

**3112 NW Cache Rd.  
Lawton, OK 73505**

RESTAURANT FOR LEASE



**LEASE RATE** **\$22.00 SF/YR**

### OFFERING SUMMARY

Available SF: ±6,030 SF

Lease Rate: \$22.00 SF/yr (NNN)

Lot Size: ±1.47 Acres

Year Built: 1980

Zoning: C-5

### PROPERTY OVERVIEW

Large restaurant offering for lease on high traffic Cache Rd. in Lawton. Location is highly visible from roadway and offers a private paved parking lot, excellent signage, and easy access from the main road. Restaurant is fully equipped and turn-key ready with furniture, fixtures and equipment included. Other nearby businesses include McAlister's Deli, Golden Corral Buffet, Five Guys, Jimmy Johns, and Casey's. This property is also available for sale, sale price is negotiable.

### PROPERTY HIGHLIGHTS

- Large restaurant for lease on Cache Rd.
- Turn-key ready.
- High traffic area.

### JASON WELLS

580.353.6100  
jwells@insightbrokers.com

Measurements and other information are obtained from Owner and/or other reliable sources and are offered as an aid for investment analysis. Although deemed reliable, information is not guaranteed and is provided subject to errors, omissions, prior sale or withdrawal.

**3112 NW Cache Rd.  
Lawton, OK 73505**

RESTAURANT FOR LEASE

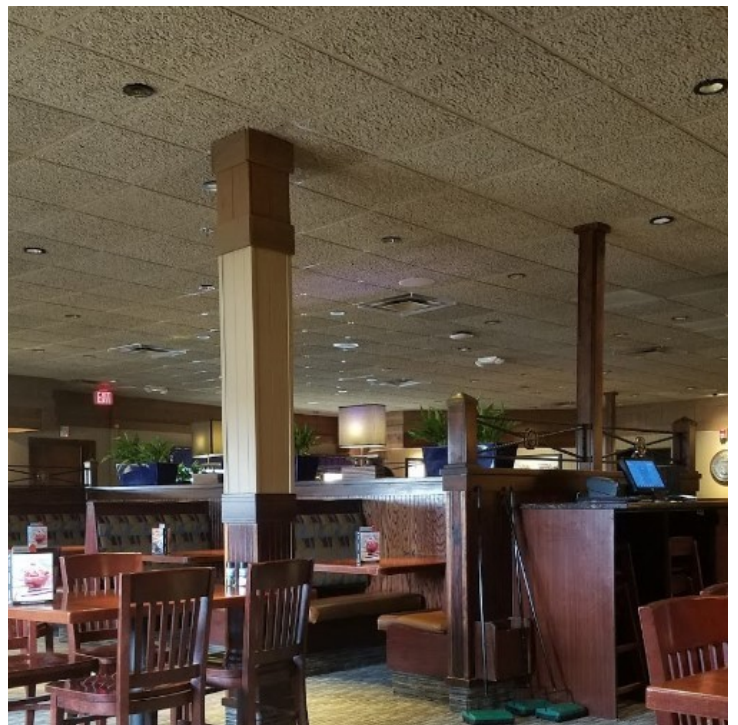

**JASON WELLS**

580.353.6100  
jwells@insightbrokers.com

**3112 NW Cache Rd.  
Lawton, OK 73505**

RESTAURANT FOR LEASE

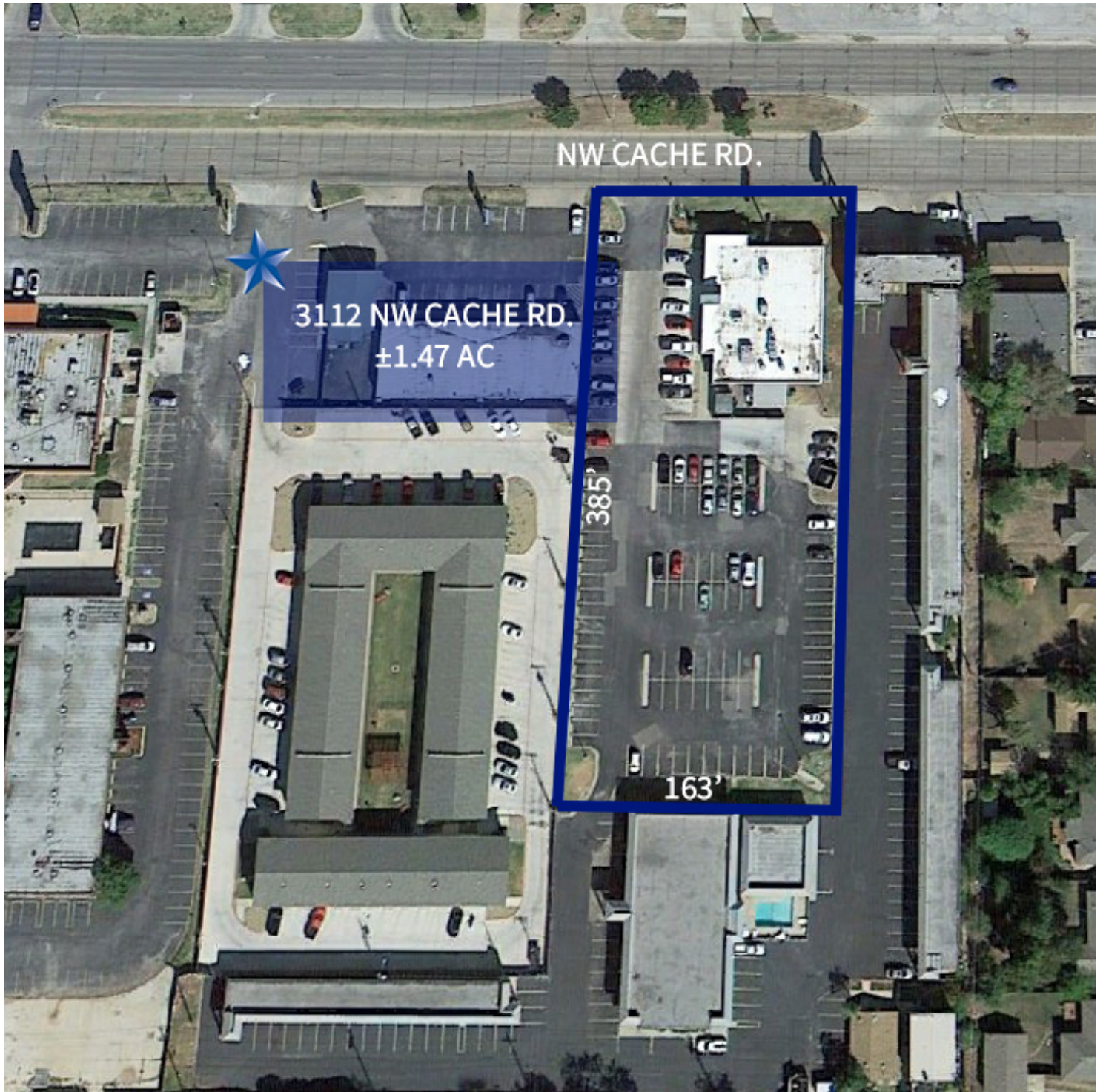

**JASON WELLS**

580.353.6100

[jwells@insightbrokers.com](mailto:jwells@insightbrokers.com)

3112 NW Cache Rd.  
Lawton, OK 73505

RESTAURANT FOR LEASE

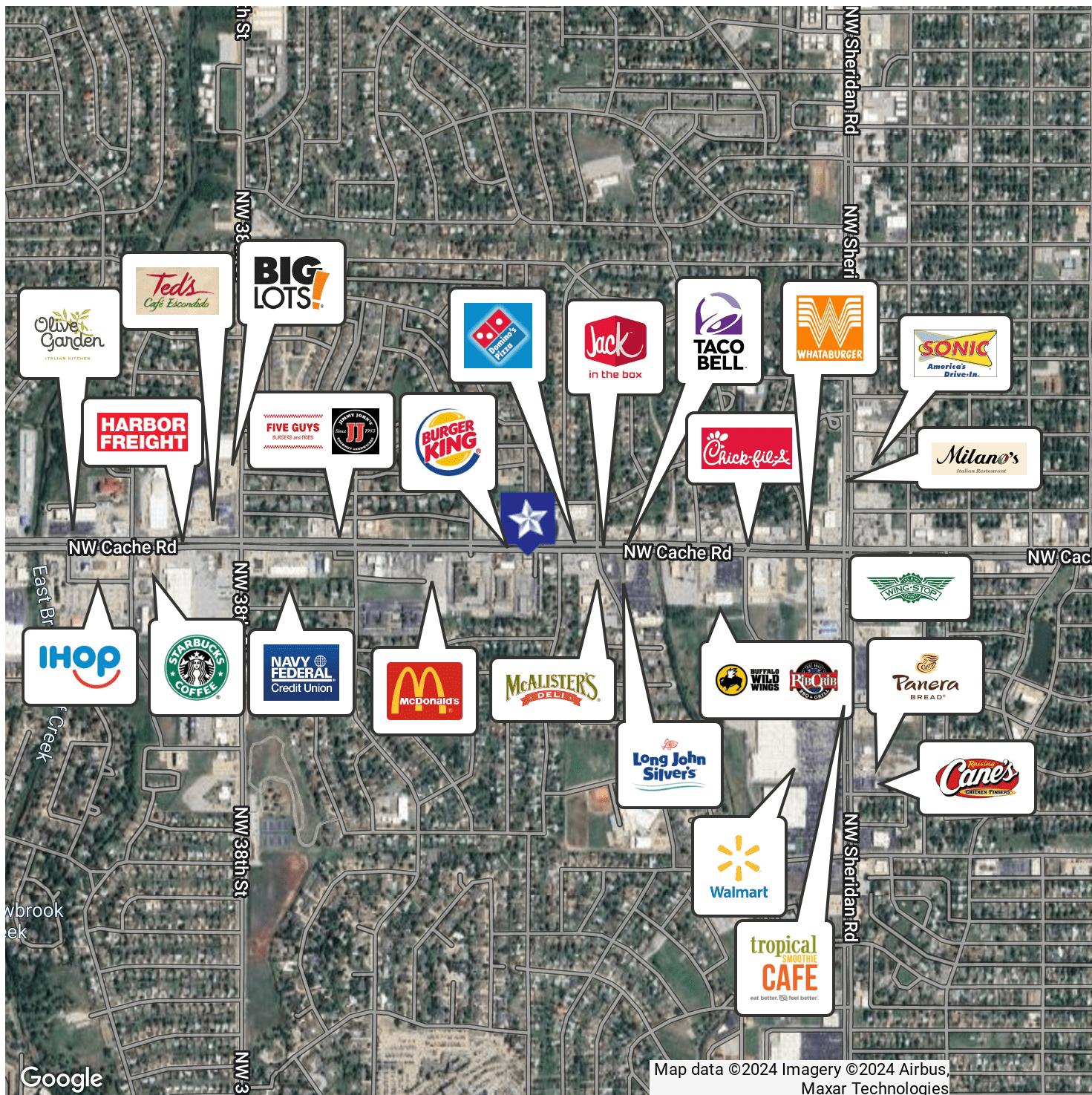

**JASON WELLS**  
580.353.6100  
jwells@insightbrokers.com



**3112 NW Cache Rd.  
Lawton, OK 73505**

RESTAURANT FOR LEASE

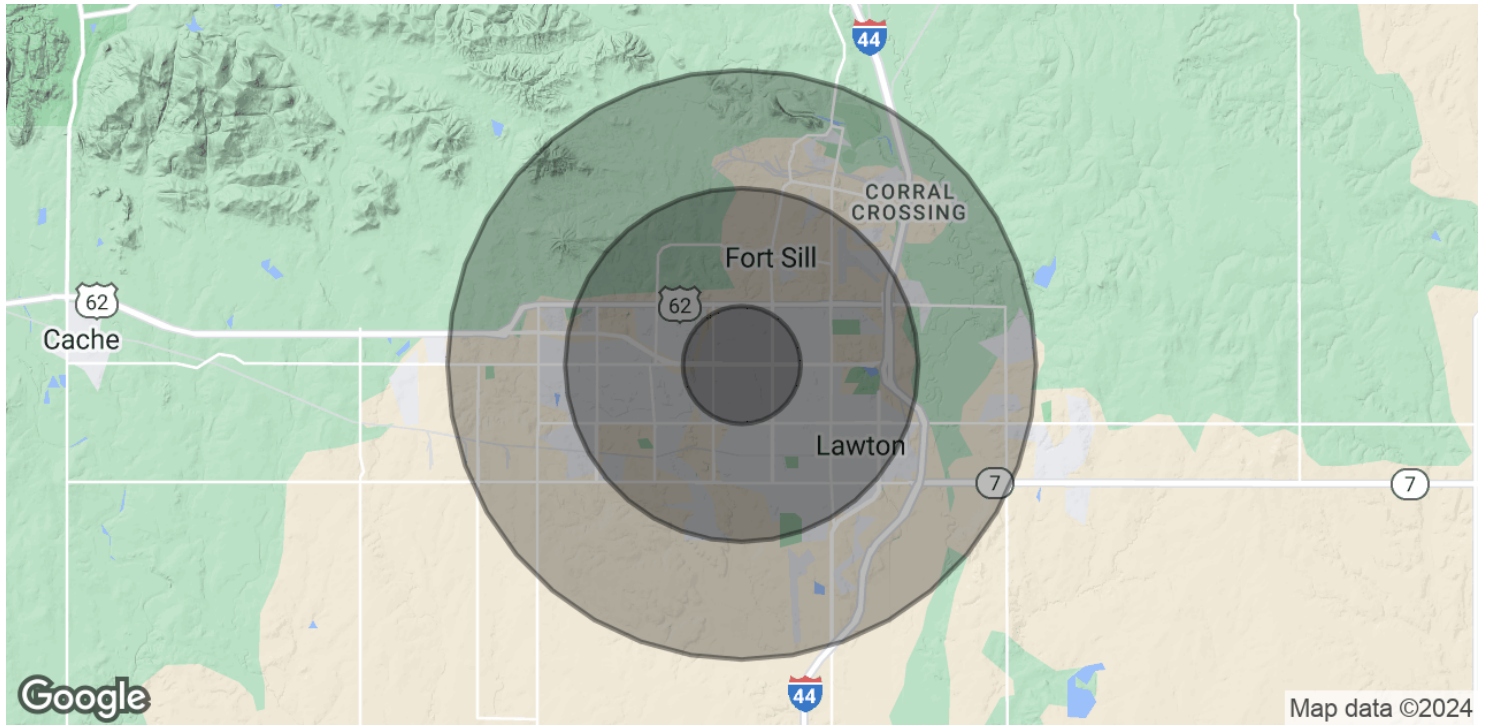

| <b>POPULATION</b>              | <b>1 MILE</b> | <b>3 MILES</b> | <b>5 MILES</b> |
|--------------------------------|---------------|----------------|----------------|
| Total Population               | 11,318        | 60,996         | 86,911         |
| Average Age                    | 33.1          | 30.8           | 31.5           |
| Average Age (Male)             | 32.1          | 30.4           | 31.4           |
| Average Age (Female)           | 34.0          | 31.6           | 31.8           |
| <b>HOUSEHOLDS &amp; INCOME</b> | <b>1 MILE</b> | <b>3 MILES</b> | <b>5 MILES</b> |
| Total Households               | 4,822         | 24,613         | 34,196         |
| # of Persons per HH            | 2.3           | 2.5            | 2.5            |
| Average HH Income              | \$50,387      | \$45,561       | \$48,438       |
| Average House Value            | \$109,998     | \$102,846      | \$119,168      |

2020 American Community Survey (ACS)

**JASON WELLS**

580.353.6100  
jwells@insightbrokers.com



## 3112 NW Cache Rd. Lawton, OK 73505

## RESTAURANT FOR LEASE



### REGION

Lawton has become the regional employment and retail center for southwest Oklahoma. Lawton supports a retail community of almost 300,000 people, all within a 45 minute drive. The greater Lawton region includes Wichita Falls, TX and the smaller towns of Cache, Duncan, Altus, Geronimo, Walters, Elgin, Chickasha, Marlow and Rush Springs, as well as the Fort Sill military installation and the Wichita Mountains Wildlife Refuge.

### LABOR FORCE

The greater Lawton area has gone through some healthy growth over the past 6 years that has resulted in a larger workforce. One of the strongest assets of the region is the population of skilled workers. Not only does the region recruit from its own residents in Lawton-Fort Sill, but also from the nearby communities and unincorporated areas of the 7 county area. On average, in a 45 minute radius from different points within the region, you can find an available workforce of approximately 350,000.

### FORT SILL

Fort Sill is one of the largest employers in Oklahoma with about 7,300 civilian employees, 9,000 soldiers stationed at the fort and another 5,500 soldiers rotating through for training. It has become a technology test and training hub of the United States. Fort Sill really is a twin city to Lawton right next door. The Army post has hotels, restaurants, day care centers, homes, shops – a city all by itself. But Fort Sill relies as much on Lawton as Lawton benefits from the \$2 billion economic impact generated by Fort Sill. Fort Sill is more than a great community partner and a major economic generator for the state of Oklahoma, it is also a workforce producer that delivers quality and technically experienced personnel when they leave the military.

### JASON WELLS

580.353.6100  
jwells@insightbrokers.com