

MARINA WEST BUSINESS CENTER BUILDING A



ELION

CLASS A DISTRIBUTION OR MANUFACTURING SPACE FOR LEASE

13900 N.W. 2ND STREET, SUNRISE, FL

112,155 SF - 276,175 SF

PROPERTY HIGHLIGHTS

- SPACE AVAILABLE: FULL BUILDING FROM 112,155 SF - 276,175 SF
- OFFICE AREA: ±32,000 SF
- CLEAR HEIGHT: 30'
- PARKING: 304 SPACES
- 42 DOCK HIGH DOORS, PLUS 2 DRIVE-IN DOORS
- ESFR FIRE SPRINKLERED
- 100% CLIMATE CONTROLLED
- TILT WALL CONSTRUCTION
- LED LIGHTING THROUGHOUT
- REAR LOAD BUILDING
- HEAVY POWER
- PARTIALLY FENCED TRUCK COURT
- EXISTING FDA PHARMACEUTICAL USE
- FRONTAGE ON 595
- 50' SPEED BAY
- 19 DOCK HIGH DOORS
- 9 PIT LEVELERS
- 2 12' X 14' RAMPS

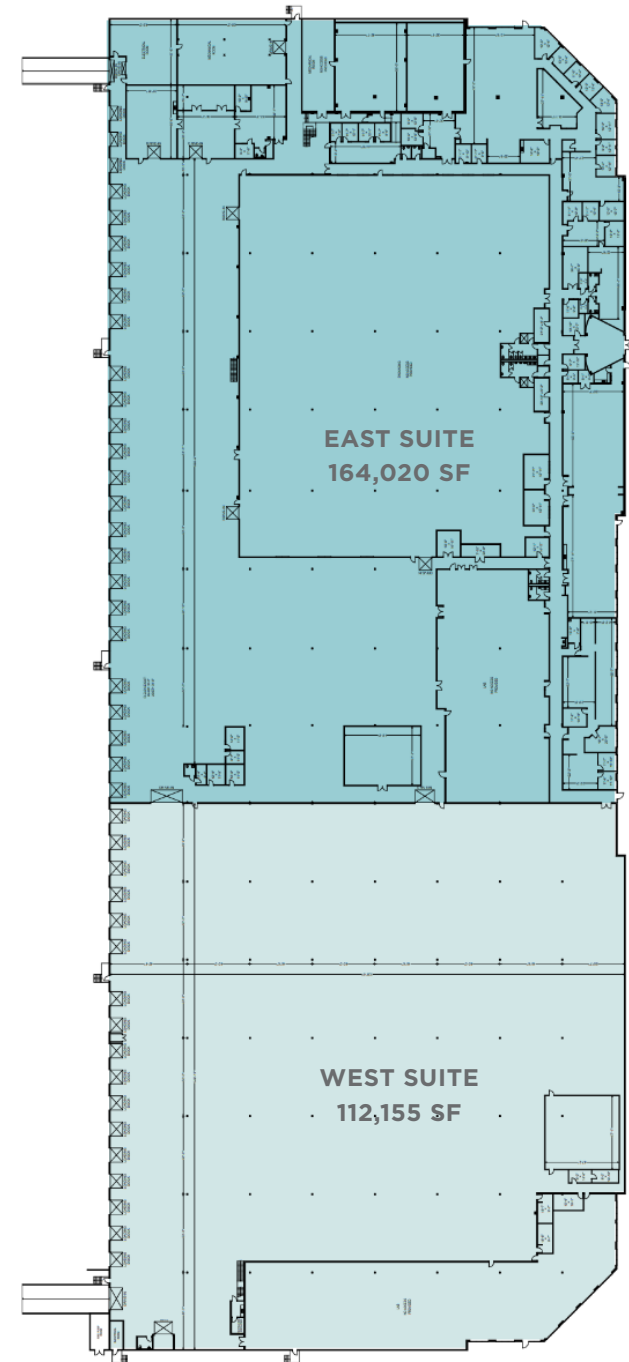

LOCATION HIGHLIGHTS

LOCATED IN ONE OF THE MOST ACTIVE SUBMARKETS ALONG A MAJOR EAST/WEST THOROUGHFARE IN BROWARD COUNTY



DEMOGRAPHICS 5 MILES

202,233 - POPULATION

\$117,853 - AVG HOUSEHOLD INCOME

41.9 - MEDIAN AGE

MARINA WEST BUSINESS CENTER BUILDING A



Drive Times	Population
0 - 1 Hours	5,132,416
1 - 2 Hours	7,483,926
2 - 3 Hours	9,245,221
3 - 4 Hours	15,894,384
4 - 5 Hours	18,462,687

FOR MORE INFORMATION, CONTACT:

MATTHEW G. MCALLISTER, SIOR
 Executive Director
 +1 561 901 5216
 matthew.mcallister@cushwake.com

ERIC CANTOR
 Senior Associate
 +1 561 227 2068
 eric.cantor@cushwake.com



ELION

©2026 Cushman & Wakefield. All rights reserved. The information contained in this communication is strictly confidential. This information has been obtained from sources believed to be reliable but has not been verified. no warranty or representation, express or implied, is made as to the condition of the property (or properties) referenced herein or as to the accuracy or completeness of the information contained herein, and same is submitted subject to errors, omissions, change of price, rental or other conditions, withdrawal without notice, and to any special listing conditions imposed by the property owner(s). any projections, opinions or estimates are subject to uncertainty and do not signify current or future property performance. PM CENTRAL COE - 2/12/26