

Property Profile Report

General Information

Location: **1810 W 35TH ST**
Parcel ID: **0122000121**
Grid: **MH25**

Planning & Zoning

*Right click [hyperlinks](#) to open in a new window.

Future Land Use (FLUM): **No Future Land Use Map**

Regulating Plan: **No Regulating Plan**

Zoning: **LR**

Zoning Cases: **None:**

Zoning Ordinances: **19990225-070b**

Zoning Overlays: **ADU Approximate Area Reduced Parking
Compatibility Standards
Residential Design Standards: LDC/25-2-Subchapter F**

Infill Options: **--**

Neighborhood Restricted Parking Areas: **--**

Mobile Food Vendors: **--**

Historic Landmark: **--**

Urban Roadways: **Yes**

Zoning Guide

The [Guide to Zoning](#) provides a quick explanation of the above Zoning codes, however, the [Land Development Information Services](#) provides general zoning assistance and can advise you on the type of development allowed on a property. Visit [Zoning](#) for the description of each Base Zoning District. For official verification of the zoning of a property, please order a [Zoning Verification Letter](#). General information on the [Neighborhood Planning Areas](#) is available from Neighborhood Planning.

Environmental

Fully Developed Floodplain: **No**
FEMA Floodplain: **No**
Austin Watershed Regulation Areas: **URBAN**
Watershed Boundaries: **Shoal Creek**
Creek Buffers: **No**
Edwards Aquifer Recharge Zone: **No**
Edwards Aquifer Recharge Verification Zone: **Yes**
Erosion Hazard Zone Review Buffer: **No**

Political Boundaries

Jurisdiction: **AUSTIN FULL PURPOSE**
Council District: **10**
County: **TRAVIS**
School District: **Austin ISD**
Community Registry: **Austin Independent School District, Austin Lost and Found Pets, Austin Neighborhoods Council, Bull Creek Road Coalition, Friends of Austin Neighborhoods, Homeless Neighborhood Association, Neighborhood Empowerment Foundation, Oakmont Heights Neighborhood Assn., Preservation Austin, SELTexas, Save Our Springs Alliance, Shoal Creek Conservancy, Sierra Club, Austin Regional Group**

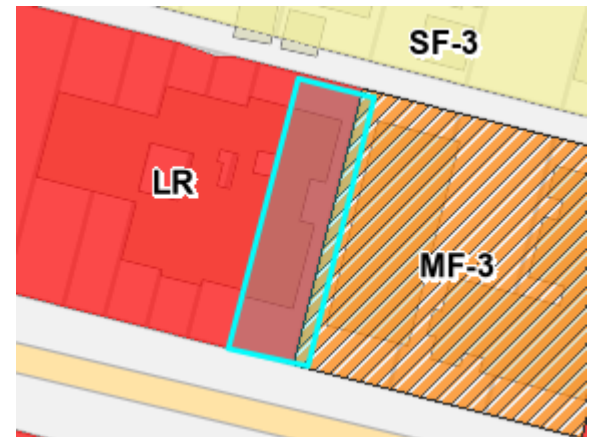

Zoning Map



Imagery Map

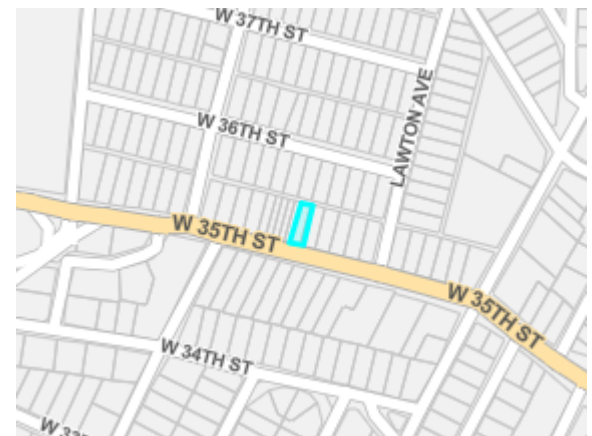

Vicinity Map