



Mt. Prospect Office for Sublease!

**1660 FEEHANVILLE DRIVE
MT. PROSPECT, IL**

Area

4th Floor – 12,268 SF (**DIVISIBLE to 3,000 SF**)

Lease Rate

Subject to Offer

Possession

Immediately

Sublease Term

Through January 31, 2027 (potential longer term available)

Space Highlights

- Large open area with cubicles
- Furniture available
- Seven offices
- Kitchenette
- Two conference rooms
- Boardroom
- Training room
- 5.63 per 1,000 parking ratio

For information, please contact:

Brian Reaney

Managing Director

t 773-920-0460

brian.reaney@nmrk.com

8750 W. Bryn Mawr, Suite 350
Chicago, IL 60631

nmrk.com



NEWMARK

The information contained herein has been obtained from sources deemed reliable but has not been verified and no guarantee, warranty or representation, either express or implied, is made with respect to such information. Terms of sale or lease and availability are subject to change or withdrawal without notice.

FOR SUBLEASE – 12,268 SF – 4th Floor

Conference Room



Reception Area



Space Photos

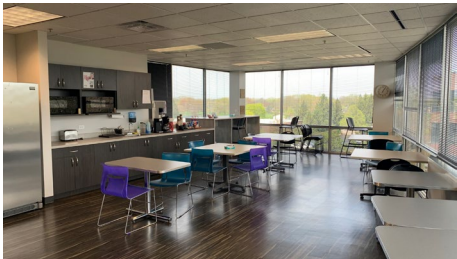

FOR SUBLEASE – 12,268 SF – 4th Floor

Plan can be demised down to as small as 3,000 SF

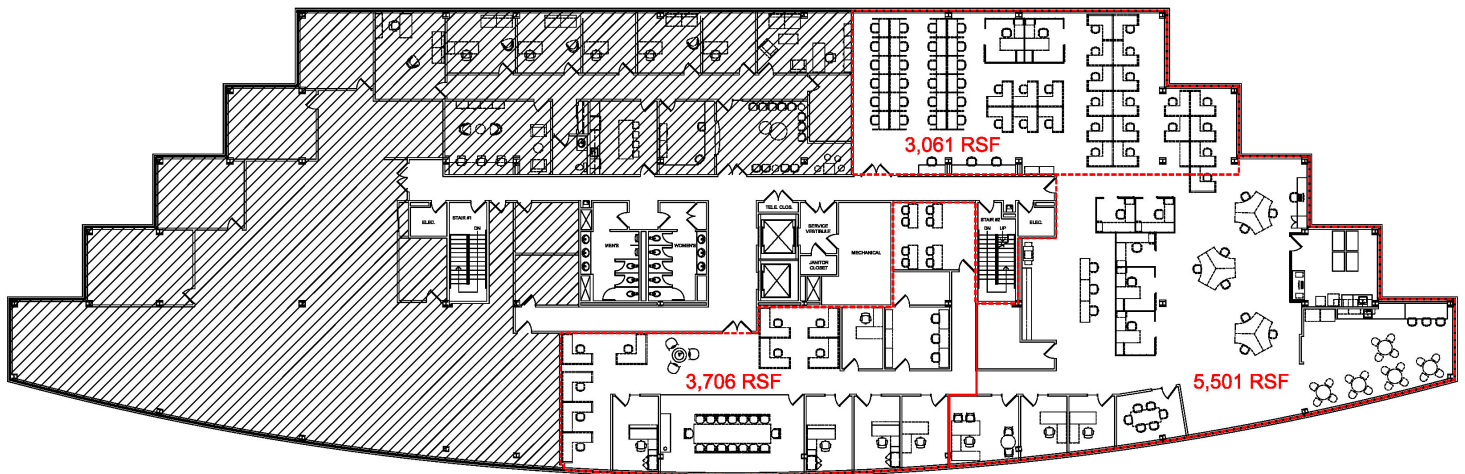

NEWMARK