

## OFFICE PROPERTY FOR LEASE

# 3,543 SF Built-Out Medical Suite Near Ascension Macomb

29703 - 29753 HOOVER RD  
WARREN, MI 48903



Professionally managed and maintained  
medical complex

Newer building construction

Ample parking to accommodate 144 vehicles

Prominent main road signage & exposure



**P.A. COMMERCIAL**  
Corporate & Investment Real Estate



### OFFERING SUMMARY

Available SF:	3,543 SF
Building Size:	17,832 SF
Lease Rate:	\$18.50 SF/yr (NNN)
Zoning:	Office
Year Built:	1998
Lot Size:	2.18 Acres
Market:	Detroit
Submarket:	Macomb West
Traffic Count:	24,000

### PROPERTY OVERVIEW

This 3,543 SF suite within this attractive medical building has a waiting room, 9 exam rooms, 2 labs, 2 private offices, and plenty of storage.

### LOCATION OVERVIEW

This medical office complex is conveniently located close to major Macomb County Hospitals. Located on the corner of a major intersection at the corner of Hoover Rd and Common Rd in the middle of a nice suburban neighborhood on a well-known medical corridor.

### PROPERTY HIGHLIGHTS

- Professionally managed and maintained medical complex
- Newer building construction
- Ample parking to accommodate 144 vehicles
- Prominent main road signage & exposure

**JOHN E. DE WALD, CPA** Principal  
 johnd@pacommercial.com (P) 248.358.0100 x112 (C) 313.510.3777

**PHILLIP J. MYERS** Senior Associate  
 phil@pacommercial.com (P) 248.358.0100 x110 (C) 586.242.4047



**P.A. COMMERCIAL**  
 Corporate & Investment Real Estate

26555 Evergreen Road, Suite 1500 • Southfield, MI 48076



**JOHN E. DE WALD, CPA** Principal  
johnd@pacommercial.com (P) 248.358.0100 x112 (C) 313.510.3777  
**PHILLIP J. MYERS** Senior Associate  
phil@pacommercial.com (P) 248.358.0100 x110 (C) 586.242.4047

 **P.A. COMMERCIAL**  
Corporate & Investment Real Estate  
26555 Evergreen Road, Suite 1500 • Southfield, MI 48076

29703 - 29753 HOOVER RD, WARREN, MI

// AVAILABLE SPACES

**LEASE TYPE** | NNN      **TOTAL SPACE** | 3,543 SF      **LEASE TERM** | Negotiable      **LEASE RATE** | \$18.50 SF/yr



SUITE	TENANT	SIZE (SF)	LEASE TYPE	LEASE RATE
29703 Hoover Rd	Available	3,543 SF	NNN	\$18.50 SF/yr

**JOHN E. DE WALD, CPA** Principal  
 johnd@pacommercial.com (P) 248.358.0100 x112 (C) 313.510.3777

**PHILLIP J. MYERS** Senior Associate  
 phil@pacommercial.com (P) 248.358.0100 x110 (C) 586.242.4047



26555 Evergreen Road, Suite 1500 • Southfield, MI 48076

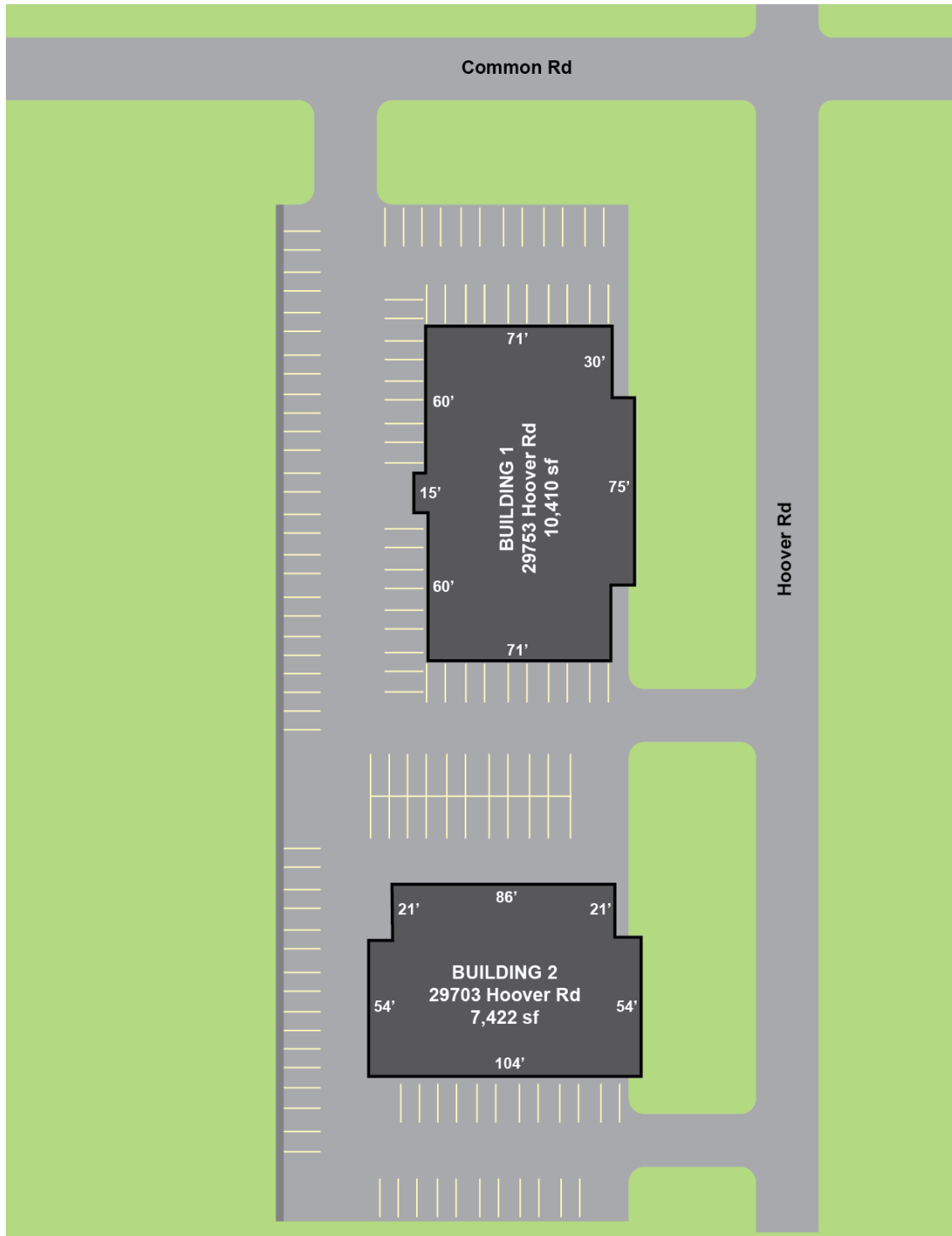

**JOHN E. DE WALD, CPA** Principal  
johnd@pacommercial.com (P) 248.358.0100 x112 (C) 313.510.3777

**PHILLIP J. MYERS** Senior Associate  
phil@pacommercial.com (P) 248.358.0100 x110 (C) 586.242.4047



26555 Evergreen Road, Suite 1500 • Southfield, MI 48076

We obtained the information above from sources we believe to be reliable. However, we have not verified its accuracy and make no guarantee, warranty or representation about it. It is submitted subject to the possibility of errors, omissions, change of price, rental or other conditions, prior sale, lease or financing, or withdrawal without notice. We include projections, opinions, assumptions or estimates for example only, and they may not represent current or future performance of the property. You and your tax and legal advisors should conduct your own investigation of the property and transaction.

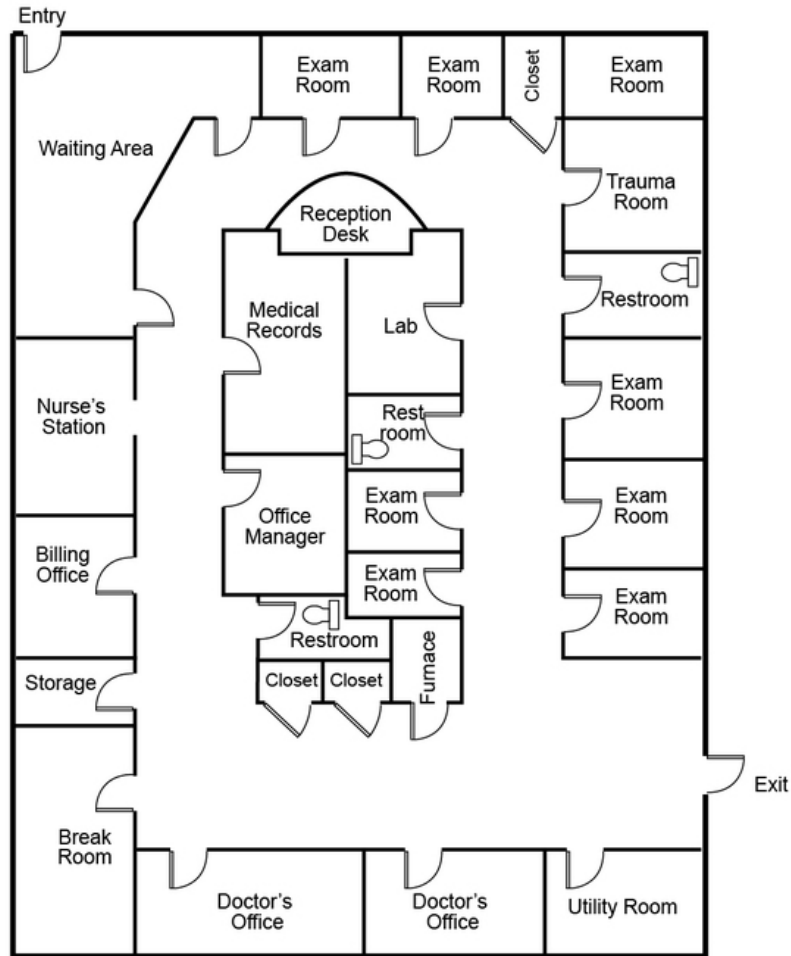

29703 Hoover Rd  
3,543 SF

**JOHN E. DE WALD, CPA** Principal  
johnd@pacommercial.com (P) 248.358.0100 x112 (C) 313.510.3777

**PHILLIP J. MYERS** Senior Associate  
phil@pacommercial.com (P) 248.358.0100 x110 (C) 586.242.4047



**P.A. COMMERCIAL**  
Corporate & Investment Real Estate

26555 Evergreen Road, Suite 1500 • Southfield, MI 48076

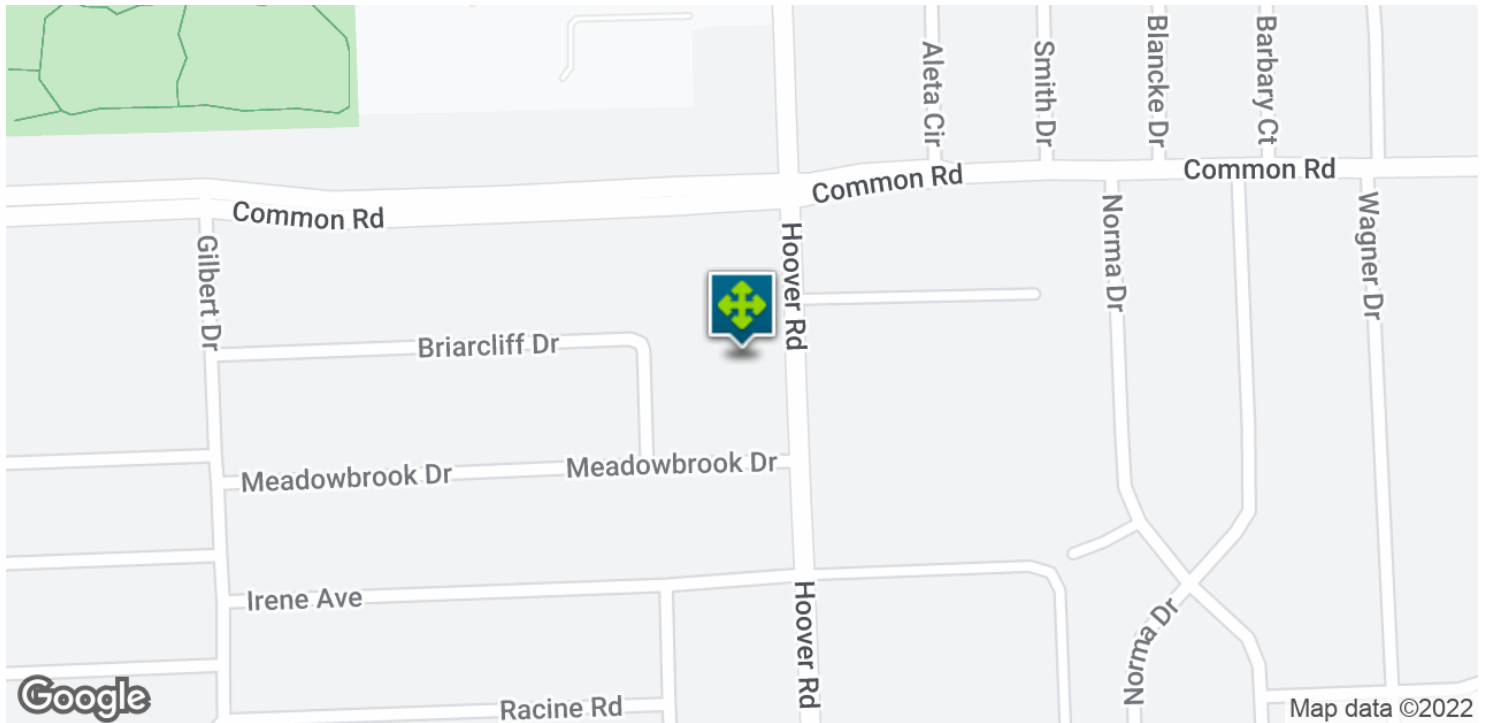

**JOHN E. DE WALD, CPA** Principal  
johnd@pacommercial.com (P) 248.358.0100 x112 (C) 313.510.3777

**PHILLIP J. MYERS** Senior Associate  
phil@pacommercial.com (P) 248.358.0100 x110 (C) 586.242.4047

 **P.A. COMMERCIAL**  
Corporate & Investment Real Estate

26555 Evergreen Road, Suite 1500 • Southfield, MI 48076

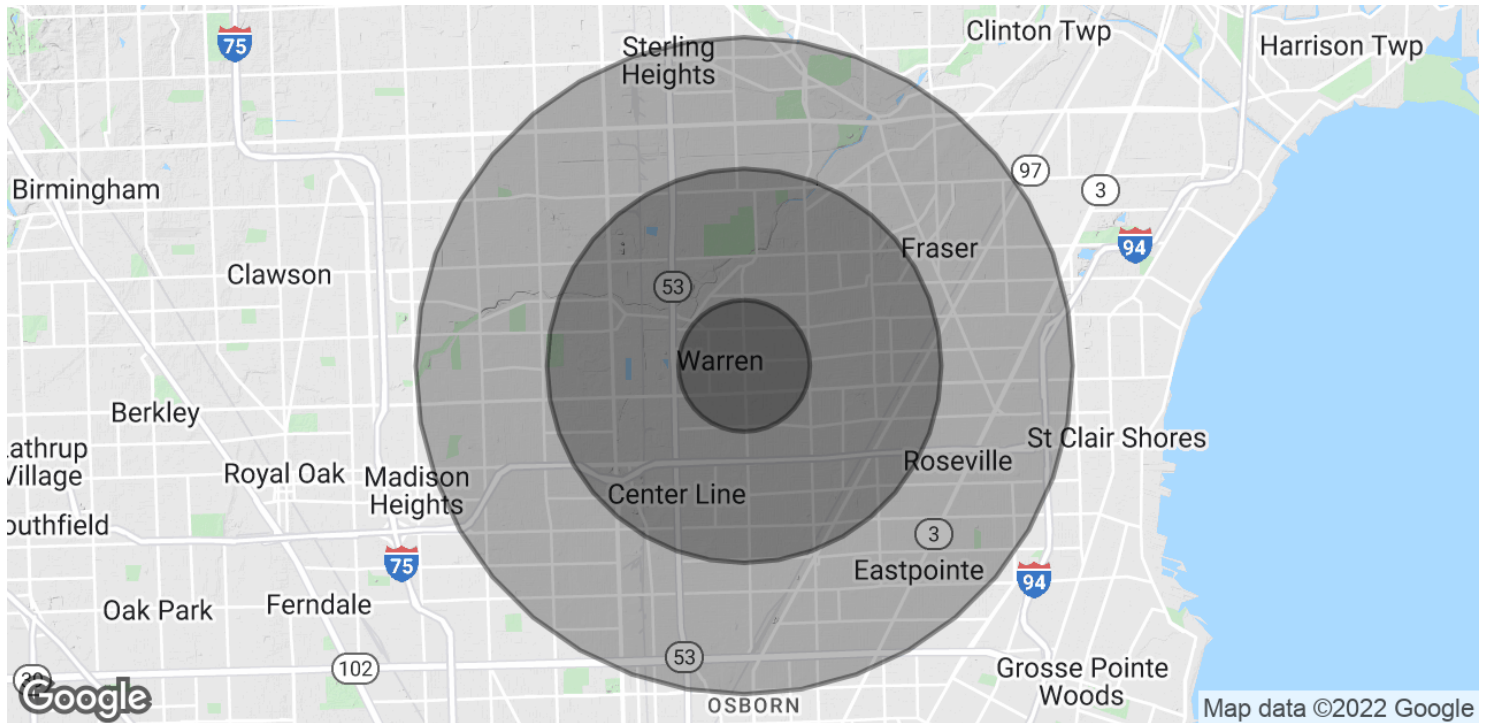

**POPULATION**

	<b>1 MILE</b>	<b>3 MILES</b>	<b>5 MILES</b>
Total Population	15,277	109,944	309,338
Average age	43.3	42.2	39.6
Average age (Male)	42.1	40.8	38.1
Average age (Female)	44.9	43.8	40.9

**HOUSEHOLDS & INCOME**

	<b>1 MILE</b>	<b>3 MILES</b>	<b>5 MILES</b>
Total households	6,585	46,857	124,950
# of persons per HH	2.3	2.3	2.5
Average HH income	\$59,621	\$58,778	\$57,042
Average house value	\$143,960	\$145,883	\$143,975

\* Demographic data derived from 2010 US Census

**JOHN E. DE WALD, CPA** Principal  
 johnd@pacommercial.com (P) 248.358.0100 x112 (C) 313.510.3777

**PHILLIP J. MYERS** Senior Associate  
 phil@pacommercial.com (P) 248.358.0100 x110 (C) 586.242.4047



26555 Evergreen Road, Suite 1500 • Southfield, MI 48076