

Sublease Available

3010 Lava Ridge Court | Suite 150 | Roseville
±11,094 RSF Total Available

Limited Time Offer, \$1.50 per sf, FULL SERVICE!!!



Property Highlights

- For sublease, Lease expires April 1, 2024
- 11,094 rentable square feet, ground floor space
- Turn-key condition, furnishings available, if desired
- Immediate occupancy
- Well under market rate - ~~\$1.95 per sf~~
- For offers received by 02/28/2022, a discounted rent of **\$1.50 - Full Service**



For more information, contact:

Clyde Rawlings
RE License # 00986815
T +1 916 491 4320
clyde.rawlings@am.jll.com

DISCLAIMER

The material herein is intended as a guide only, no liability for negligence or otherwise is assumed for the material contained herein by Jones Lang LaSalle, its principal or its servants or its agents. No material contained herein shall form the basis of or be part of any agreement and no warranty is given or implied as to the accuracy of the whole or any part of the material. Prospective purchasers/tenants should not rely on the material but should make their own enquiries and satisfy themselves of all aspects of the material. Any liability by Jones Lang LaSalle, its principal, its servants or its agents in any way connected with the brochure, whether or not such liability results from or involves negligence, will not exceed \$1000.00.
©2019. Jones Lang LaSalle IP, Inc. All rights reserved. Jones Lang LaSalle Brokerage, Inc. Real Estate License #01856260



3010 Lava Ridge Court | Suite 150 | Roseville

Building Photos



3010 Lava Ridge Court | Suite 150 | Roseville

Floor Plan

Suite 150 : ±11,094 RSF

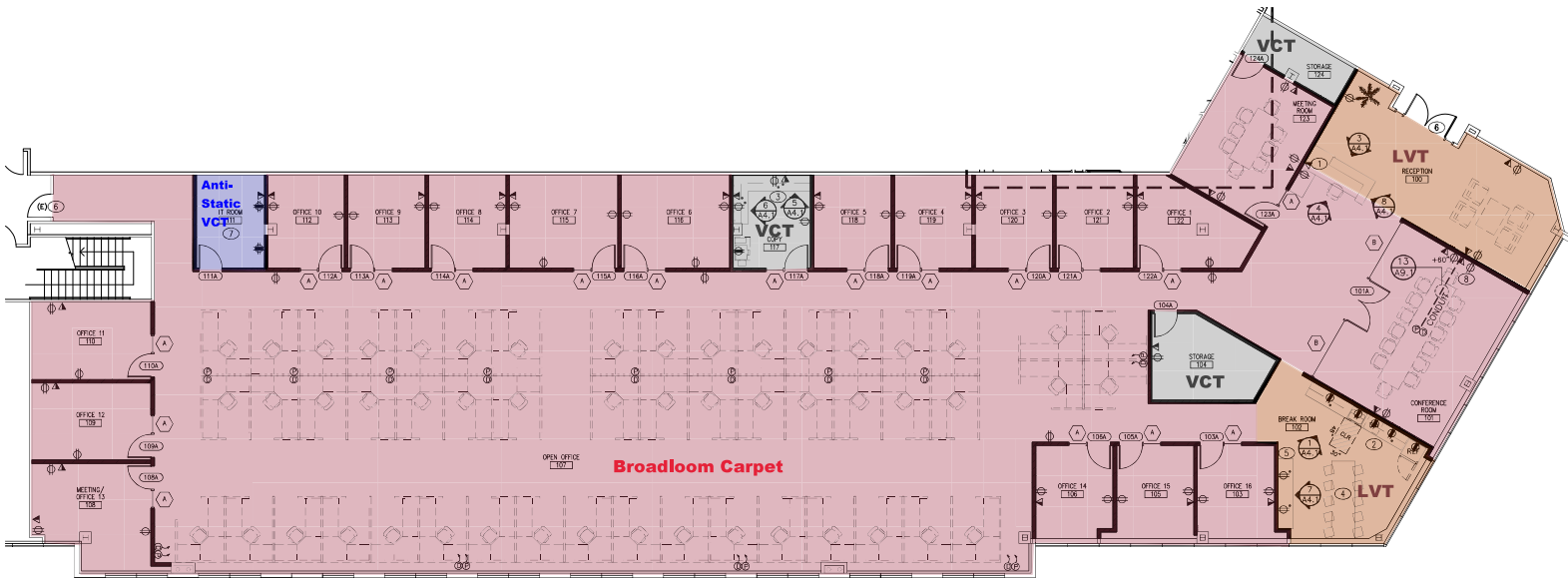

Plan is not to scale

For more information, contact:

Clyde Rawlings
RE License # 00986815
T +1 916 491 4320
clyde.rawlings@am.jll.com

DISCLAIMER

The material herein is intended as a guide only, no liability for negligence or otherwise is assumed for the material contained herein by Jones Lang LaSalle, its principal or its servants or its agents. No material contained herein shall form the basis of or be part of any agreement and no warranty is given or implied as to the accuracy of the whole or any part of the material. Prospective purchasers/tenants should not rely on the material but should make their own enquiries and satisfy themselves of all aspects of the material. Any liability by Jones Lang LaSalle, its principal, its servants or its agents in any way connected with the brochure, whether or not such liability results from or involves negligence, will not exceed \$1000.00.
©2019. Jones Lang LaSalle IP, Inc. All rights reserved. Jones Lang LaSalle Brokerage, Inc. Real Estate License #01856260

