



2834 S State Highway 208

2834 S State Highway 208, Snyder, TX 79549



Deborah Boyd

Evermore Real Estate

690 Boyd Ln, Snyder, TX 79549

debboyd39@yahoo.com

(325) 573-8505



2834 S State Highway 208

\$325,000

GUARANTEED STREAM OF INCOME!

This business consists of both a cemetery and a monuments business. Includes an office building, shop, and storage building. Everything you need for a successful business will be conveyed: 2 backhoes, 5 trailers, computers, computer programs, Ford F150 Super Duty pick-up, Cadillac Deville, 2 diesel mowers, golf cart, compressors, sandblast pots, chain hoist, tents, chairs. There is ample room for many new gravesites....

- Close to Highway 84 and 180



Price:	\$325,000
Property Type:	Specialty
Property Subtype:	Cemetery/Mausoleum
Building Class:	C
Sale Type:	Investment
Lot Size:	18.04 AC
Gross Building Area:	2,534 SF
No. Stories:	1
Year Built:	1960
Parking Ratio:	2.76/1,000 SF
APN / Parcel ID:	19362
Walk Score ®:	1 (Car-Dependent)

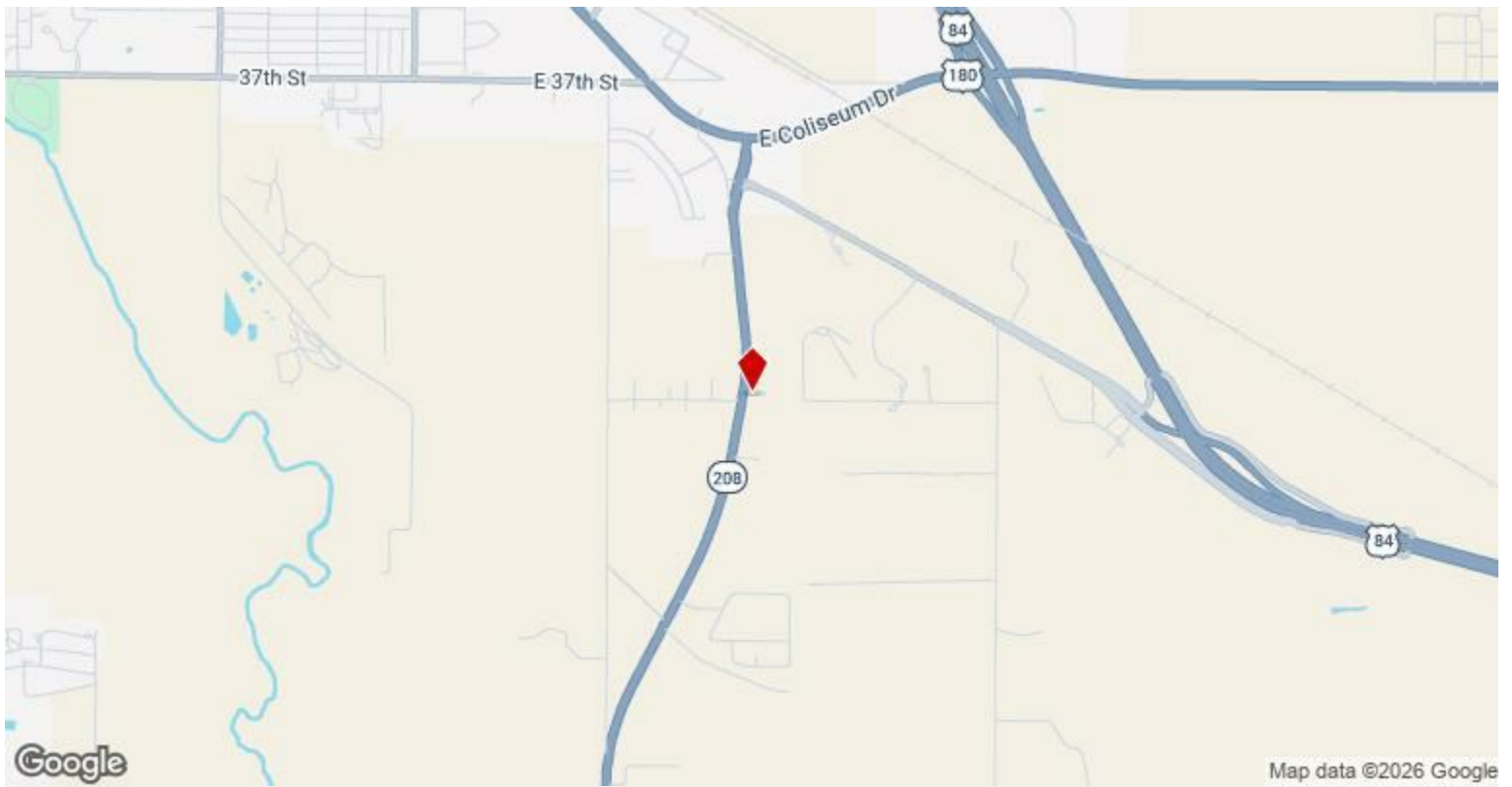

2834 S State Highway 208, Snyder, TX 79549

Property Photos



Building Photo



Building Photo

Property Photos



Building Photo



Building Photo

Property Photos



Building Photo