



## Offering Summary

Lease Rate: \$7.95/SF, NNN

Available SF: 50,083 SF

- 12,073 SF turn-key office with ample parking
- 1 ramped drive-in (12' x 14')
- 4 loading docks with pit levelers
- 7 knockouts panels allocated for expanding dock access
- 28' clear height
- 54' x 42' column spacing
- 60' speed bay

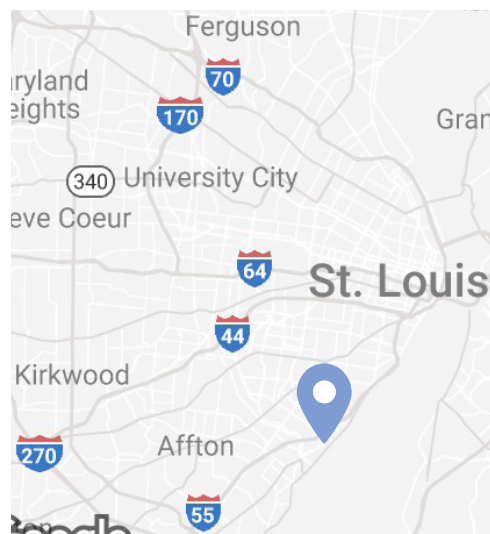

## Get more information

**Dan Cahill, CCIM**  
Senior Vice President  
314 785 7639  
dan.cahill@avisonyoung.com

**Ben Cahill, CCIM, SIOR**  
Principal  
314 785 7637  
ben.cahill@avisonyoung.com

Entire Building Floor Plan

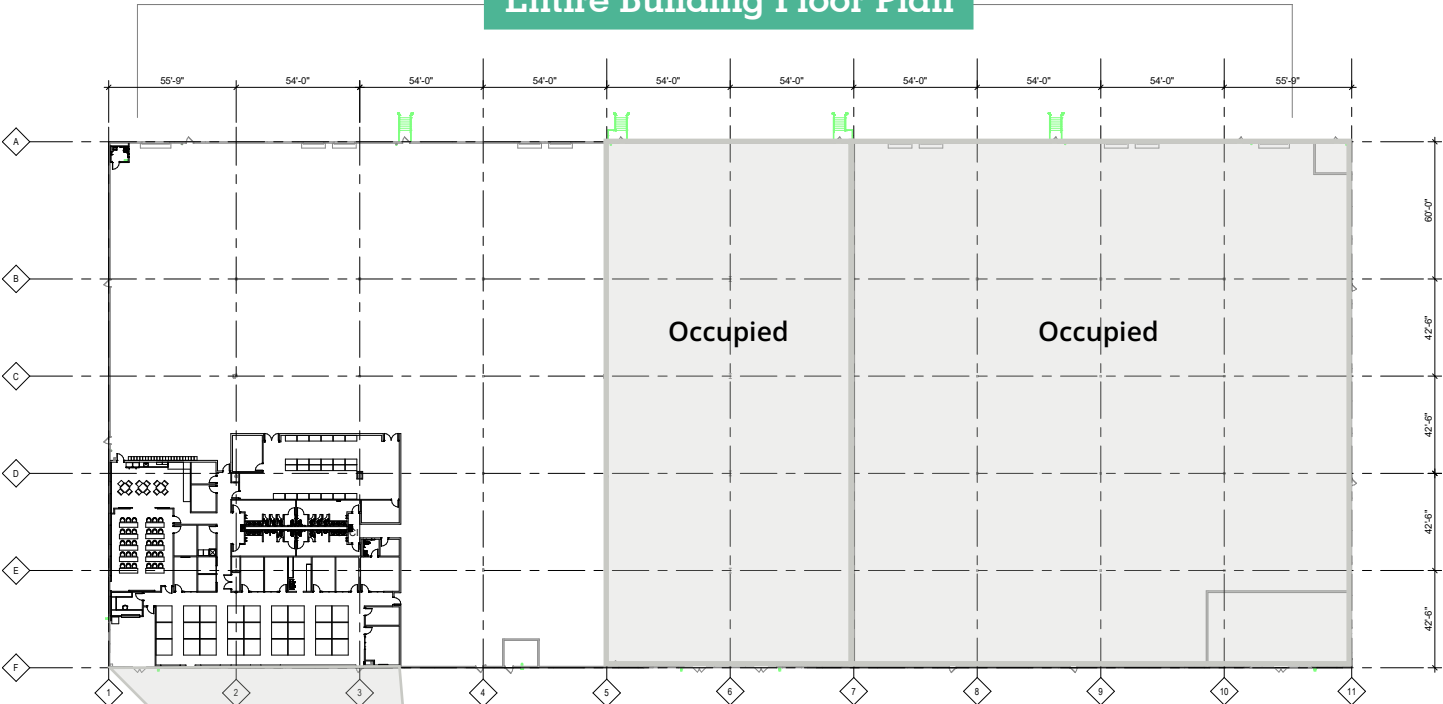

Office Floor Plan

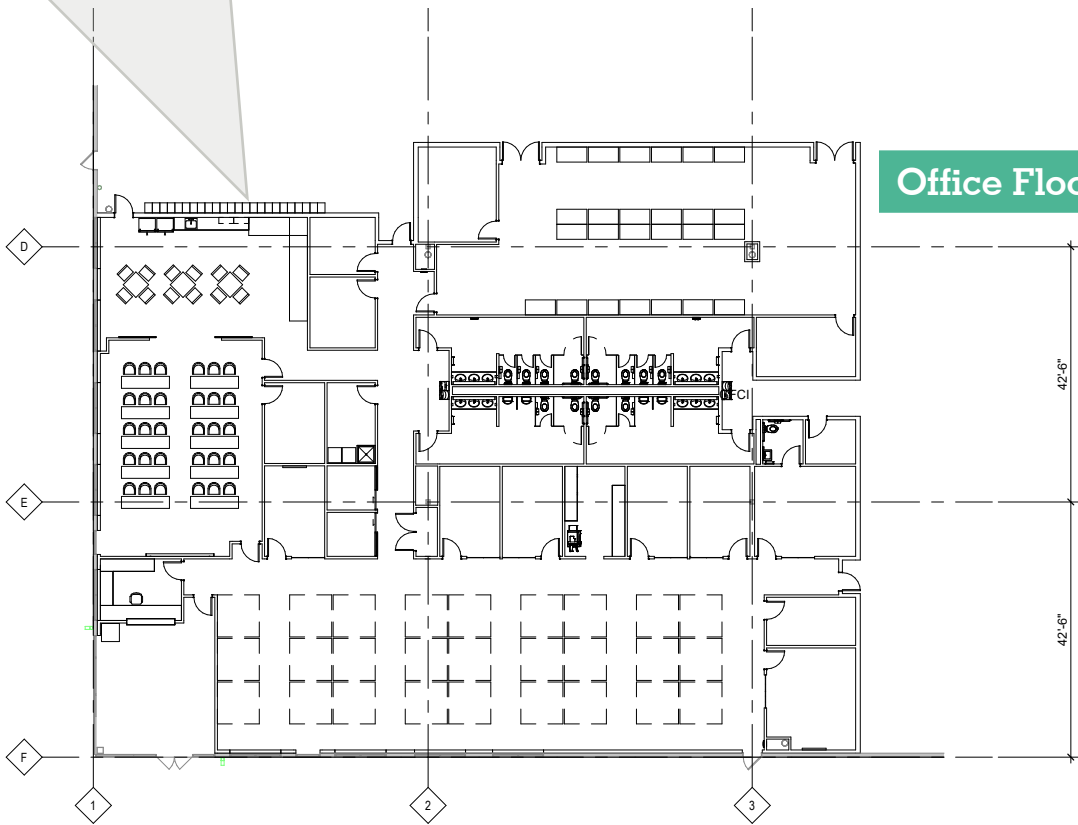

**Dan Cahill, CCIM**  
Senior Vice President  
314 785 7639  
dan.cahill@avisonyoung.com

**Ben Cahill, CCIM, SIOR**  
Principal  
314 785 7637  
ben.cahill@avisonyoung.com



# Industrial for Sale or Lease

River City Business Park



**Dan Cahill, CCIM**  
Senior Vice President  
314 785 7639  
dan.cahill@avisonyoung.com

**Ben Cahill, CCIM, SIOR**  
Principal  
314 785 7637  
ben.cahill@avisonyoung.com