

4215 - 61st Avenue SE, Bay 8
Calgary, AB

6,376 square feet

 **LEE &
ASSOCIATES**
COMMERCIAL REAL ESTATE SERVICES

FOR SUBLEASE



 Drive-in
Loading

 Paint Booth
Included

 Located in
Foothills Industrial Park

JON C. MOOK, SIOR
PRESIDENT, MANAGING DIRECTOR
C: 403-616-5239
jmook@lee-associates.com

EMILY GOODMAN, B.COMM
VICE PRESIDENT, PRINCIPAL
C: 403-862-4348
egoodman@lee-associates.com

PROPERTY DETAILS

AVAILABLE AREA:

Office: 751 sq. ft.
Warehouse: 5,624 sq. ft.
Total: 6,376 sq. ft.

NET SUBLEASE RATE:

\$12.00 per sq. ft. per annum

OPERATING COSTS:

\$6.92 per sq. ft. per annum (for 2023)

TERM:

October 31st, 2025

YEAR BUILT:

1976

AVAILABILITY:

Immediately

ZONING:

I-G (Industrial General)

CEILING HEIGHT:

20' clear

ELECTRICAL:

200 Amp, 120/208 Volts, 3 Phase

LOADING:

1 - 12' W x 14' H Drive-in door
1 - 14' W x 16' H Drive-in door

COMMENTS:

- » Paint booth included
(automotive painting is not an acceptable use)
- » Large truck loading area
- » Direct access onto 61st Avenue SE
- » Quick access to Barlow Trail,
Glenmore Trail, and Deerfoot Trail SE



FLOOR PLAN

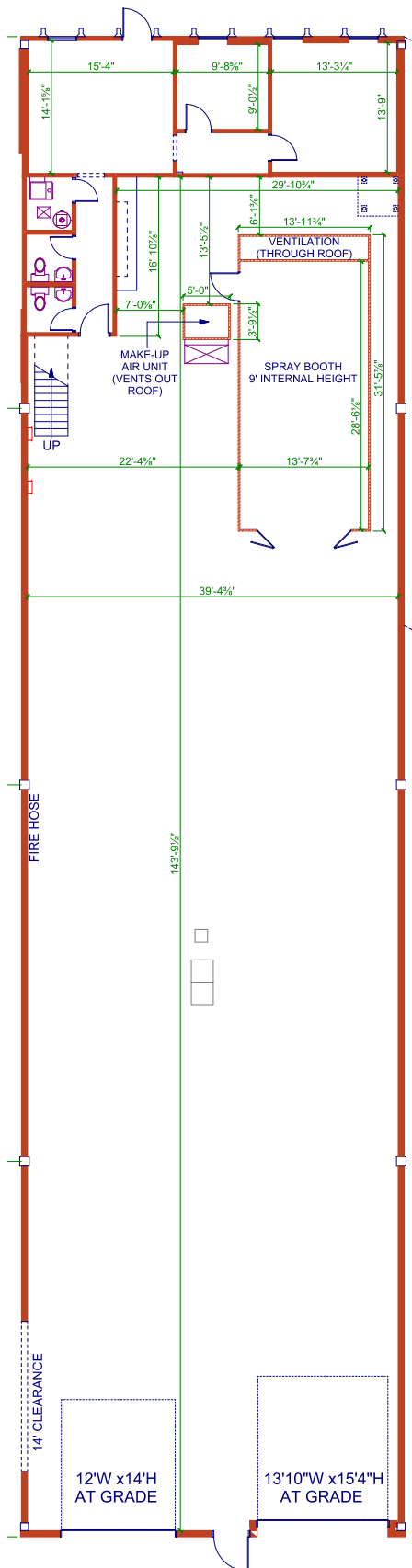

LOCATION

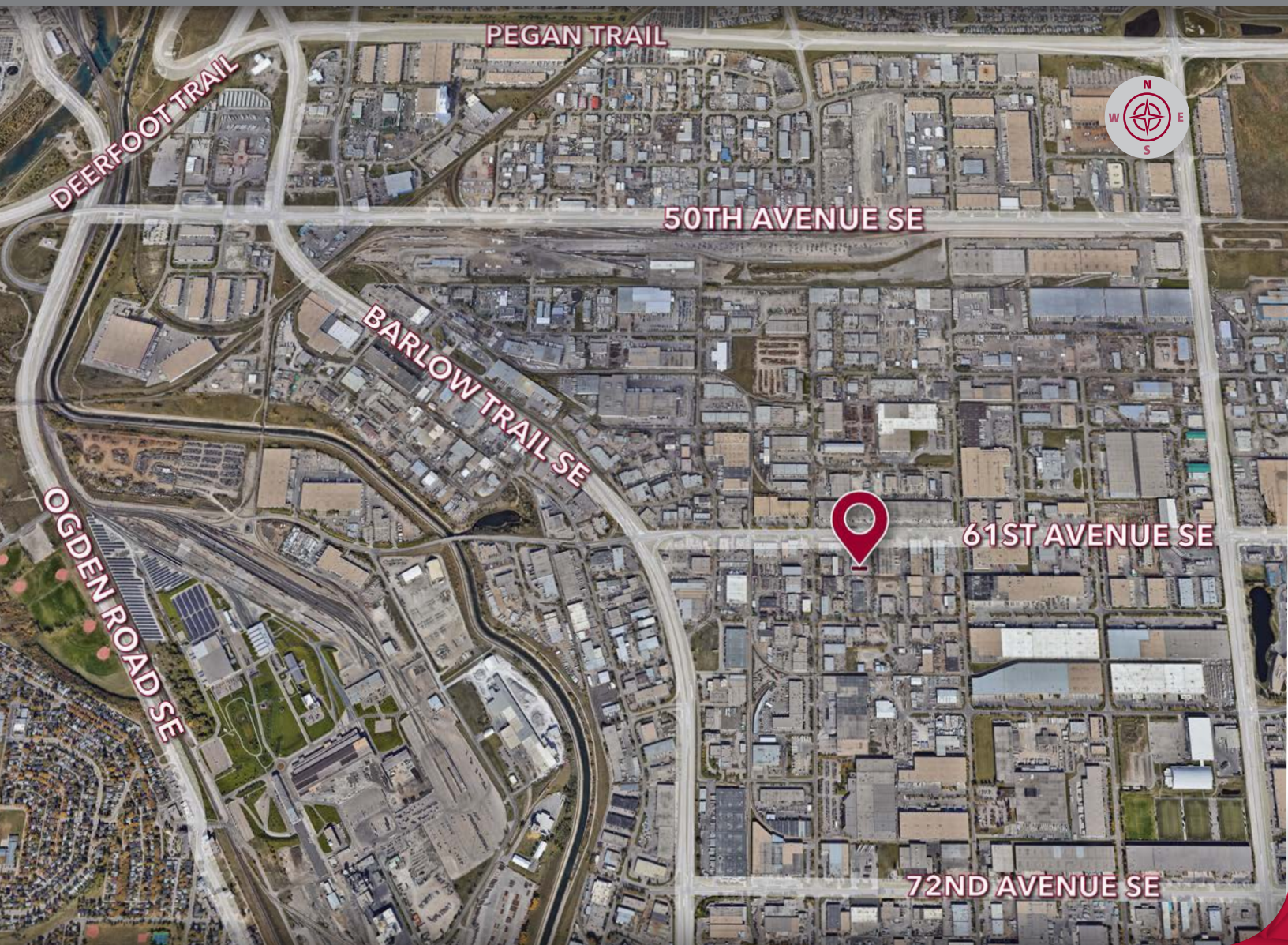

CONTACT US



JON C. MOOK, SIOR
PRESIDENT, MANAGING DIRECTOR
C: 403-616-5239
jmook@lee-associates.com



EMILY GOODMAN, B.COMM
VICE PRESIDENT, PRINCIPAL
C: 403-862-4348
egoodman@lee-associates.com

This brochure is for INFORMATION PURPOSES ONLY. There are no representations or warranties provided with respect to the information contained herein. Any prospective purchaser should take whatever steps they deem necessary or advisable to verify the accuracy or completeness of any information contained herein before relying on any such information. Prospective purchasers are cautioned to conduct their own due diligence.

117, 4950 - 106th Avenue SE | Calgary, AB T2C 5E9
lee-associates.com