

# Office Spaces | For Lease

**CBRE**

410 Saint-Nicolas Street  
Montreal (Quebec)

CBRE URBAN PROPERTIES | MONTREAL





# Lease Terms

Term	5 years
Additional Rent	\$13.00 per sq. ft. Base Year 2024
Net Rent	\$18.00 per sq. ft.
Tenant Improvement Allowance	TBD
Hydro / In-Suite Cleaning	Included
Availability	Immediate

# Floor Plans

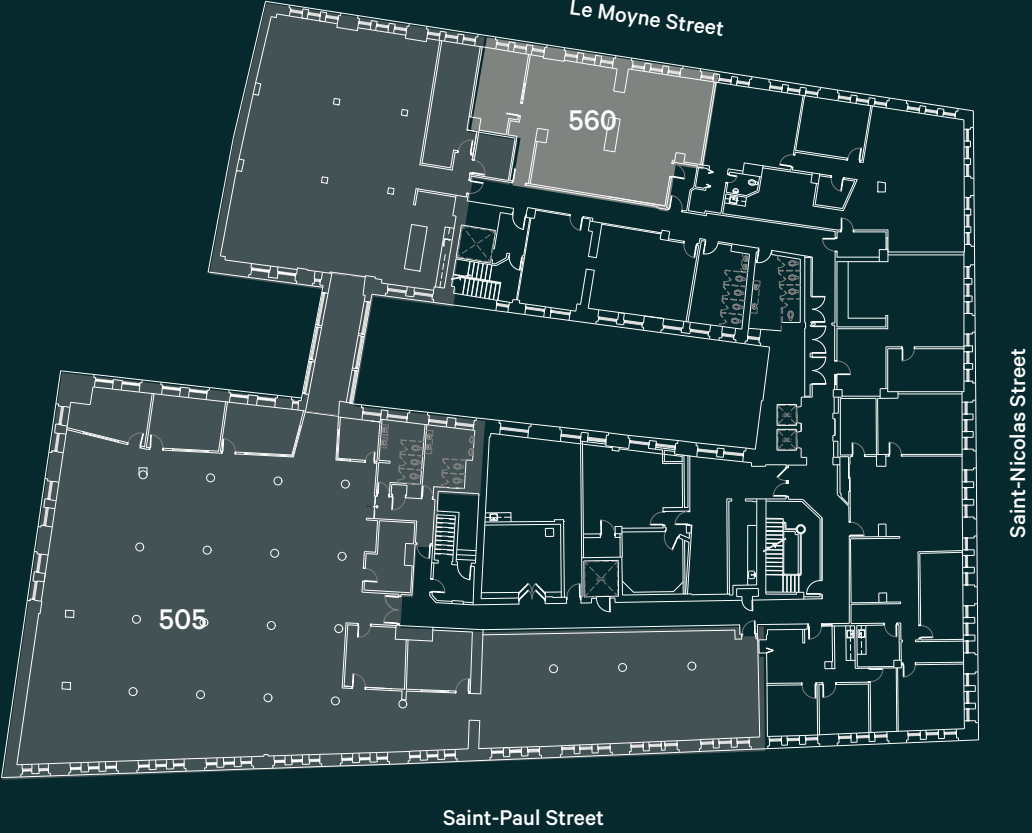

Suite	SQ. FT.
101	7,924
104	1,152
505	13,112
560	1,469
600	4,528
Possible private rooftop terrace	Full floor

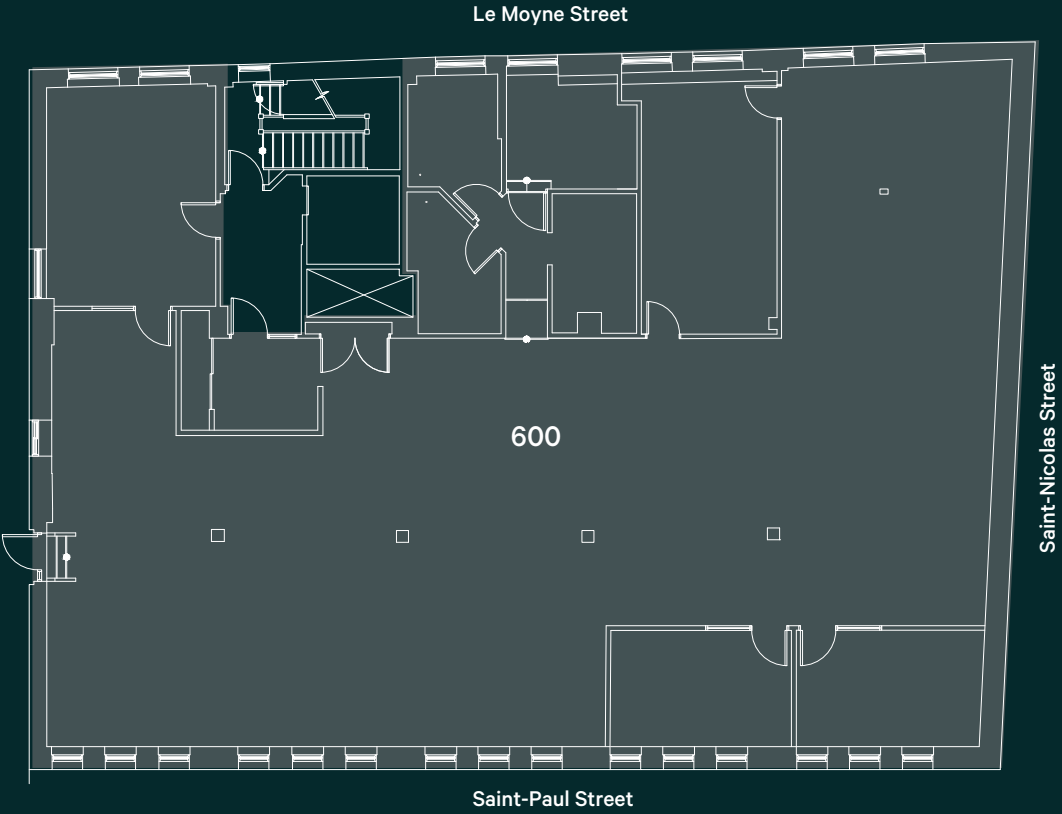



- 

Located on Saint-Nicolas Street between Saint-Pierre and Le Moyne streets
- 

The space benefits from natural light
- 

7-min walk to the Place-D'Armes metro station
- 

Numerous amenities located in close proximity
- 

Move in ready suites available

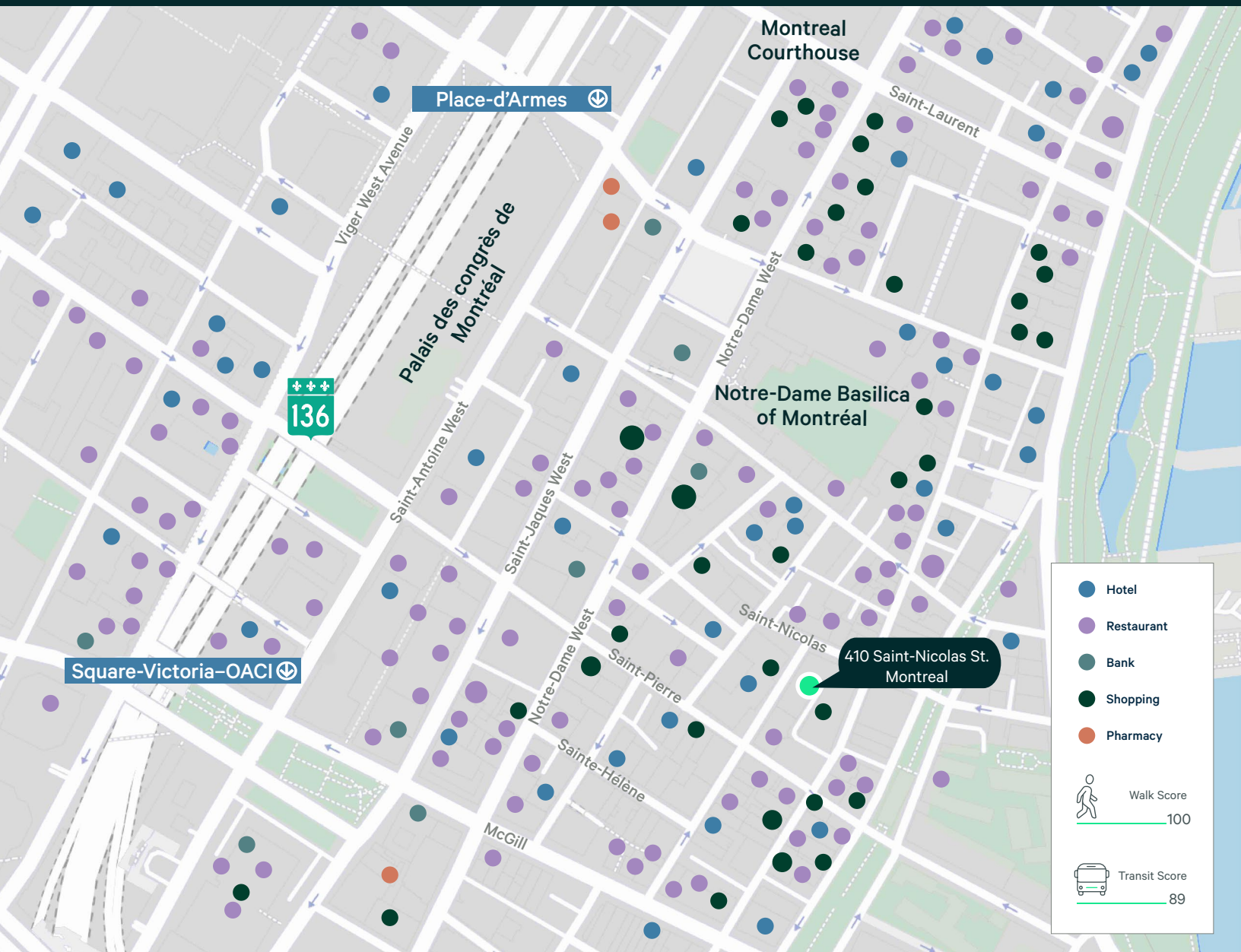

## Contact Us

**Christopher Rundle**  
Vice President  
Real Estate Broker  
+1 514 375 0818  
christopher.rundle@cbre.com

**Bryan Greenberg**  
Associate Vice President  
Commercial Real Estate Broker  
+1 514 375 2507  
bryan.greenberg@cbre.com

**Amanda Angela Herbu**  
Associate  
Commercial Real Estate Broker  
+1 514 375 0456  
amanda.herbu@cbre.com

CBRE Limited, Real Estate Agency | 1250 René-Lévesque Blvd West, Suite 2800 | Montréal, Québec H3B 4W8 | +1 514 849 6000 | [www.cbre.ca](http://www.cbre.ca)

This disclaimer shall apply to CBRE Limited, Real Estate Agency, and to all other divisions of the Corporation; to include all employees and independent contractors ("CBRE"). The information set out herein, including, without limitation, any projections, images, opinions, assumptions and estimates obtained from third parties (the "Information") has not been verified by CBRE, and CBRE does not represent, warrant or guarantee the accuracy, correctness and completeness of the Information. CBRE does not accept or assume any responsibility or liability, direct or consequential, for the Information or the recipient's reliance upon the Information. The recipient of the Information should take such steps as the recipient may deem necessary to verify the Information prior to placing any reliance upon the Information. The Information may change and any property described in the Information may be withdrawn from the market at any time without notice or obligation to the recipient from CBRE. CBRE and the CBRE logo are the service marks of CBRE Limited and/or its affiliated or related companies in other countries. All other marks displayed on this document are the property of their respective owners. All Rights Reserved. Mapping Sources: Canadian Mapping Services [canadamapping@cbre.com](mailto:canadamapping@cbre.com); DMTI Spatial, Environics Analytics, Microsoft Bing, Google Earth.