

# EXCELLENT ACCESS TO I-90 & SPOKANE AIRPORT



## FOR LEASE | OFFICE AND YARD

**2823 S CRAIG RD**  
**AIRWAY HEIGHTS, WA 99001**

### Property Details

Airway Heights is experiencing rapid growth, with a major contributing factor being its proximity to the Spokane/Coeur d'Alene area. This property offers convenient access to both I-90 and State Highway 2.

### Property Details

**Office Area: 1,344 SF**

**West Yard Area: 45,559 SF**

**East Yard Area: 178,076 SF**

- BNSF Access 375' Rail Spur

**OPEN  
LISTING  
FOR ALL  
BROKERS**

### Lease Rate

**\$5,455 / MO + NNN**

# FOR LEASE | OFFICE AND YARD

2823 S CRAIG RD | AIRWAY HEIGHTS, WA 99001

## FLOOR PLAN

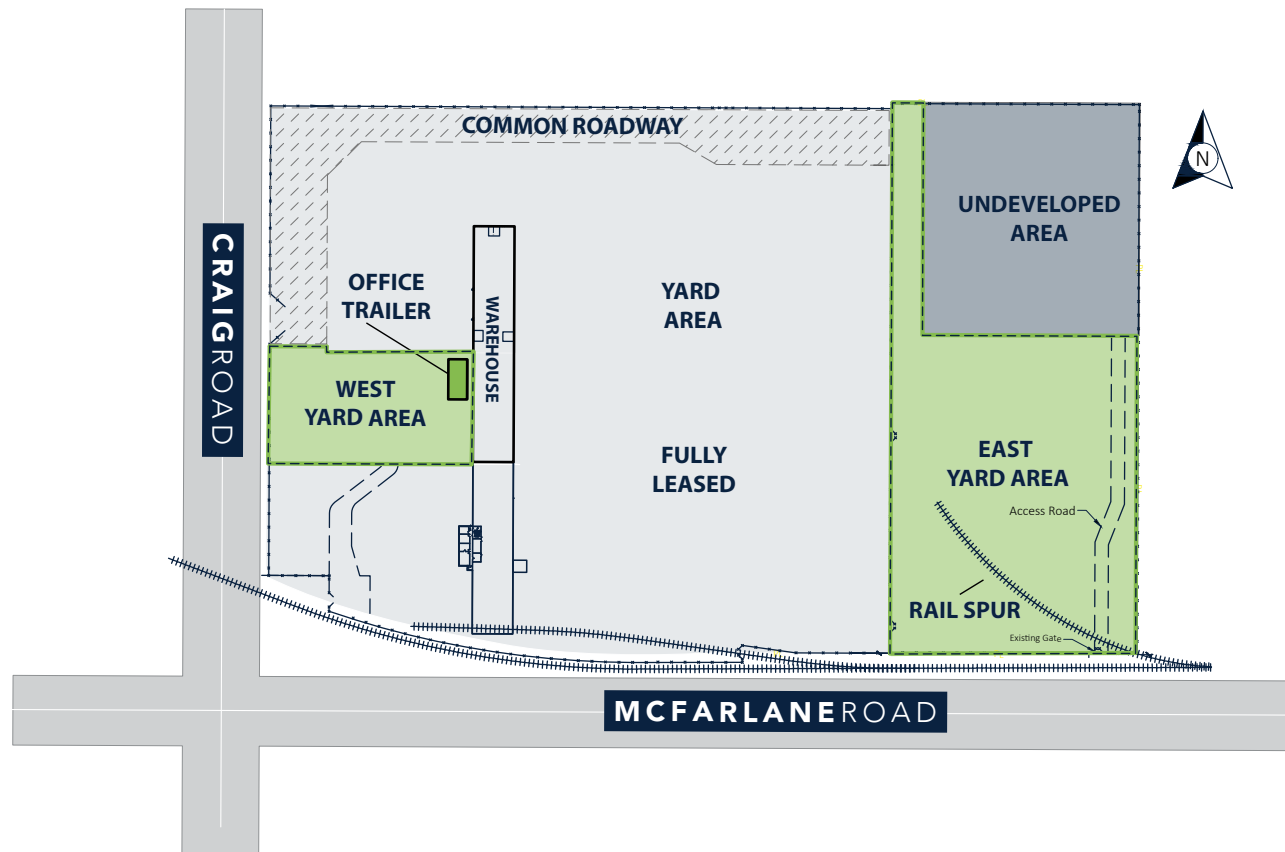



# FOR LEASE | OFFICE AND YARD

2823 S CRAIG RD | AIRWAY HEIGHTS, WA 99001

## MAP

