



Gas Tower

555 West 5th Street

Space
availability
summary

WeWork @ 555 West 5th Street
Los Angeles, CA

wework

36th Floor 27,240 RSF
35th Floor 27,240 RSF
34th Floor 27,240 RSF

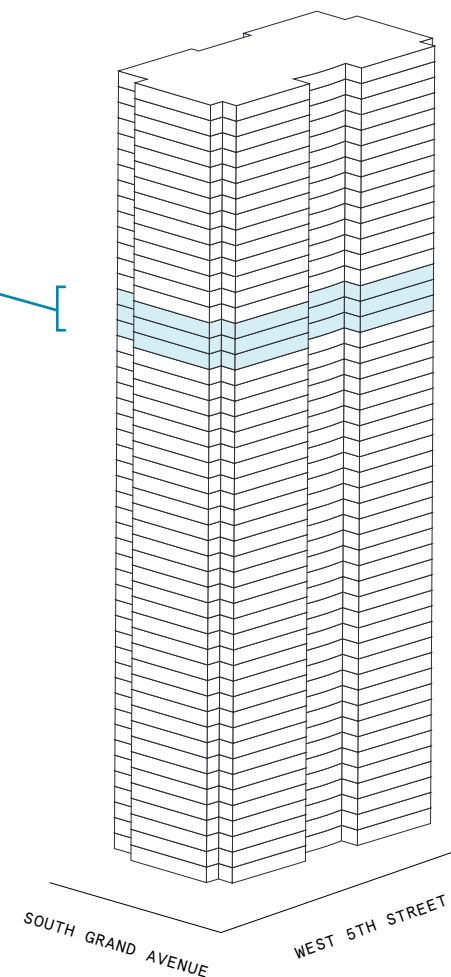
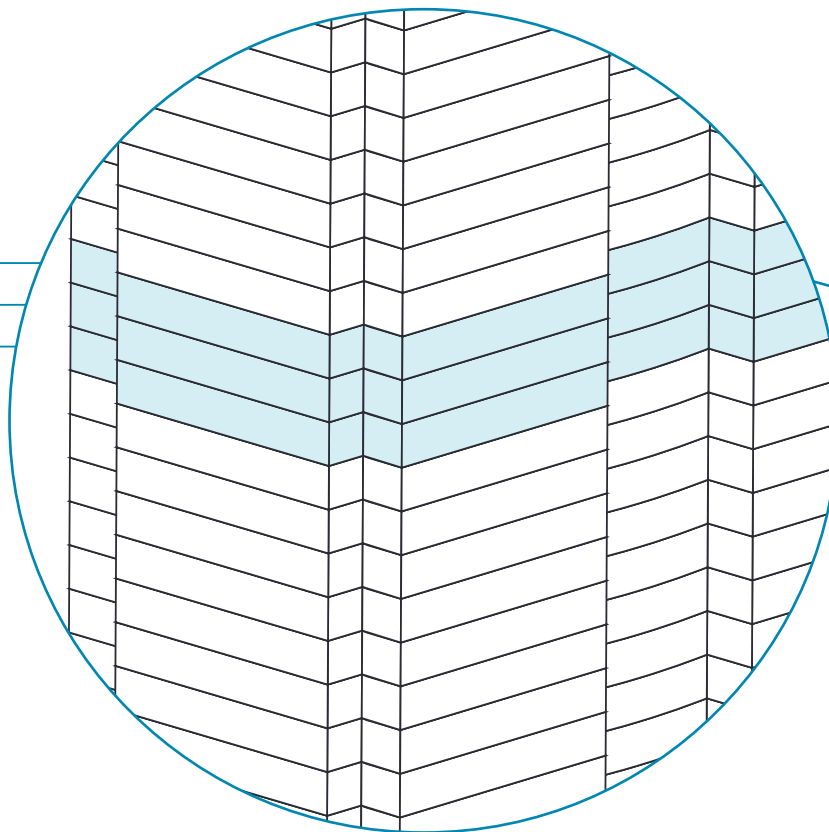

81,720 RSF

TOTAL WEWORK RSF

555 West 5th Street

At a glance

Workspaces designed for productivity and creativity with flexible size & term

Dedicated, private suites available from 58 to 1,682 RSF

Move-in ready suites - furnished & wired

50

TOTAL BUILDING FLOORS

1,338,507

TOTAL BUILDING SQ FT

All dimensions are approximate and subject to variances. It is your obligation to independently verify the particulars of the property. WeWork reserves the right to make changes.



Welcoming downtown workspace with panoramic views

The Gas Company Tower is an impressive Class-A tower in Bunker Hill that offers 360-degree views of LA's Financial District. Designed by Skidmore, Owings & Merrill and completed in 1991, this Energy Star and LEED Gold certified building won the 2014 BOMA 360 and 2011–2012 BOMA Regional Office Building of the Year award. WeWork's space spans three full floors in this expansive 50-story tower, housing a mix of sleek private offices, unique meeting spaces, and sun-soaked lounges.



Floor-to-ceiling windows and light hardwood floors add to the openness imparted by the building's high ceilings.



360-degree views of downtown LA serve as a striking backdrop for thoughtful yet minimal design touches and a light, airy palette.

Refined glamour and bold creativity

555 West 5th Street embodies downtown LA's passion for art, music, and all forms of creativity. Unique to the building are its use of glass elements in windows, mirrors to create bright, airy open spaces. Beautiful transitional areas, arches and painted ceilings add pops of character and color to the office, while minimalist art and décor create an elegant, calming atmosphere.

- Metallic accents and modern light fixtures bring industrial-chic appeal to colorful common spaces
- The common areas are expansive with extra-high ceilings, floor-to-ceiling windows, and glass accents
- A central atrium staircase is surrounded by windows, providing a striking focal point with breathtaking views

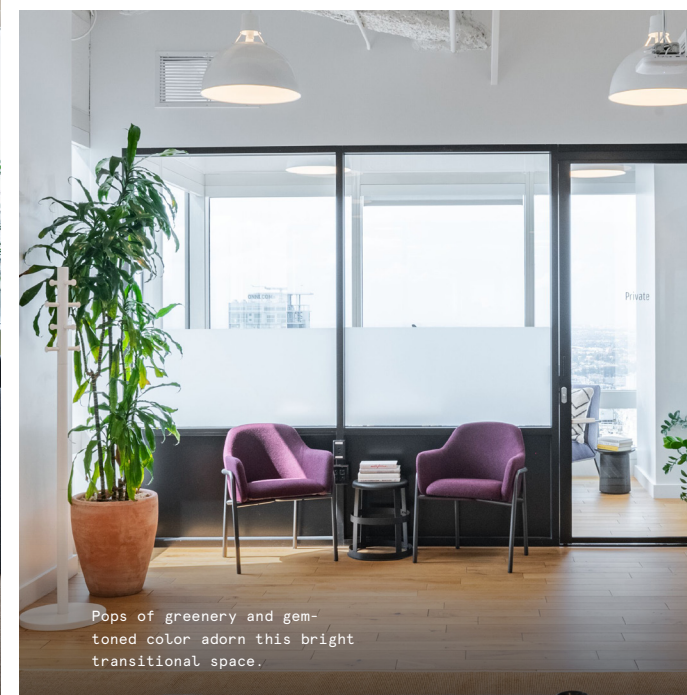
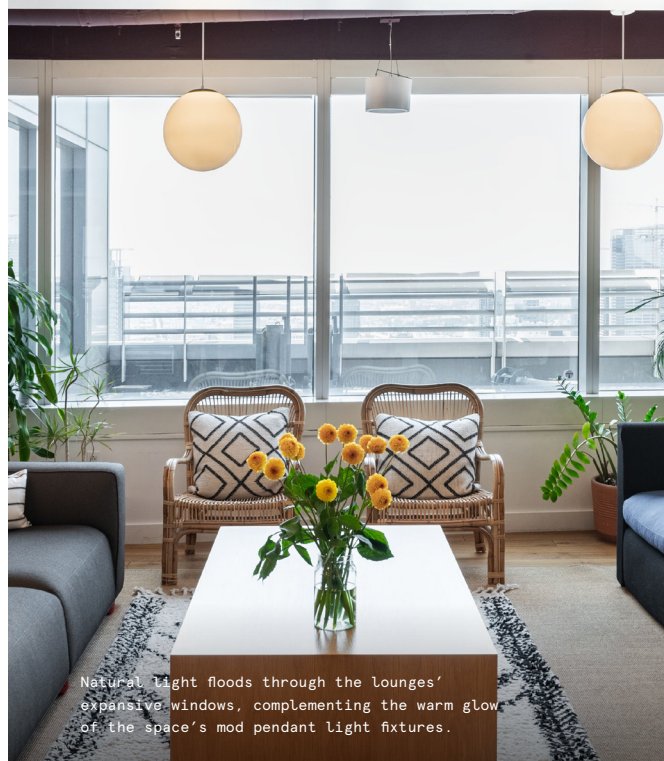
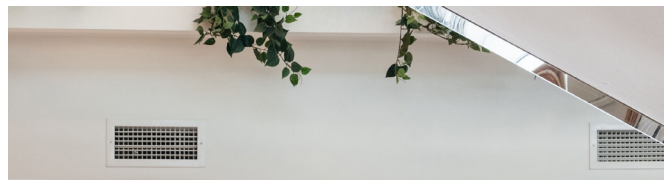



On-site amenities

- 24/7 security
- Electronic keycard access
- Web-based visitor access
- Business-class printers
- Professional events and programming
- Stocked pantry



- Messenger center
- US mail drop
- On-site staff
- Meeting rooms
- Phone booths
- Wellness/meditation room
- Classroom space
- Recreational Games
- Dog-friendly spaces
- Bicycle storage
- On-site parking
- Access to car charging station
- Emergency back-up power
- Supplemental HVAC and electric

Building specifications



Hours of operation

Monday - Friday: 8am-5pm



Security

24/7 attended lobby
24/7 CCTV monitoring



HVAC

Monday - Friday: 8am-6pm
Saturday: 9am-1pm



Building history

Built in 1991
Designed by Skidmore, Owings
and Merrill
Developed by Maguire Properties



Elevators

6 passenger elevators
with a capacity of 4,000 lbs
2 freight elevator
with a capacity of 4,000 lbs



Fire strategy

Fully-sprinklered floors



Building size

50 stories
1,338,507 SF





Certifications

LEED Gold certified
Energy Star certified

Experience the best of Bunker Hill

Situated in downtown LA's Bunker Hill neighborhood, 555 West 5th Street lets members experience all this central location has to offer. This area is known for its bars, restaurants, and hotels—local favorites include the nearby food stalls of Grand Central Market and Perch's rooftop dining. For those seeking after-work outings, the Broad Museum, Walt Disney Concert Hall, Pershing Square, Staples Center, and the LA Public Library are all within a few block radius. Commuting is also easy with on-site parking and bike storage, the Pershing Square Station just two blocks away, and direct access to the 10, 110, and 101.

Distance to WeWork

Gas Company Tower Parking Lot	 Walk	1 min
Pershing Square Parking Lot	 Walk	2 min
Pac Mutual Parking Lot	 Walk	3 min
7th Street/Metro Center	 Walk	5 min

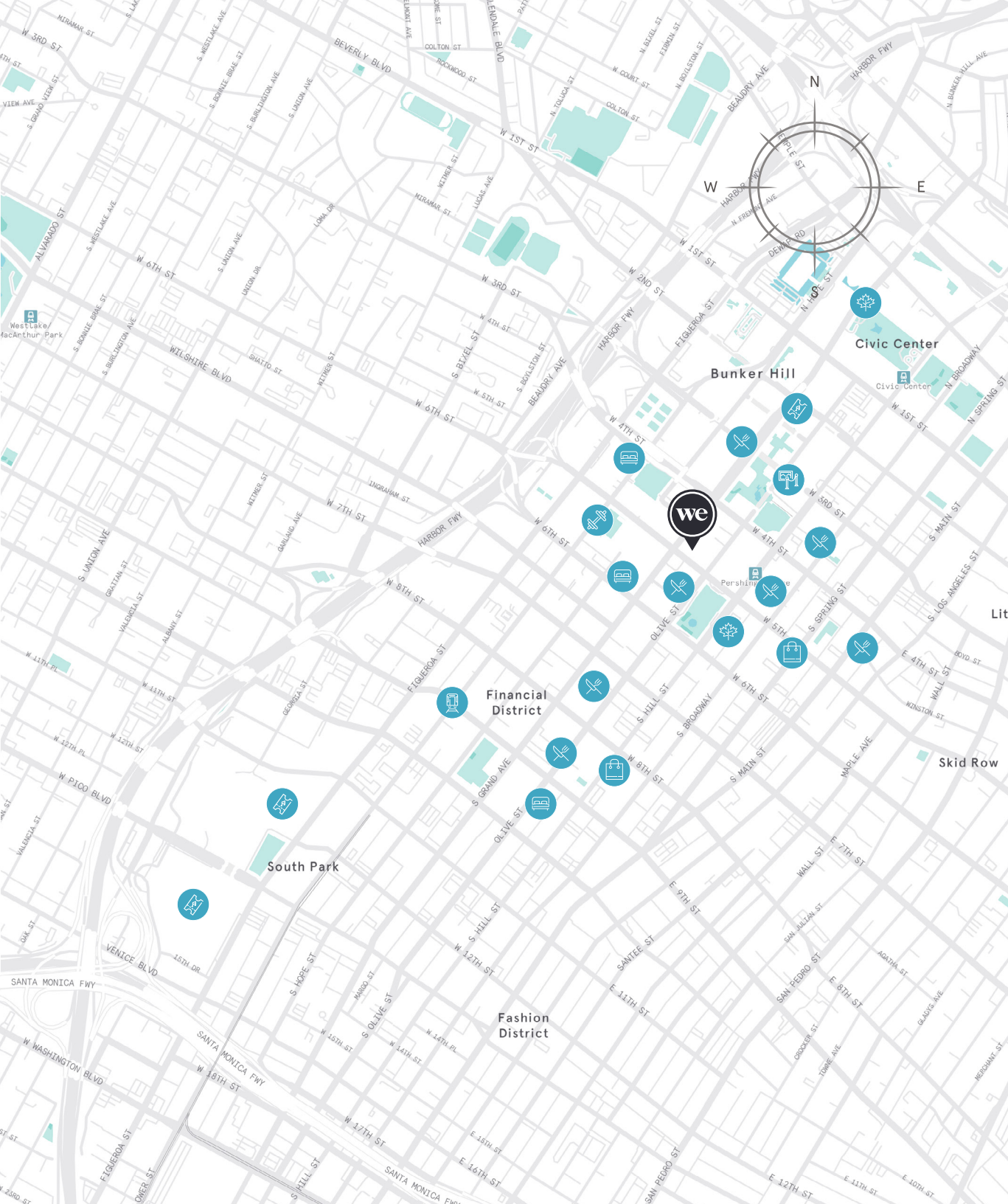

34th Floor

24,278 RSF





10

MEETING ROOM(S)

5

SHARED WORKSPACE(S)

LEGEND

-  MEETING ROOM
-  SHARED WORKSPACE
-  DEDICATED SPACE

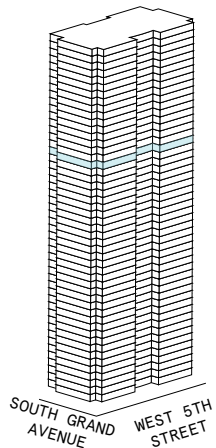

34th Floor

24,278 RSF

24,278 RSF Suite 34-100

10

MEETING ROOM(S)

1

PRIVATE OFFICE(S)

LEGEND

 DEDICATED SPACE

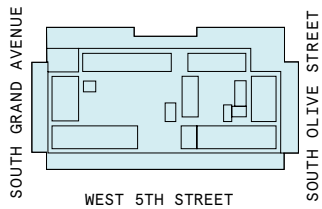

35th Floor

27,240 RSF





9

MEETING ROOM(S)

7

SHARED WORKSPACE(S)

LEGEND

-  MEETING ROOM
-  SHARED WORKSPACE
-  DEDICATED SPACE

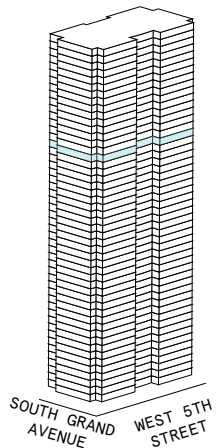

35th Floor

27,240 RSF

27,240 RSF Suite 35-100

9

MEETING ROOM(S)

7

PRIVATE OFFICE(S)

LEGEND

 DEDICATED SPACE

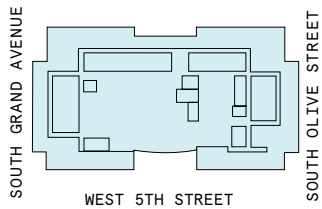

36th Floor

27,240 RSF





10

MEETING ROOM(S)

9

SHARED WORKSPACE(S)

LEGEND

-  MEETING ROOM
-  SHARED WORKSPACE
-  DEDICATED SPACE

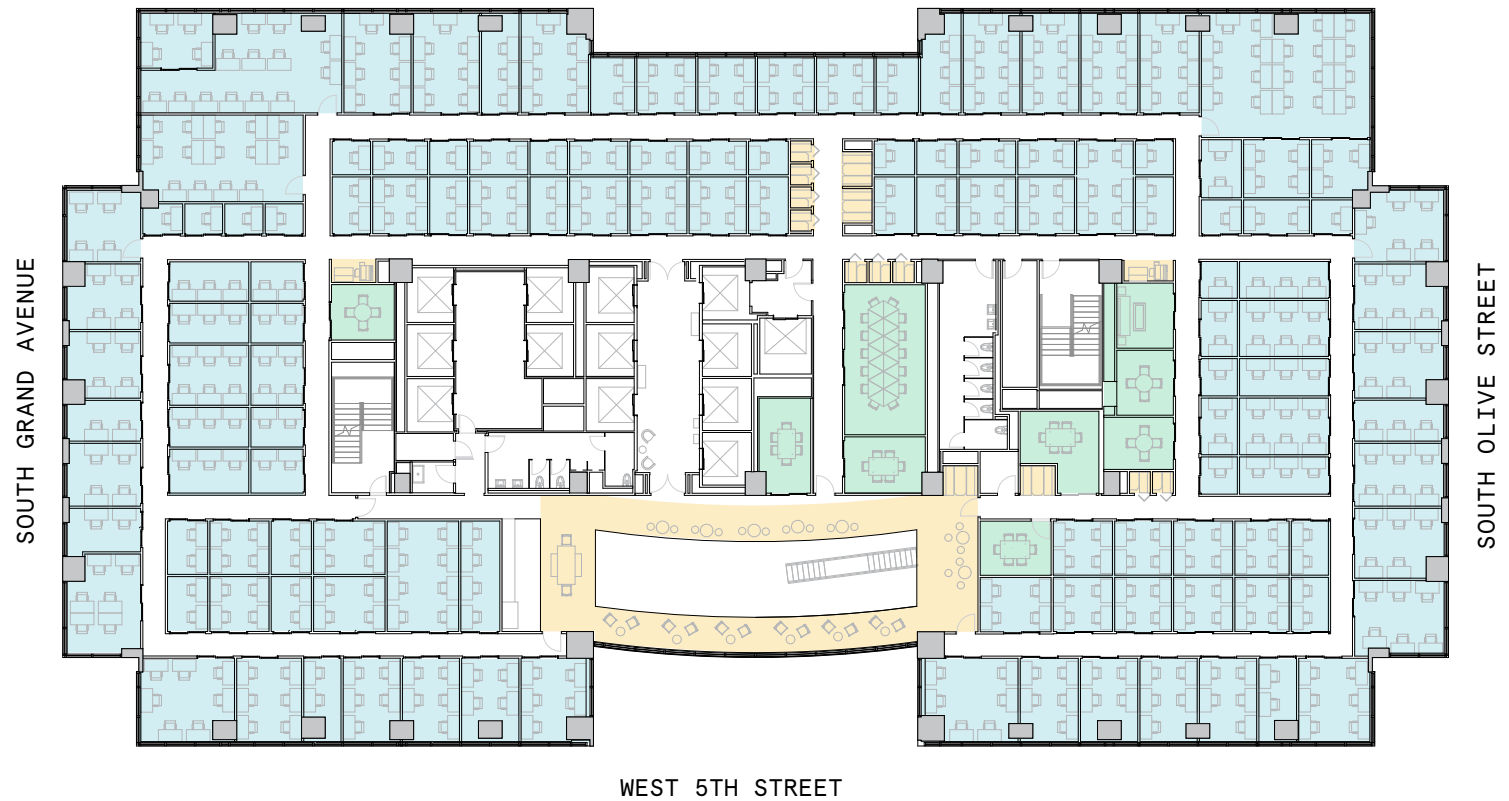
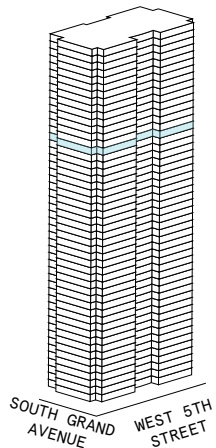

36th Floor

27,240 RSF

27,240 RSF Suite 36-100

10
MEETING ROOM(S)

1
PRIVATE OFFICE(S)

LEGEND

 DEDICATED SPACE

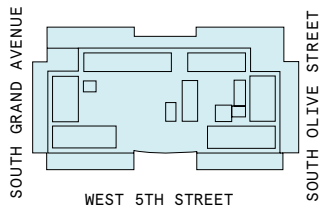
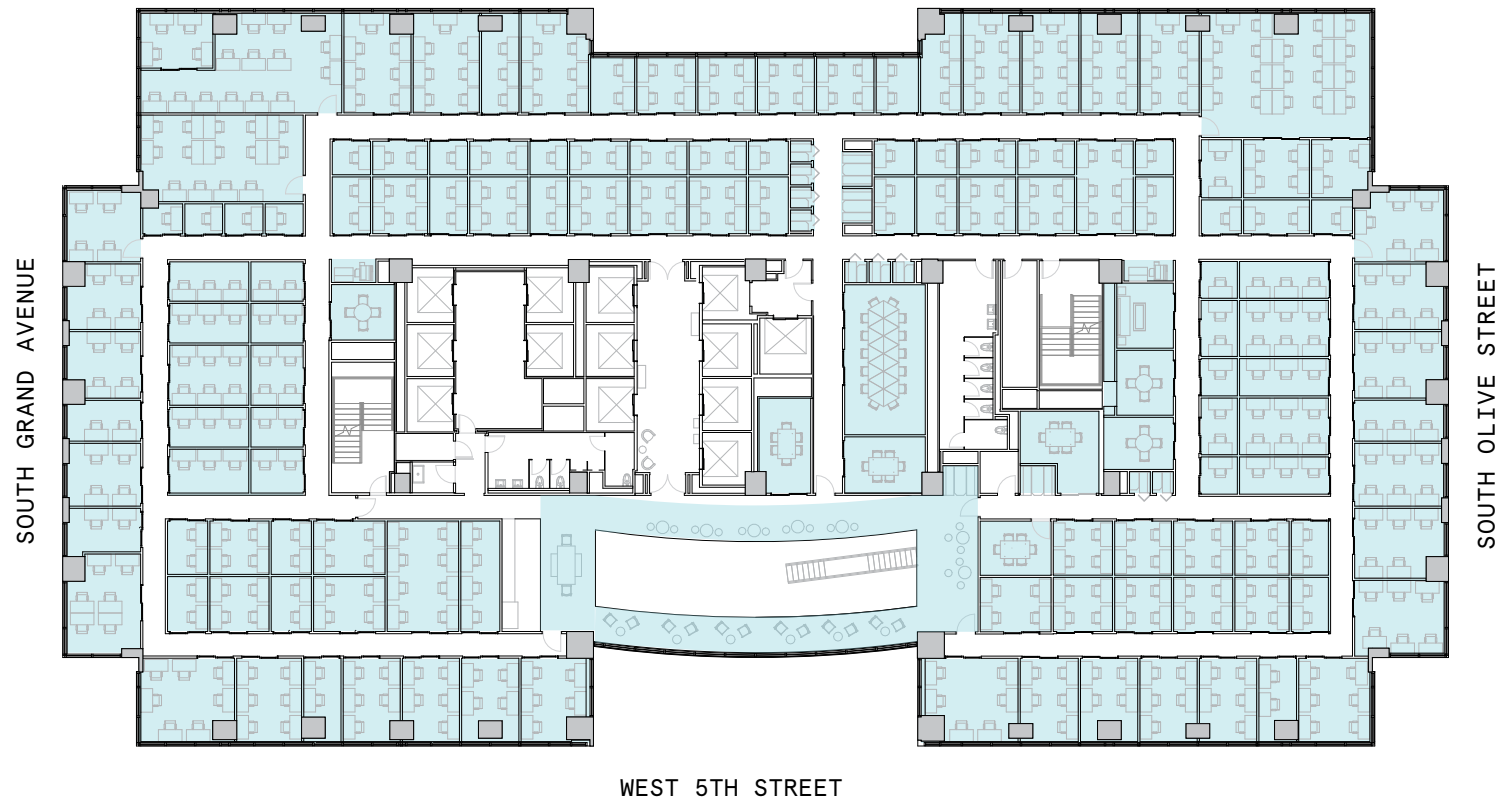

Contact

For leasing inquiries please
reach out to our team.



James Berner

LEASING DIRECTOR
JAMES.BERNER@WEWORK.COM
818.389.9453

Lara Chengappa

LEASING MANAGER
LARA.CHENGAPPA@WEWORK.COM
412.818.1080

© 2022 WeWork. The WeWork trademark and related logos are the property of WeWork Companies LLC. Any reference to third-party names are for reference and informational purposes only and should not be considered an endorsement or association of WeWork or vice versa. Photographs contained herein may be representative examples of various WeWork locations and do not necessarily depict the WeWork location referenced. While reasonable efforts have been made to check the accuracy of the information contained here, WeWork, its officers, employees, directors, and representatives, make no warranty, express or implied, regarding the accuracy of the information and disclaim any liability arising from the use of the information contained herein. All dimensions are approximate and subject to variances. It is your obligation to independently verify the particulars of the property. WeWork reserves the right to make changes.