

184 FIFTH AVENUE

BETWEEN WEST 22ND & 23RD STS

Full Floor Presence Overlooking
Madison Square Park

➤ Entire 6th Floor: 3,845 rsf

Steps from **R** **W** the subway station and
NJ  train; and 7 minute walk to Union
Square's transit hub with access to
4 **5** **6** **N** **Q** **R** **W** **L** express and local lines



Furniture shown for layout concept only



ENTIRE 6TH FLOOR 3,845 RSF

Bright floor with an open plan layout featuring hardwood floors throughout, a glass-front conference room, two glass-front office/collaboration rooms, large open area, oversized full wet pantry with seating area, phone room, and ADA accessible men's and women's restrooms. Steps from Madison Square Park, a wide variety of restaurants and retail at your doorstep, and five blocks from Union Square Park and Green Market



Furniture shown for layout concept only

✓ Rent: Upon request

✓ Possession: June 1, 2026



East View of Madison Square Park



ENTIRE 6TH FLOOR

3,845 RSF (TEST-FIT)

[Click to view Virtual Tour](#)

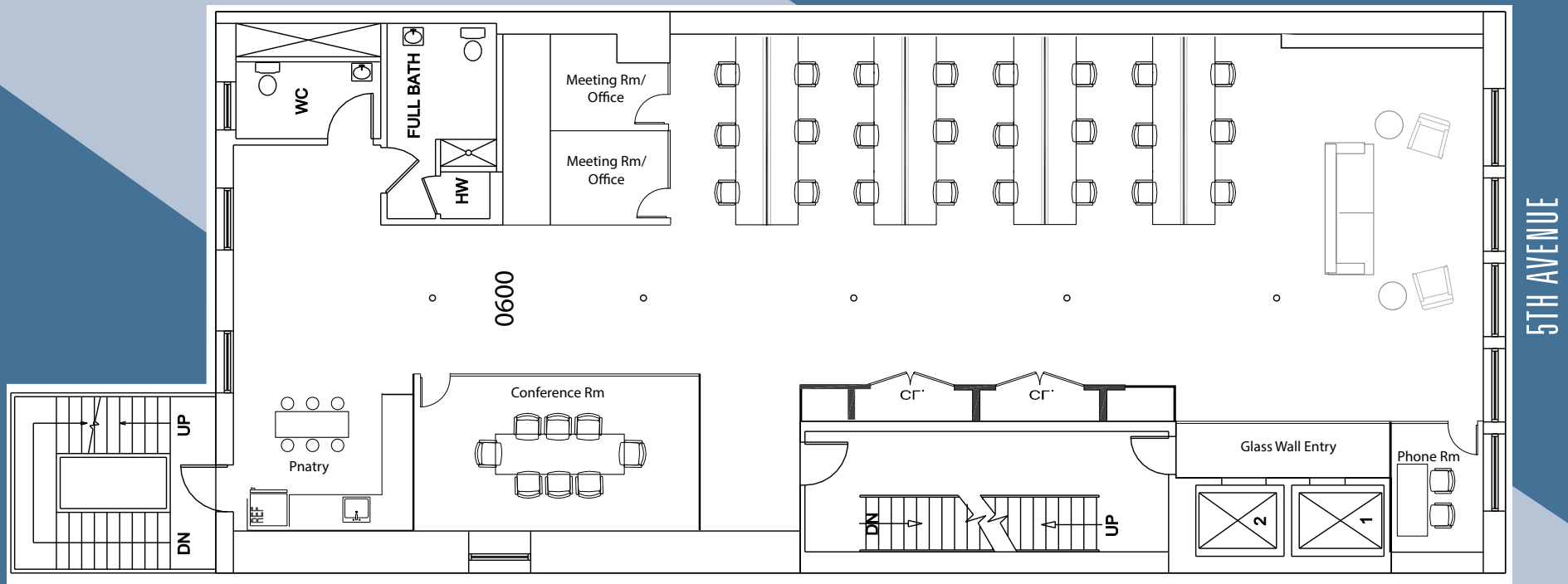

(Floor plan for descriptive purposes only; not to scale. Furniture shown for layout concept only)

FEATURING

- ✓ Open Layout - Exposed Ceiling
- ✓ Hardwood Floor Throughout
- ✓ Glass-Front Conference Room
- ✓ Wet Pantry with Seating Space
- ✓ Two Sides of Natural Light
- ✓ East and West Exposure
- ✓ Tenant-Controlled A/C
- ✓ 24/7/365 Card-key Secure Access

GREEN SPACE AT YOUR DOORSTEP

Elevate your workday with a relaxing lunch outdoors, or a breath of fresh air surrounded by lawns, fountains and trees! Enjoy a variety of evening park activities with seasonal scheduling and art displays throughout the year

Madison Square Park



For further information and/or inspection contact:

Daria Ghasemi

Associate

Licensed Real Estate Salesperson

816.654.2212 (c) | dghasemi@absre.com

Ben Waller

Partner

Licensed Associate Real Estate Broker

212.400.9515 | bwaller@absre.com

Zoe Snow

Associate

Licensed Real Estate Salesperson

303.877.4693 (c) | zsnow@absre.com

ABS Partners Real Estate • 200 Park Avenue South, 10th Floor, New York, NY 10003 • 212.400.6060 • www.absre.com