



Colliers

INDUSTRIAL FLEX | FOR LEASE



Springville Freeway Flex Building with Land

909 N 2000 W | Springville, UT

Property Information

- 5,201 SF, Main Building
- 1,405 SF Shed with Water and Power
- 1,217 SF Storage Shed
- 2+ Acre Lot (Additional Acreage Available)
- Freeway visibility with large frontage sign
- Zoning: Highway Commercial
- Lease Rate: \$9,400 MO / NNN

Contact:

Justin Irvine

Vice President
+1 801 400 4260
justin.irvine@colliers.com

James Yeates

Vice President
+1 801 995 0049
james.yeates@colliers.com

Colliers

2100 Pleasant Grove Blvd., Suite 200
Pleasant Grove, UT 84062
Main: +1 801 947 8300
colliers.com

Accelerating success.

Floor Plan & Property Overview

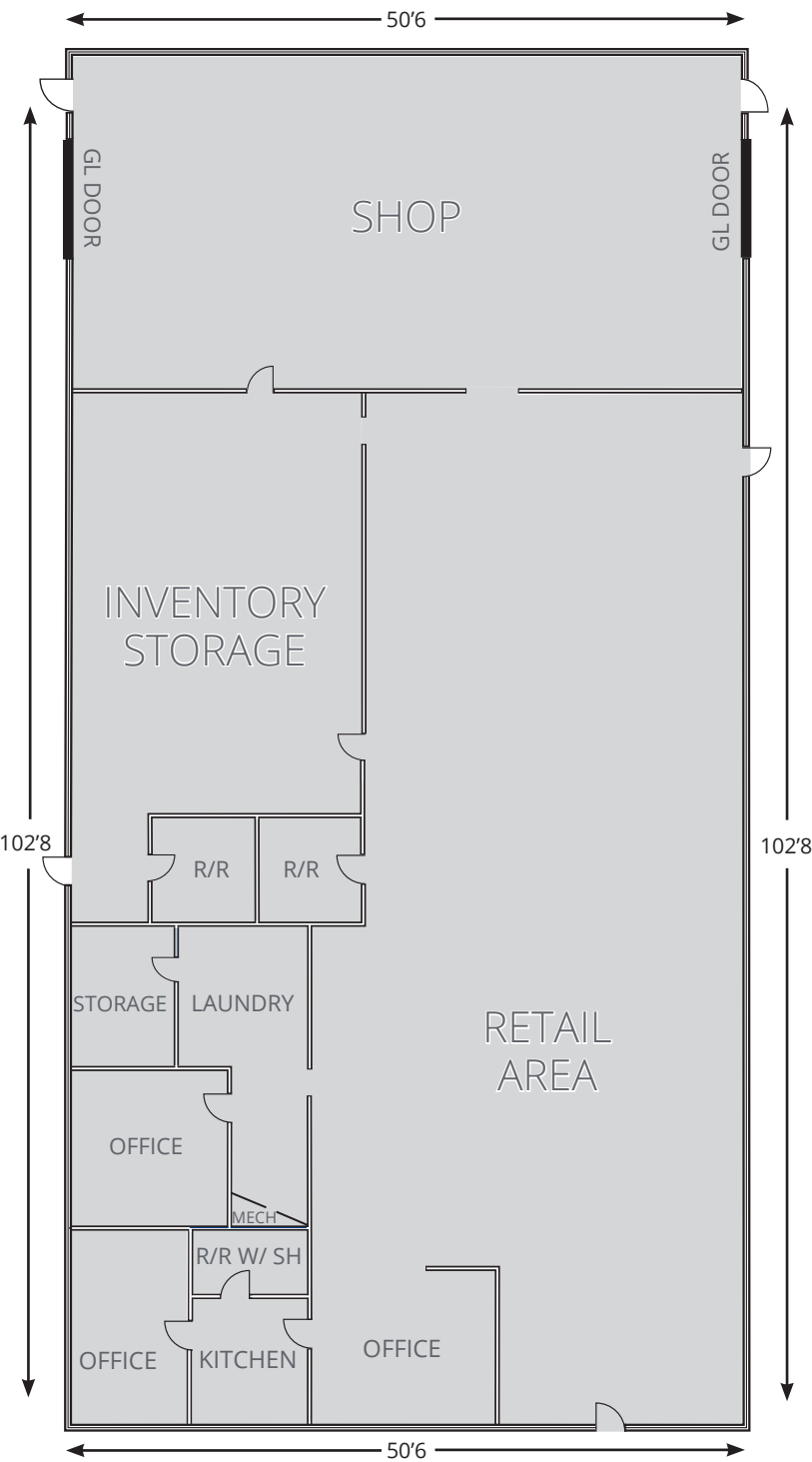

Aerial Map

Springville Flex Building | For Lease



Colliers

2100 Pleasant Grove Blvd., Suite 200
Pleasant Grove, UT 84062
Main: +1 801 947 8300
colliers.com

Justin Irvine

Vice President
+1 801 400 4260
justin.irvine@colliers.com

James Yeates

Vice President
+1 801 995 0049
james.yeates@colliers.com

This document has been prepared by Colliers International for advertising and general information only. Colliers International makes no guarantees, representations or warranties of any kind, expressed or implied, regarding the information including, but not limited to, warranties of content, accuracy and reliability. Any interested party should undertake their own inquiries as to the accuracy of the information. Colliers International excludes unequivocally all inferred or implied terms, conditions and warranties arising out of this document and excludes all liability for loss and damages arising there from. This publication is the copyrighted property of Colliers International and/or its licensor(s). ©2025. All rights reserved.