

INDUSTRIAL CONDOMINIUMS FOR SALE



TUPELO COVE

75 Tupelo Street, Bristol, RI 02809

WHITNEY RUGG

Sales Associate
401.751.3200 x3302
whitney@mgcommercial.com

LEEDS MITCHELL IV, SIOR

Principal Broker, Partner
401.751.3200 x3307
leeds@mgcommercial.com

MG COMMERCIAL

365 Eddy Street, Penthouse Suite
Providence, RI 02903
401.751.3200 | mgcommercial.com

PROPERTY SUMMARY

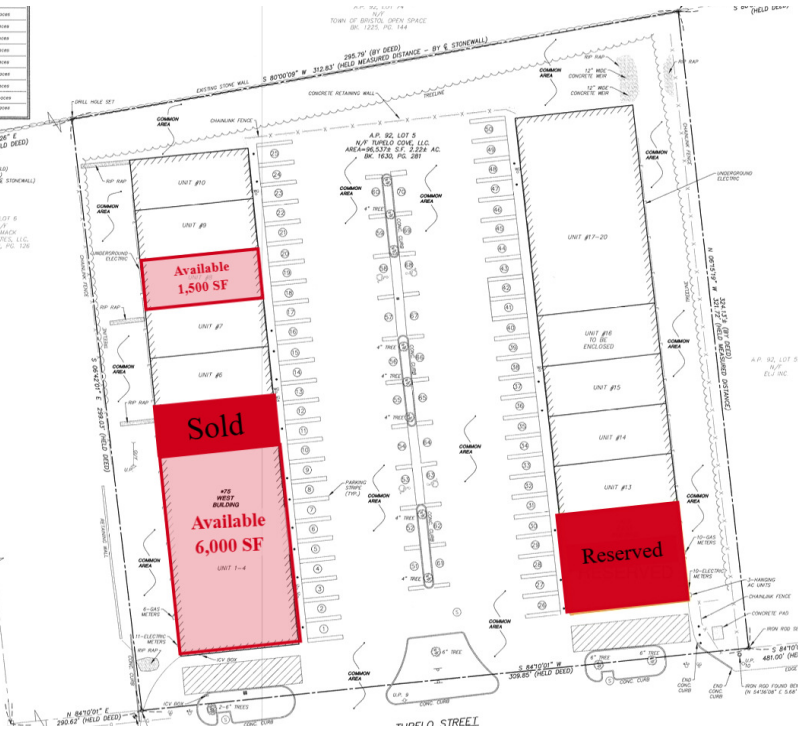

PROPERTY DESCRIPTION

Constructed in 2014, Tupelo Cove is a first-class commercial/tradesman park consisting of two (2), 15,000 SF buildings. Each unit has a 14' w x 16' h drive in door and is separately metered for gas and electricity. Currently available are a 1,500 SF unit with a drive-in door and a 6,000 SF unit with 4 drive-in doors.

PROPERTY HIGHLIGHTS

- Modern, meticulously maintained park
- One (1) drive-in door/1,500 SF
- Flexible size options available
- Each unit separately metered for gas and electricity (3 phase, 120/208V)

WHITNEY RUGG
Sales Associate
401.751.3200 x3302
whitney@mgcommercial.com

LEEDS MITCHELL IV, SIOR
Principal Broker, Partner
401.751.3200 x3307
leeds@mgcommercial.com



LOCATION DESCRIPTION

Tupelo Cove is ideally situated between Route 114 & 136 in Bristol, RI and is located adjacent to the Bristol Industrial Park which is home to many cutting edge manufacturing companies. Easy access to all points in the East Bay and minutes to Aquidneck Island, Tupelo Cove is an ideal setting for tradesmen, artisans and craftsmen.

OFFERING SUMMARY

Sale Price:	\$337,500 - \$1,350,000
Number of Units Available:	2
Square Footage Available:	1,500 - 6,000 SF
Lot Size:	93,608 SF
Building Size:	30,000 SF

365 Eddy Street, Penthouse Suite
Providence, RI 02903
mgcommercial.com

