

PRINTED

1	12-1-09 Construction / Permit
2	02-20-10 Permit Comments
3	REV 2 4-20-10 BLDG COMMENT
4	6-18-10 REV 3
5	
6	

REVISIONS

1	Permit Comments
2	DETAIL 11/A1.7
3	OWNER COORDINATION
4	
5	
6	

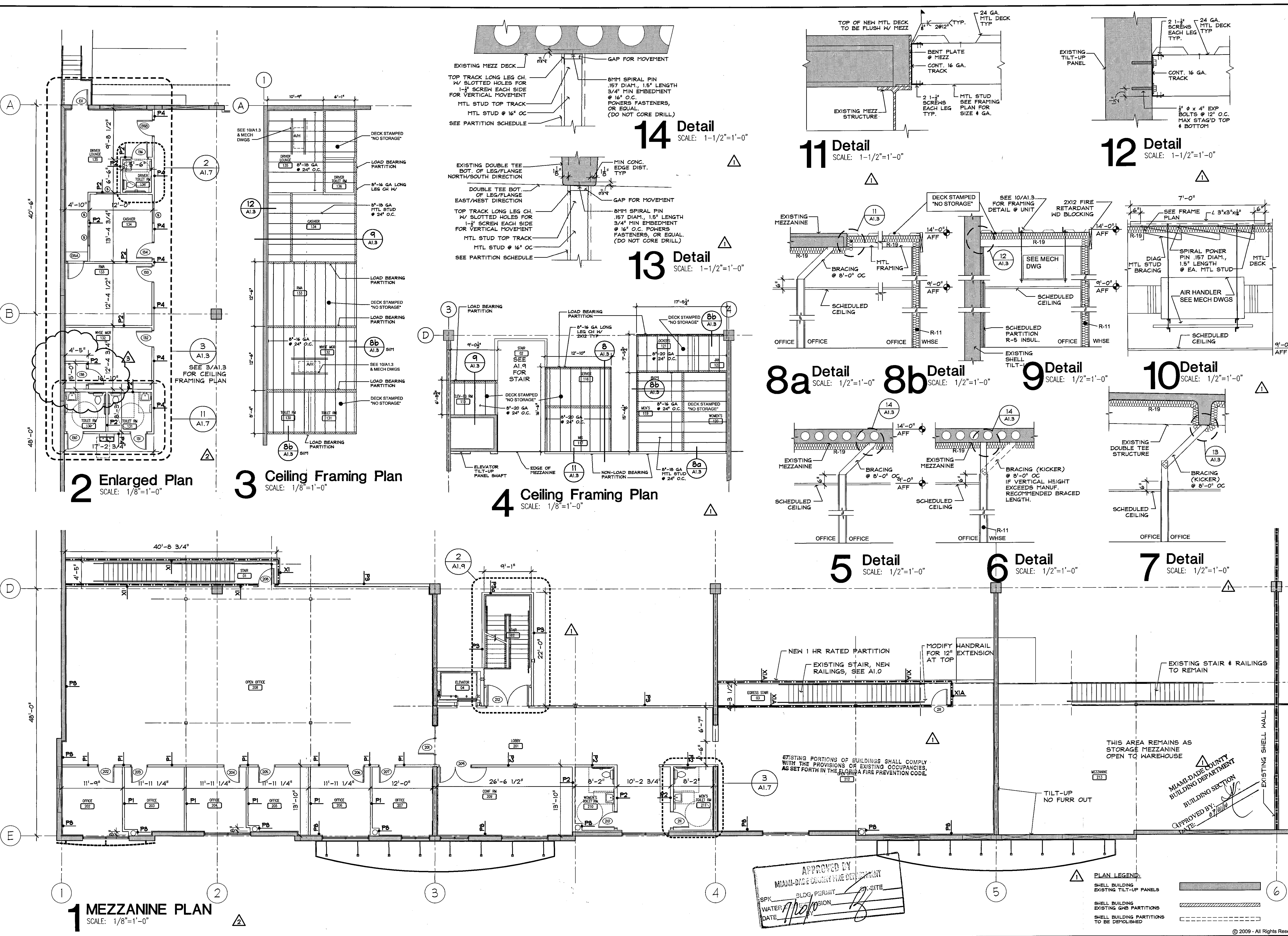

APPROVED BY
 MIAMI-DADE COUNTY FIRE DEPARTMENT
 BLDG PERMIT
 SPK
 WATER
 DATE 7/12/10

PLAN LEGEND:

- SHELL BUILDING EXISTING TILT-UP PANELS
- SHELL BUILDING EXISTING GWS PARTITIONS
- SHELL BUILDING PARTITIONS TO BE DEMOLISHED

STAR
 2201 NW 115th AVE - Suite 101
 MIAMI, FL
 Dolphin Commerce Center, Phase 2

Joseph V. Belluccia, AIA
 JUN 21 2010
 FL REG AR92396

I CERTIFY TO THE BEST OF MY KNOWLEDGE THAT THE DRAWINGS & SPECIFICATIONS COMPLY WITH THE APPLICABLE MINIMUM BUILDING CODES

JOB NO : 08023
 DRAWN BY : RES
 ISSUE DATE : 12-1-09

SHEET TITLE:
 SECOND FLOOR PLAN
SHEET NUMBER
 A13