



FOR LEASE

2,036 SF of Retail/Office/Flex, corner unit

701 16th Street, San Diego, CA 92101



PROPERTY HIGHLIGHTS

- ◆ Iconic Snowflake Bakery Building
- ◆ +/- 30,000 Square Feet class B Building
- ◆ 15,485 SF lot
- ◆ Full Remodel
- ◆ 4 Parking spaces @ \$100 per space
- ◆ Prime East Village / Makers Quarter Location
- ◆ Easy Access to I-5 and CA-94
- ◆ APN 535-180-26-00
- ◆ Excellent Signage
- ◆ Ground Floor Retail/Office
- ◆ Private Restrooms
- ◆ Seismic Retrofit

LEASE RATE

- ◆ \$2.25 PSF + Utilities



701 16TH



BLOCK D



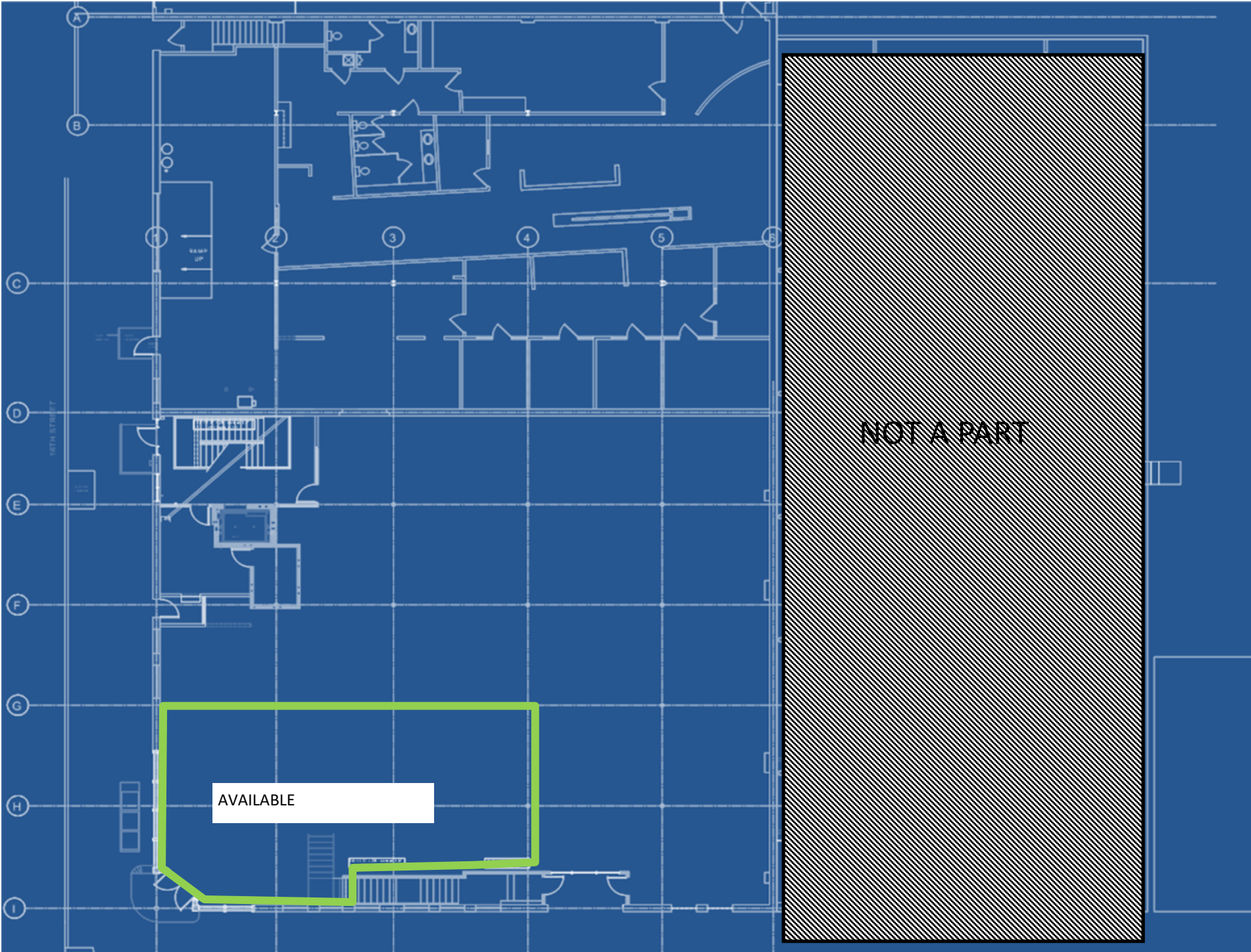

AVAILABLE

NOT A PART

DEMOGRAPHICS

9 2 10 1

80,000

WORK DOWNTOWN

20 MIN.

AVERAGE COMMUTE

31%

MILLENNIAL WORKFORCE SPACES

7

INCUBATORS/ACCELERATORS

8+

COWORKING SPACES

90+

ART/CULTURAL GROUPS

1 IN 5

WALK TO WORK

85%

EXERCISE 3+ DAYS/WEEK

51%

COLLEGE GRADUATES

110

STARTUPS





Peter Wright
Lic. #01846272
(619) 243-8450
pwright@qfcre.com

1495 Pacific Highway, Suite 450 San Diego, CA 92101 | (619) 243-8454 | www.qfcre.com

The information contained herein has been obtained from sources considered to be reliable, but no guarantee of its accuracy is made by this company. In addition, no representation is made respecting zoning, condition of title, dimensions, or any matters of a legal or environmental nature. Such matters should be referred to legal counsel for determination. Terms and conditions are subject to change without prior notice. Subject to errors and omissions.