

SUNSET POINTE
1230-1240 SUNSET BLVD
ROCKLIN, CA
FOR LEASE
1,205 SF - 2,889 SF RETAIL SUITES

ETHAN CONRAD
PROPERTIES INC.



COMPLETELY REMODELED

FOR MORE INFORMATION CONTACT:

Chase Burke
DRE: #01879336
chase@romecre.com
916-705-8132

Andy Jonsson
DRE: #02076108
andy@romecre.com
916-813-8409

ROME
REAL ESTATE GROUP

VIEW VIRTUAL TOUR

916.779.1000

ETHAN CONRAD PROPERTIES, INC.

1300 NATIONAL DRIVE, SUITE 100 | SACRAMENTO CA, 95834 | FAX: 916.779.1200
www.ethanconradprop.com

FEATURES

- Easy access from Sunset Boulevard/Hwy 65 interchange.
- At signalized intersection of Sunset Boulevard and West Oaks Boulevard.
- Center is strategically located to attract customers from surrounding commercial, industrial, office & residential traffic generators.

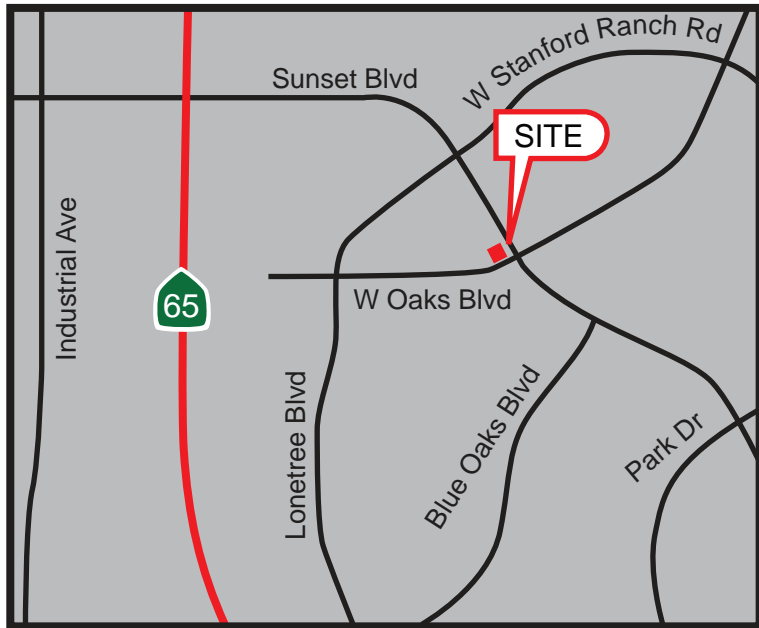

PROPERTY DETAILS

Major employers in the trade area are Oracle, Stanford Ranch Business Park and United Natural Foods, Esurance, William Jessup University (Over +1,200 students).

Rocklin offers a high quality of life with excellent schools and a well-planned, community. Surrounded by several residential communities and developments.

LEASE RATE

1230 SUNSET BLVD:
 Suite 300 1,679 SF \$2,854.00, NNN (\$1.70 PSF)
 Suite 400 1,210 SF \$2,360.00, NNN (\$1.95 PSF)

1240 SUNSET BLVD:
 Suite 400 - 1,205 SF: \$2,109.00, NNN (\$1.75 PSF)

NNN costs are \$0.57 PSF.

DEMOGRAPHICS:

	1 miles	3 miles	5 miles
2018 Population (est):	13,686	81,559	189,676
2018 HH Income:	\$118,359	\$125,226	\$110,960
Daily Traffic Count:		Sunset Blvd 31,097	

[VIEW VIRTUAL TOUR](#)

ETHAN CONRAD PROPERTIES, INC.

1300 NATIONAL DRIVE, SUITE 100 | SACRAMENTO CA, 95834 | 916.779.1000
 www.ethanconradprop.com

FOR LEASE

SUNSET POINTE
1230-1240 SUNSET BLVD
ROCKLIN, CA

SITE PLAN

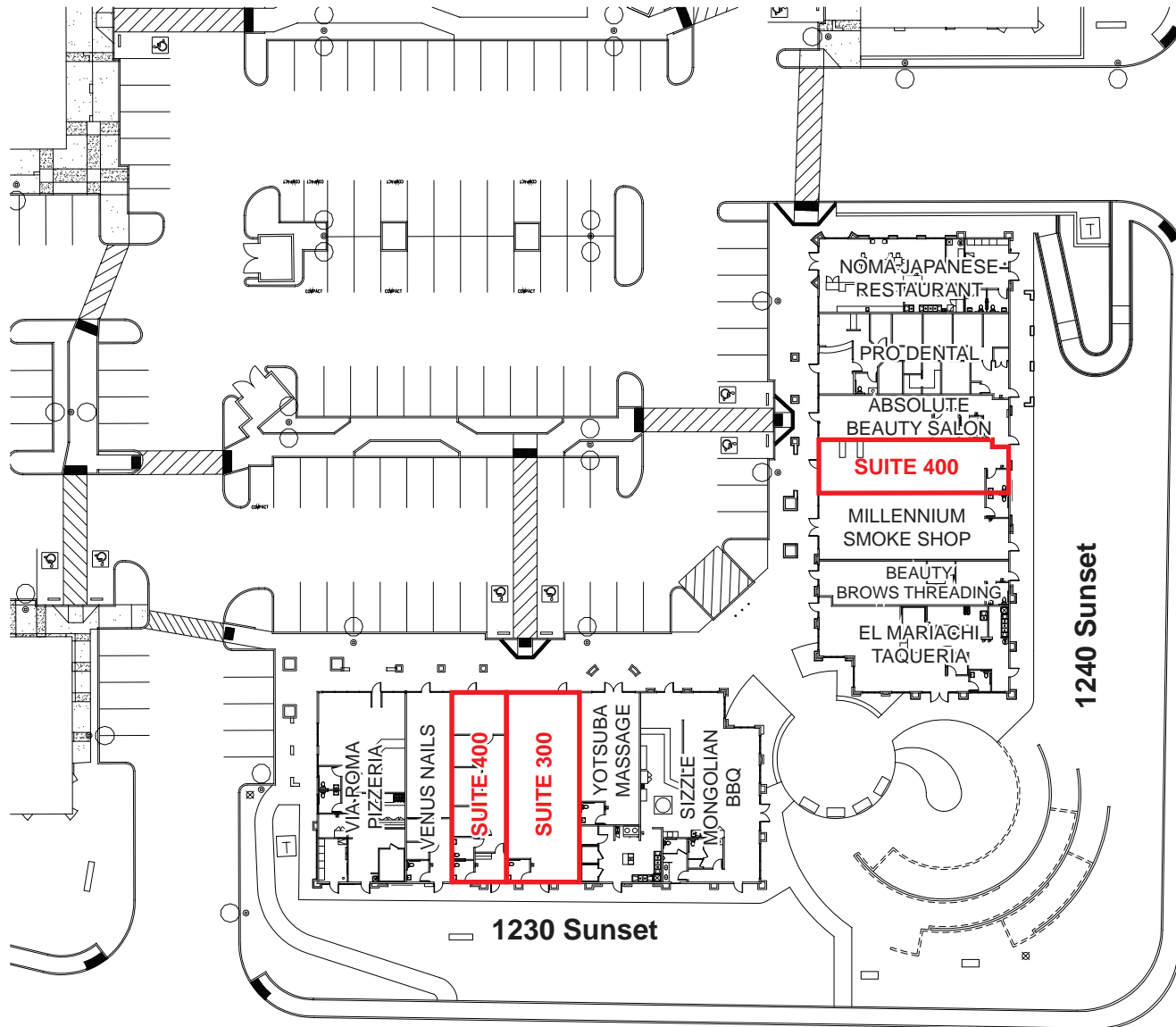

[VIEW VIRTUAL TOUR](#)

ETHAN CONRAD PROPERTIES, INC.
1300 NATIONAL DRIVE, SUITE 100 | SACRAMENTO CA, 95834 | 916.779.1000
www.ethanconradprop.com

The information contained herein has been obtained from sources we believe to be reliable. However, we cannot guarantee, warrant or represent its accuracy and all information is subject to error, change or withdrawal. An interested party and their advisors should conduct an independent investigation of the property to determine to your satisfaction the suitability of the property for your needs.

1230 SUNSET BLVD

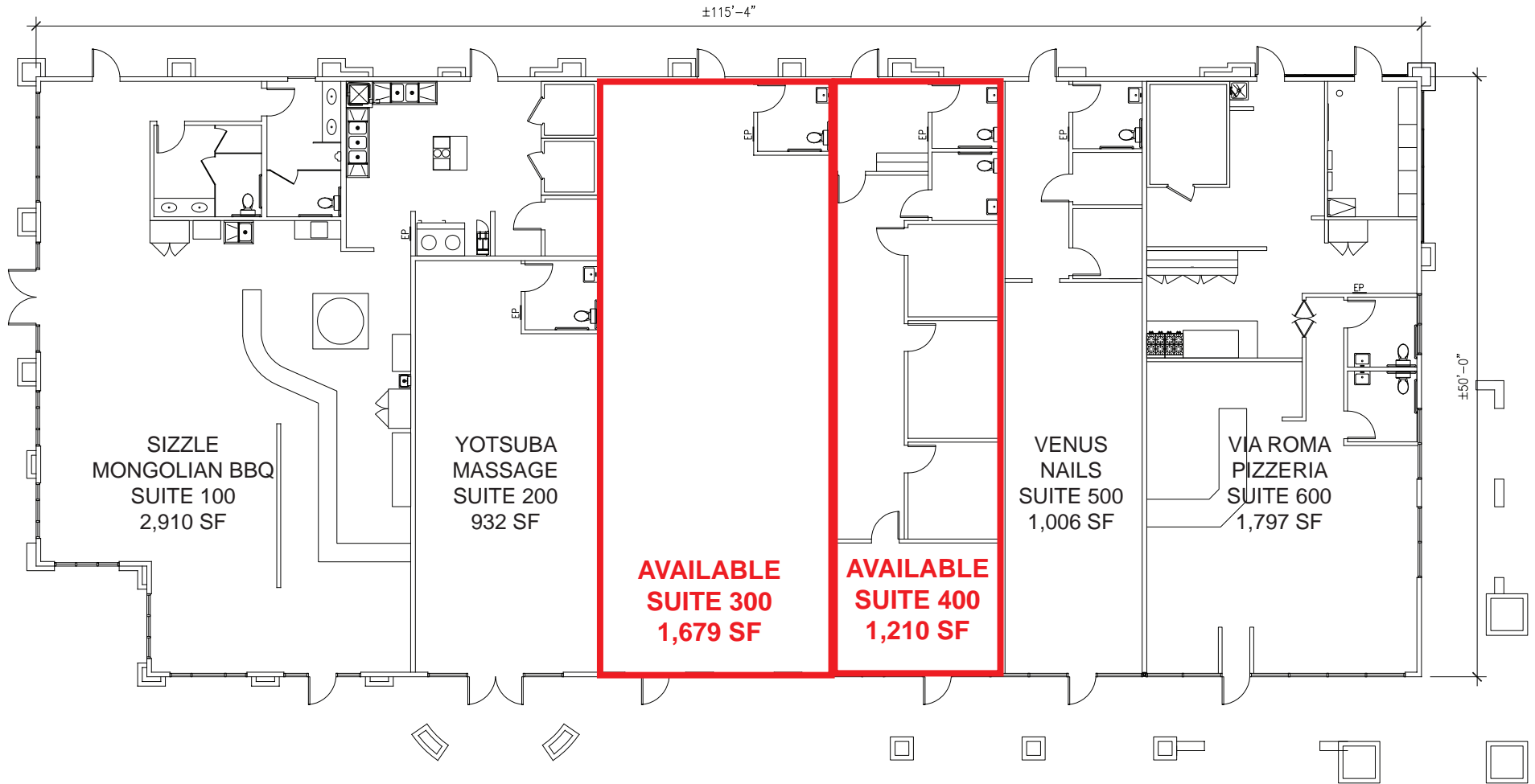

ETHAN CONRAD PROPERTIES, INC.
1300 NATIONAL DRIVE, SUITE 100 | SACRAMENTO CA, 95834 | 916.779.1000
www.ethanconradprop.com

The information contained herein has been obtained from sources we believe to be reliable. However, we cannot guarantee, warrant or represent its accuracy and all information is subject to error, change or withdrawal. An interested party and their advisors should conduct an independent investigation of the property to determine to your satisfaction the suitability of the property for your needs.

1240 SUNSET BLVD

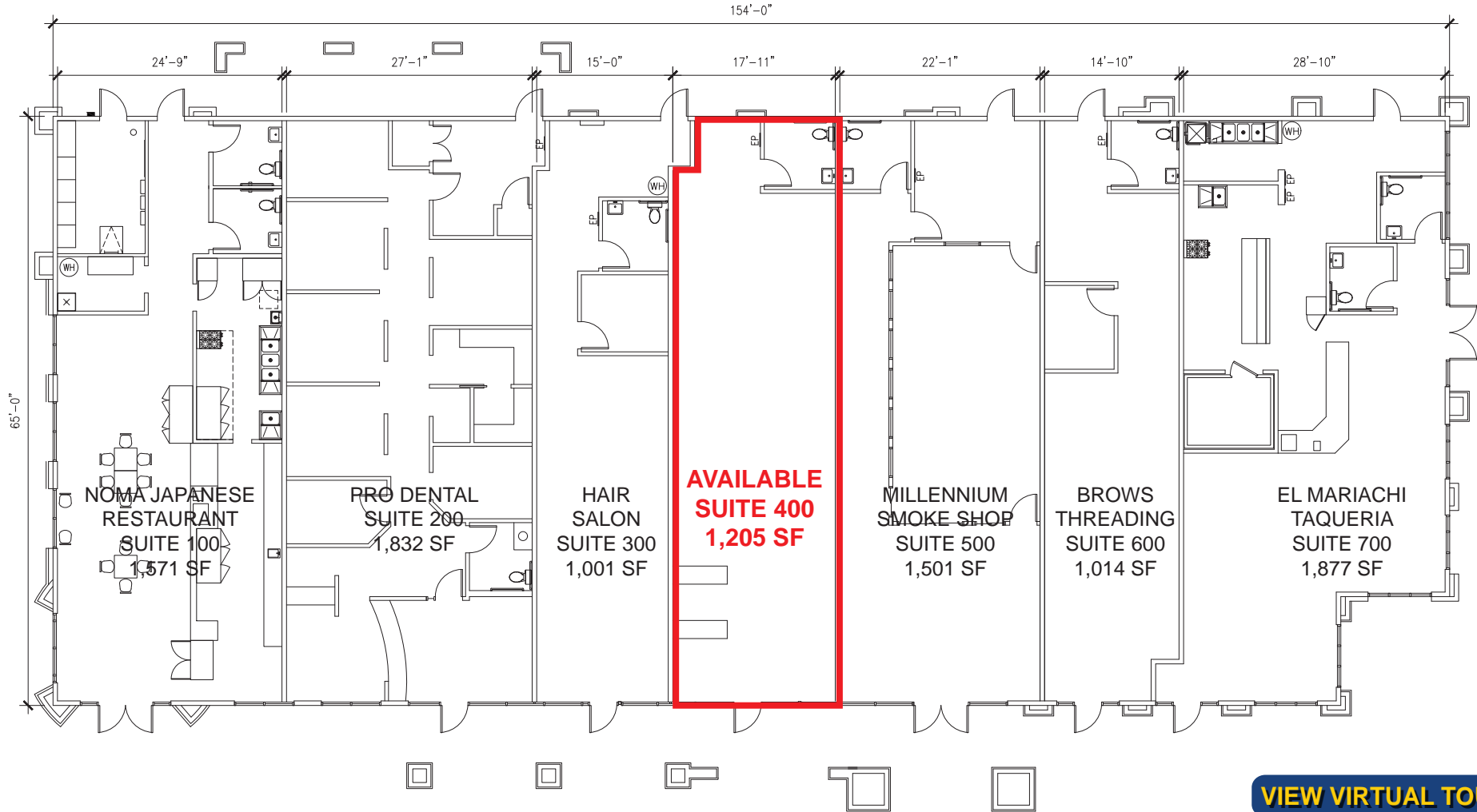

ETHAN CONRAD PROPERTIES, INC.
1300 NATIONAL DRIVE, SUITE 100 | SACRAMENTO CA, 95834 | 916.779.1000
www.ethanconradprop.com

The information contained herein has been obtained from sources we believe to be reliable. However, we cannot guarantee, warrant or represent its accuracy and all information is subject to error, change or withdrawal. An interested party and their advisors should conduct an independent investigation of the property to determine to your satisfaction the suitability of the property for your needs.



ETHAN CONRAD PROPERTIES, INC.
1300 NATIONAL DRIVE, SUITE 100 | SACRAMENTO CA, 95834 | 916.779.1000
www.ethanconradprop.com

The information contained herein has been obtained from sources we believe to be reliable. However, we cannot guarantee, warrant or represent its accuracy and all information is subject to error, change or withdrawal. An interested party and their advisors should conduct an independent investigation of the property to determine to your satisfaction the suitability of the property for your needs.