

**3600**

PARKWAY CENTER CT

**RARE 33,667 SF  
ORLANDO WAREHOUSE  
FOR SALE**

3600 PARKWAY CENTER COURT, ORLANDO, FL 32808



## KEY FEATURES

- ±32,000 SF Total Building Area
- 28' Clear Height - accommodates racking, distribution, and vertical storage
- Robust Power Supply - 1,200+ amps, ideal for heavy equipment users
- Multiple Loading Configurations:
  - 4 Dock-High Doors
  - 1 Ramp Drive-in Door
  - 1 Hybrid Dock/Drive-In Door
- Undeveloped IOS Potential - excess land allows for trailer parking, outdoor storage, or yard expansion
- Functional Layout - supports efficient operations, logistics flow, and tenant customization
- Strategic Advantages
  - Owner-User Opportunity - secure long-term occupancy while capturing appreciation and operational control
  - Scarce IOS Component - increasingly difficult to find in infill industrial markets
  - Versatile Loading - ability to accommodate a mix of fleet vehicles, box trucks, and dock operations
  - High Power Capacity - positions the asset for a wide range of industrial and light manufacturing users

THE  
SPACE  
32,000 SF



## PROPERTY DETAILS

- Sale Price:** CALL FOR DETAILS
- Location:** 3600 Parkway Center Ct.  
Orlando, FL 32808
- Size:** 33,667 SF
- Parcel ID:** 04-22-29-6708-00-130
- Zoning:** ORL I-P/W
- Land Size:** 2.89 AC
- Parking:** 0.56/1,000
- Signage:** Building

## HIGHLIGHTS

- 16' x 21' Drive-In Door
- 10' x 10' Ramp/Dock High Combo Door,
- Four 10' x 8' Dock High Doors
- 1200+ Amps, 28' Clear Height (to the joist)
- HVAC System for Office and Partial Warehouse Space
- Large Ceiling Fan System for Warehouse Space
- Fully Sprinklered

## OVERVIEW

3600 Parkway Center Court presents a rare opportunity to acquire a ±32,000 SF industrial warehouse ideally suited for owner-users seeking functionality, scale, and long-term upside. The property combines strong physical infrastructure with flexible outdoor potential—making it highly adaptable for a range of industrial uses including distribution, manufacturing, and service-based operations.



Trey Dyer

Trey@4acre.com

407.797.7767

# LOCATION AERIAL

DOWNTOWN  
ORLANDO

**John Young Pkwy**

**Parkway Center Ct.**

THE  
SPACE

4 ACRE COMMERCIAL | CONTACT TREY DYER AT 407.797.7767



# PROPERTY AERIAL



4 ACRE COMMERCIAL | CONTACT TREY DYER AT 407.797.7767



# FLOOR PLAN 33,667 SF TOTAL

MAIN SPACE: 6,310 SF

TENANT SPACE: 27,347 SF

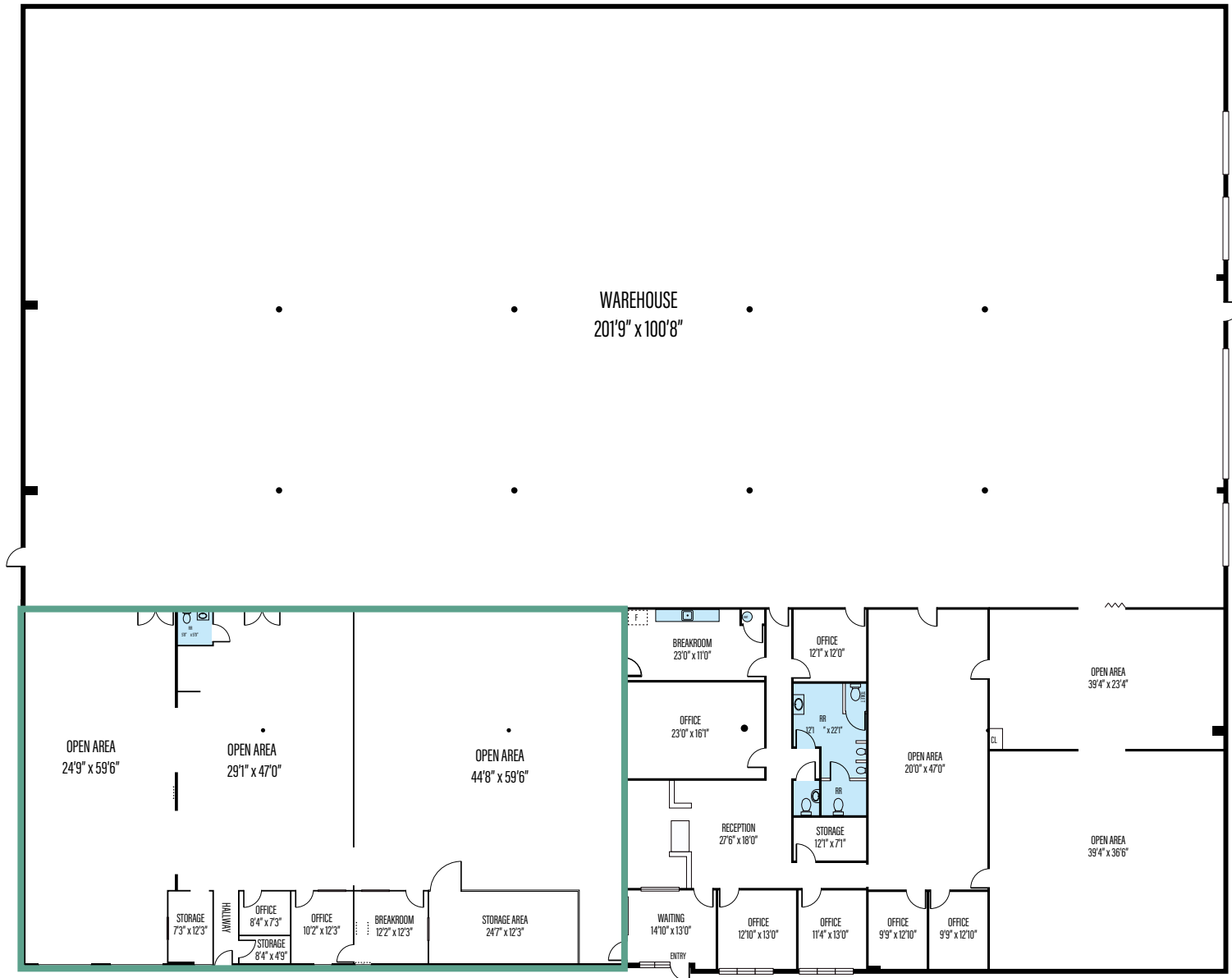

# SPACE LAYOUT 33,667 SF TOTAL

MAIN SPACE: 6,310 SF

TENANT SPACE: 27,347 SF

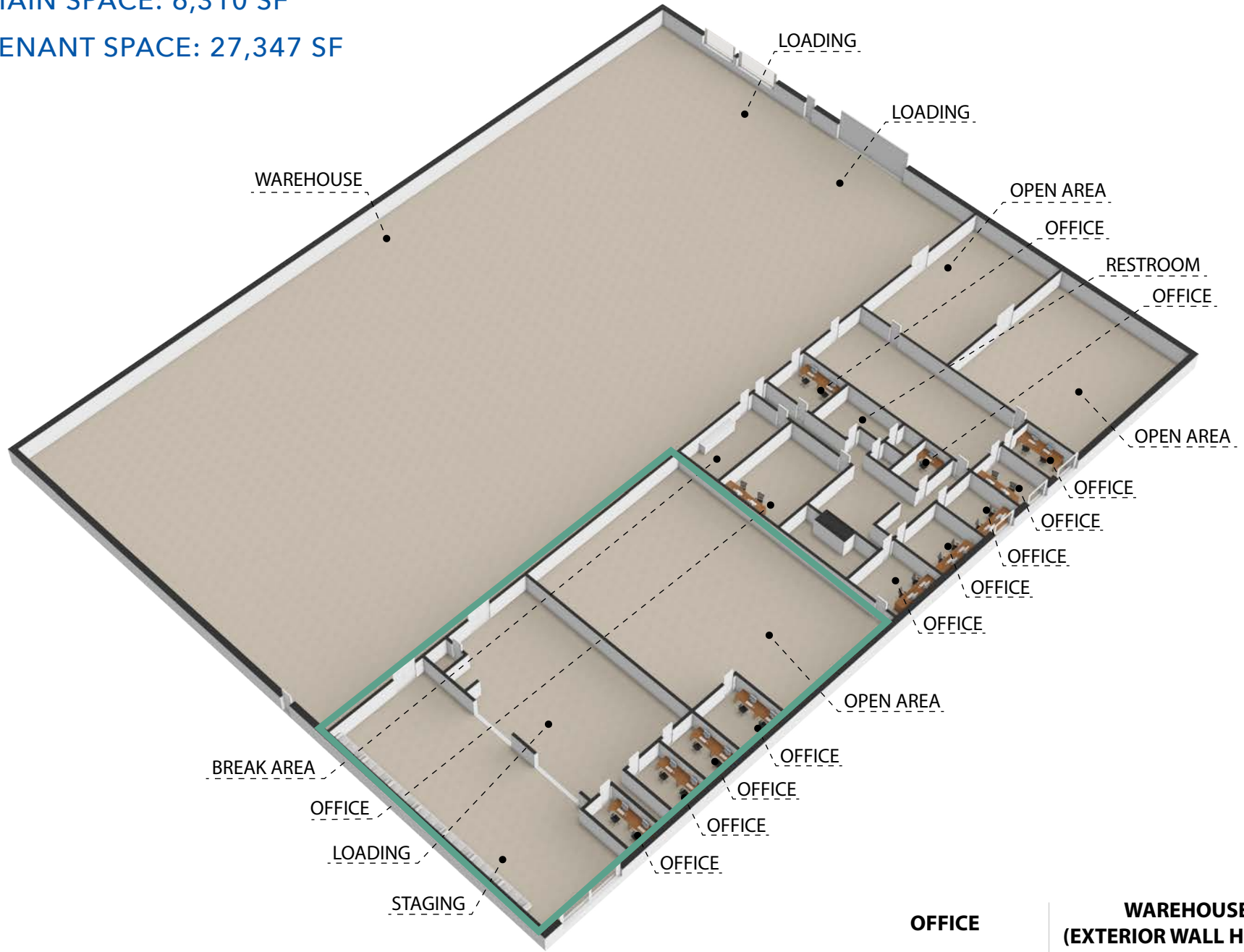

**OFFICE**  
CEILING HEIGHT : 8'0"

**WAREHOUSE**  
**(EXTERIOR WALL HEIGHT)**  
CEILING HEIGHT : 20'0"

# INTERIORS | MAIN - OFFICE



4 ACRE COMMERCIAL | CONTACT TREY DYER AT 407.797.7767



# INTERIORS | MAIN - WAREHOUSE



4 ACRE COMMERCIAL | CONTACT TREY DYER AT 407.797.7767



# INTERIORS | TENANT AREA



# FRONT LOADING DOCKS



4 ACRE COMMERCIAL | CONTACT TREY DYER AT 407.797.7767



# LOCATION MAP

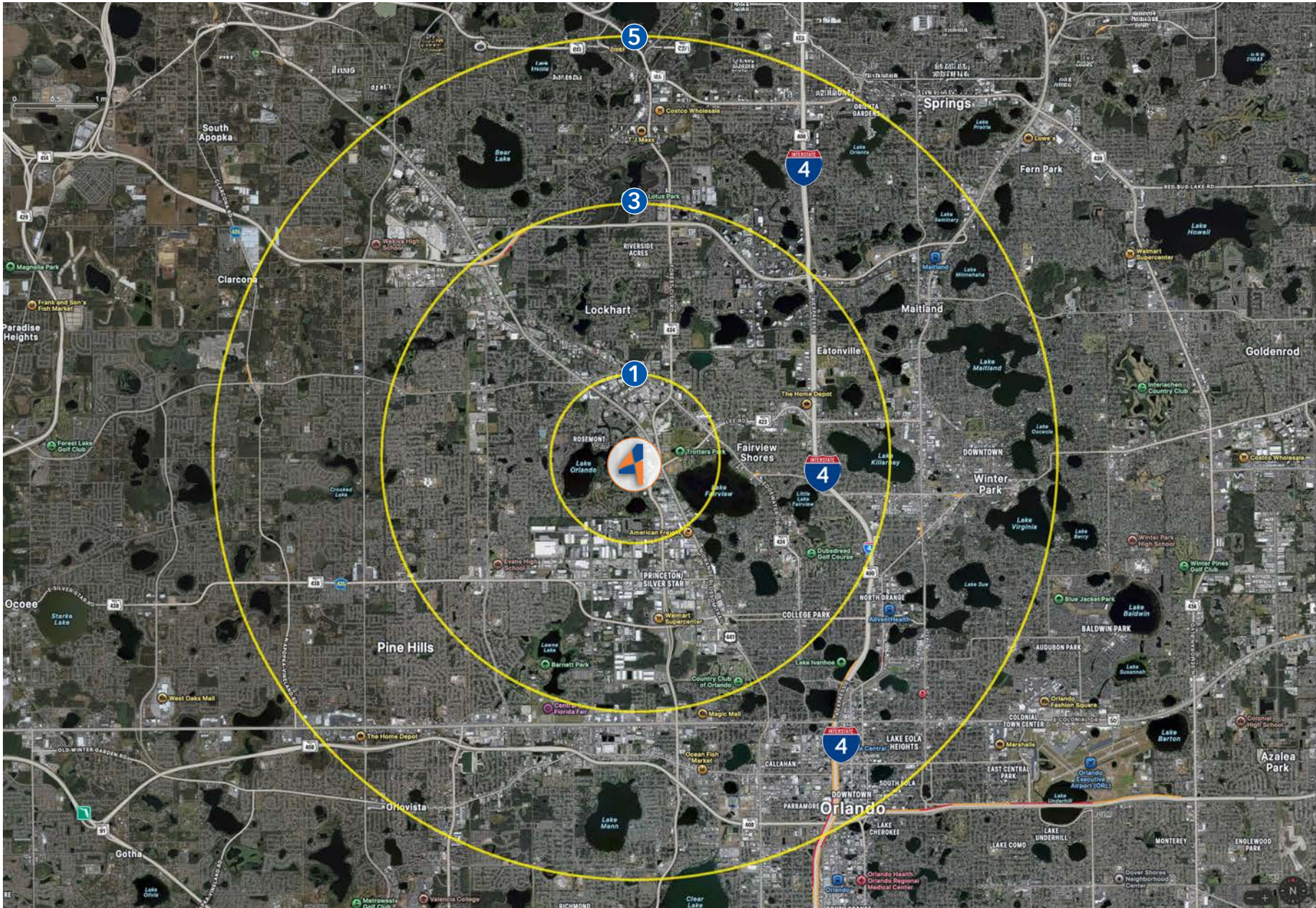

4 ACRE COMMERCIAL | CONTACT TREY DYER AT 407.797.7767





Trey Dyer  
Trey@4acre.com  
407.797.7767

4 Acre Commercial Real Estate (4 Acre) does not represent or warranty the accuracy of the information contained herein. Such information has been given to 4 Acre by the owner of the property or obtained from other sources deemed reliable. 4 Acre has no reason to doubt its accuracy, but does not guarantee it. The reviewer(s) of this document is encouraged to perform their own research for their own purposes to verify the dependability of the information being reviewed. All information should be verified by reviewer(s) prior to purchase or lease. Unless otherwise noted, the property is being offered as-is, where is, with all faults. This information represents the proprietary work product of 4 Acre Realty, LLC and may not be copied, reproduced, modified, distributed, published, transmitted, or otherwise disclosed without the express written consent of 4 Acre Realty, LLC.