

1580-1584 Zephyr Ave
HAYWARD, CA

±9,168-34,592 SF contiguous
Available for Lease



Patrick J Metzger
RE Lic. #: 01888895
+1 510 285 5362
patrickj.metzger@jll.com

Thomas Mensendiek
RE Lic. #: 02001433
+1 925 944 2163
t.mensendiek@jll.com

Jason Ovadia
CA Lic. #: 01742912
+1 510 285 5360
jason.ovadia@jll.com



EASTGROUP
PROPERTIES

Jones Lang LaSalle Brokerage, Inc. Real Estate
License #: 01856260

1580 Zephyr Ave

HAYWARD, CA

±9,168 SF Available

Premises features

±9,168 SF total

±100 SF Office space

Two (2) Dock-high doors

One (1) Grade-level door

Skylights throughout, LED warehouse lighting

±20' - ±22' minimum Clear Height

Fully sprinklered (.33/3750)

±1 mile to I-880 via Whipple Rd

Minimum ±100 Amps @ 208 Volt 3 phase power
(subject to confirmation)

±24' - ±60' Column Spacing

Available 1/1/2025

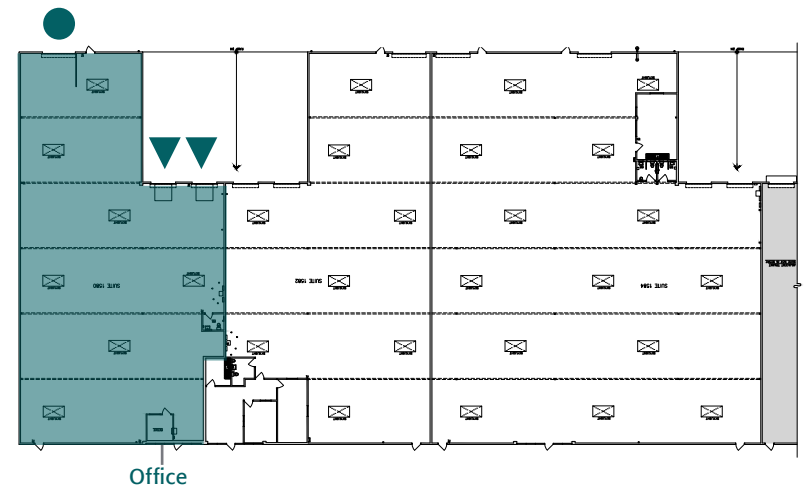

- ▲ Dock High Doors
- Grade Level Doors

1582 Zephyr Avenue

HAYWARD, CA

±9,550 SF Available

Premises features

±9,550 SF total, Expandable

±500 SF Office space

Two (2) Dock-high doors

One (1) Grade-level door

Skylights throughout, LED warehouse lighting

±20' - ±22' minimum Clear Height

Fully sprinklered (.33/3750)

±1 mile to I-880 via Whipple Rd

Minimum ±100 Amps @ 208 Volt 3 phase power
(subject to confirmation)

±24' - ±60' Column Spacing

Available 2/1/2025

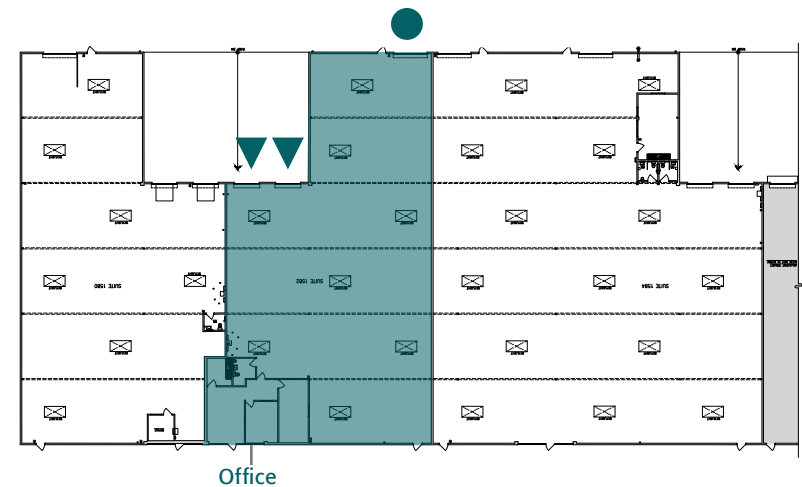

- ▲ Dock High Doors
- Grade Level Doors

1584 Zephyr Avenue

HAYWARD, CA

±15,824 SF Available

Premises features

±15,824 SF total, Expandable

±1,000 SF Office space

Two (2) Dock-high doors

Two (2) Grade-level door

Skylights throughout, LED warehouse lighting

±20' - ±22' minimum Clear Height

Fully sprinklered

±1 mile to I-880 via Whipple Rd

Minimum ±200 Amps @ 208 Volt 3 phase power
(subject to confirmation)

±24' - ±60' Column Spacing

New interior and exterior paint

Available Now

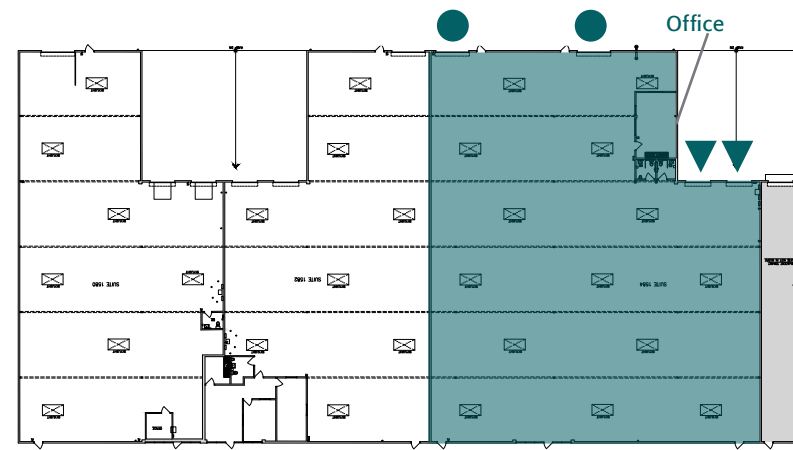

- ▲ Dock High Doors
- Grade Level Doors

1580-1584 Zephyr Ave

HAYWARD, CA

±9,168-34,592 SF contiguous
Available for Lease

Corporate Neighbors



- | | | | |
|------------------------|----------------------------|----------------------------|-------------------------------|
| 1. Forward Air, Inc | 8. Keeco | 15. Plant Terra | 22. American Licorice Company |
| 2. Xcapade | 9. Kuehne Nagel | 16. Samuel | 23. Autowise |
| 3. Gallo Sales Company | 10. Tesla | 17. J.B. Hunt | 24. RW Garage Doors |
| 4. Allure Labs | 11. Renewal by Andersen | 18. Move-Pros | 25. Rich's |
| 5. WMT Logistics, Inc. | 12. MDC Precision | 19. Yaneng | 26. Hayward Training |
| 6. FWS | 13. Chalk | 20. Armenino | 27. Kwan Wo Ironworks |
| 7. Semano | 14. Johnson Computer, Inc. | 21. Standard Event Rentals | 28. IMT Precision, Inc. |

1580-1584 Zephyr Ave

HAYWARD, CA

±9,168-34,592 SF Contiguous Available for Lease

Demographics

| Access to consumers | 15 minutes | 30 minutes | 45 minutes |
|---|------------|------------|-------------|
| Total Population | 397,930 | 1,983,498 | 5,000,685 |
| Total Households | 122,523 | 691,141 | 1,750,595 |
| Millennial Population (Born 1981 to 1998) | 105,093 | 528,141 | 1,276,719 |
| Median Home Value | \$868,960 | \$997,480 | \$1,128,694 |
| Ordered any item online in last 6 months | 235,955 | 1,222,549 | 3,166,671 |
| Spent \$500+ on Internet orders in last 12 months | 133,433 | 724,160 | 1,912,579 |
| Median Household Income | \$122,221 | \$124,420 | \$135,280 |
| Median Disposable Income | \$100,910 | \$101,753 | \$106,283 |
| Household Income 100K+ | 75,691 | 419,855 | 1,107,560 |
| Manufacturing Employees | 15,695 | 56,669 | 125,009 |
| Warehousing & Distribution Employees | 15,375 | 60,121 | 131,030 |

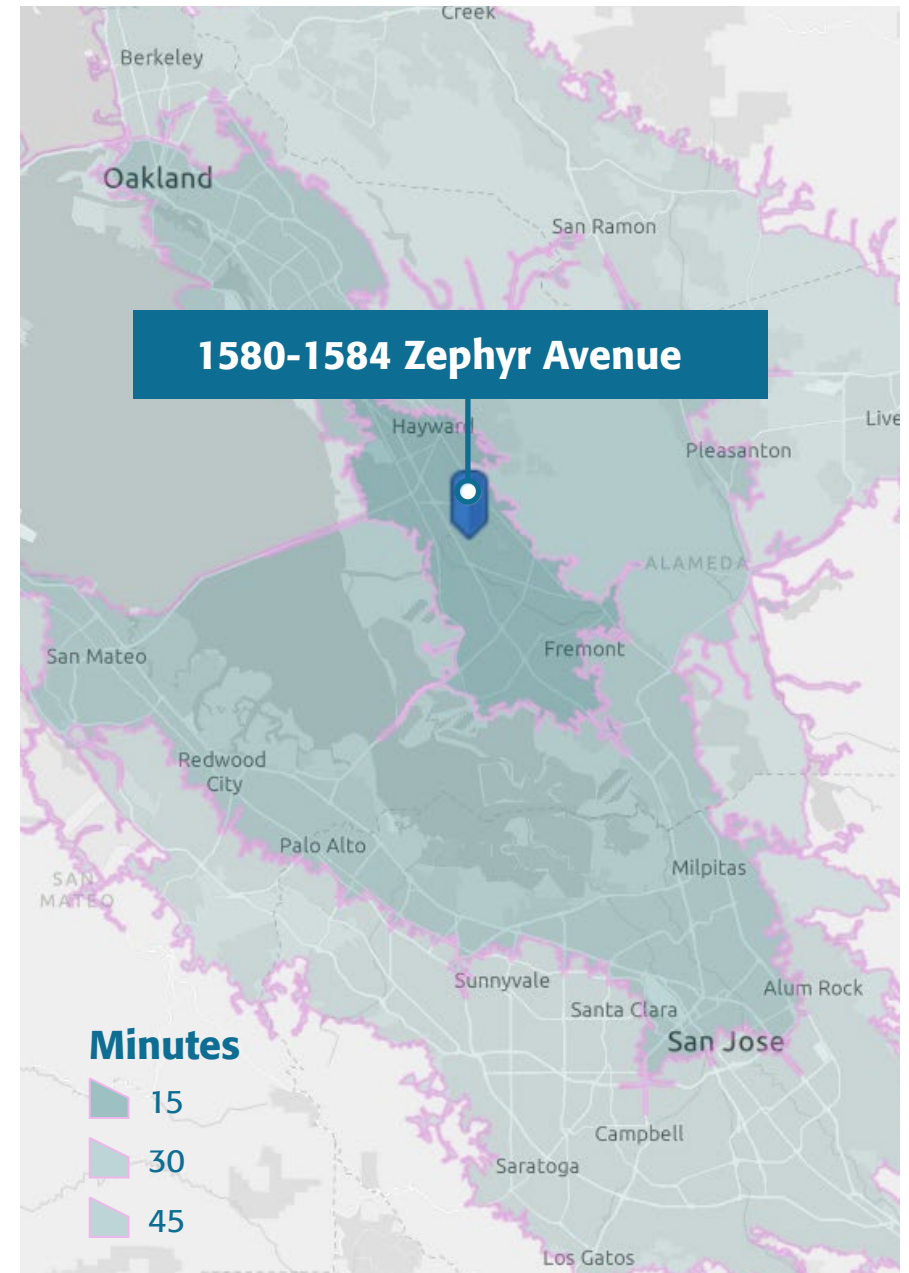

1580-1584 Zephyr Ave

HAYWARD, CA

±9,168-34,592 SF Contiguous
Available for Lease

Strategic location

Port

Port of Redwood City **17.6 miles**

Port of Oakland **19.2 miles**

Airport

Oakland Airport **13.5 miles**

SFO International Airport **24.5 miles**

San Jose Airport **21.5 miles**

BART

Hayward BART Station **6.7 miles**

Contact

Patrick J Metzger
RE Lic. #: 01888895
+1 510 285 5362
patrickj.metzger@jll.com

Thomas Mensendiek
RE Lic. #: 02001433
+1 925 944 2163
t.mensendiek@jll.com

Jason Ovardia
CA Lic. #: 01742912
+1 510 285 5360
jason.ovardia@jll.com

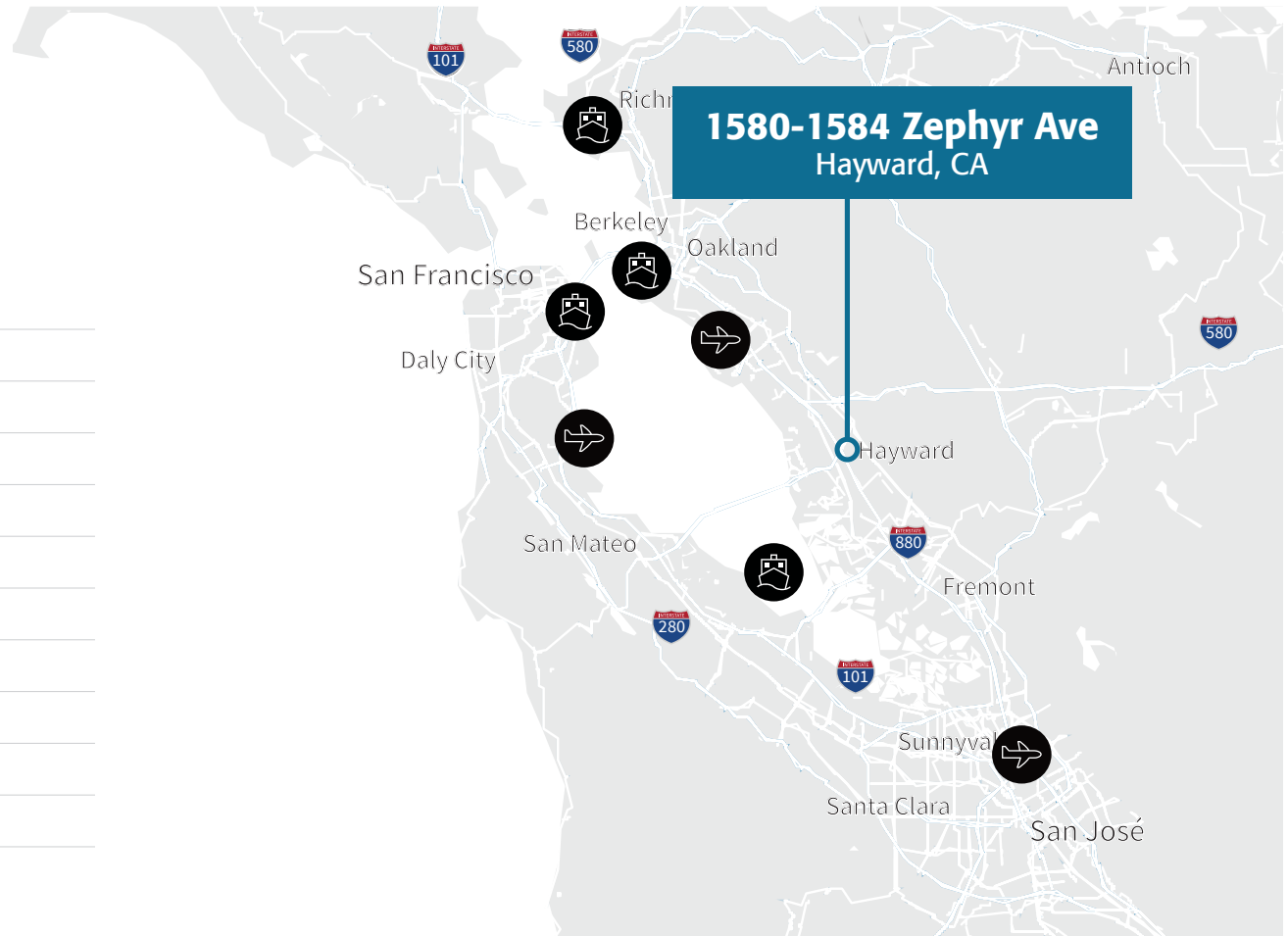

Although information has been obtained from sources deemed reliable, neither Owner nor JLL makes any guarantees, warranties or representations, express or implied, as to the completeness or accuracy as to the information contained herein. Any projections, opinions, assumptions or estimates used are for example only. There may be differences between projected and actual results, and those differences may be material. The Property may be withdrawn without notice. Neither Owner nor JLL accepts any liability for any loss or damage suffered by any party resulting from reliance on this information. If the recipient of this information has signed a confidentiality agreement regarding this matter, this information is subject to the terms of that agreement. ©2024. Jones Lang LaSalle IP, Inc. All rights reserved.