

# INDUSTRIAL & STORAGE SPACES

4101-4240 Bandy Blvd. Fort Pierce, FL 34981



**FOR LEASE** | Starting at \$16.00/sf\*

**JEREMIAH BARON  
& CO**

COMMERCIAL REAL ESTATE

49 SW Flagler Ave. Suite 301

Stuart FL, 34994

[www.commercialrealestatellc.com](http://www.commercialrealestatellc.com)

**Brian Schwan**

772.286.5744 Office

772.215.1167 Mobile

[bschwan@commercialrealestatellc.com](mailto:bschwan@commercialrealestatellc.com)

# PROPERTY OVERVIEW

- Multiple industrial lease options available at the Fort Pierce Business Park located on the corner of Bandy Blvd. and Selvitz Rd. in Fort Pierce.
- There are currently a few spaces available as follows: (1) 286 sf storage bay with a roll-up door, (5) 600 sf flexible business/storage units with a roll up door, (1) 1,064 sf flex warehouse space with an office and roll up door, and (1) 1,600 sf flex warehouse space with an office, 3 roll-up doors, and a bathroom.
- Site features include 12 x 12 roll up doors and a common loading dock.
- Excellent location as it is just a few minutes away from I-95, Florida's Turnpike, and US Highway 1.

SPACES AVAILABLE	
<b>B-2   600 SF   FLEX SPACE</b>	\$800/mo.
<b>B-3   600 SF   FLEX SPACE</b>	\$800/mo.
<b>B-6   600 SF   FLEX SPACE</b>	\$800/mo.
<b>E-5   6,480 SF   FLEX WAREHOUSE</b>	\$8,640/mo.
<b>1.25 AC YARD SPACE</b>	\$1.75/sf/yr.

<b>BUILDING SIZE</b>	7,303 sf   13,677 SF   27,200 SF
<b>BUILDING TYPE</b>	Industrial
<b>YARD SPACE</b>	2.92 AC
<b>FRONTAGE</b>	195' to Selvitz Road
<b>TRAFFIC COUNT</b>	8,800 ADT (Selvitz Road)
<b>YEAR BUILT</b>	1986   1991
<b>CONSTRUCTION TYPE</b>	CB Stucco
<b>PARKING SPACE</b>	Ample
<b>ZONING</b>	I-1 (Ft. Pierce)
<b>LAND USE</b>	HI
<b>PARCEL ID</b>	2431-505-0003-000-1 2431-505-0010-000-3 2431-505-0009-000-3

NO WARRANTY OR REPRESENTATION, EXPRESS OR IMPLIED, IS MADE AS TO THE ACCURACY OF THE INFORMATION CONTAINED HEREIN, AND THE SAME IS SUBMITTED SUBJECT TO ERRORS, OMISSIONS, CHANGE OF PRICE, RENTAL OR OTHER CONDITIONS, PRIOR SALE, LEASE OR FINANCING, OR WITHDRAWAL WITHOUT NOTICE, AND OF ANY SPECIAL LISTING CONDITIONS IMPOSED BY OUR PRINCIPALS NO WARRANTIES OR REPRESENTATIONS ARE MADE AS TO THE CONDITION OF THE PROPERTY OR ANY HAZARDS CONTAINED THEREIN ARE ANY TO BE IMPLIED.

**JEREMIAH BARON  
& CO**

COMMERCIAL REAL ESTATE

49 SW Flagler Ave. Suite 301  
Stuart FL, 34994  
www.commercialrealestatellc.com

**Brian Schwan**

772.286.5744 Office

772.215.1167 Mobile

bschwan@commercialrealestatellc.com

# SITE PLAN

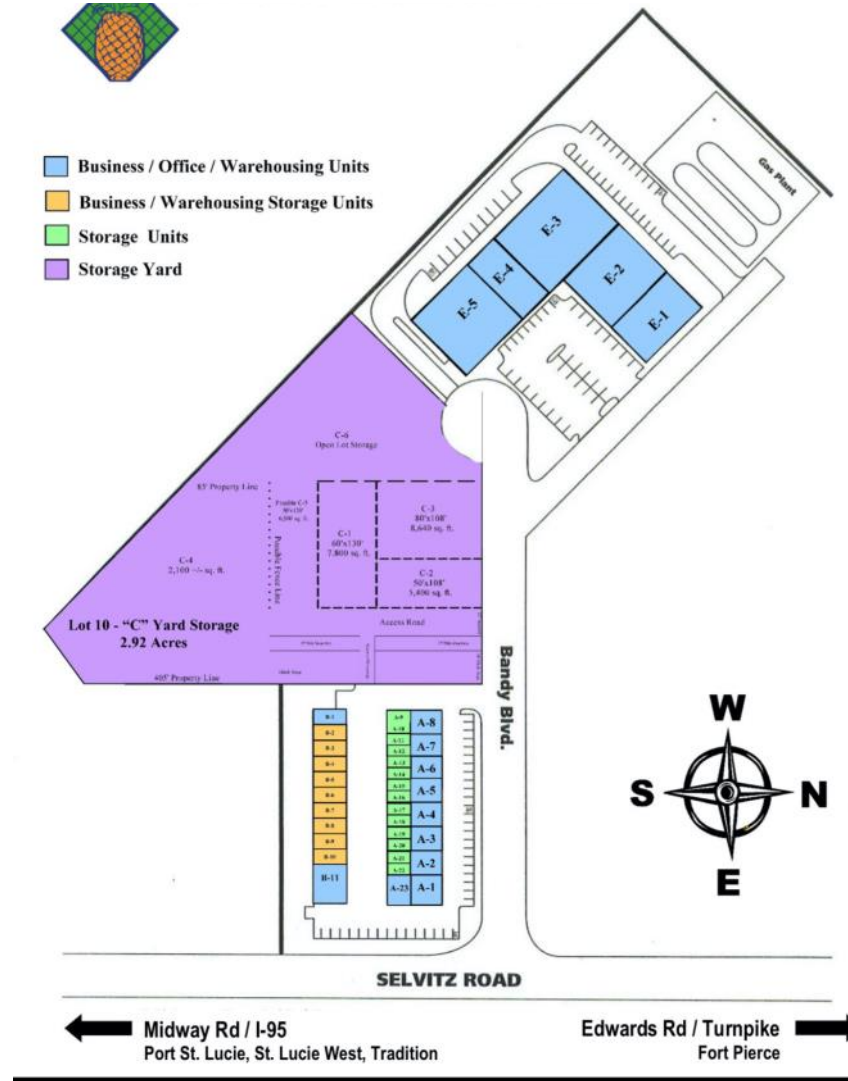

**JEREMIAH BARON  
& CO**

COMMERCIAL REAL ESTATE

49 SW Flagler Ave. Suite 301  
Stuart FL, 34994  
[www.commercialrealestatellc.com](http://www.commercialrealestatellc.com)

**Brian Schwan**  
772.286.5744 Office  
772.215.1167 Mobile  
[bschwan@commercialrealestatellc.com](mailto:bschwan@commercialrealestatellc.com)

# ADDITIONAL PHOTO (4240 BLDG.)



**JEREMIAH BARON  
& CO**

COMMERCIAL REAL ESTATE

49 SW Flagler Ave. Suite 301

Stuart FL, 34994

[www.commercialrealestatellc.com](http://www.commercialrealestatellc.com)

**Brian Schwan**

772.286.5744 Office

772.215.1167 Mobile

[bschwan@commercialrealestatellc.com](mailto:bschwan@commercialrealestatellc.com)

# DEMOGRAPHICS

2023 Population Estimate		2023 Average Household Income		Average Age	
1 Mile	659	1 Mile	\$78,631	1 Mile	36.70
3 Mile	30,596	3 Mile	\$64,285	3 Mile	39.80
5 Mile	94,435	5 Mile	\$60,389	5 Mile	40.40

2028 Population Projection		2023 Median Household Income		Median Age	
1 Mile	691	1 Mile	\$61,731	1 Mile	37
3 Mile	32,245	3 Mile	\$50,490	3 Mile	40
5 Mile	99,190	5 Mile	\$46,506	5 Mile	40

**JEREMIAH BARON  
& CO**

COMMERCIAL REAL ESTATE

49 SW Flagler Ave. Suite 301  
Stuart FL, 34994  
[www.commercialrealestatellc.com](http://www.commercialrealestatellc.com)

**Brian Schwan**

772.286.5744 Office  
772.215.1167 Mobile  
[bschwan@commercialrealestatellc.com](mailto:bschwan@commercialrealestatellc.com)

# ZONING INFORMATION (PERMITTED USES)

Self-Service Storage	P
-Automobile Rentals	P
-Automobile Sales	P
-Boat Rentals	P
-Boat Sales	P
-Vehicle Repair, General	P
-Vehicle Repair, Limited	P
-Marine-Related Repair	P
-Vehicle Storage	P
Artisan	P
-Cabinet Shops, Woodworking	P
Light Industrial Service (except as noted below)	P
-Catering Facility, Large-Scale	P
-Contractors/Others Performing Services Off-Site	P
-Research Service	P
Marine-Related Industrial	P

Wholesale Trade	P
Heavy Industrial (except as noted below)	-
-Heavy Equipment Sales and Rentals	P
-Service of Heavy Equipment	P
-Processing of Food and Related Products	P
Aquaculture Facilities	P
Community Gardens	C

**JEREMIAH BARON  
& CO**

COMMERCIAL REAL ESTATE

49 SW Flagler Ave. Suite 301  
Stuart FL, 34994  
[www.commercialrealestatellc.com](http://www.commercialrealestatellc.com)

**Brian Schwan**

772.286.5744 Office

772.215.1167 Mobile

[bschwan@commercialrealestatellc.com](mailto:bschwan@commercialrealestatellc.com)

# TRADE AREA MAP



**JEREMIAH BARON  
& CO**

COMMERCIAL REAL ESTATE

49 SW Flagler Ave. Suite 301  
Stuart FL, 34994  
[www.commercialrealestatellc.com](http://www.commercialrealestatellc.com)

**Brian Schwan**

772.286.5744 Office  
772.215.1167 Mobile  
[bschwan@commercialrealestatellc.com](mailto:bschwan@commercialrealestatellc.com)

# PROXIMITY MAP

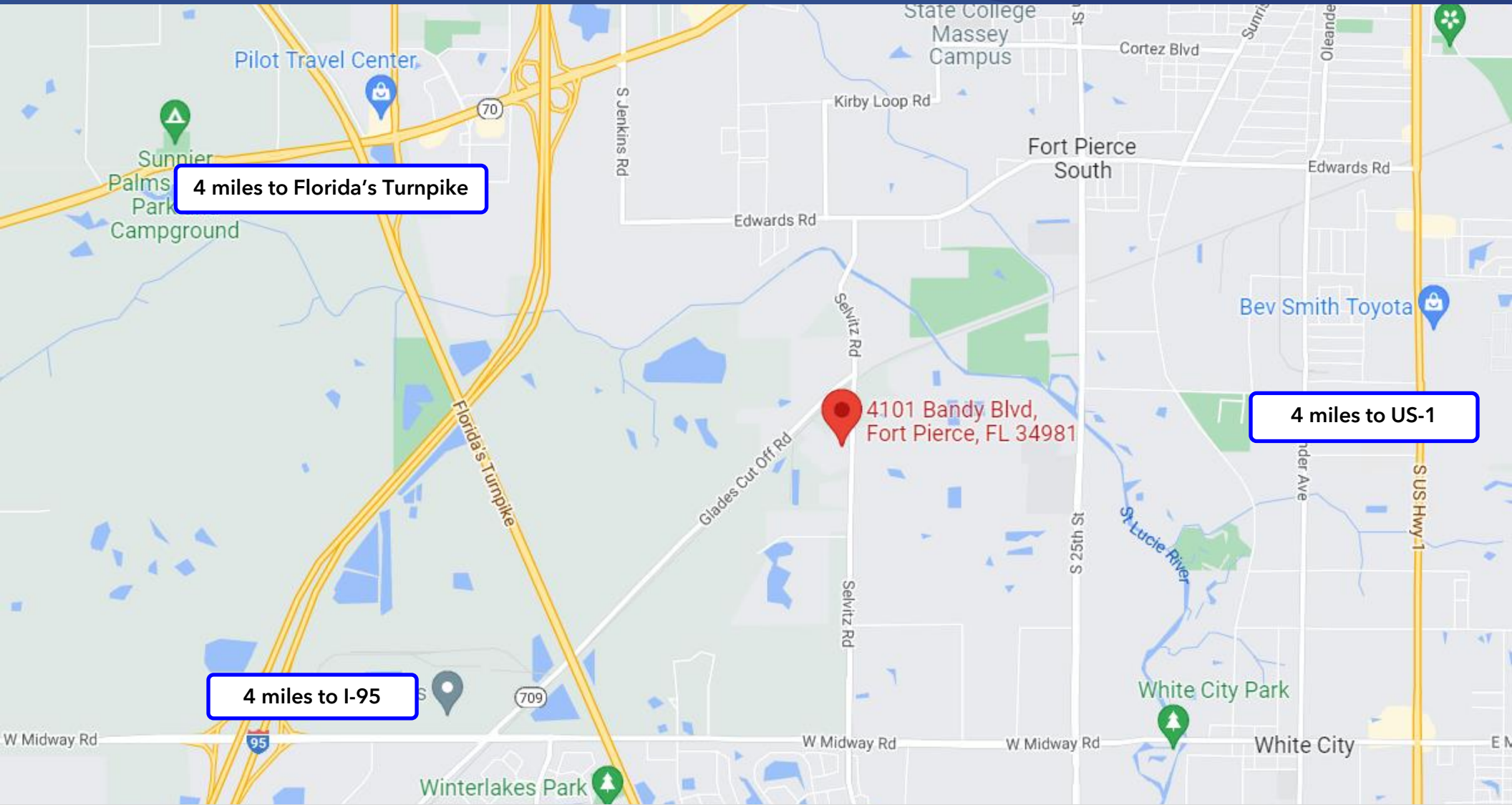

**Jeremiah Baron**  
& CO.

Commercial Real Estate, LLC

49 SW Flagler Ave. Suite 301  
Stuart FL, 34994  
[www.commercialrealestatellc.com](http://www.commercialrealestatellc.com)

**Brian Schwan**

772.286.5744 Office  
772.215.1167 Mobile  
[bschwan@commercialrealestatellc.com](mailto:bschwan@commercialrealestatellc.com)