



30,759 SF AVAILABLE FOR LEASE

PREMIER DOCK HIGH WAREHOUSE DISTRIBUTION FACILITY

10724-10736 Bloomfield Avenue | Santa Fe Springs, CA



WAREHOUSE DISTRIBUTION FACILITY

- 30,759 SF Dock High Industrial Unit
- 1,990 SF of Office Space
- 3 Dock High Positions
2 Ground Level Doors
- 24' Clearance
- .33/3000 Sprinklers
- 400 Amps of Power
- 52 Car Parking Spaces
- Major Street Frontage
- Excellent Access to (5), (605) & (105) Freeways
- High Image Business Park Environment

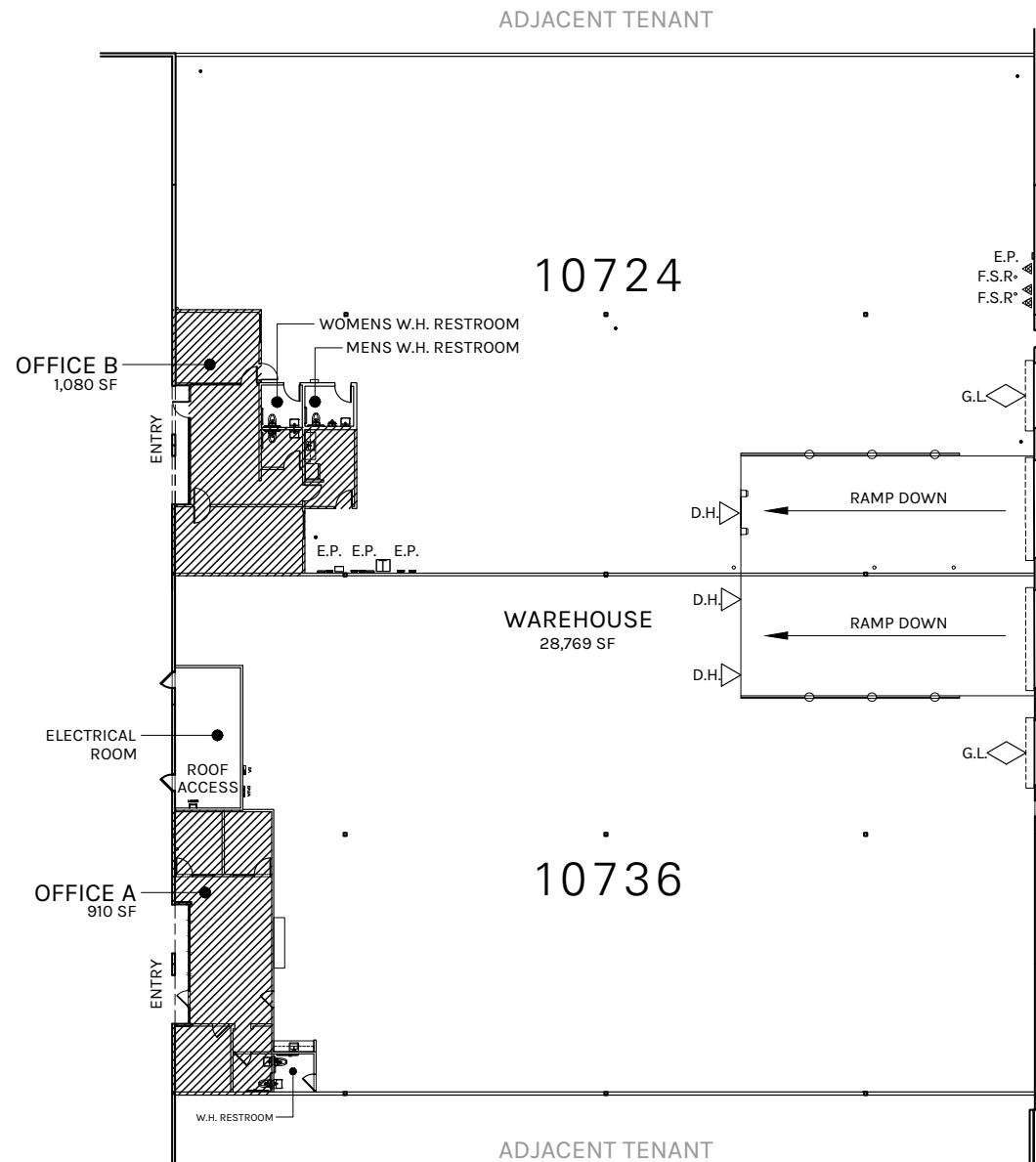

WAREHOUSE
28,769 SF

OFFICE
1,990 SF

TOTAL
30,759 SF

PLAN LAYOUT SUBJECT TO FIELD CONDITIONS AND MAY DIFFER FROM PLAN AS SHOWN. ALL INFORMATION PRESENTED ON THIS DRAWING IS PRESUMED TO BE ACCURATE, HOWEVER TENANT SHOULD VERIFY PERTINENT INFORMATION PRIOR TO COMMITTING TO A LEASE. ANY FURNITURE OR APPLIANCES SHOWN ON PLAN ARE FOR CONCEPT ONLY AND WILL BE TENANT PROVIDED.

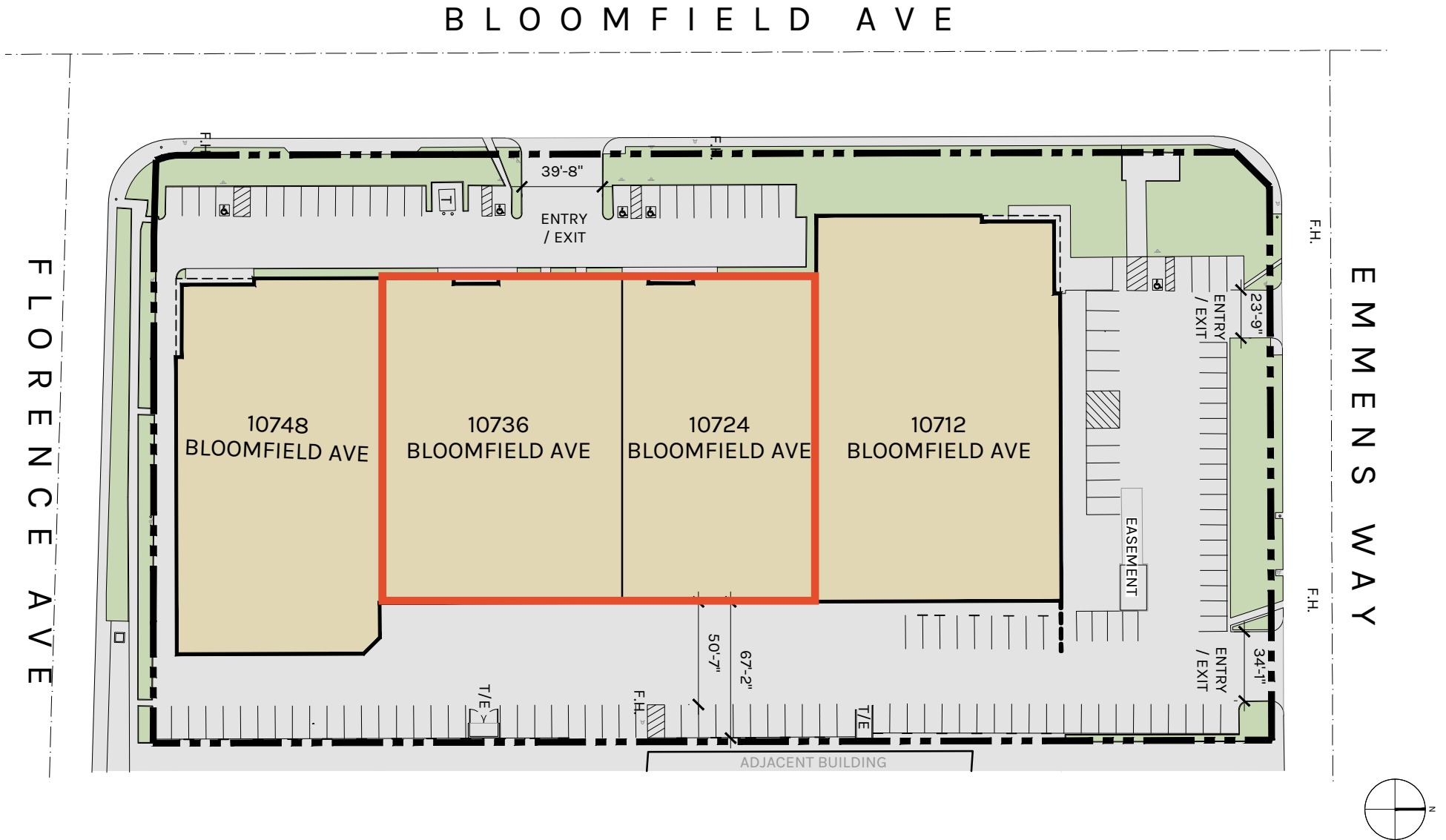

WAREHOUSE
28,769 SF

OFFICE
1,990 SF

TOTAL
30,759 SF

PLAN LAYOUT SUBJECT TO FIELD CONDITIONS AND MAY DIFFER FROM PLAN AS SHOWN. ALL INFORMATION PRESENTED ON THIS DRAWING IS PRESUMED TO BE ACCURATE, HOWEVER TENANT SHOULD VERIFY PERTINENT INFORMATION PRIOR TO COMMITTING TO A LEASE. ANY FURNITURE OR APPLIANCES SHOWN ON PLAN ARE FOR CONCEPT ONLY AND WILL BE TENANT PROVIDED.

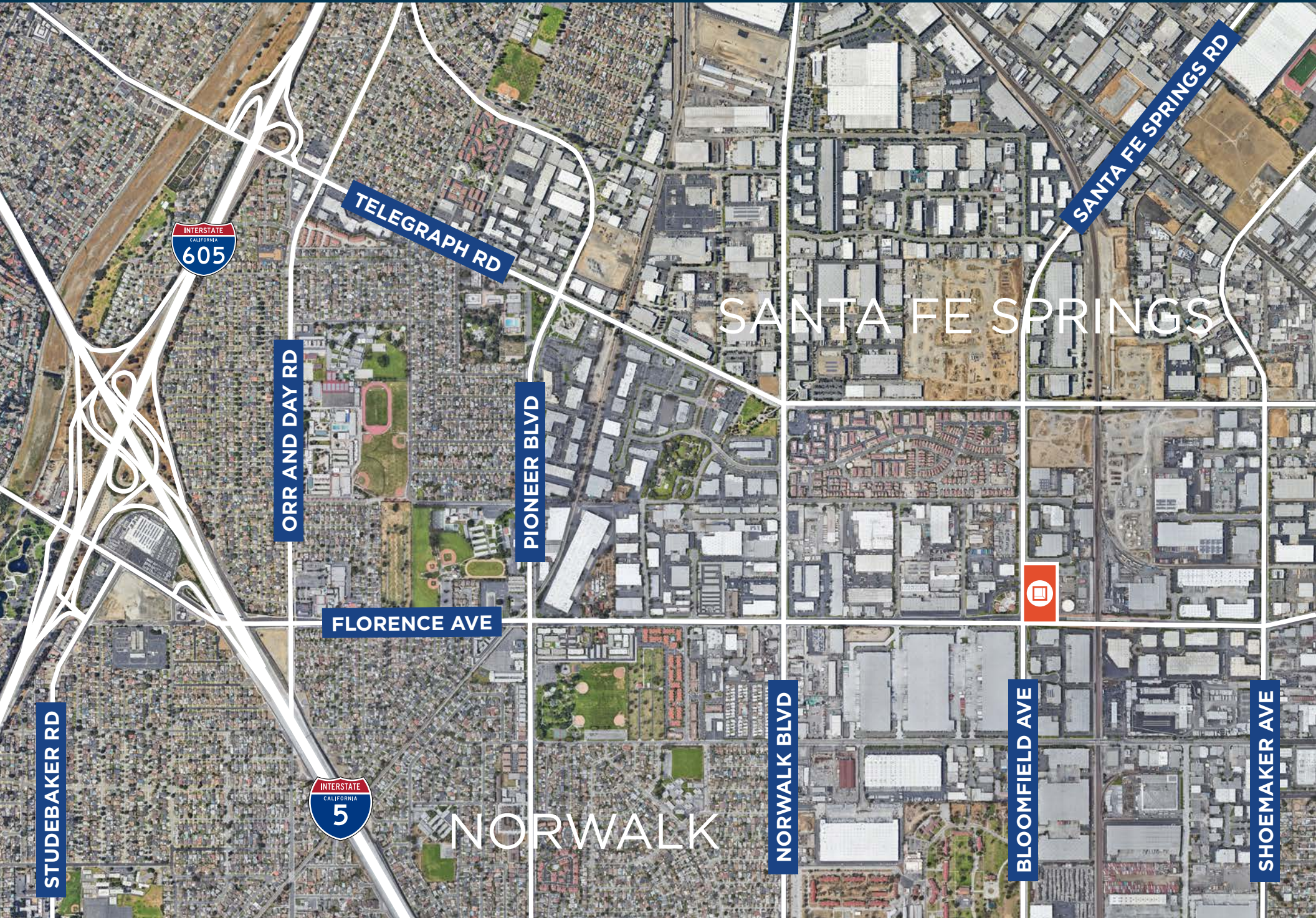

TELEGRAPH RD

SANTA FE SPRINGS RD

SANTA FE SPRINGS

ORR AND DAY RD

PIONEER BLVD

FLORENCE AVE



STUDEBAKER RD

NORWALK

NORWALK BLVD

BLOOMFIELD AVE

SHOEMAKER AVE

Location

10724-10736 BLOOMFIELD AVENUE



1.7 Miles to (5) Freeway	2.0 Miles to (605) Freeway
14 Miles to Downtown Los Angeles	22 Miles to Los Angeles International Airport
20 Miles to Port of Long Beach	22 Miles to Port of Los Angeles



**Rexford
Industrial**

Leasing Contacts

JOHN MCMILLAN

Vice Chairman

t 310-491-2048

john.mcmillan@nmrk.com

CA RE License #01103292

CONNOR REEVES

Senior Managing Director

t 310-491-2088

connor.reeves@nmrk.com

CA RE License #01983477

ANDREW CONROY

Transaction Manager

t 310-491-2085

andrew.conroy@nmrk.com

CA RE License #02143325

NEWMARK

Newmark

2301 Rosecrans Ave

Suite 4100

El Segundo, CA 90245

t 310-491-2000

nmrk.com

Corporate License #01355491

The information contained herein has been obtained from sources deemed reliable but has not been verified and no guarantee, warranty or representation, either express or implied, is made with respect to such information. Terms of sale or lease and availability are subject to change or withdrawal without notice.