

# CUPERTINO CIVIC PARK

20370, 20380 & 20410  
TOWN CENTER LANE

±446 SF TO ±1,800 SF  
AVAILABLE FOR LEASE

**NEWMARK**

**JOHN MCKENNA**

650.688.8548

[john.mckenna@nmrk.com](mailto:john.mckenna@nmrk.com)

CA RE License #01276576

**SKYLAR SMITH**

949.637.2857

[skylar.smith@nmrk.com](mailto:skylar.smith@nmrk.com)

CA RE Lic #02196285

20370  
20380  
20410  
TOWN CENTER LANE



- » Two-Story Professional Office Buildings
- » Excellent Central Cupertino Location
- » Easy Access to Highways 280 and 85
- » Covered and Surface Parking
- » Common Conference Room
- » Walking Distance to Restaurants (Chipotle, SpiceKlub, Bitter + Sweet, Kee Wah Bakery), Hotels (Juniper), and Financial Services (Wells Fargo & Chase Bank)
- » Adjacent to Cupertino Civic Center (City Hall, Community Hall, Library with Coffee Society)
- » Local Ownership & Management

CUPERTINO  
CIVIC PARK

FIRST FLOOR

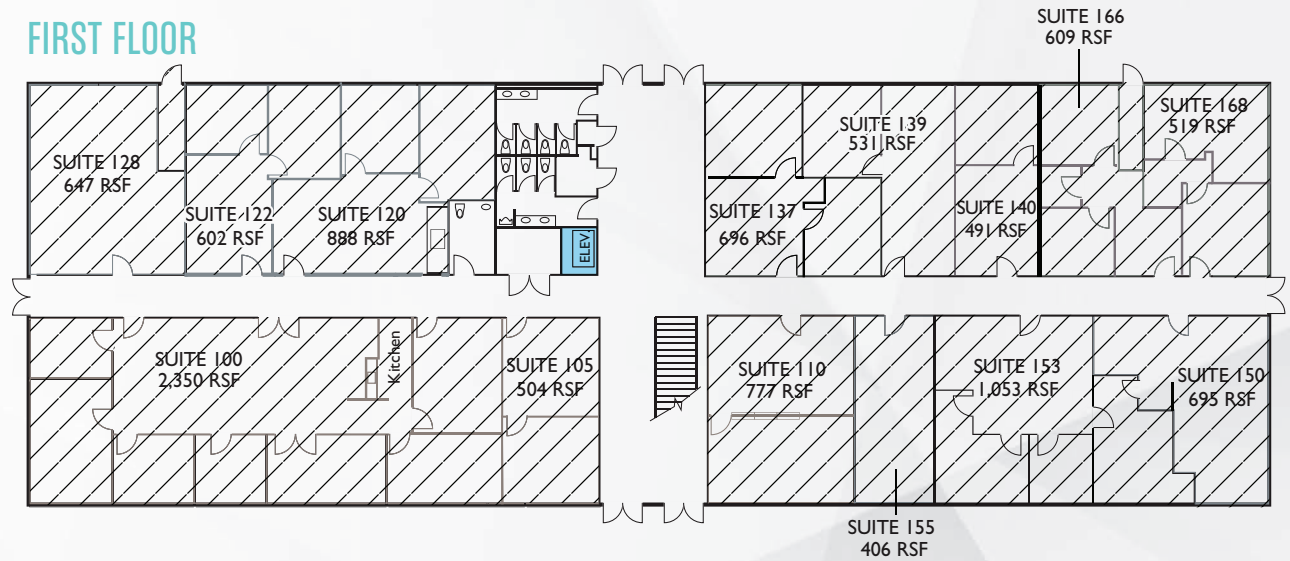

SECOND FLOOR

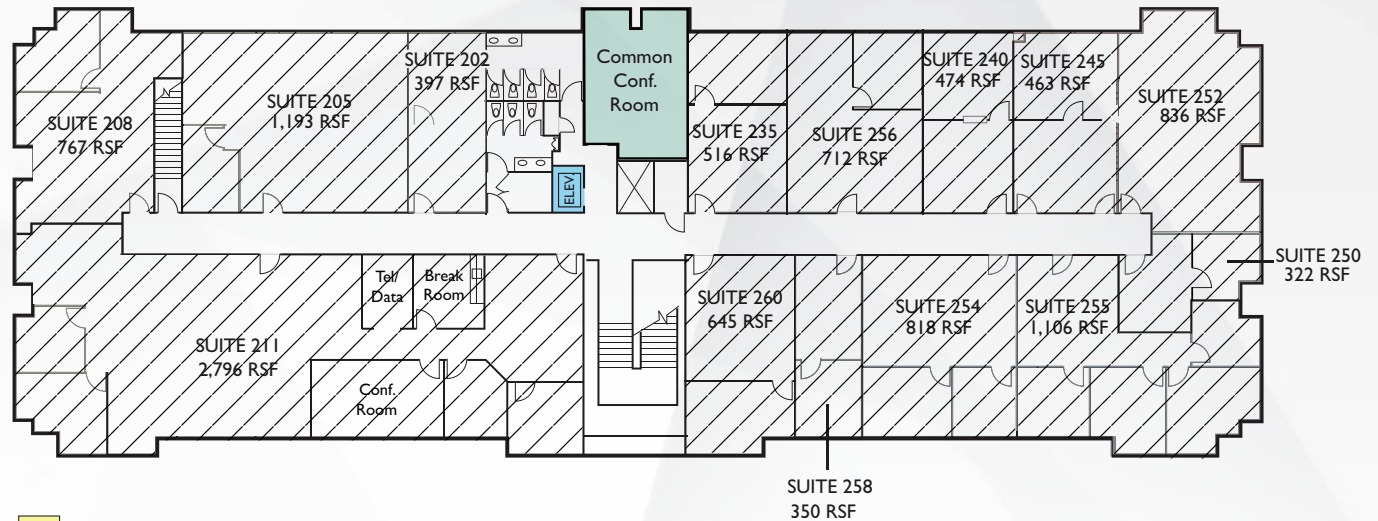

- AVAILABLE
- LEASED

FIRST FLOOR

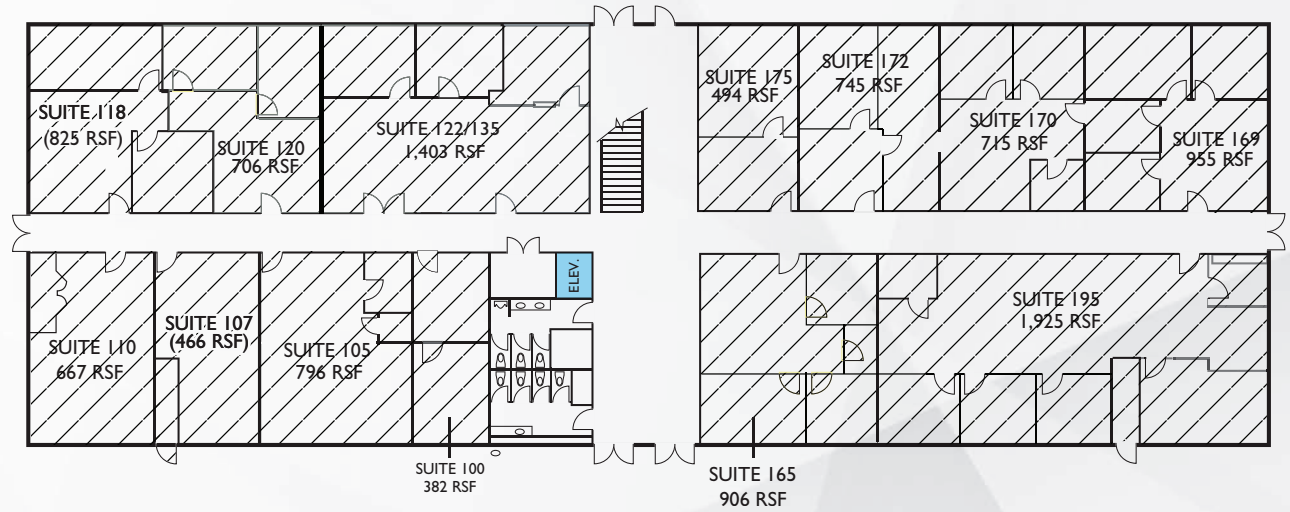

SECOND FLOOR

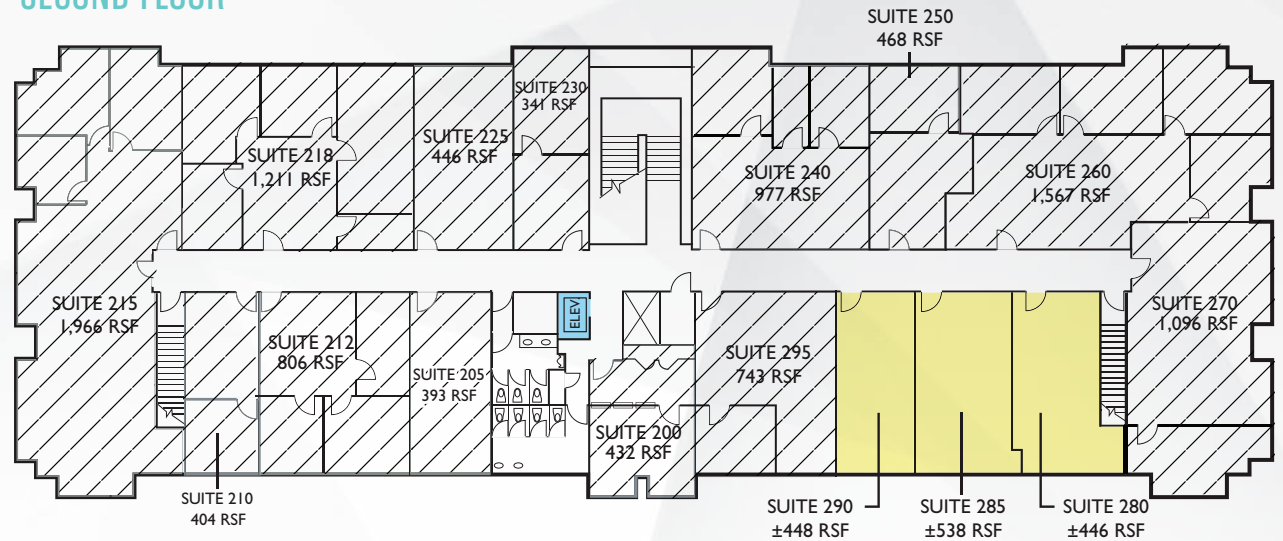

- AVAILABLE
- LEASED

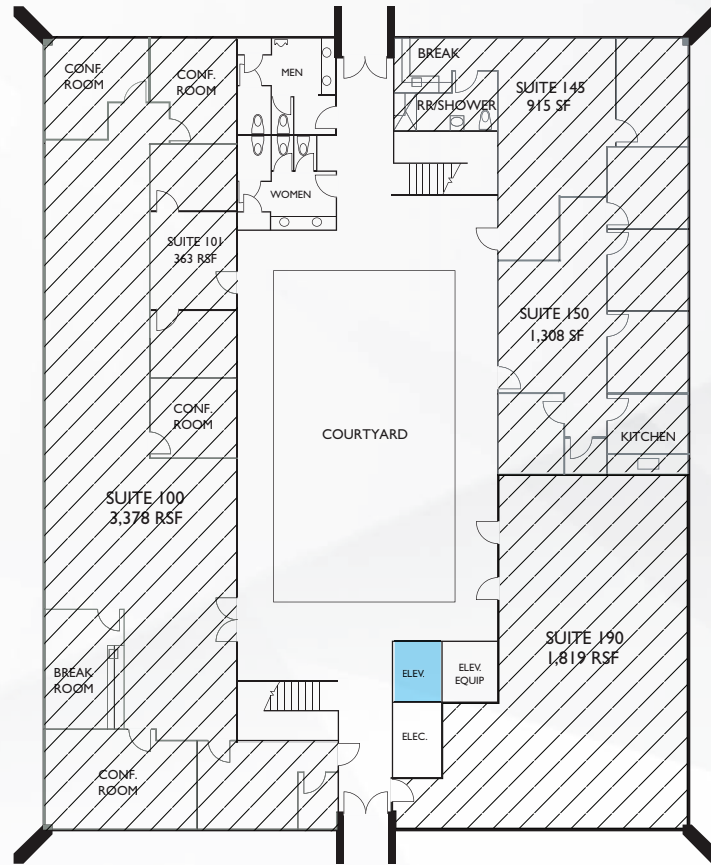

\*

FIRST FLOOR

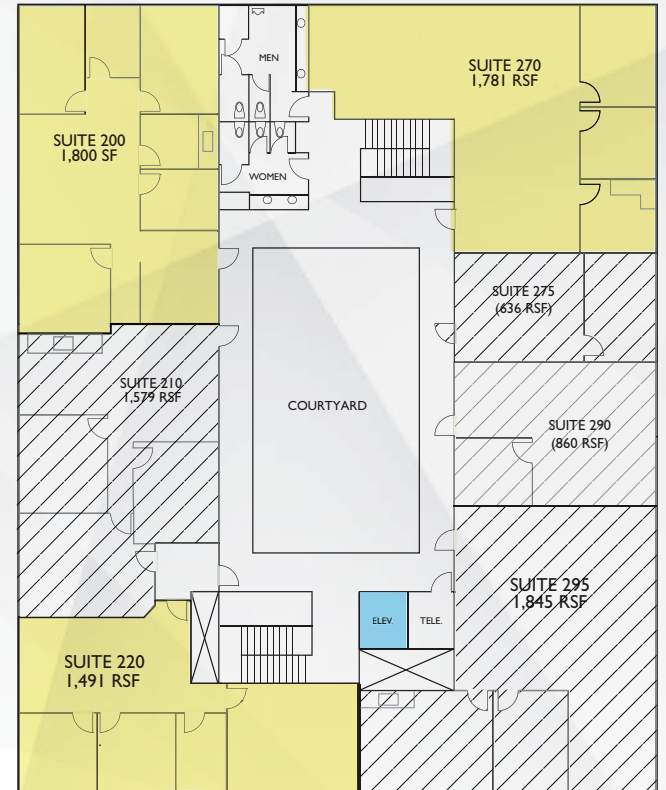

SECOND FLOOR



-  AVAILABLE
-  LEASED

# CUPERTINO CIVIC PARK

20370, 20380 & 20410  
TOWN CENTER LANE

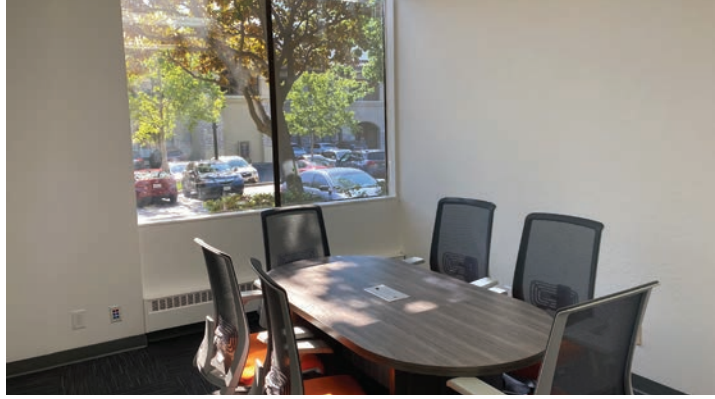

# CUPERTINO CIVIC PARK

## 20370, 20380 & 20410 TOWN CENTER LANE

**JOHN MCKENNA**  
650.688.8548  
john.mckenna@nmrk.com  
CA RE License #01276576

**SKYLAR SMITH**  
949.637.2857  
skylar.smith@nmrk.com  
CA RE Lic #02196285

The distributor of this communication is performing acts for which a real estate license is required. The information contained herein has been obtained from sources deemed reliable but has not been verified and no guarantee, warranty or representation, either express or implied, is made with respect to such information. Terms of sale or lease and availability are subject to change or withdrawal without notice. MP-514.10/24



WELLS FARGO

Combo Lockbox

20380 20370

20410

Amenities and Additional Covered Parking for Office Tenants

