

# FOR LEASE INDUSTRIAL BUILDING

TOTAL AVAILABLE  
42,000 SF

# 11 DELTA DRIVE

Londonderry, NH 03053



6 DOCKS  
1 DRIVE-IN



22'  
CLEAR HEIGHT



1600 AMPS



FULLY  
AIR-CONDITIONED

**RJKELLY**  
INVESTMENT | DEVELOPMENT | MANAGEMENT

  
**THE BOULOS  
COMPANY**

# PROPERTY OVERVIEW

11 Delta Drive is a 42,000 SF industrial warehouse building with the entire space available for lease. Built in 1989, the building features 22' warehouse clear height, six loading docks and one oversized drive-in door. This fully air-conditioned building is serviced by municipal water & sewer and is heated by natural gas. It offers two power services: 400 amps at 277/480V and 1,200 amps at 120/208V.

11 Delta Drive is situated in the vicinity of the Manchester-Boston Regional Airport, making it highly desirable for warehouse distribution companies that require immediate access to the airport. The property is approximately two miles from the F.E. Everett Turnpike and Interstates 293 and 93, providing quick and easy access to major highways leading to points north, south, east and west. Boston is within a 50 minute ride via Interstate 93. Industrial neighbors include, FedEx, Wurth Baer, US NCR, Visual Edge IT New England and TruGreen Lawn Care.



# BUILDING SPECIFICATIONS

<b>BUILDING SIZE</b>	42,000± SF	<b>HVAC</b>	100% air-conditioned; gas heat
<b>AVAILABLE SPACE</b>	42,000± SF	<b>LOADING</b>	6 docks, 1 drive-in door
<b>BUILDING TYPE</b>	Industrial	<b>CLEAR HEIGHT</b>	22'
<b>YEAR BUILT</b>	1989	<b>ZONING</b>	Industrial II
<b>PARKING RATIO</b>	1.2/1,000 SF	<b>POWER</b>	400 amps at 277/480V 1200 amps at 120/208V
<b>UTILITIES</b>	Municipal water & sewer	<b>LEASE RATE</b>	\$14.00/SF NNN

## FLOOR PLAN - 42,000± SF

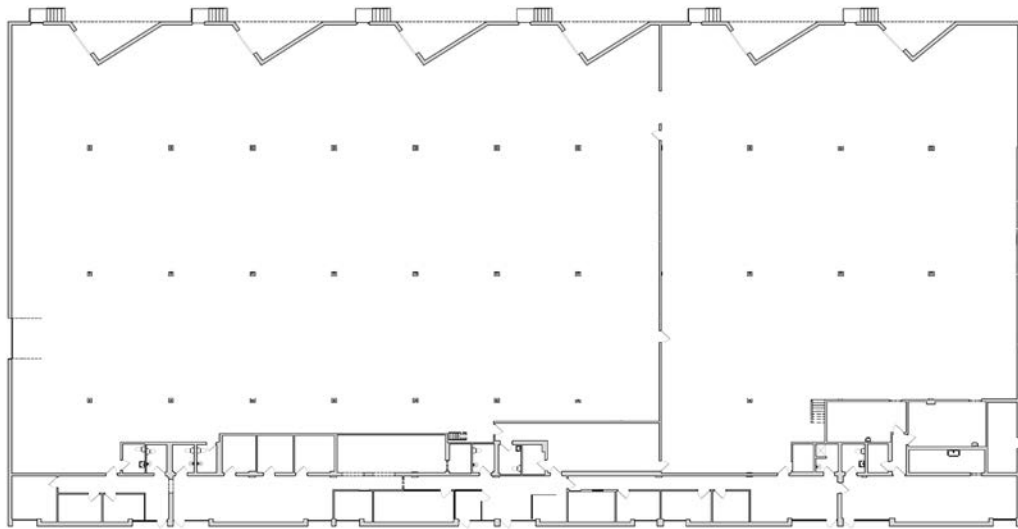

## LOCAL ECONOMIC OVERVIEW

Londonderry, New Hampshire is home to approximately 25,000 residents and serves as a popular bedroom community for the Greater Boston area. A member of Rockingham County, Hudson is bordered by the New Hampshire communities of Nashua, Merrimack, Litchfield, Londonderry, Windham, Pelham and Tyngsborough, Massachusetts. The town sits on the Massachusetts-New Hampshire line and is conveniently located directly across the Merrimack River from the bustling city Manchester just 10 miles away—making the town highly accessible to three of New England's largest employment hubs and an attractive relocation destination.

Two major airports service the Londonderry area: Boston-Manchester Regional Airport in Manchester, New Hampshire and Logan International Airport in Boston, Massachusetts. Though Boston-Manchester Regional Airport is only 5 minutes away from Londonderry and serves a variety of national destinations, daily shuttle buses between Londonderry and Logan Airport run consistently.

# AERIAL OVERVIEW



## CONTACT US



**MICHAEL TAMPOSI**  
Broker | Partner  
+1 603.333.1333 D  
+1 603.315.4348 C  
mtamposi@boulos.com



**ROGER DIEKER**  
Managing Broker | Partner  
+1 603.333.1333 D  
+1 603.540.8315 C  
rdieker@boulos.com

©2026 Boulos Holdings, LLC d/b/a The Boulos Company. All rights reserved. This information has been obtained from sources believed reliable, but has not been verified for accuracy or completeness. You should conduct a careful, independent investigation of the property and verify all information. Any reliance on this information is solely at your own risk. The Boulos Company and The Boulos Company logo are service marks of The Boulos Company, Inc. and Boulos Holdings, LLC. All other marks displayed on this document are the property of their respective owners. Photos herein are the property of their respective owners. Use of these images without the express written consent of the owner is prohibited.

**BROKERAGE RELATIONSHIP DISCLOSURE FORM**  
**(This is Not a Contract)**

*This form shall be presented to the consumer at the time of first business meeting, prior to any discussion of confidential information*

**Right Now, You Are a Customer**

As a customer, the licensee with whom you are working is not obligated to keep confidential the information that you might share with him or her. As a customer, you should not reveal any confidential information that could harm your bargaining position.

**As a customer, you can expect a real estate licensee to provide the following customer-level services:**

- To disclose all material defects known by the licensee pertaining to the on-site physical condition of the real estate;
- To treat both the buyer/tenant and seller/landlord honestly;
- To provide reasonable care and skill;
- To account for all monies received from or on behalf of the buyer/tenant or seller/landlord relating to the transaction;
- To comply with all state and federal laws relating to real estate brokerage activity; and
- To perform ministerial acts, such as showing property, preparing, and conveying offers, and providing information and administrative assistance.

**To Become a Client**

Clients receive more services than customers. You become a client by entering into a written contract for representation as a seller/landlord or as a buyer/tenant.

**As a client, in addition to the customer-level services, you can expect the following client-level services**

- Confidentiality;
- Loyalty;
- Disclosure;
- Lawful Obedience; and
- Promotion of the client's best interest.
- For seller/landlord clients this means the agent will put the seller/landlord's interests first and work on behalf of the seller/landlord.
- For buyer/tenant clients this means the agent will put the buyer/tenant's interest first and work on behalf of the buyer/tenant.

**Client-level services also include advice, counsel, and assistance in negotiations.**

**For important information about your choices in real estate relationships, please see page 2 of this disclosure form.**

I acknowledge receipt of this disclosure as required by the New Hampshire Real Estate Commission (Pursuant to Rea 701.01).  
**I understand as a customer I should not disclose confidential information.**

Name of Consumer (Please Print)		Name of Consumer (Please Print)	
Signature of Consumer	Date	Signature of Consumer	Date
Provided by: Name & License #		Date	(Name and License # of Real Estate Brokerage Firm)
_____ consumer has declined to sign this form (Licensees Initials)			

## *Types of Brokerage Relationships commonly practiced in New Hampshire*

### *SELLER AGENCY (RSA 331-A:25-b)*

A seller agent is a licensee who acts on behalf of a seller or landlord in the sale, exchange, rental, or lease of real estate. The seller is the licensee's client, and the licensee has the duty to represent the seller's best interest in the real estate transaction.

### *BUYER AGENCY (RSA 331-A:25-c)*

A buyer agent is a licensee who acts on behalf of a buyer or tenant in the purchase, exchange, rental, or lease of real estate. The buyer is the licensee's client, and the licensee has the duty to represent the buyer's best interests in the real estate transaction.

### *SINGLE AGENCY (RSA 331-A:25-b; RSA 331-A:25-c)*

Single agency is a practice where a firm represents the buyer only, or the seller only, but never in the same transaction. Disclosed dual agency cannot occur.

### *SUB-AGENCY (RSA 331-A:2, XIII)*

A sub-agent is a licensee who works for one firm but is engaged by the principal broker of another firm to perform agency functions on behalf of the principal broker's client. A sub-agent does not have an agency relationship with the customer.

### *DISCLOSED DUAL AGENCY (RSA 331-A:25-d)*

A disclosed dual agent is a licensee acting for both the seller/landlord and the buyer/tenant in the same transaction with the knowledge and written consent of all parties.

The licensee cannot advocate on behalf of one client over another. Because the full range of duties cannot be delivered to both parties, written informed consent must be given by all clients in the transaction.

A dual agent may not reveal confidential information without written consent, such as:

1. Willingness of the seller to accept less than the asking price.
2. Willingness of the buyer to pay more than what has been offered.
3. Confidential negotiating strategy not disclosed in the sales contract as terms of the sale.
4. Motivation of the seller for selling nor the motivation of the buyer for buying.

### *DESIGNATED AGENCY (RSA 331-A:25-e)*

A designated agent is a licensee who represents one party of a real estate transaction and who owes that party client-level services, whether or not the other party to the same transaction is represented by another individual licensee associated with the same brokerage firm.

### *FACILITATOR (RSA 331-A:25-f)*

A facilitator is an individual licensee who assists one or more parties during all or a portion of a real estate transaction without being an agent or advocate for the interests of any party to such transaction. A facilitator can perform ministerial acts, such as showing property, preparing and conveying offers, and providing information and administrative assistance, and other customer-level services listed on page 1 of this form. This relationship may change to an agency relationship by entering into a written contract for representation, prior to the preparation of an offer.

### *ANOTHER RELATIONSHIP (RSA 331-A:25-a)*

If another relationship between the licensee who performs the service and the seller, landlord, buyer or tenant is intended, it must be described in writing and signed by all parties to the relationship prior to services being rendered.