



Space for Recharge

175,557 RSF // 4 BUILDING CAMPUS



PACIFIC OAK
Keppel Pacific Oak US REIT



TRANSWESTERN

Westech 360, a four-building, Class A office campus on North Capital of Texas Highway Loop 360 in Northwest Austin, offers newly designed, move-in-ready suites with access to numerous surrounding business centers and shopping and dining hubs including The Arboretum, one of Austin's top retail destinations, just a two-minute drive away.

THE OVER 175,000 SF CAMPUS IS WELL-SERVED BY TWO HIGHWAYS, ENJOYS EXCELLENT INGRESS AND EGRESS AT A LIGHTED INTERSECTION AND HAS PROMINENT VISIBILITY FROM LOOP 360.

TAKE A LOOK FROM A BIRD'S-EYE VIEW

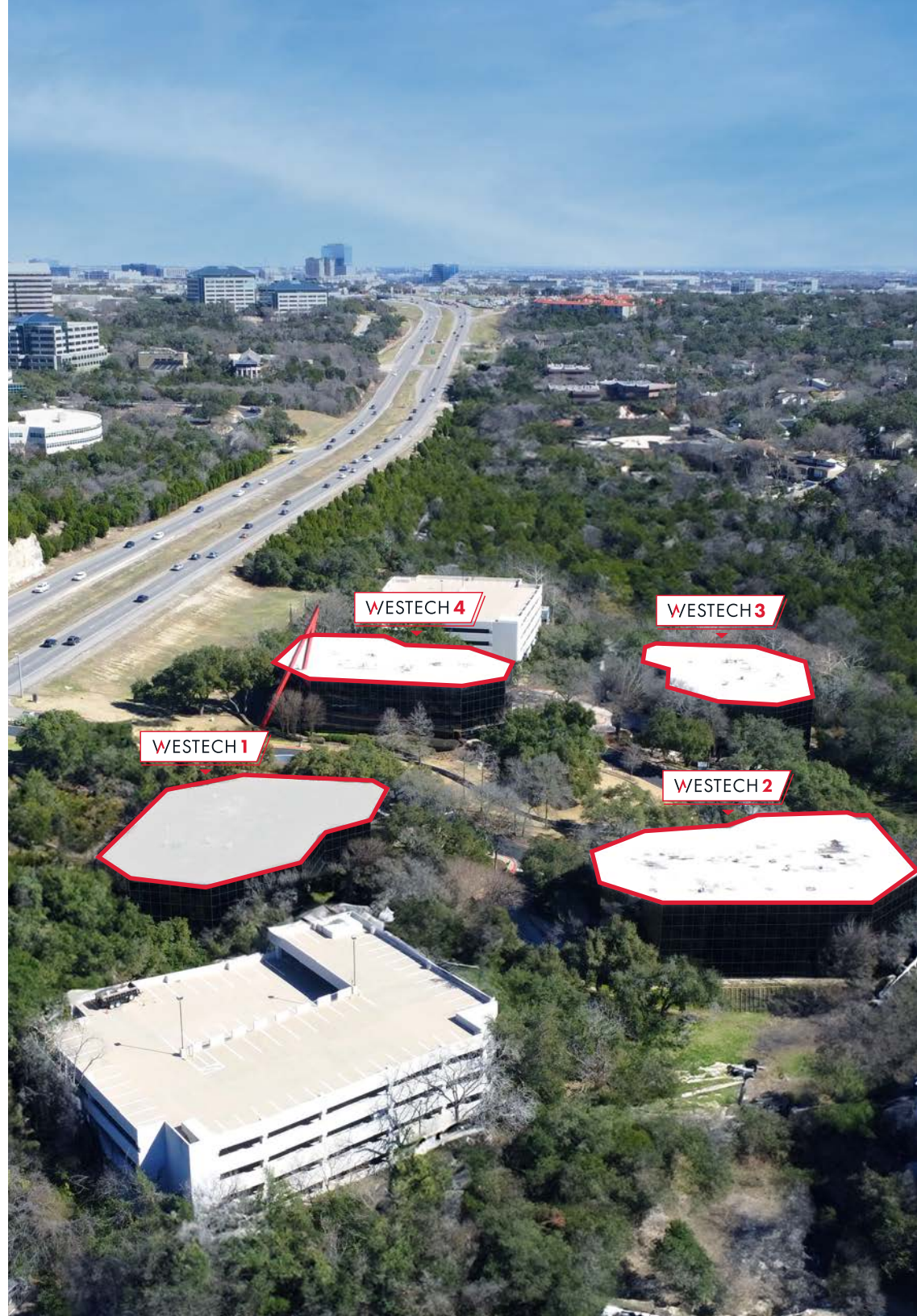

DELIVERING Q1 2026

Move-In Ready Spec Suites

Experience turnkey workspaces designed for the way you work today. Our new, fully built-out spec suites make moving in effortless. Just bring your team and get started.

Ranging from 3,276–4,239 SF, each suite features modern finishes, efficient layouts, and thoughtful design to support productivity and collaboration.

[CLICK TO VIEW THE FLOORPLANS](#)

SPEC SUITE 1250

SPEC SUITE 2220

SPEC SUITE 4140

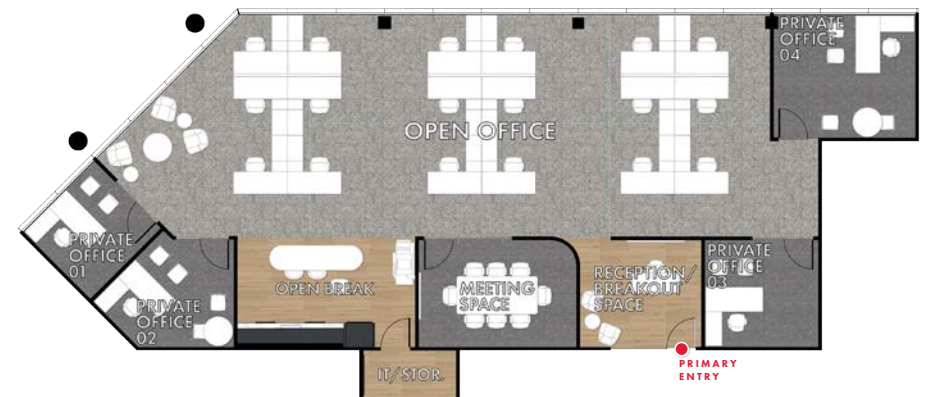

SAMPLE FLOORPLATE ▲

[PREVIEW THE FINISHES ▶](#)

175,557 RSF | 4 BUILDING CAMPUS

Providing the Perfect Environment

CLICK TO VIEW AVAILABILITIES FOR EACH BUILDING

WESTECH 1

[VIEW AVAILABILITIES](#)

WESTECH 2

[VIEW AVAILABILITIES](#)

WESTECH 3

[VIEW AVAILABILITIES](#)

WESTECH 4

[VIEW AVAILABILITIES](#)



Building Features & Amenities

- Newly Renovated Lobbies
- Reservable Common Conference Center
- Fitness Center with Shower Facilities
- On-site Food & Beverage with Lunchdrop Service
- Rotating Food Trucks



CONFERENCE CENTER



OUTDOOR PATIO SEATING



FITNESS CENTER

NEWLY RENOVATED LOBBIES

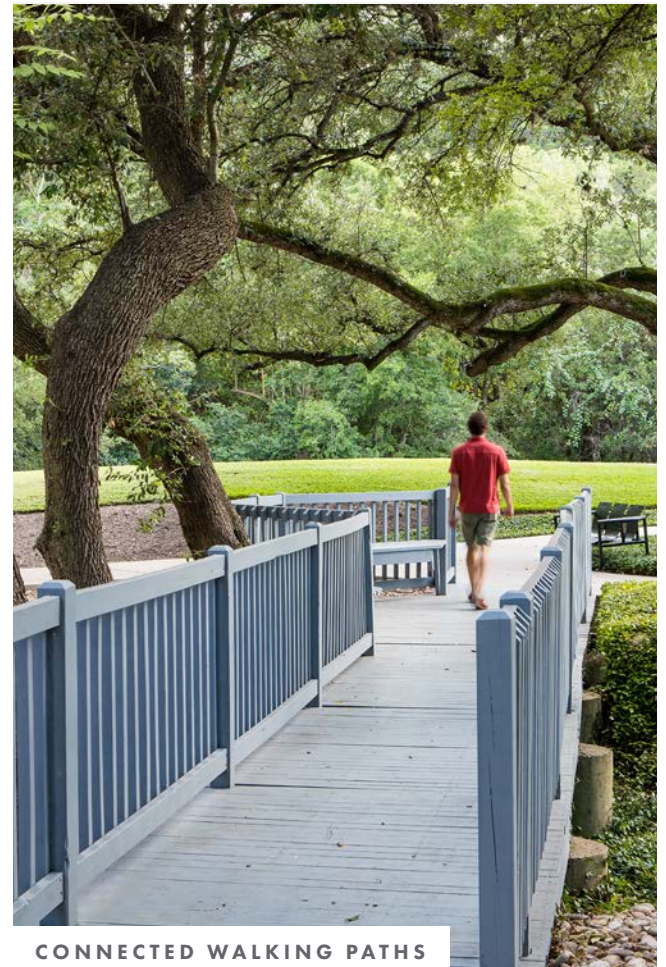

CONNECTED WALKING PATHS

- Outdoor Gathering Area
- Excellent Ingress/Egress at Lighted Intersection
- 3.5:1000 Structured Parking Garage
- Bipolar Ionization HVAC
- On-site Property Management
- Monument Signage Opportunities

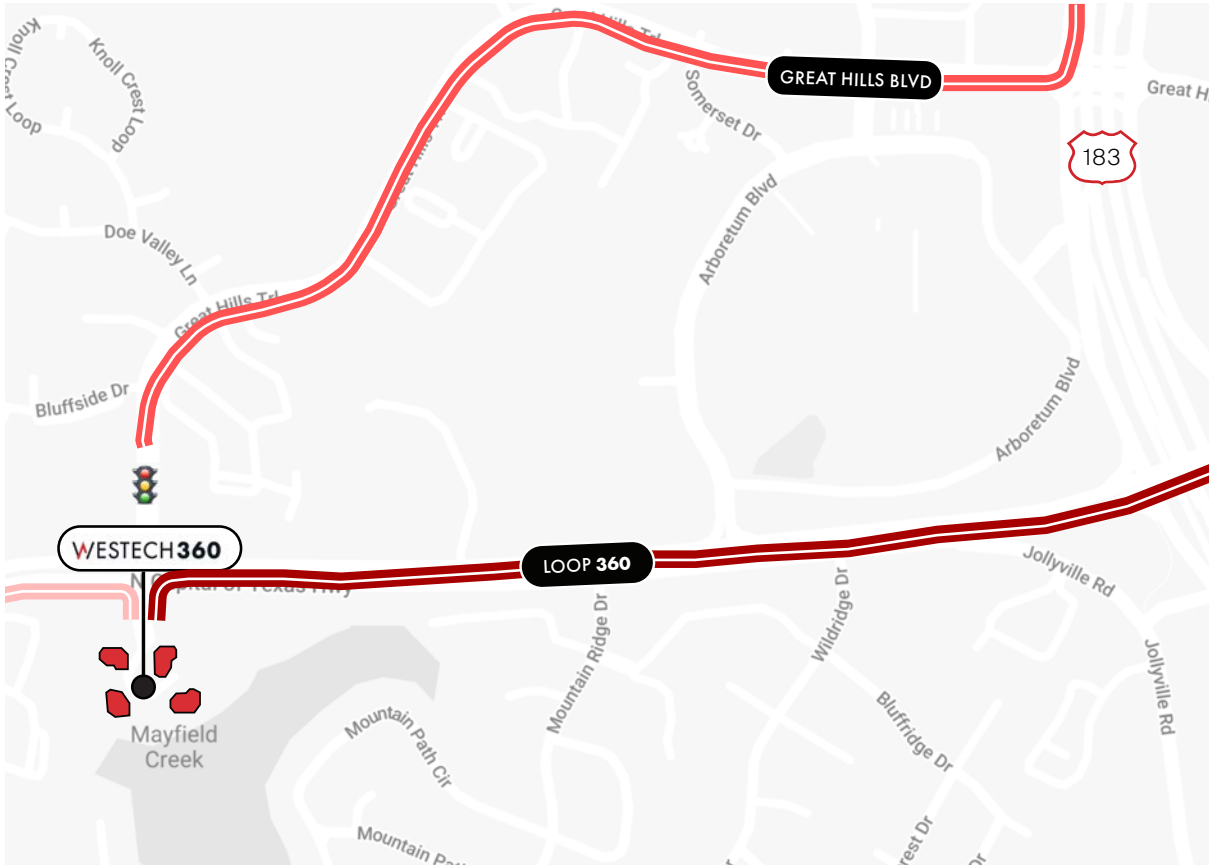

Premier Location

RIGHT OFF OF
LOOP 360

EXPLORE THE NEIGHBORHOOD

DRIVE TIMES
(MINUTES)

1

BULL CREEK
GREENBELT

2

THE
ARBORETUM

7

PENNYBACKER BRIDGE
OVERLOOK

10

THE
DOMAIN

12

Q2 STADIUM

15

AUSTIN CBD







WESTECH360

For leasing information, please contact:

BRANDON LESTER

512.314.3576

BRANDON.LESTER@TRANSWESTERN.COM

CONNOR ATCHLEY

512.314.3557

CONNOR.ATCHLEY@TRANSWESTERN.COM

CARLY LANGLEY

512.314.3991

CARLY.LANGLEY@TRANSWESTERN.COM



PACIFIC OAK
Keppel Pacific Oak US REIT

 TRANSWESTERN