

FOR SUBLEASE

±8,528 SF

INDUSTRIAL UNIT
\$1.55 GROSS PER SF

SUBLEASE THRU JUNE 30, 2028

MOTIVATED
SUBLESSOR



9753

INDEPENDENCE AVENUE

CHATSWORTH, CA

PROPERTY HIGHLIGHTS



LOCATED IN HIGH IMAGE
CHATSWORTH BUSINESS PARK



200 AMPS, 120/208 VOLTS



1 REAR GROUND LEVEL
LOADING DOOR



INCREDIBLE TRUCK ACCESS
- FULL DRIVE AROUND ACCESS



15' CLEAR HEIGHT



1,325 SF OFFICE SPACE



3 RESTROOMS



1 BLOCK FROM DE SOTO AVENUE

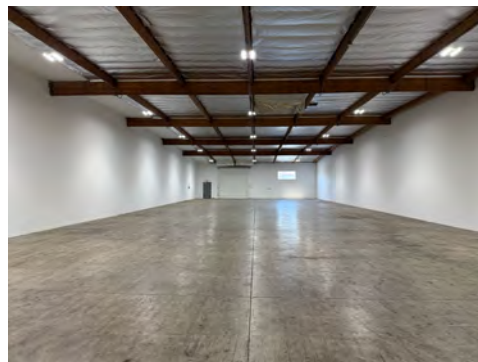

spectrumcre.com | 818.252.9900

SPECTRUM
COMMERCIAL REAL ESTATE, INC.



RON KASSAN

Executive Vice President
818.512.5001
ron@availablewarehouses.com
CA DRE Lic. #01063078



ART MINASSIAN

Senior Vice President
818.634.3722
art@availablewarehouses.com
CA DRE Lic. #02026662



No warranty, express or implied, is made as to the accuracy of the information contained herein. This information is submitted subject to errors, omission, change of price, rental or other conditions, withdrawal without notice, and is subject to any special listing conditions imposed by our principals. Cooperating brokers, buyers, tenants and other parties who receive this document should not rely on it, but should use it as a starting point of analysis, and should independently confirm the accuracy of the information contained herein through a due diligence review of the books, records, files and documents that constitute reliable sources of the information described herein. Spectrum Commercial Real Estate, Inc. CA DRE #02042805

9753

INDEPENDENCE AVENUE

CHATSWORTH, CA

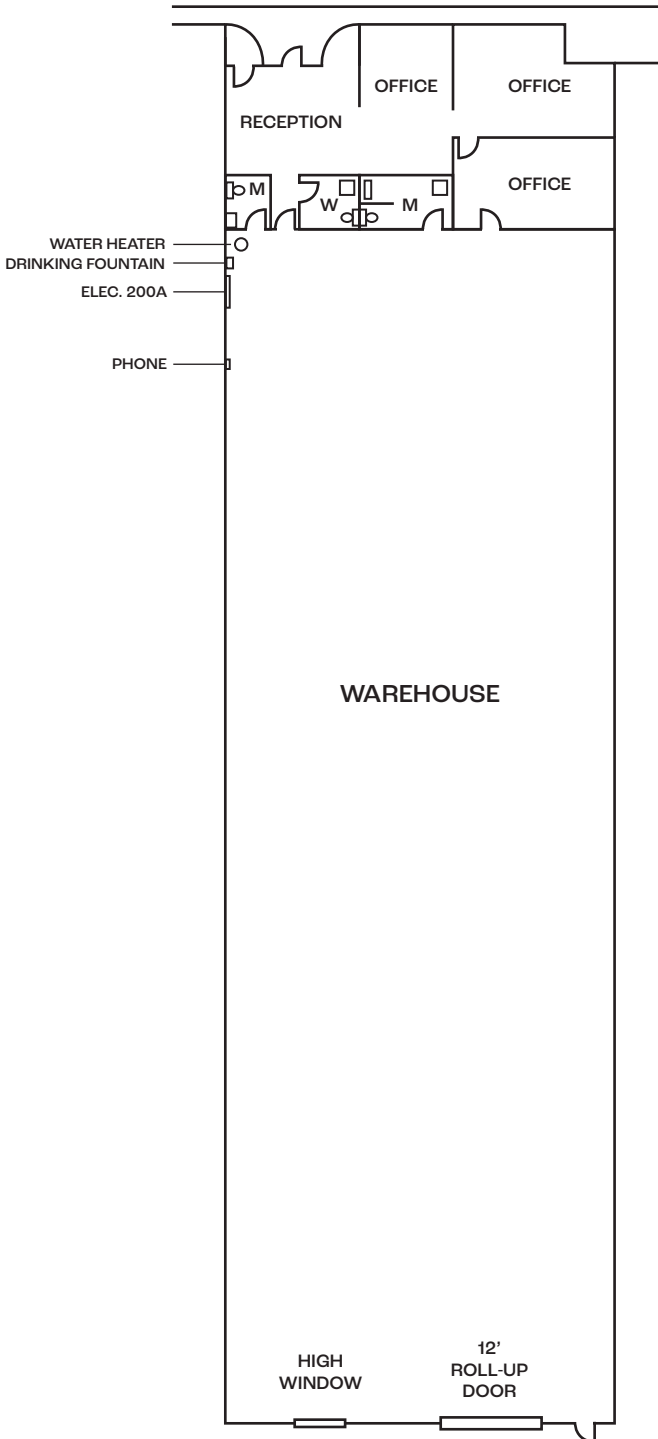

spectrumcre.com | 818.252.9900

SPECTRUM
COMMERCIAL REAL ESTATE, INC.



RON KASSAN

Executive Vice President
818.512.5001
ron@availablewarehouses.com
CA DRE Lic. #01063078



ART MINASSIAN

Senior Vice President
818.634.3722
art@availablewarehouses.com
CA DRE Lic. #02026662



No warranty, express or implied, is made as to the accuracy of the information contained herein. This information is submitted subject to errors, omission, change of price, rental or other conditions, withdrawal without notice, and is subject to any special listing conditions imposed by our principals. Cooperating brokers, buyers, tenants and other parties who receive this document should not rely on it, but should use it as a starting point of analysis, and should independently confirm the accuracy of the information contained herein through a due diligence review of the books, records, files and documents that constitute reliable sources of the information described herein. Spectrum Commercial Real Estate, Inc. CA DRE #02042805