

Geneva, IL • SEC Roosevelt & Kirk

LFI

LOCATION FINDERS INTERNATIONAL, INC.

PROPERTY HIGHLIGHTS

- Site Area: 4.3 acres
- Great location for medical offices
- Ideal bank, restaurant, pharmacy, hospitality, and retail site
- Geneva's new East Side Gateway
- Over 50,000 vehicles per day
- Sewer & water to site
- Two signalized intersections

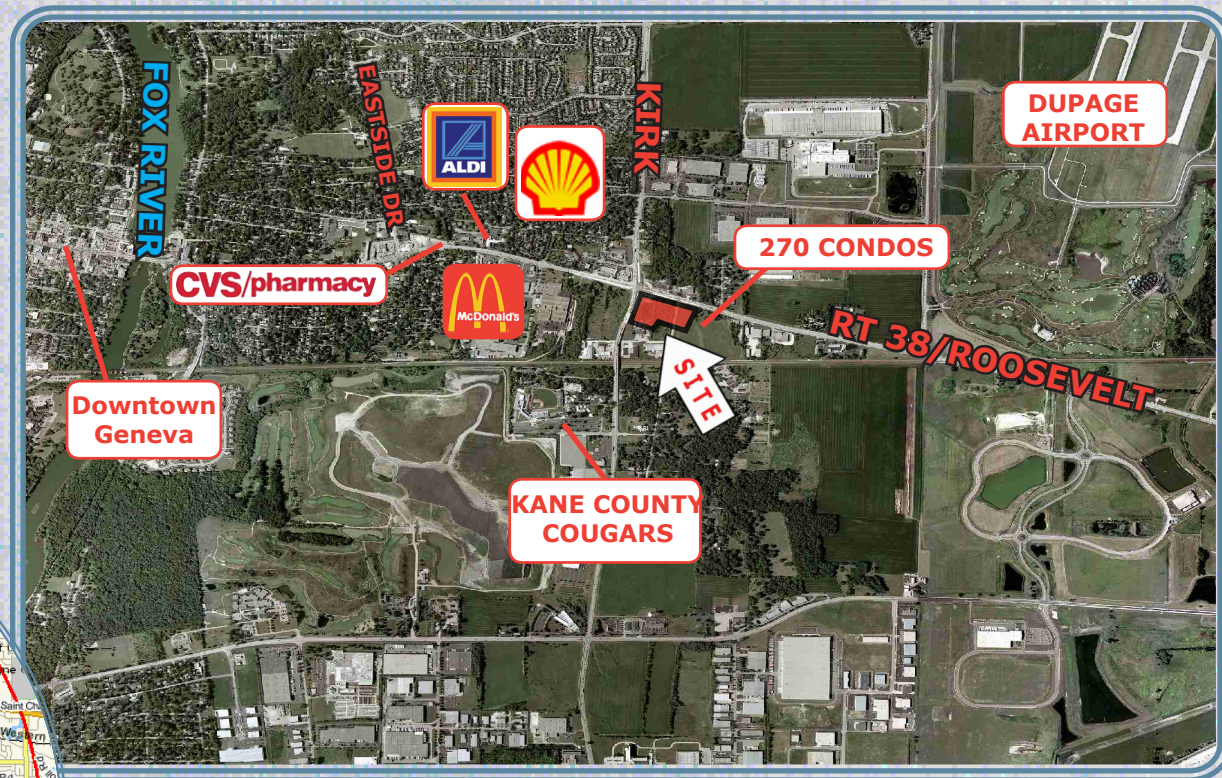

Geneva, IL • SEC Roosevelt & Kirk

	3 mile	5 mile
• Population	44,300	129,413
• Number of Households	16,144	43,184
• Average Household Income	\$90,485	\$102,152

For more information contact Tim Rose 708.390.1611 timrose@lfirealestate.com or Rudy Rosen 708.390.1626 rosen@lfirealestate.com
www.lfirealestate.com

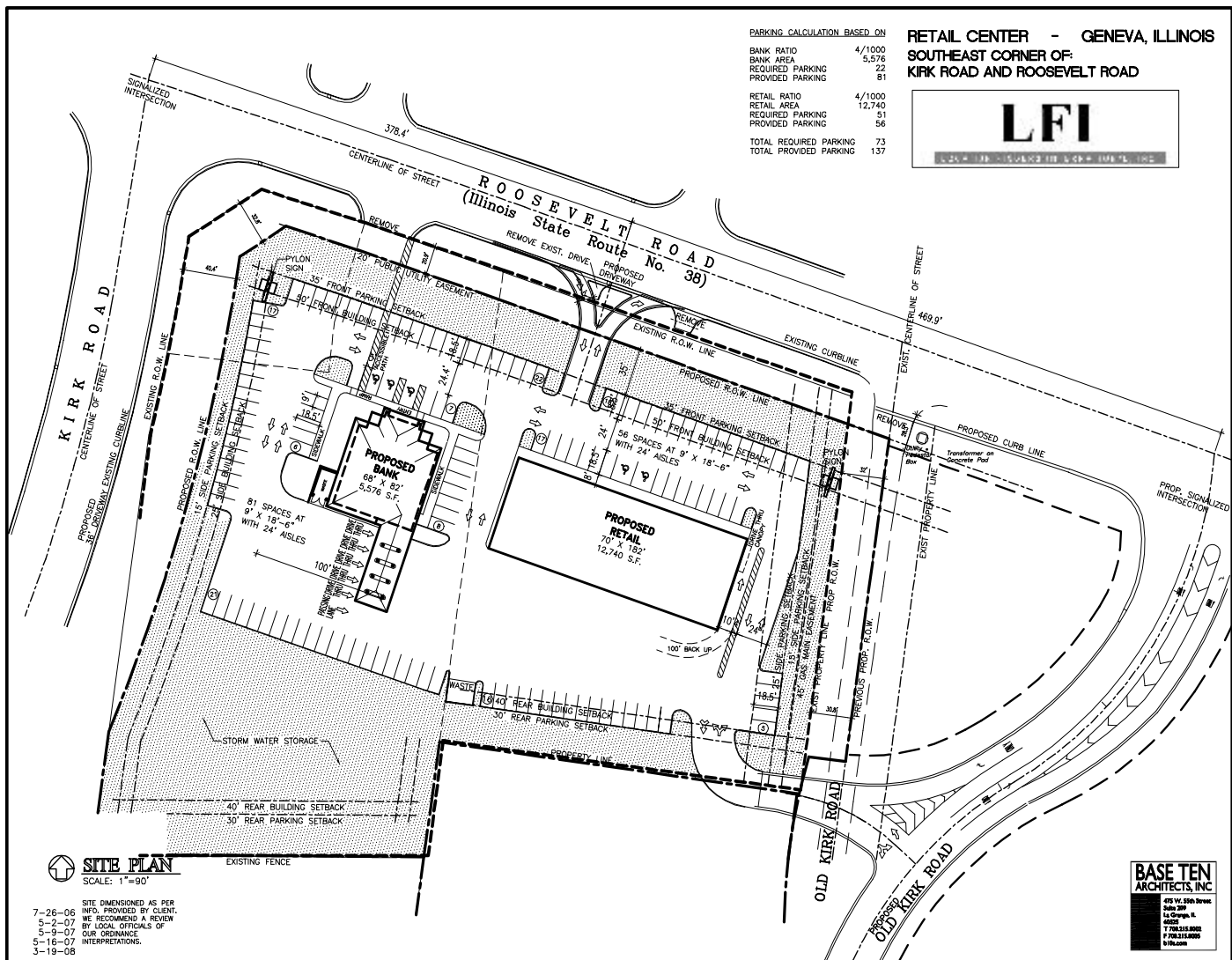

Geneva, IL • SEC Roosevelt & Kirk

LFI

LOCATION FINDERS INTERNATIONAL, INC.

For more information contact Tim Rose 708.390.1611 timrose@lfirealestate.com or Rudy Rosen 708.390.1626 rosen@lfirealestate.com www.lfirealestate.com