

# 5334 SW Beaverton Hillsdale Hwy

5334 SW Beaverton Hillsdale Hwy, Portland, OR 97221



Endcap space with strong visibility along Beaverton Hillsdale Hwy. Close proximity to the new housing developments being built on the Alpenrose Dairy property. This property has easy access and off street parking. The vacancy has a grade level roll up door and one restroom.



**Available:**

**2,135 SF**

**\$28.00 PSF, NNN**

**Approx. \$8.50  
NNN**

**Ashley Rhea | [ashley@barnardcommercial.com](mailto:ashley@barnardcommercial.com)**

**503.675.0900 | [www.barnardcommercial.com](http://www.barnardcommercial.com) | Mail: 5200 Meadows Road Suite 150, Lake Oswego OR 97035**

# 5334 SW Beaverton Hillsdale Hwy

5334 SW Beaverton Hillsdale Hwy, Portland, OR 97221



## SPACE HIGHLIGHTS

- Roll up door
- 1 Restroom
- Lighted Intersection
- Pylon signage
- Off street parking



Ashley Rhea | [ashley@barnardcommercial.com](mailto:ashley@barnardcommercial.com)

503.675.0900 | [www.barnardcommercial.com](http://www.barnardcommercial.com) | Mail: 5200 Meadows Road Suite 150, Lake Oswego OR 97035

# 5334 SW Beaverton Hillsdale Hwy

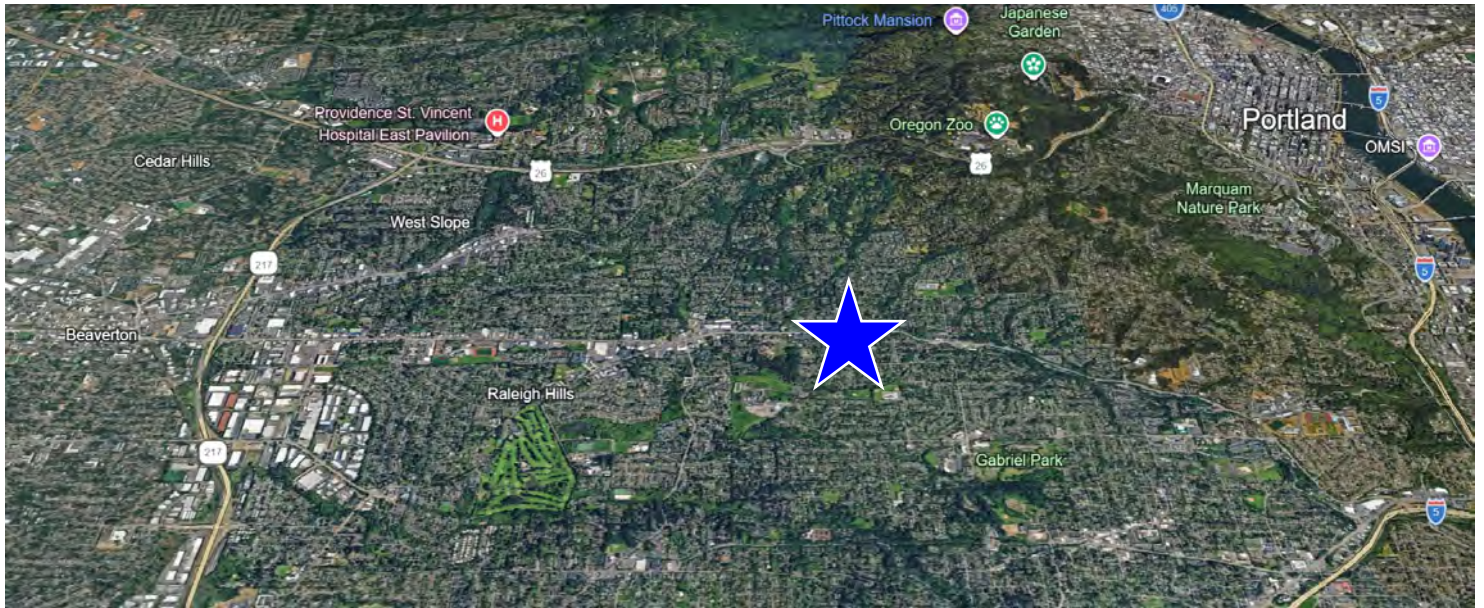

Ashley Rhea | [ashley@barnardcommercial.com](mailto:ashley@barnardcommercial.com)

503.675.0900 | [www.barnardcommercial.com](http://www.barnardcommercial.com) | Mail: 5200 Meadows Road Suite 150, Lake Oswego OR 97035

All information contained herein was obtained from sources deemed reliable. No guarantee is made with respect to accuracy. Specifications subject to change without notice.