

BUILDING H

501 WEST NORTHSHORE DRIVE

9,080 sq ft - 118,126 sq ft contiguous

W NORTHSHORE DRIVE

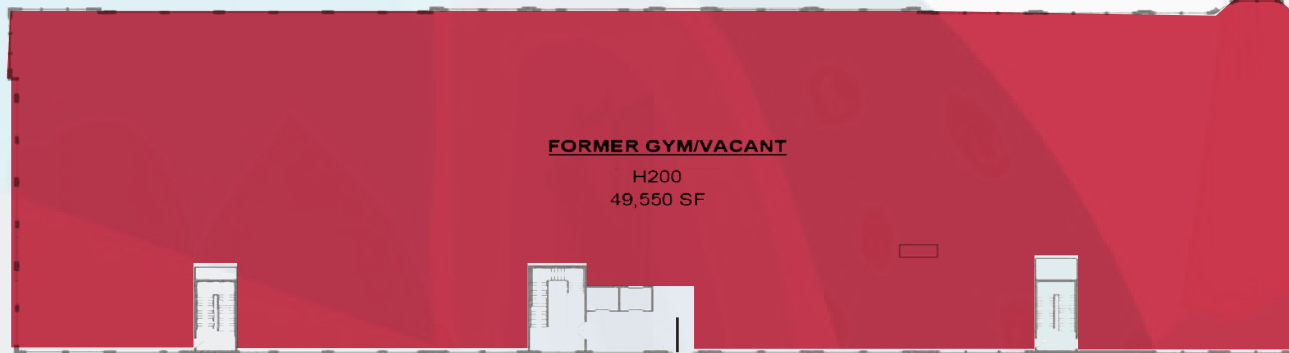

2ND FLOOR

SKYWALK ACCESS TO PARKING GARAGE



3RD FLOOR

SKYWALK ACCESS TO PARKING GARAGE



4TH FLOOR

SKYWALK ACCESS TO PARKING GARAGE

N PORT WASHINGTON ROAD