

444 South Cedros  
Ave, Suite 260  
Solana Beach, California



CREATIVE. COSTAL. CEDROS.



# LOCATION FEATURES

- IN THE HEART OF THE POPULAR CEDROS DESIGN DISTRICT
- DISTINCTIVE LANDMARK BUILDING
- NORTH COUNTY ENTERTAINMENT & NIGHTLIFE HUB
- SURROUNDED BY TRENDY SHOPS, BUSINESSES, CAFES AND WINERIES + BREWERIES
- MINUTES TO THE OCEAN - WALK, BIKE, SURF!
- NEAR HIGHWAY 101 PEDESTRIAN BRIDGE
- EASY ACCESS TO HIGHWAY 101 & I-5
- AMTRAK STATION NEARBY
- DIRECTLY ADJACENT TO BRIDGE TO COAST
- HIGHWAY CADDY CORNER TO NEW RARE SOCIETY RESTAURANT
- FARMERS MARKET ACROSS THE STREET EVERY SUNDAY
- CREATIVE & DYNAMIC WORK ENVIRONMENT
- ATTRACTIVE LOBBY AND COMMON AREAS - INCLUDING UPPER LEVEL SEATING AREA TO ENJOY THE OCEAN BREEZES

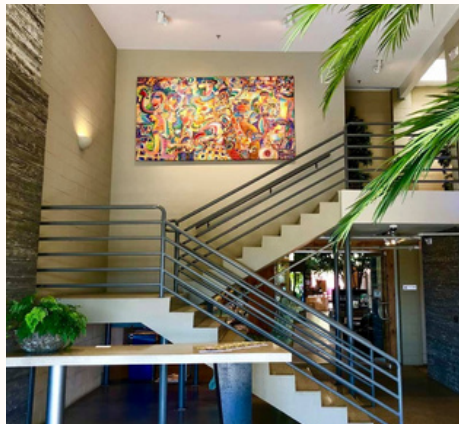

# 444 South Cedros Ave, Suite 260 Solana Beach, California

444 S. Cedros Avenue, Suite 260 Solana Beach, CA, 92075

Size: ±1,000 SF

Base Rent: \$3.75/SF

NNN's: \$0.70/SF

Available: Sixty (60) Day Notice

Suite Layout:

- Open, spacious and bright
- Hard wood floors
- Operable windows
- Photo studio set up
- Kitchen with built-in cabinets and sink
- Creative Office/ Retail space facing South Cedros

Parking: 2 Unreserved Parking Spots





444 South Cedros Ave, Suite 260  
Solana Beach, California



1: Office | 2: View of Farmers Market from suite 260 | 3: Built in Kitchen + Cabinets | 4: Common Area Patio Facing Cedros | 5: Photo Studio Set Up



# NEARBY AMENITIES



Pacific Ocean

**NAI San Diego**

**444** South Cedros Ave, Suite 260  
Solana Beach, California



**EXCLUSIVE CONTACT**

Jason Smithson  
Senior Vice President  
jsmithson@naisandiego.com  
619.241.2394  
LIC # 01477835

NO WARRANTY OR REPRESENTATION, EXPRESS OR IMPLIED, IS MADE AS TO THE ACCURACY OF THE INFORMATION CONTAINED HEREIN, AND THE SAME IS SUBMITTED SUBJECT TO ERRORS, OMISSIONS, CHANGE OF PRICE, RENTAL OR OTHER CONDITIONS, PRIOR SALE, LEASE OR FINANCING, OR WITHDRAWAL WITHOUT NOTICE, AND OF ANY SPECIAL LISTING CONDITIONS IMPOSED BY OUR PRINCIPALS NO WARRANTIES OR REPRESENTATIONS ARE MADE AS TO THE CONDITION OF THE PROPERTY OR ANY HAZARDS CONTAINED THEREIN ARE ANY TO BE IMPLIED.