

NAMPA COMMERCIAL BUILDING

# 1923 2ND STREET S

NAMPA, ID



[rallensrealty.com](http://rallensrealty.com)



**RALLENS REALTY**  
CONSULTANTS



FOR SALE



### PROPERTY INFORMATION

<b>PROPERTY TYPE</b>	Nampa Commercial Building
<b>ADDRESS</b>	1923 2nd Street S Nampa, ID 83651
<b>PURCHASE PRICE</b>	\$399,000 (\$106/SF)
<b>LOT SIZE</b>	±0.16 Acres
<b>BUILDING SIZE</b>	<b>Ground Floor:</b> ±2,295 SF <b>Basement:</b> ±1,456 SF <b>Total:</b> ±3,751SF
<b>ZONING</b>	City of Nampa - RML

### HIGHLIGHTS

- Versatile building could accommodate a wide variety of uses
- Less than ±0.5 miles from Downtown Nampa
- Building and monument signage available
- Contact Agent for showing instructions

This information, while not guaranteed, is from sources we believe to be reliable. This data is subject to price change, corrections, errors, omissions, prior sale, and/or withdrawal.

**BEN FULCHER**

208.859.7407 | [ben@rallensrealty.com](mailto:ben@rallensrealty.com)

RALLENS REALTY CONSULTANTS | 401 W FRONT ST, SUITE 307, BOISE, ID 83702 | 208.996.1055



## Floorplan

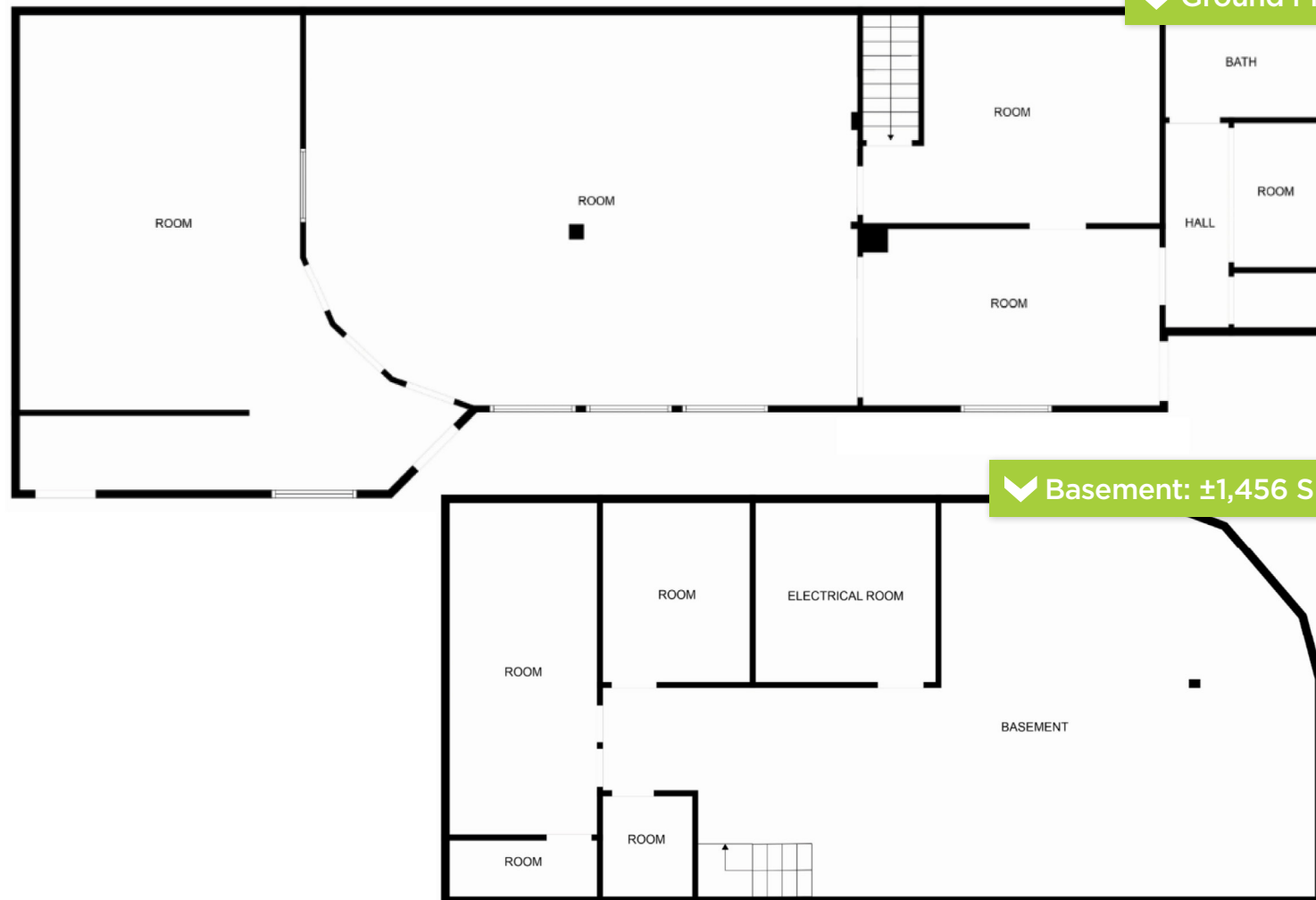

✓ Ground Floor: ±2,295 SF

✓ Basement: ±1,456 SF



**1923 2ND STREET S** | NAMPA, ID



**BEN FULCHER**

208.859.7407 | [ben@rallensrealty.com](mailto:ben@rallensrealty.com)

[rallensrealty.com](https://rallensrealty.com)







**1923 2ND STREET S** | NAMPA, ID



**BEN FULCHER**

208.859.7407 | [ben@rallensrealty.com](mailto:ben@rallensrealty.com)

[rallensrealty.com](https://rallensrealty.com)