

20TH STREET INDUSTRIAL

2915 20th St NE, Cleveland, TN

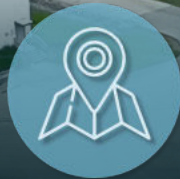

GREAT LOCATION

Easy Access to APD-40
and US-64; 10 Minutes to
I-75 Freeway



IL ZONING

Light Industrial:
Light Manufacturing,
Distribution, etc.

LEASING FLYER



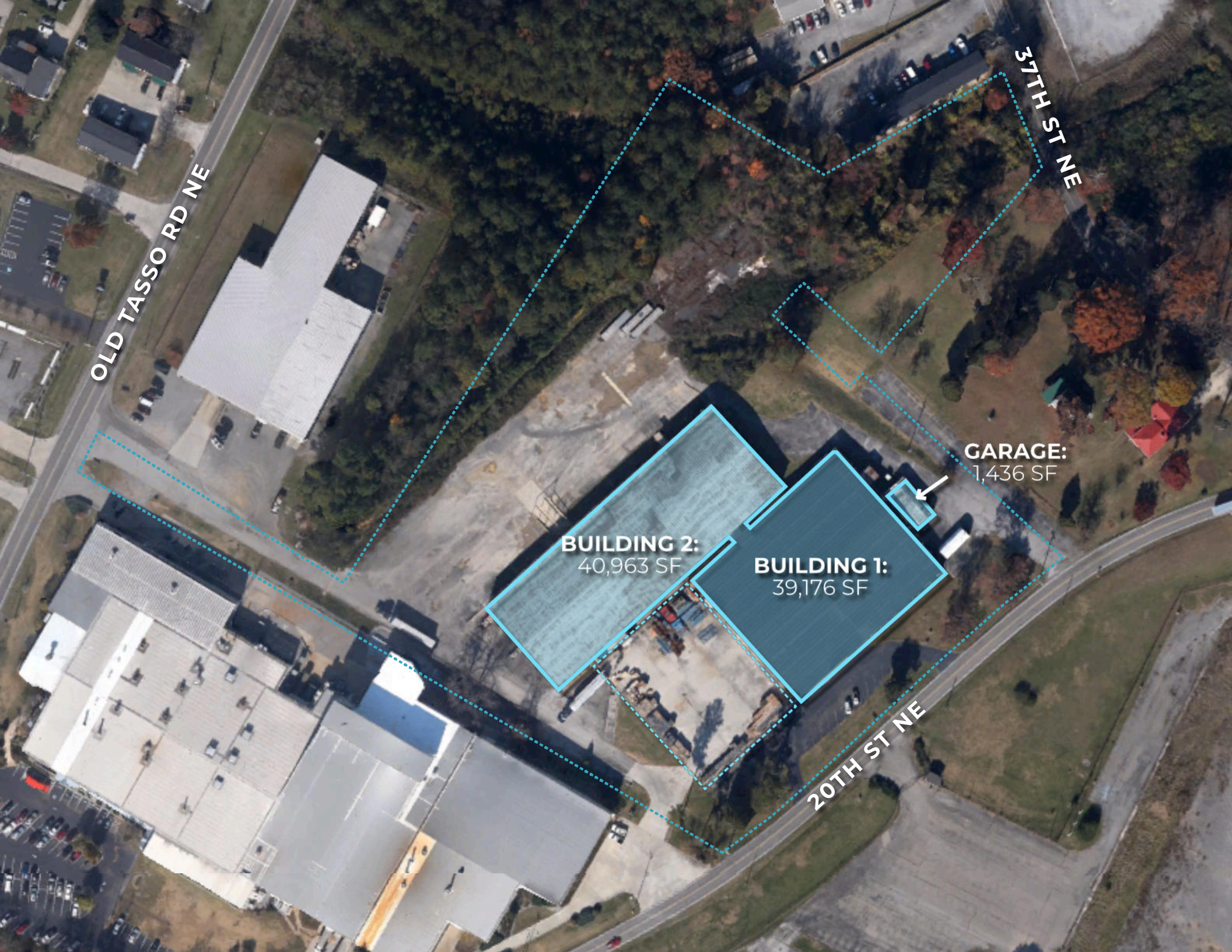

OLD TASSO RD NE

37TH ST NE

20TH ST NE

BUILDING 2:
40,963 SF

BUILDING 1:
39,176 SF

GARAGE:
1,436 SF

AVAILABLE SPACE

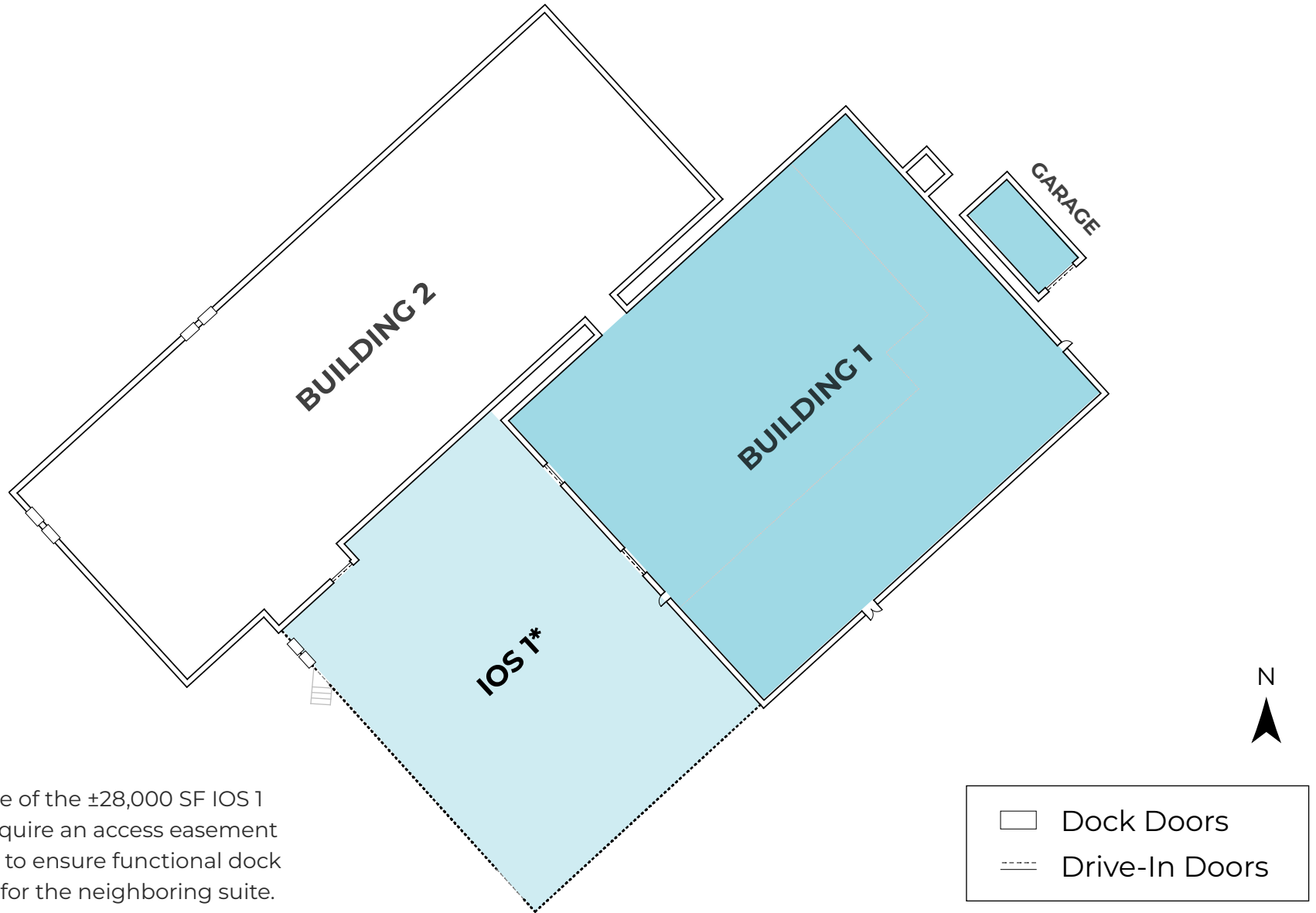

* Tenant's use of the ±28,000 SF IOS 1 space will require an access easement to Building 1 to ensure functional dock accessibility for the neighboring suite.

Sketch is a rough estimation and not to scale.

AVAILABLE SPACE

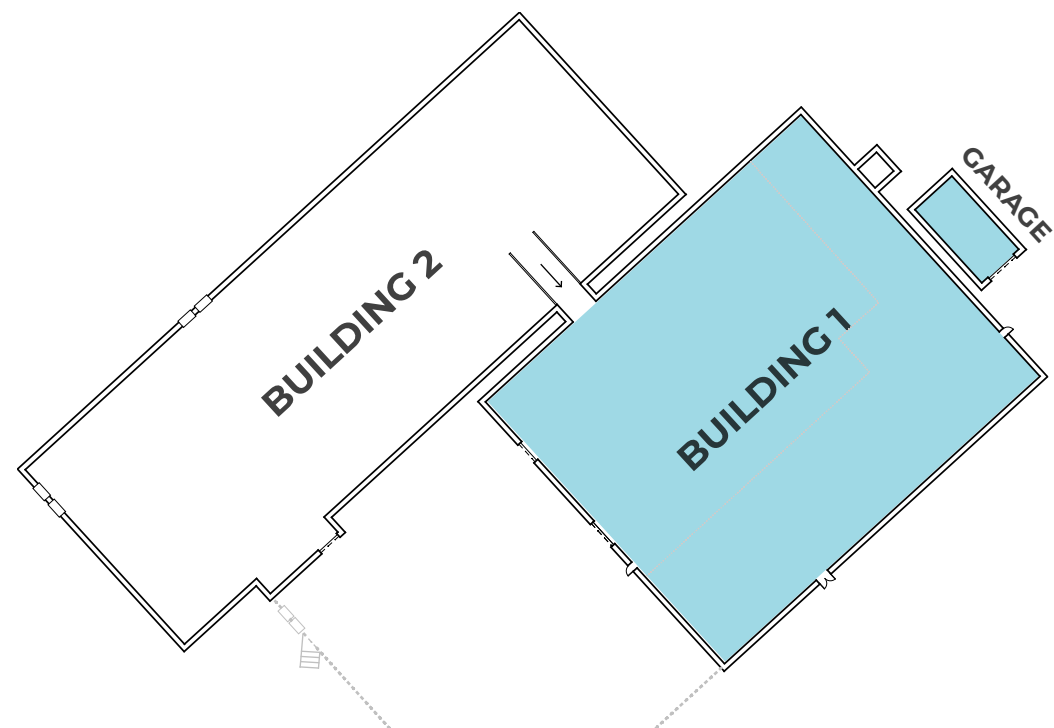

BUILDING	1	Garage
SIZE	± 40,000 Sqft.	± 1,450 Sqft.
LOADING DOCKS	-	-
DRIVE-INS	2	1
AVAILABILITY	60 Days	60 Days

Sketch is a rough estimation and not to scale.





IOS 2:
DIVISIBLE +/- 4.5 AC

IOS 1:
+/- 28,000 SF
GATED LOT

Sketch is a rough estimation and not to scale.

AVAILABLE LAND



Sketch is a rough estimation and not to scale.

SPACE	IOS 1*	IOS 2
LOT SIZE	± 28,000 Sqft.	± 4.5 AC [Divisible]
GATED/SECURED	Yes	-
LOADING DOCKS	2	-
DRIVE-INS	1	-

* IOS 1 will require an access easement to Building 1 to ensure functional dock accessibility for the neighboring suite.

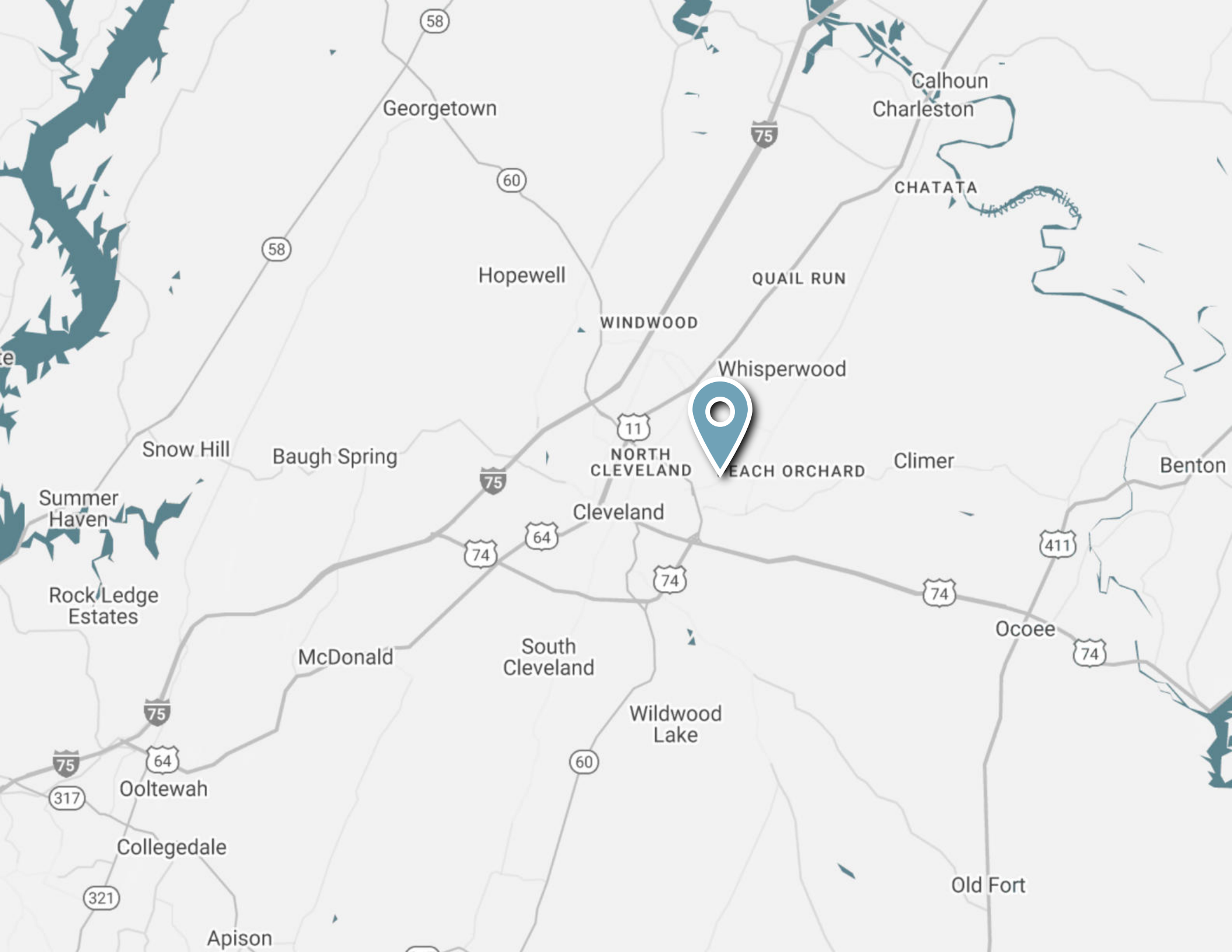

BlendPack

AIRL, Inc.

FERGUSON

Seifeler

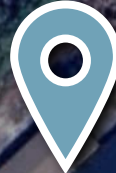

CORMETECH.

derby
SUPPLY CHAIN SOLUTIONS

Rhodes
CLIMATE CONTROLLED
STORAGE

AAA
Mini Storage

CORMETECH.

TOY YARD

Whirlpool
CORPORATION

Coca-Cola



Brad Peters

bpeters@ipausa.com

858-209-4329

DRE#02025155