

# 9,707 SF to 19,460 SF

## 1919 Monterey Road, San Jose | Industrial space for lease



JOEL YUNGEN  
+1 650 480 2115  
joel.yungen@jll.com  
License #: 01850588

EDDIE SHUAI  
+1 510 285 5368  
eddie.shuai@jll.com  
License #: 01454419

DAVID ROSS  
+1 415 450 8588  
dave.ross@jll.com  
License #: 02052598

Jones Lang LaSalle Brokerage, Inc.  
Real Estate License #: 01856260

# 9,707 SF to 19,460 SF

## 1919 Monterey Road, San Jose | Industrial space for lease



JOEL YUNGEN | +1 650 480 2115 | [joel.yungen@jll.com](mailto:joel.yungen@jll.com) | License #: 01850588  
EDDIE SHUAI | +1 510 285 5368 | [eddie.shuai@jll.com](mailto:eddie.shuai@jll.com) | License #: 01454419  
DAVID ROSS | +1 415 450 8588 | [dave.ross@jll.com](mailto:dave.ross@jll.com) | License #: 02052598

9,707 SF to 19,460 SF

1919 Monterey Road, San Jose | Industrial space for lease



JOEL YUNGEN | +1 650 480 2115 | [joel.yungen@jll.com](mailto:joel.yungen@jll.com) | License #: 01850588  
EDDIE SHUAI | +1 510 285 5368 | [eddie.shuai@jll.com](mailto:eddie.shuai@jll.com) | License #: 01454419  
DAVID ROSS | +1 415 450 8588 | [dave.ross@jll.com](mailto:dave.ross@jll.com) | License #: 02052598



9,707 SF to 19,460 SF

1919 Monterey Road, San Jose | Industrial space for lease

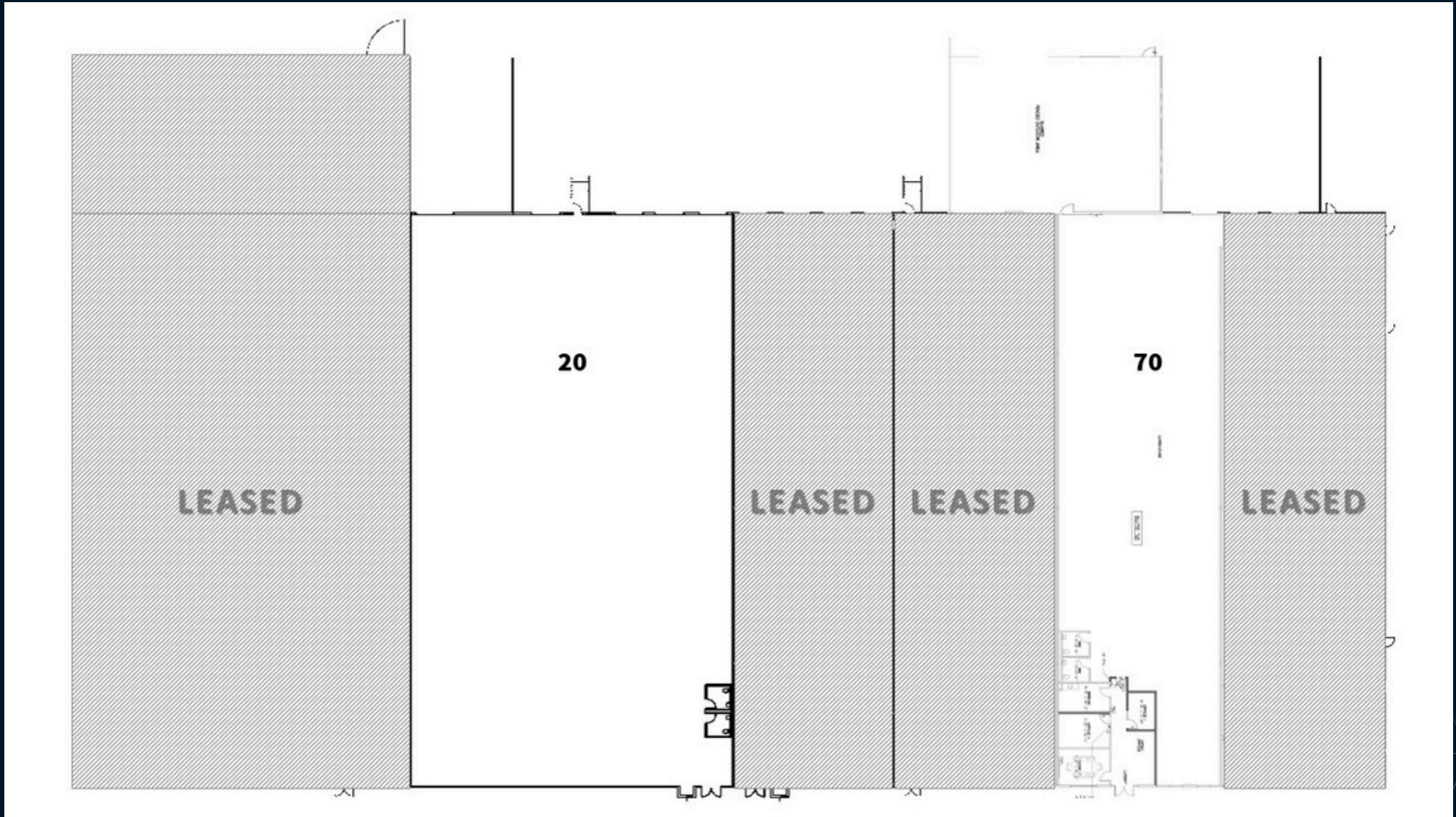

JOEL YUNGEN | +1 650 480 2115 | joel.yungen@jll.com | License #: 01850588

EDDIE SHUAI | +1 510 285 5368 | eddie.shuai@jll.com | License #: 01454419

DAVID ROSS | +1 415 450 8588 | dave.ross@jll.com | License #: 02052598

# 9,707 SF to 19,460 SF

## 1919 Monterey Road, San Jose | Industrial space for lease



**UNIT 20: 19,460 SF**  
Available upon 60 day notice

**UNIT 70: 9,707 SF**  
Available upon 60 day notice

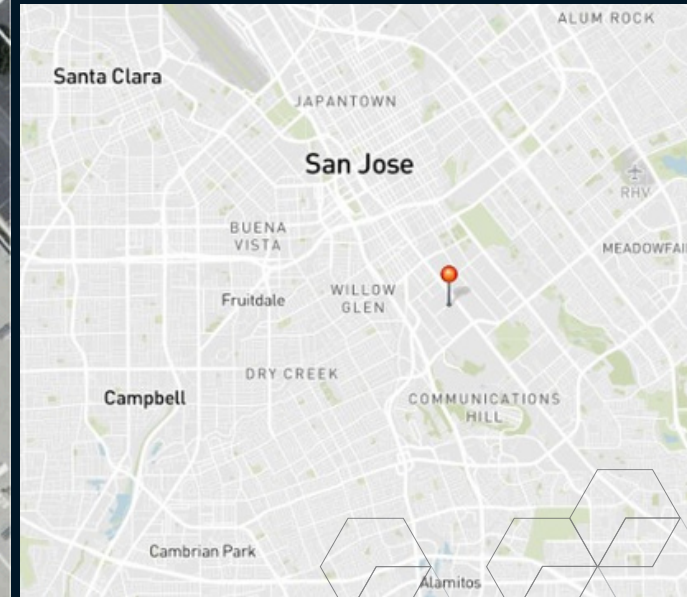

JOEL YUNGEN | +1 650 480 2115 | joel.yungen@jll.com | License #: 01850588  
EDDIE SHUAI | +1 510 285 5368 | eddie.shuai@jll.com | License #: 01454419  
DAVID ROSS | +1 415 450 8588 | dave.ross@jll.com | License #: 02052598

# 9,707 SF to 19,460 SF

## 1919 Monterey Road, San Jose | Industrial space for lease



### UNIT 20

- 19,460 RSF
- Four (4) dock doors
- One (1) grade level door
- Fenced truck court
- 400 AMPS @ 480v (To be verified by tenant)
- Clear height: 24'
- Sprinklers: 0.495 GPM/SF
- Available upon 60 day notice

### UNIT 70

- 9,707 RSF
- One (1) dock door
- One (1) grade level door
- Fenced truck court
- 400 AMPS @ 480v (To be verified by tenant)
- Clear height: 24'
- Sprinklers: 0.495 GPM/SF
- Available upon 60 day notice



# 9,707 SF to 19,460 SF

## 1919 Monterey Road, San Jose | Industrial space for lease

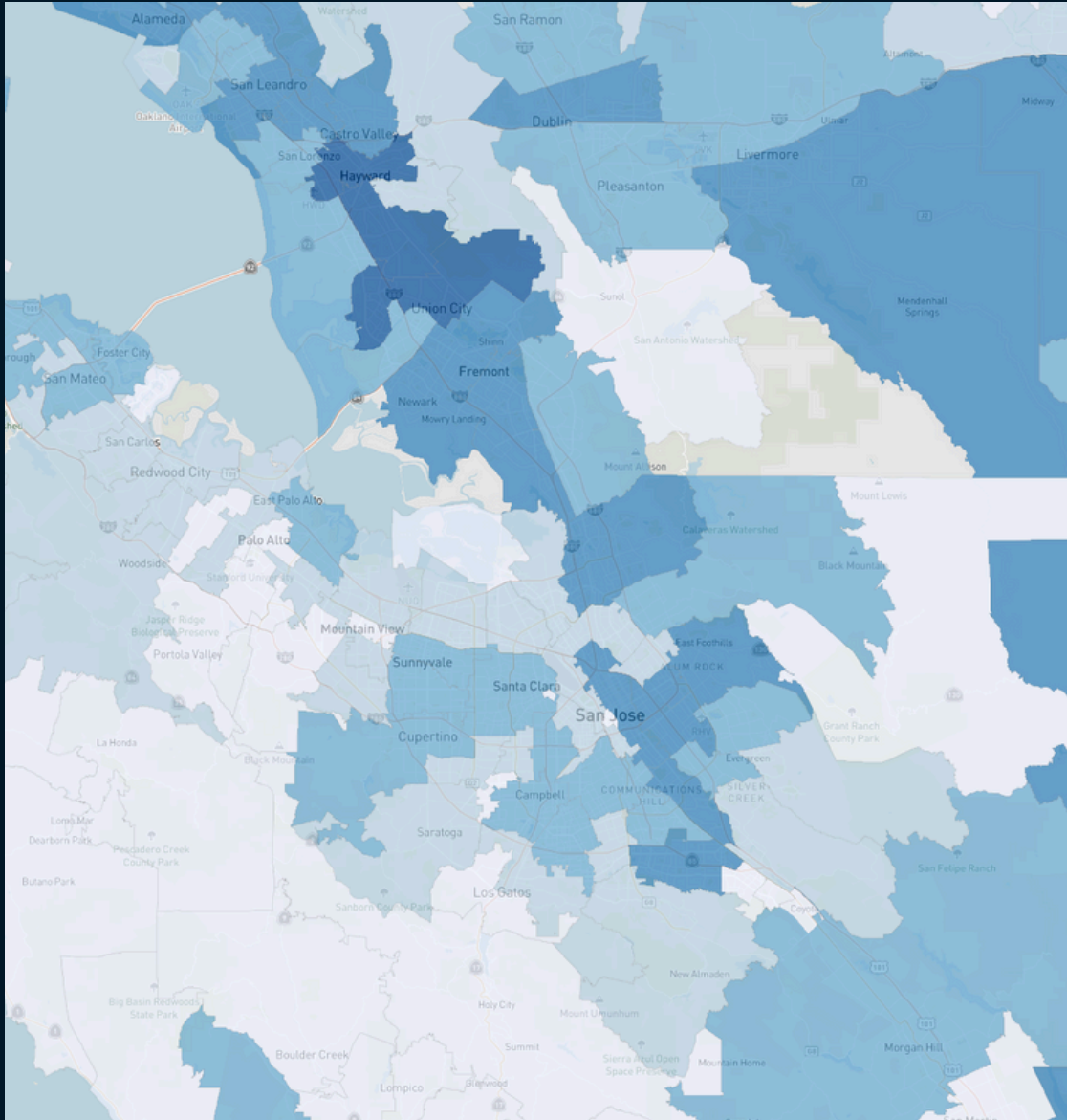

### LABOR MAP

#### PROFESSIONALS

STEM Occupation Concentration

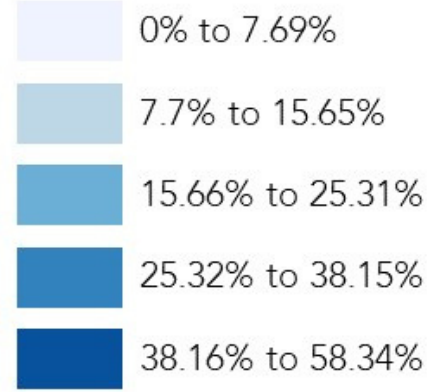

#### WAREHOUSING/DISTRIBUTION

STEM Occupation Concentration

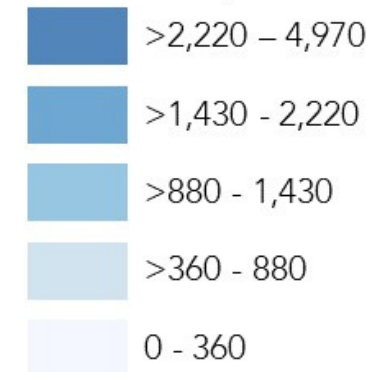

JOEL YUNGEN | +1 650 480 2115 | joel.yungen@jll.com | License #: 01850588

EDDIE SHUAI | +1 510 285 5368 | eddie.shuai@jll.com | License #: 01454419

DAVID ROSS | +1 415 450 8588 | dave.ross@jll.com | License #: 02052598

# 9,707 SF to 19,460 SF

## 1919 Monterey Road, San Jose | Industrial space for lease

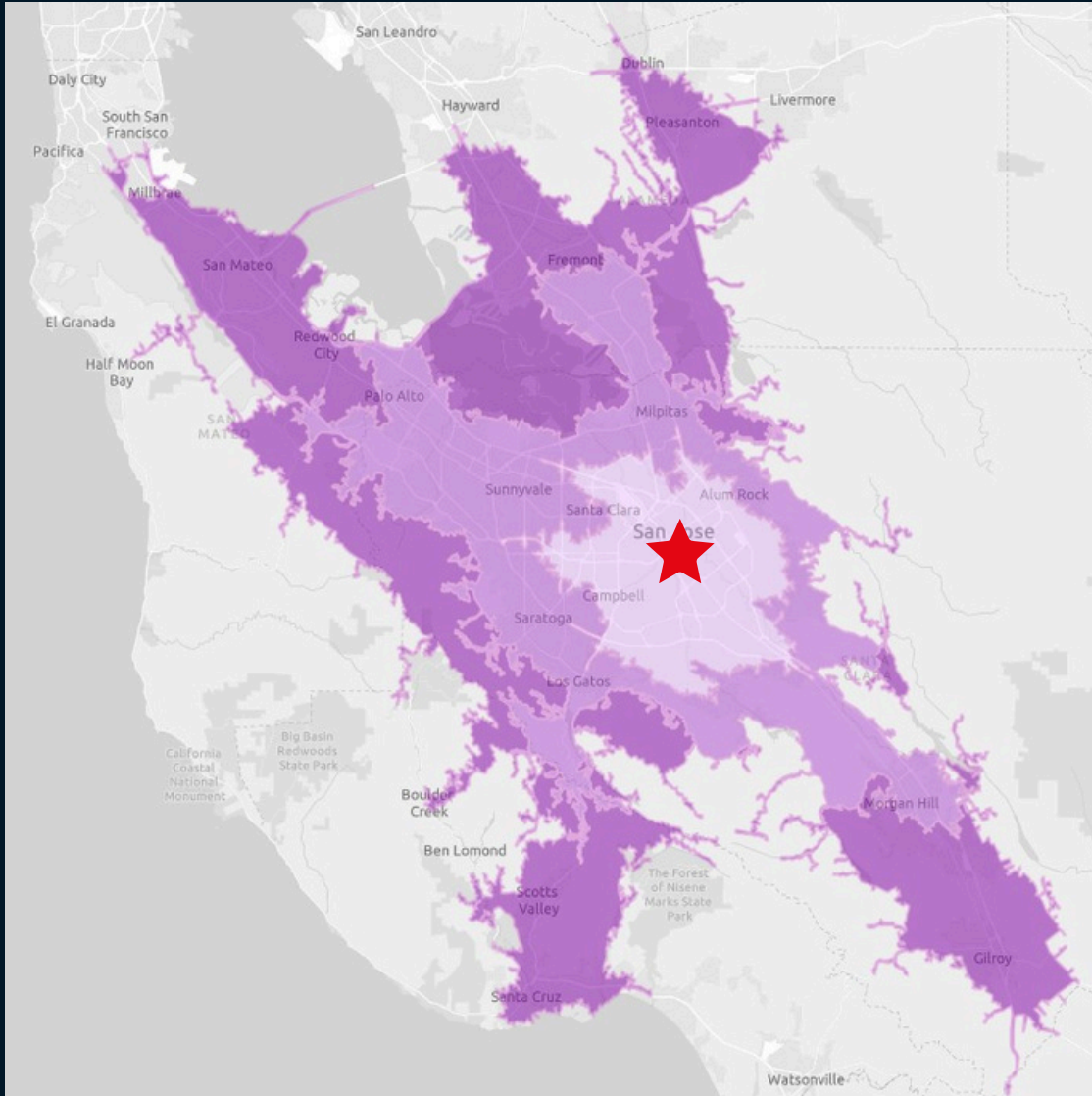

### DRIVE TIME MAP



JOEL YUNGEN | +1 650 480 2115 | joel.yungen@jll.com | License #: 01850588  
EDDIE SHUAI | +1 510 285 5368 | eddie.shuai@jll.com | License #: 01454419  
DAVID ROSS | +1 415 450 8588 | dave.ross@jll.com | License #: 02052598

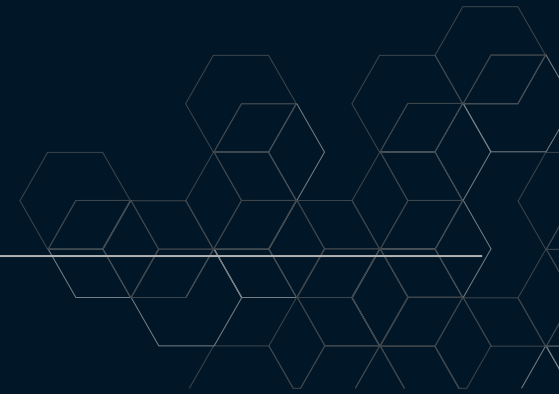



# 9,707 SF to 19,460 SF

## 1919 Monterey Road, San Jose | Industrial space for lease

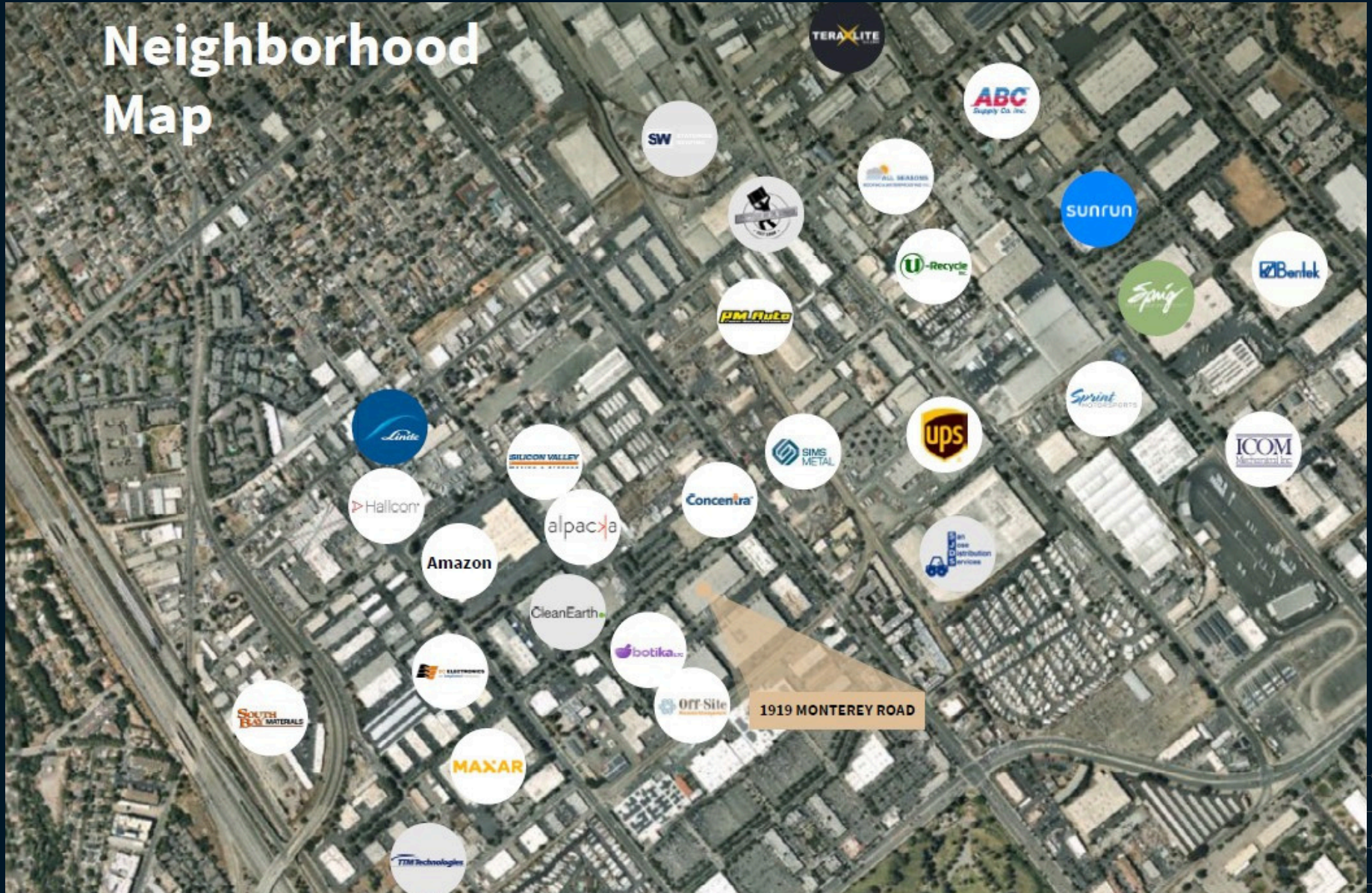

JOEL YUNGEN | +1 650 480 2115 | joel.yungen@jll.com | License #: 01850588  
EDDIE SHUAI | +1 510 285 5368 | eddie.shuai@jll.com | License #: 01454419  
DAVID ROSS | +1 415 450 8588 | dave.ross@jll.com | License #: 02052598