

FOR LEASE

1,500 SF OFFICE IN MIDTOWN

2651 Cameron Street, Suite E | Mobile, AL



PROPERTY DESCRIPTION:

- **Suite E:** 1,500 SF in-line office space
- **Layout:** large open work space, 1 private office, conference room, small storage closet and 2 restrooms
- Zoned B-3: Community Business
- Abundant on-site parking
- Convenient location in the heart of Midtown Mobile between Dauphin Street and Old Shell Road
- Easy access to Airport Boulevard & Government Boulevard
- Proximate to the Publix-anchored retail center
- Prime Midtown corridor with lots of new offices, medical & retail developments

LEASE RATE: \$14.00/SF MG

Jay Roberds, II, SIOR
251.753.1015
jay@cre-mobile.com



**CRE
MOBILE**
CRE-MOBILE.COM



NO WARRANTY OR REPRESENTATION, EXPRESS OR IMPLIED, IS MADE AS TO THE ACCURACY OF THE INFORMATION CONTAINED HEREIN, AND THE SAME IS SUBMITTED SUBJECT TO ERRORS, OMISSIONS, CHANGE OF PRICE, RENTAL OR OTHER CONDITIONS, PRIOR SALE, LEASE OR FINANCING, OR WITHDRAWAL WITHOUT NOTICE, AND OF ANY SPECIAL LISTING CONDITIONS IMPOSED BY OUR PRINCIPALS. NO WARRANTIES OR REPRESENTATIONS ARE MADE AS TO THE CONDITION OF THE PROPERTY NOR ANY HAZARDS CONTAINED THEREIN ARE ANY TO BE IMPLIED.

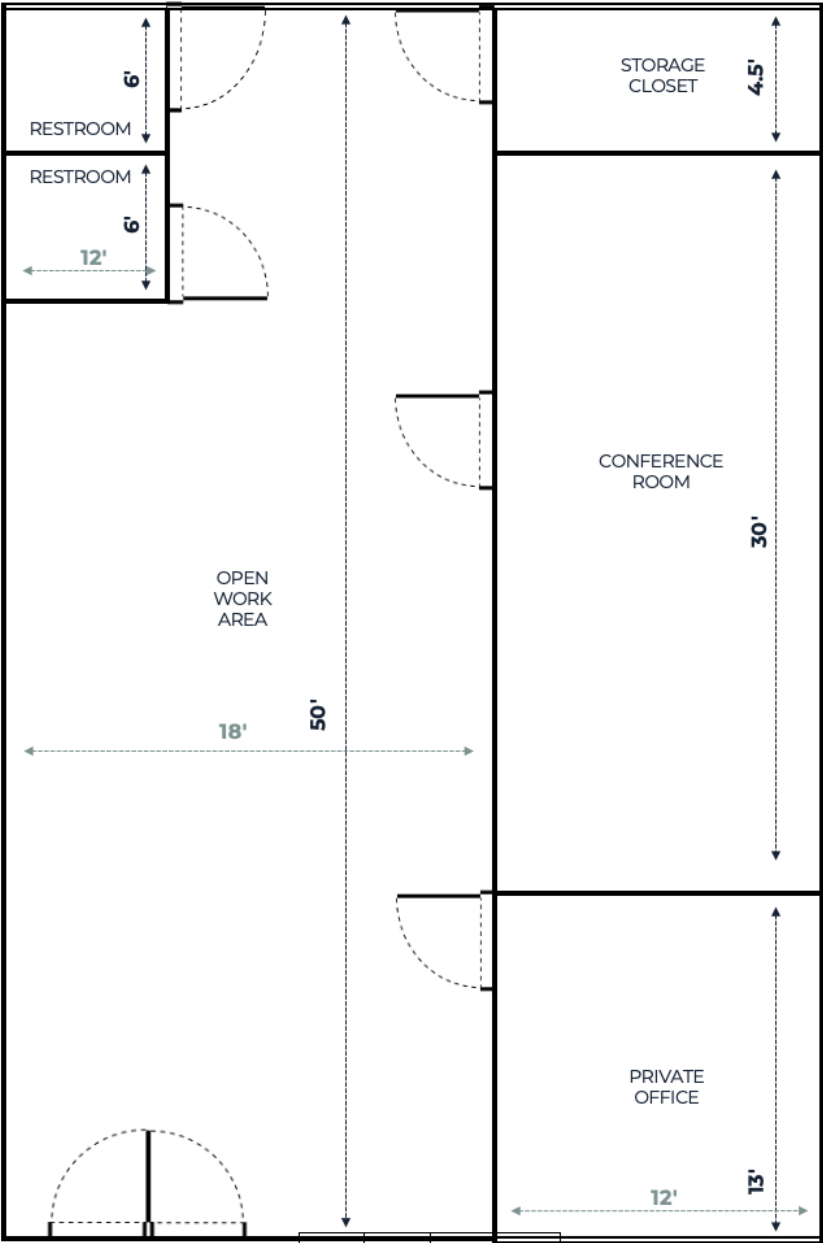

CAMERON STREET

FLOOR PLAN MEASUREMENTS PRESENT A ROUGH SKETCH
AND NOT GUARANTEED TO ACCURACY NOR DRAWN
COMPLETELY TO SCALE

NO WARRANTY OR REPRESENTATION, EXPRESS OR IMPLIED, IS MADE AS TO THE ACCURACY OF THE INFORMATION CONTAINED HEREIN, AND THE SAME IS SUBMITTED SUBJECT TO ERRORS, OMISSIONS, CHANGE OF PRICE, RENTAL OR OTHER CONDITIONS, PRIOR SALE, LEASE OR FINANCING, OR WITHDRAWAL WITHOUT NOTICE, AND OF ANY SPECIAL LISTING CONDITIONS IMPOSED BY OUR PRINCIPALS. NO WARRANTIES OR REPRESENTATIONS ARE MADE AS TO THE CONDITION OF THE PROPERTY NOR ANY HAZARDS CONTAINED THEREIN ARE ANY TO BE IMPLIED.