

LIFE SAFETY LEGEND	
	EGRESS PATH
	EXIT LIGHTING FIXTURE
	EMERGENCY LIGHTING FIXTURE W/NO SWITCH
	EGRESS OCCUPANT CAPACITY OPENING CLEAR WIDTH EGRESS CAPACITY FACTOR
NET FLOOR AREA (FT2) 15 (FT2) PER PERSON	UNITS 1,2,3, AND 5
NET FLOOR AREA (FT2) 60 (FT2) PER PERSON	UNIT 4
	1 HR RATED FIRE WALL
	FIRE EXTINGUISHER: MODEL NO. 2A10BC (THE TOP OF EACH PORTABLE FIRE EXTINGUISHER SHALL BE LOCATED @ 5'-0" A.F.F.)
	FIRE ALARM

NOTE: NET FLOOR AREA = GROSS - BATHROOMS, STORAGE, AND PORCHES

- UNIT 1 (Anet) = 1792 FT2, OL = 1792 FT2/15 = 119
- UNIT 2 (Anet) = 1438 FT2, OL = 1438 FT2/150 = 9
- UNIT 3 (Anet) = 1438 FT2, OL = 1438 FT2/150 = 9
- UNIT 4 (Anet) = 1649 FT2, OL = 1649 FT2/15 = 110
- LOFT 1 (Anet) = 522 FT2, OL = 522 FT2/15 = 35
- LOFT 2 (Anet) = 522 FT2, OL = 522 FT2/15 = 35
- LOFT CONNECTOR (Anet) OL = 639 FT2/15 = 43

PARTITION LEGEND

- 8" FRAMED EXTERIOR WALLS
R-18 INSTALLED IN EXTERIOR WALLS,
INSTALL GWB WHERE NOTED
ON ROOM FINISH SCHEDULE.
- INTERIOR TWO HOUR RATED GWB PARTITION:
3 5/8" MTL OR 2"X 4" WOOD STUDS @ 16" O.C.
W/ 5/8" FIRE RATED GWB EA. SIDE & 3 1/2"
SOUND ATTENUATION BATT. UL DESIGN
NO. U465. EXTEND PARTITION TO FIRE RATED
CEILING ABOVE.
- INTERIOR ONE HOUR RATED GWB PARTITION:
6" MTL OR 2"X 6" WOOD STUDS @ 16" O.C.
W/ 5/8" FIRE RATED GWB EA. SIDE & 6"
SOUND ATTENUATION BATT. UL DESIGN
NO. U465. EXTEND PARTITION TO FIRE RATED
CEILING ABOVE.

AREA	SQ. FT.
AIR CONDITION LOFTS & CONN. RM.	6317 1683
PORCH/PATIO & ENTRANCE	380
TOTAL UNDER ROOF	8380

SAFETY PLAN

SCALE 1/8" = 1'-0"

- UNIT 1 - RESTAURANT
- UNIT 2 - SALON BARBER/
COSMOLOGY
- UNIT 3 - SPLIT UNIT CLEANERS
MODELNO WASHER
PRESSER (CLEANERS
PURPOSE DROP OFF
AND PICK UP) AND
OFFICE SPACE
- UNIT 4 - RESTAURANT
- LOFT 1 - MEETING PLACE
- LOFT 2 - OFFICE SPACE
- LOFTS CONN. RM. - OPEN
CORRIDOR PASS THRU NEAR
ELEVATOR

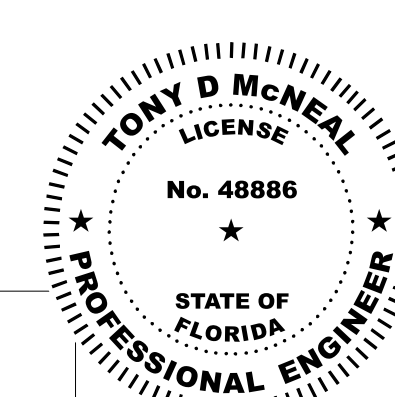
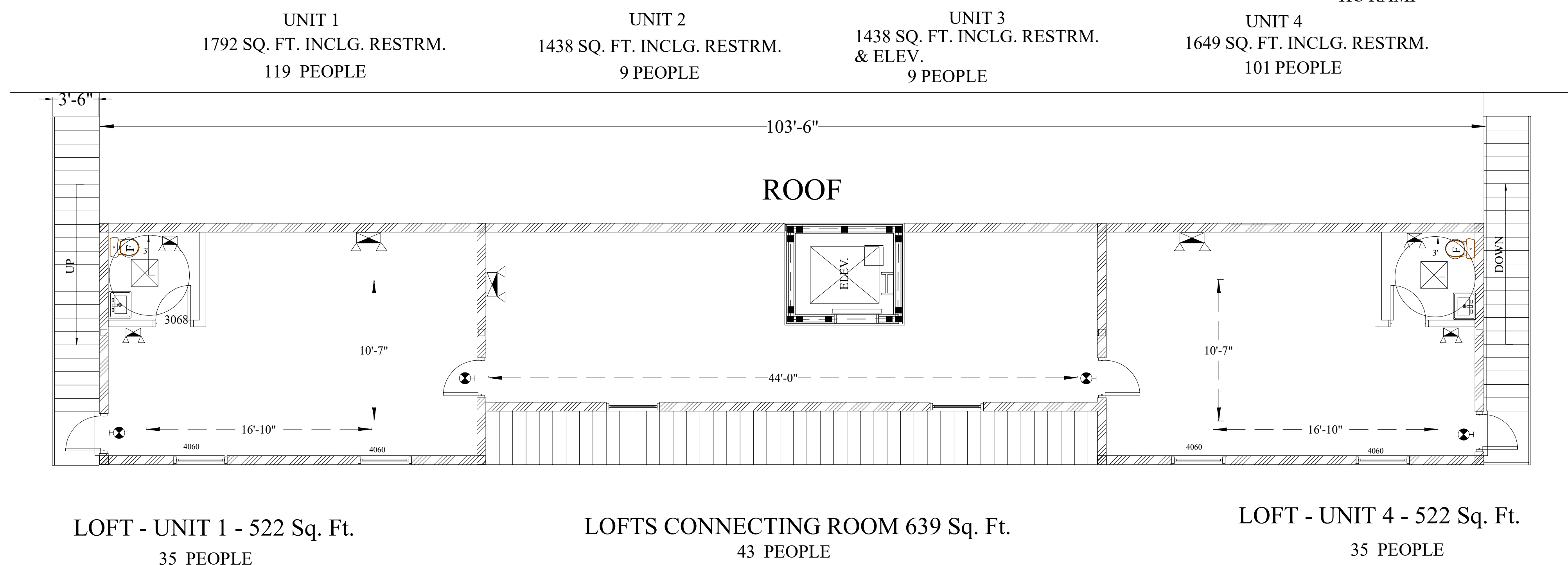
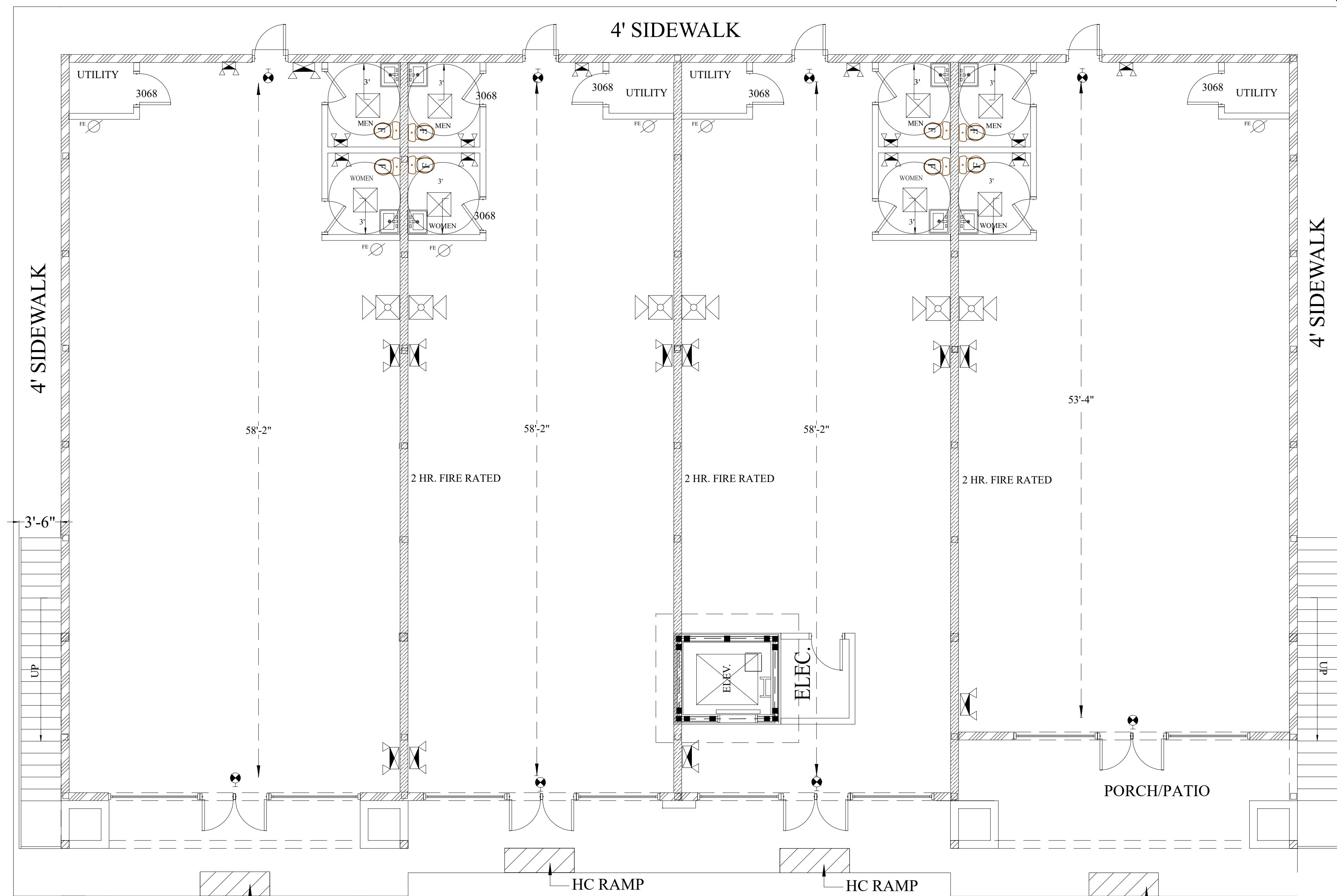

This plan has been digitally signed and sealed by Tony D. McNeal, P.E. on the date adjacent to the seal.
Printed copies of this document are not considered signed and sealed and the signature must be verified on any electronic copy.

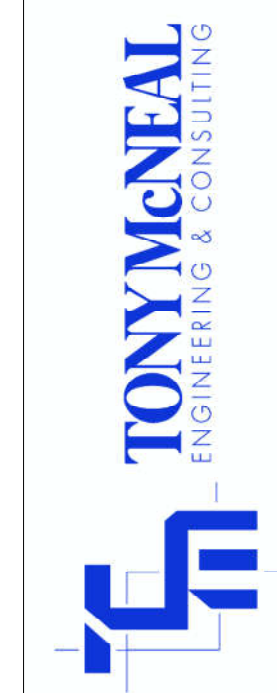

COMPANY NAME:
Tony McNeal, P.E.
Tony McNeal Engineering and Consulting, LLC
2800 S. Adams St., #7528
Tallahassee, FL 32314-7528
E-mail: tony@tmengineeringandconsulting.com
(850) 284-7258 PE Lic.#: 48886 FL

PROJECT NAME:
SEABOARD PLAZA
335 PAT THOMAS PARKWAY
QUINCY, FL
TANDT CONSTRUCTION ENTERPRISE

DATE	8/27/2024
PAGE #	8