

WOODSIDE RETAIL CENTER

RETAIL FOR LEASE

1021-1023 COLUMBUS AVENUE, MARYSVILLE, OHIO 43040



Conceptual image—not final approved design



AARON HEATH SENIOR VICE PRESIDENT

MOBILE 614.804.6936 | DIRECT 614.334.7786
AHEATH@EQUITY.NET



NOAH HEATH ADVISOR

MOBILE 614.949.9876 | DIRECT 614.334.7783
NHEATH@EQUITY.NET



The information contained herein has been obtained from the property owner or other sources that we deem reliable. Although we have no reason to doubt its accuracy, no representation or warranty is made regarding the information, and the property is offered "as is". The submission may be modified or withdrawn at any time by the property owner.

PROPERTY HIGHLIGHTS

WOODSIDE RETAIL CENTER

RETAIL FOR LEASE

1021-1023 COLUMBUS AVENUE, MARYSVILLE, OHIO 43040

- Two buildings of +/- 10,115 SF each
- +/- 0.72 acre outparcel available for ground lease at \$70,000 per year
- Woodside Commerce District is a 100+ acre fully integrated, mixed-use community
- Over 1,200 new residential units just off Columbus Avenue (Industrial Parkway)
- Across from Colemans Crossing and near downtown Marysville
- New retail space for lease at \$40.00 NNN psf + \$8.00 est. op. exp.



MARYSVILLE AERIAL



PARCEL AERIAL



OBLIQUE AERIAL

Renderings are approximate size

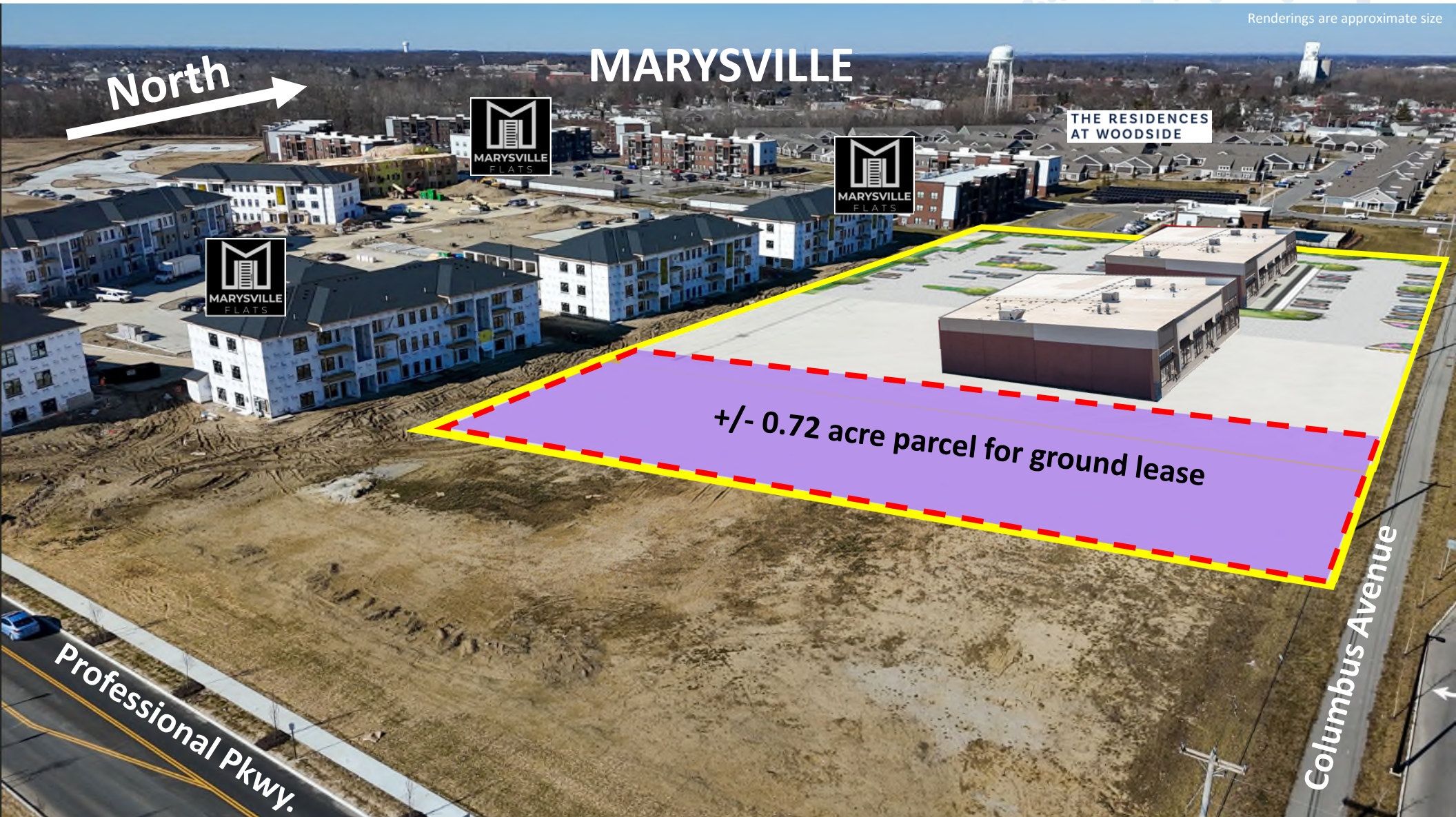

SITE PLAN

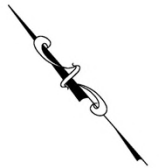
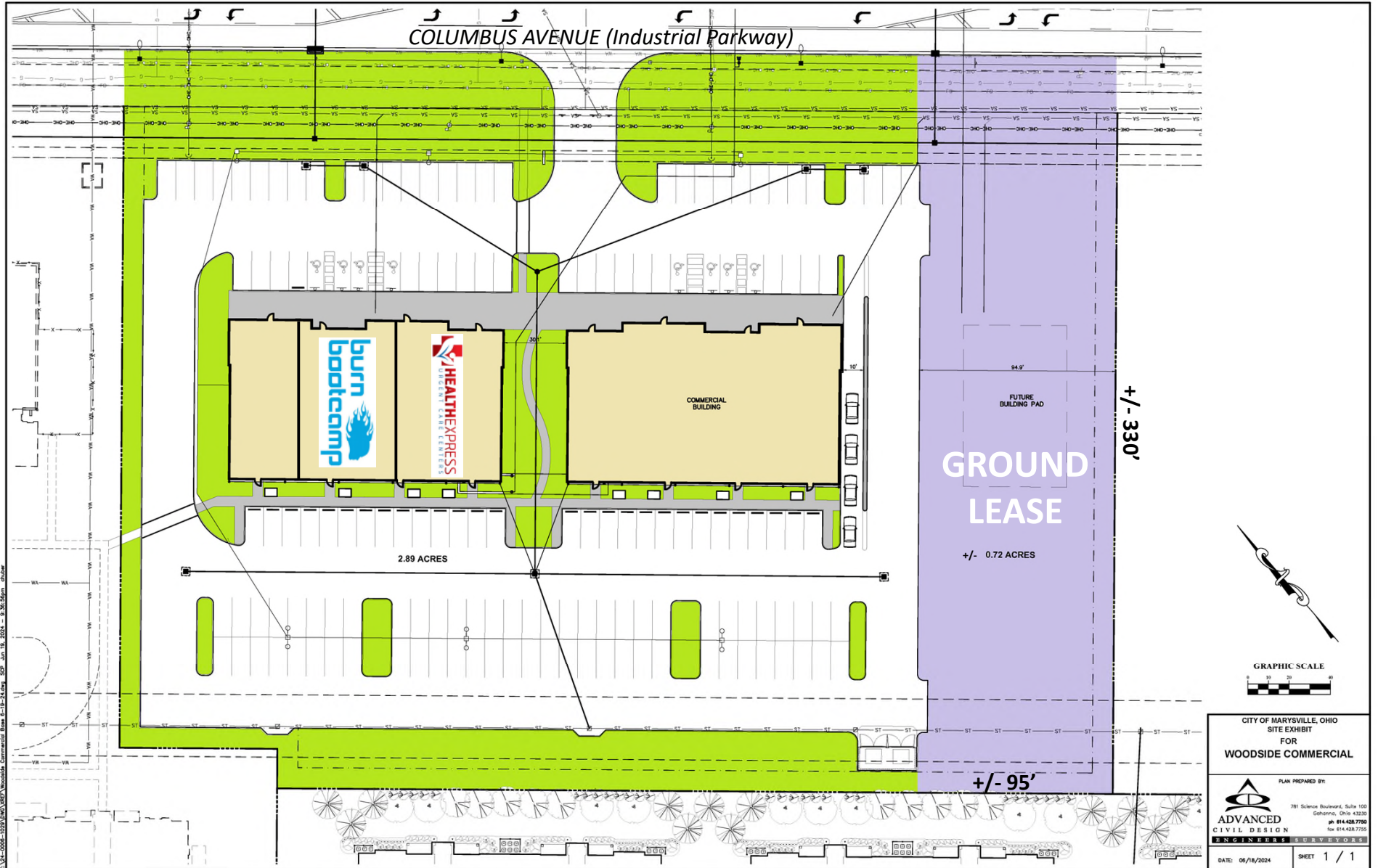

CITY OF MARYSVILLE, OHIO
SITE EXHIBIT
FOR
WOODSIDE COMMERCIAL

PLAN PREPARED BY:

781 Science Boulevard, Suite 1100
Columbus, Ohio 43235
ph 614.428.7750
fax 614.428.7755

DATE: 06/18/2024 SHEET 1 / 1

SPACE PLAN: BUILDING ONE

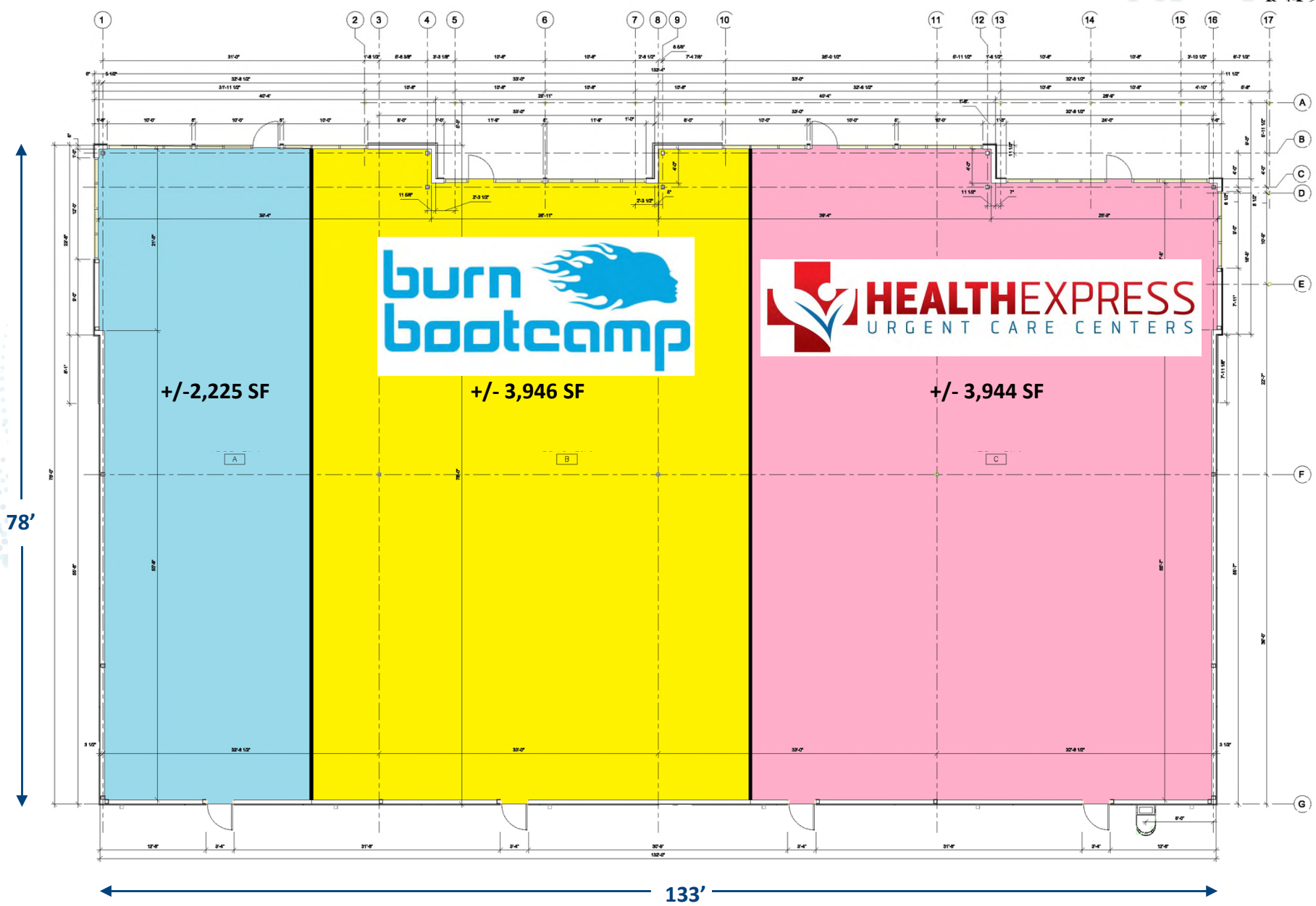

SPACE PLAN: BUILDING TWO

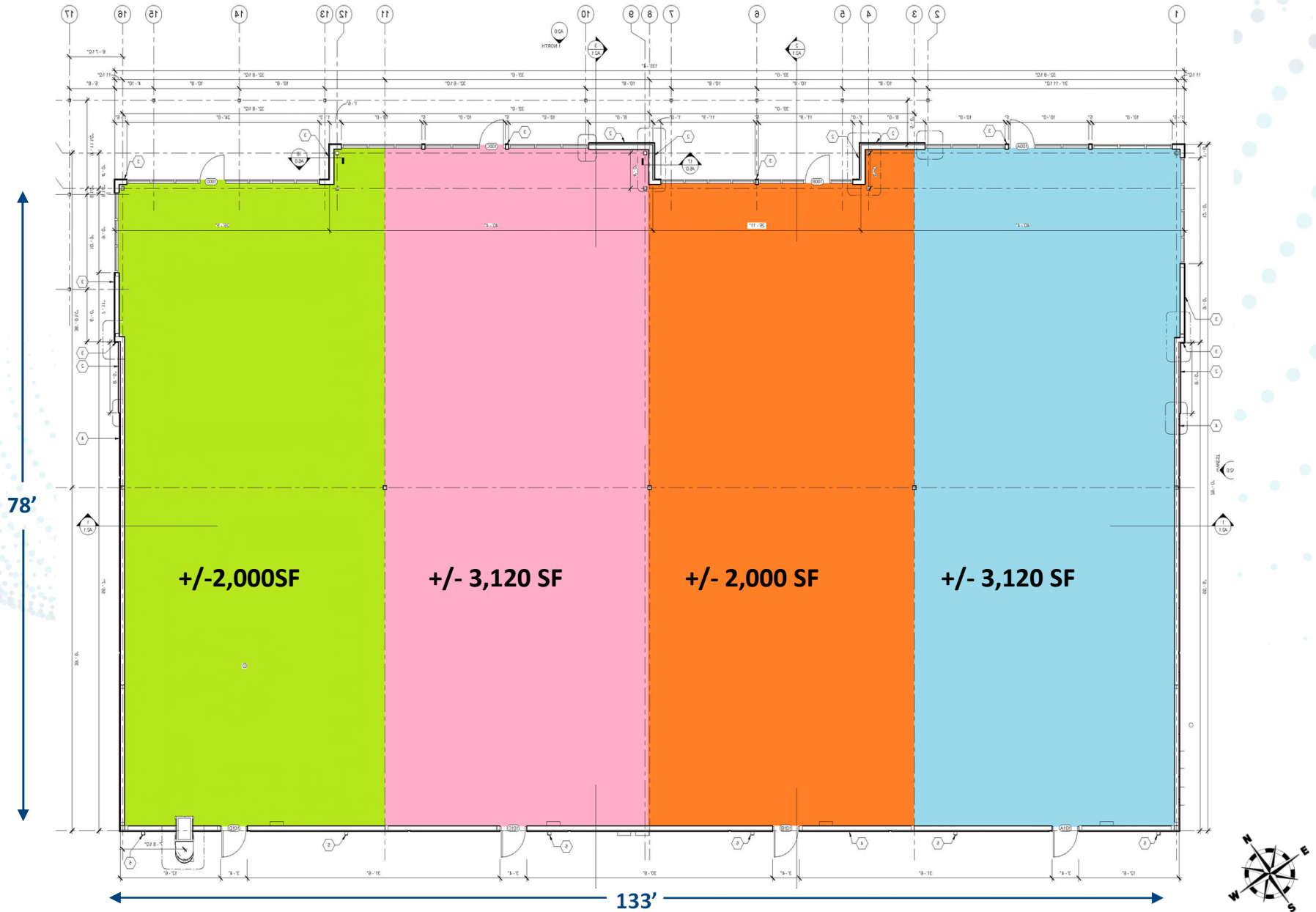

MONUMENT SIGNAGE

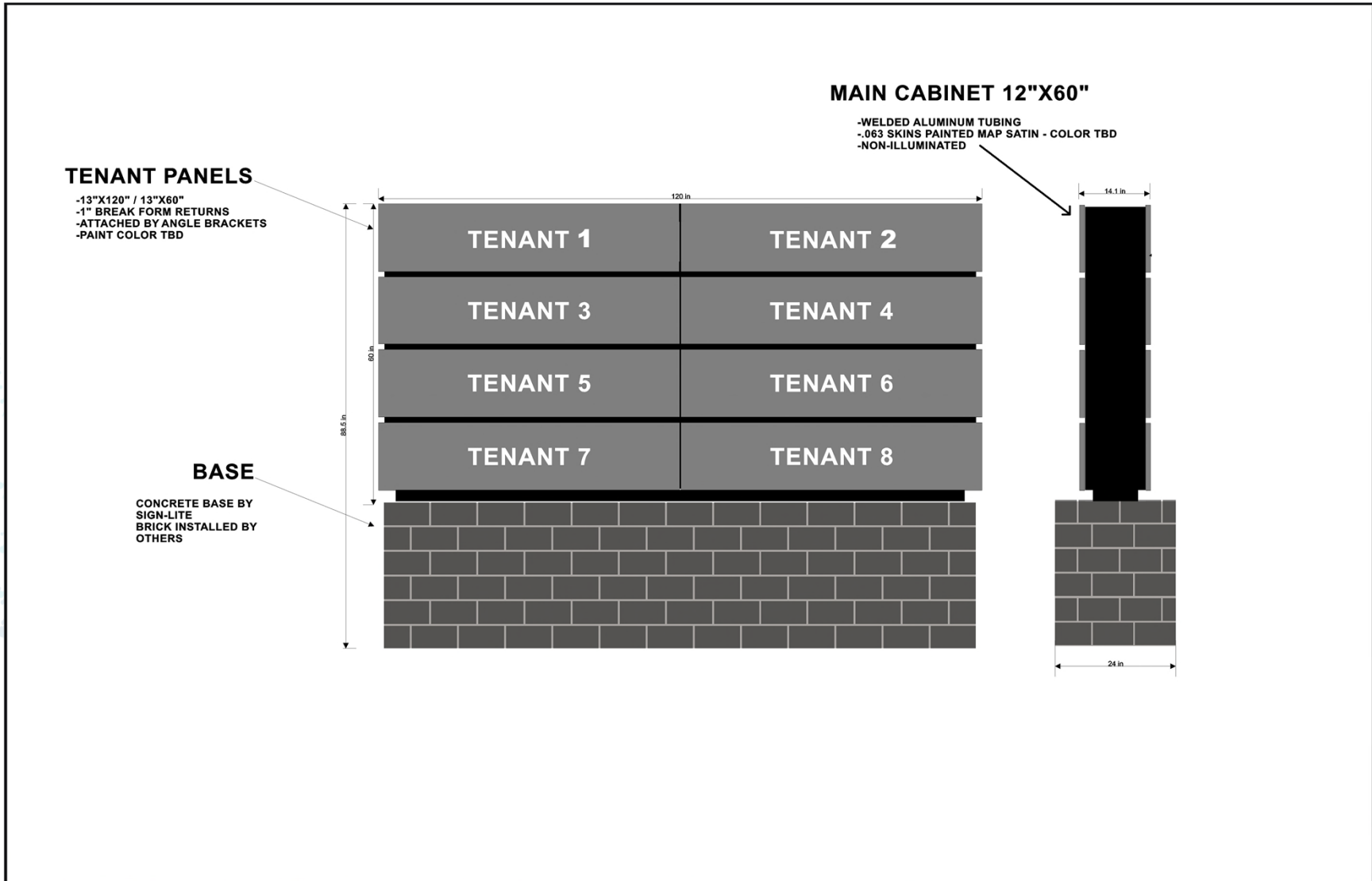

Sign-Lite
 MANUFACTURER • INSTALL • MAINTENANCE
 937.910.5981 SignLiteSales.com

CLIENT: Equity Real Estate - Sarah Freiheit
 SITE LOCATION: Columbus Ave , Marysville, OH
 APPROVAL: _____
 DATE: 9/4/2024

Job Notes:

9/4/24-
 PUD development
 QUOTE DRAWING - SIZING IS APPROXIMATE

FABRICATION AND INSTALLATION PER SPECIFICATION.
 INSTALL IN ACCORDANCE WITH THE NEC. ALL SIGNAGE
 EQUIP WITH DISCONNECT SWITCHES.



equity | brokerage

www.equity.net

The information contained herein has been obtained from the property owner or other sources that we deem reliable. Although we have no reason to doubt its accuracy, no representation or warranty is made regarding the information, and the property is offered "as is". The submission may be modified or withdrawn at any time by the property owner.

ELEVATIONS

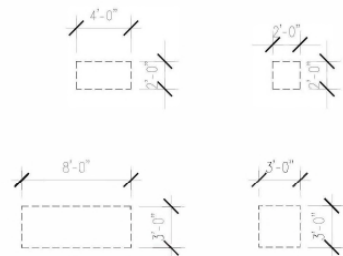

SIGNAGE MAXIMUM DIMENSIONS



EXHIBIT E-3

1-MILE RADIUS DEMOS

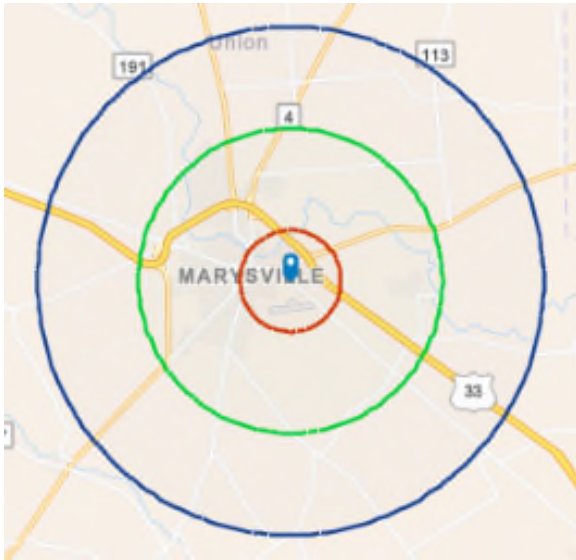

KEY FACTS

3,332
Population

2.3
Average
Household Size

37.2
Median Age

\$67,082
Median Household Income

BUSINESS

476

Total Businesses

6.250

Total Employees

EDUCATION

10%

No High School
Diploma

40%

High School
Graduate

27%

Some
College

23%

Bachelor's/Grad/Prof
Degree

INCOME



\$39,181
Per Capita
Income



\$67,082
Median
Household
Income



\$94,618
Average
Household
Income

EMPLOYMENT

50.5
White
Collar %

34.9
Blue
Collar %

14.6
Services
%

equity | brokerage

The information contained herein has been obtained from the property owner or other sources that we deem reliable. Although we have no reason to doubt its accuracy, no representation or warranty is made regarding the information, and the property is offered "as is." The submission may be modified or withdrawn at any time by the property owner.

3-MILE RADIUS DEMOS

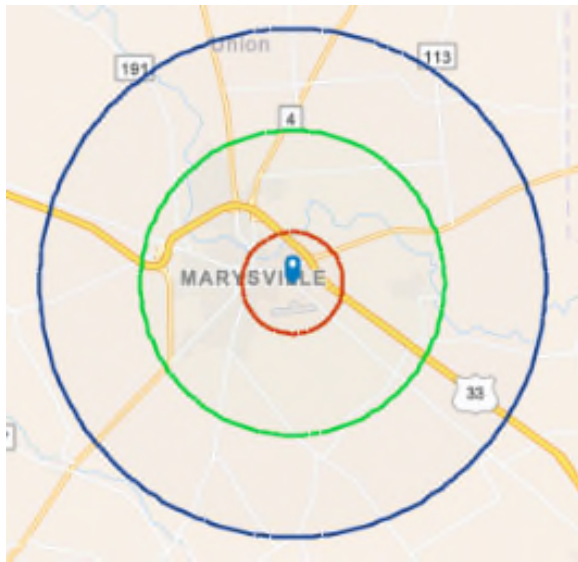

KEY FACTS

27,138
Population

2.5
Average
Household Size

35.9
Median Age

\$84,882
Median Household Income

BUSINESS

868

Total Businesses

12,109

Total Employees

EDUCATION

7%

No High School
Diploma

36%

High School
Graduate

28%

Some
College

30%

Bachelor's/Grad/Prof
Degree

INCOME



\$39,848
Per Capita
Income



\$84,882
Median
Household
Income



\$110,113
Average
Household
Income

EMPLOYMENT

64.4
White
Collar %

25.6
Blue
Collar %

10.0
Services
%

equity | brokerage

The information contained herein has been obtained from the property owner or other sources that we deem reliable. Although we have no reason to doubt its accuracy, no representation or warranty is made regarding the information, and the property is offered "as is." The submission may be modified or withdrawn at any time by the property owner.

5-MILE RADIUS DEMOS

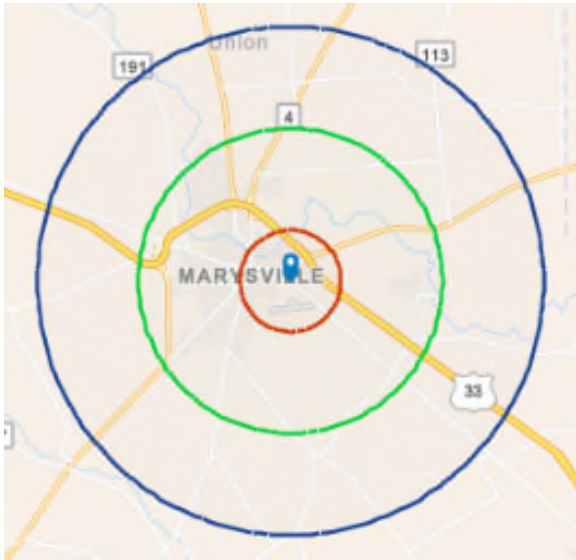

KEY FACTS

32,442
Population



Average
Household Size



Median Age

\$89,609

Median Household Income

BUSINESS



Total Businesses

947



Total Employees

13,144

EDUCATION



6%

No High School
Diploma



35%

High School
Graduate



28%

Some
College



32%

Bachelor's/Grad/Prof
Degree

INCOME



\$41,420

Per Capita
Income



\$89,609

Median
Household
Income



\$115,852

Average
Household
Income

EMPLOYMENT



65.8

White
Collar %



24.2

Blue
Collar %



10.0

Services
%

equity | brokerage

The information contained herein has been obtained from the property owner or other sources that we deem reliable. Although we have no reason to doubt its accuracy, no representation or warranty is made regarding the information, and the property is offered "as is." The submission may be modified or withdrawn at any time by the property owner.