

GLENDALE AVE & 27TH AVE PHOENIX 85051



**2727 W GLENDALE AVE
OFFERED AT
\$6,200/MO**

Excellent location for this large warehouse with endless possibilities. Featuring an office or reception area and restroom. The warehouse has 3 garage doors that are over 15' tall, 2 of them with drive through and automatic door openers. Office has minisplit for heating and cooling; warehouse has evaporative coolers. Electrical panel can handle 440 power with a 220 already functioning subpanel. Concrete floors for easy cleanup can accommodate a variety of businesses.

PROPERTY FEATURES

- Reception/office area
- Large warehouse
- Near I-17
- 6,262
- 3 Garage doors over 15' tall
- Ample parking
- Concrete floors in warehouse



CONTACT US

CENTURY 21
Northwest Realty



John Crow
CEO, Century 21 Northwest Realty
(623) 556-6170 (p) | (623) 556-6170 (m)
john@thelocationpro.com

**2727 W Glendale Ave
Phoenix 85051**



CENTURY 21
Northwest Realty



John Crow
CEO, Century 21 Northwest Realty
(623) 556-6170 (p) | (623) 556-6170 (m)
john@thelocationpro.com

**2727 W Glendale Ave
Phoenix 85051**

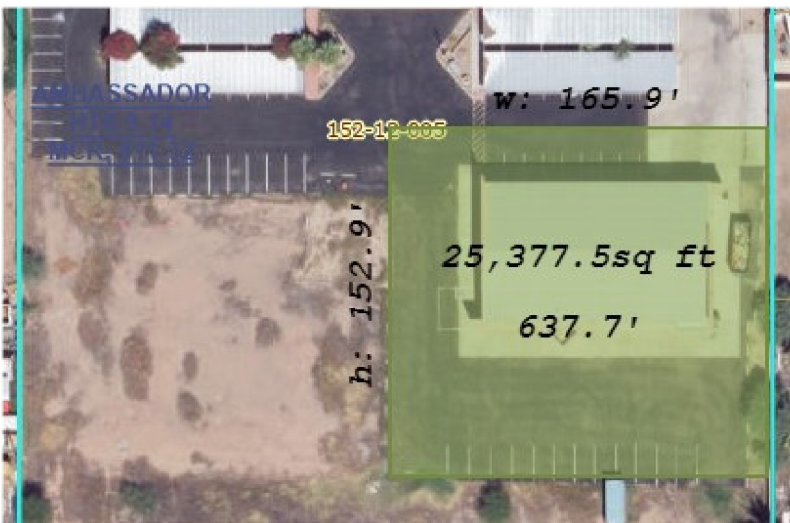

CENTURY 21.
Northwest Realty



John Crow
CEO, Century 21 Northwest Realty
(623) 556-6170 (p) | (623) 556-6170 (m)
john@thelocationpro.com

**2727 W Glendale Ave
Phoenix 85051**

Nearby Businesses

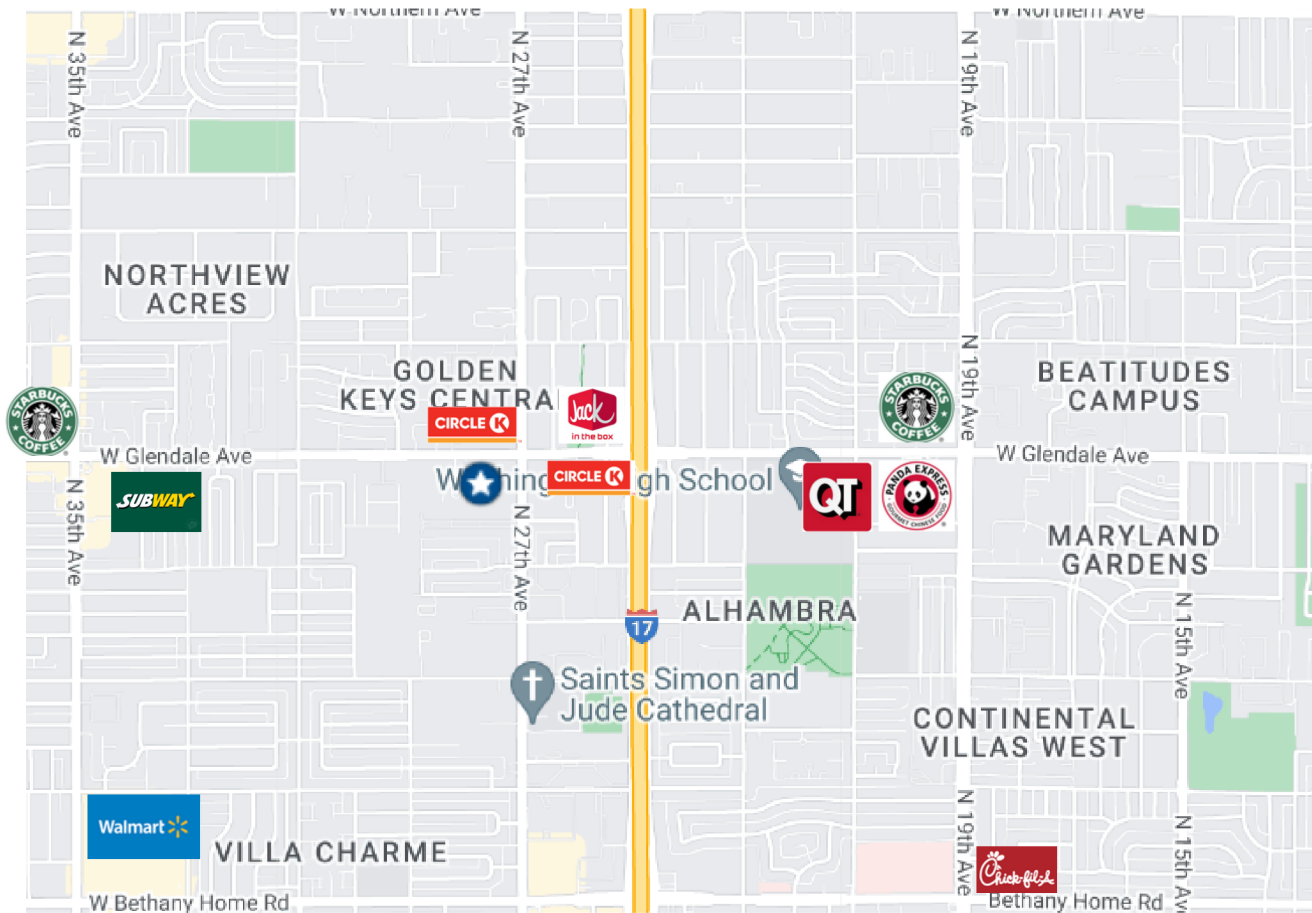

CENTURY 21
Northwest Realty



John Crow
CEO, Century 21 Northwest Realty
(623) 556-6170 (p) | (623) 556-6170 (m)
john@thelocationpro.com