



OFFICE BUILDING FOR SALE

1 Lands End Lane | Dodgeville, WI

THE OFFERING

Broadwing Advisors, LLC, on behalf of the existing owner is offering for sale the building located at 1 Lands End Lane in Dodgeville, Wisconsin.

Large Class-B flex office property located on Dodgeville's Northside for purchase. The 165,582 square foot building is designed with 2 stories and a broad atrium area. The building features a nice mix of private offices, collaborative, and flex industrial spaces.

ASKING PRICE

- Negotiable

PROPERTY DETAILS

- **Building:** 165,582 SF
- **Land Area:** ~ 11 acres
- **Zoned:** M-L, Limited Industrial District
- **Parcel Number:** 216-1070.AA
- 2 story office building with atrium
- ~350 parking stalls

LOCATION

- The site is highly visible and positioned in close proximity to HWY 18. This location provides easy vehicular access to Dodgeville's amenities and downtown community

For more information and Offering Memorandum, please contact:

Craig P. Stanley, CCIM
Broadwing Advisors, LLC
(608) 294-4099
craig@broadwing-advisors.com

Deana J. Porter
Broadwing Advisors, LLC
(608) 661-7451
deana@broadwing-advisors.com

Emily M. Mehl
Broadwing Advisors, LLC
(608) 692-3525
emily@broadwing-advisors.com



LOCATION

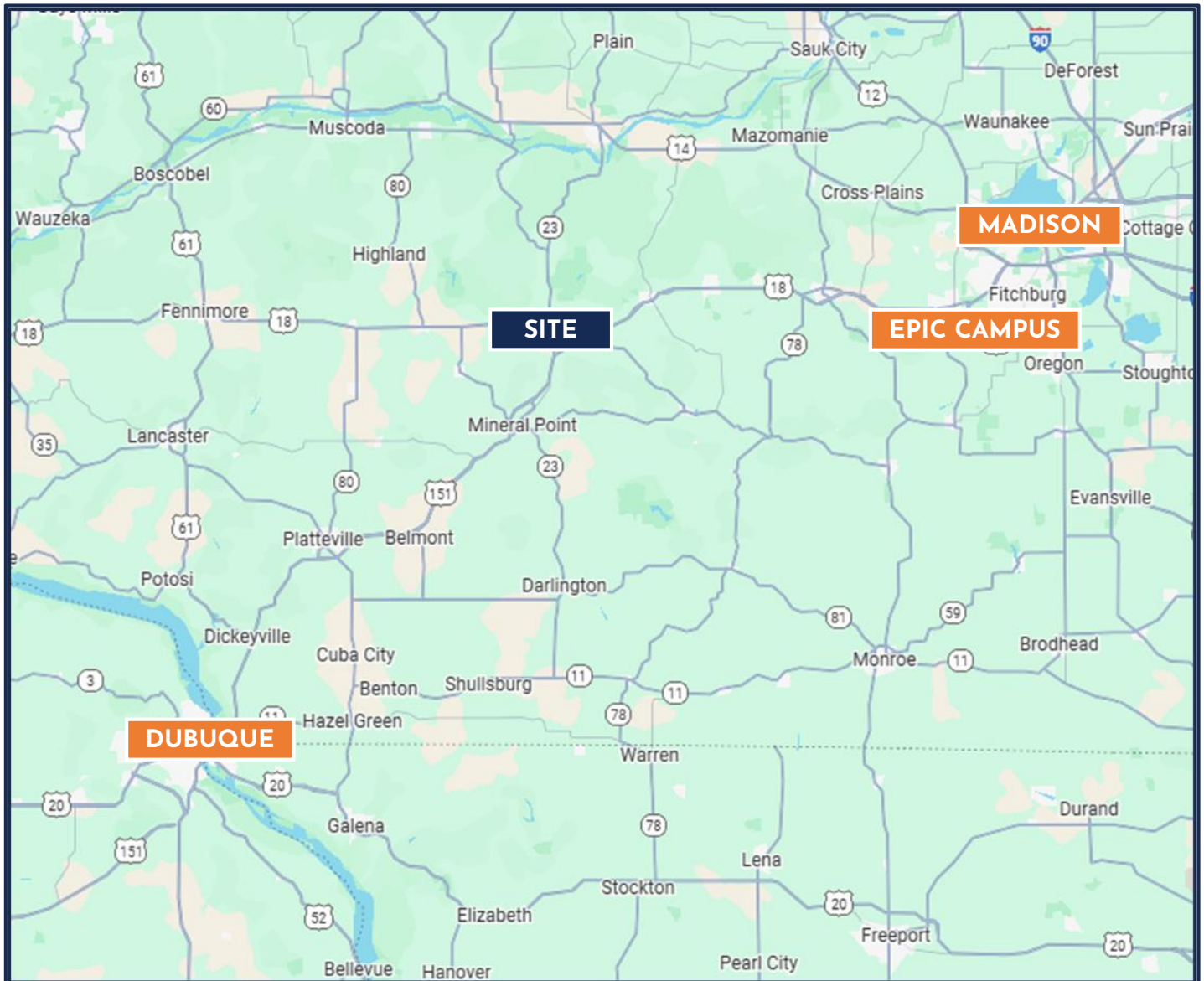

SITE PLAN



* 11 Acres for sale
(current lot lines to be adjusted prior to closing)



EXTERIOR PHOTOS



FLOOR PLANS



FIRST FLOOR PLAN
88,654 S.F.

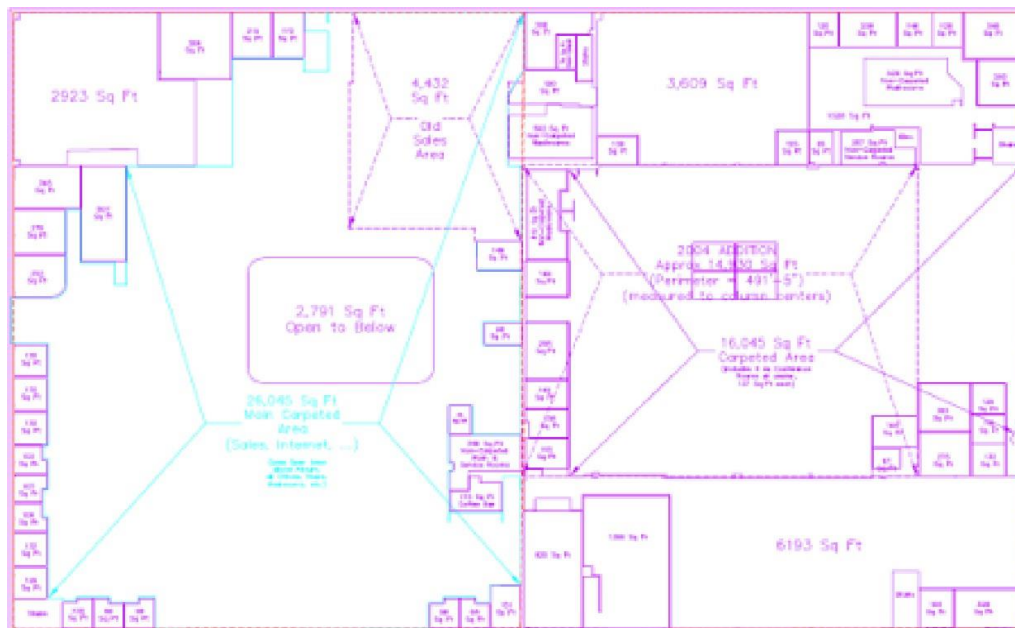

SECOND FLOOR PLAN
77,018S.F.

