

LEASE

MARTIN WAY PROFESSIONAL PLAZA

3905 Martin Way E Olympia, WA 98506



OFFERING SUMMARY

Lease Rate:	\$20 SF/yr
Lease Type:	Modified Gross (MG)
Building Size:	9,600 SF
Suites A & A1 SF:	4,095 SF
Lot Size:	0.81 Acres
Year Built:	1988

PROPERTY OVERVIEW

Suites A and A1 are TOGETHER one leasing Suite. Professional office building close to amenities. Easy access to I-5 and downtown Olympia and Lacey. Plenty of parking in front and rear of building.

PROPERTY HIGHLIGHTS

- 9 Mostly Furnished Private Offices
- 2 Kitchen Areas
- Conference Space
- Copy Center Space
- Extra Cubicles
- Office Storage (under stairs)
- Private Mezzanine (A2)
- Use of the Main Backlit Monument Sign on Martin Way

Jason Hearn

(360) 701-3490

jason.hearn@coldwellbankercommercialdanforth.com

Bob Fredrickson, CCIM

(206) 595-7232

bfredrickson@cbcworldwide.com



**COLDWELL BANKER
COMMERCIAL**
DANFORTH

LEASE

MARTIN WAY PROFESSIONAL PLAZA

3905 Martin Way E Olympia, WA 98506

Floor 1

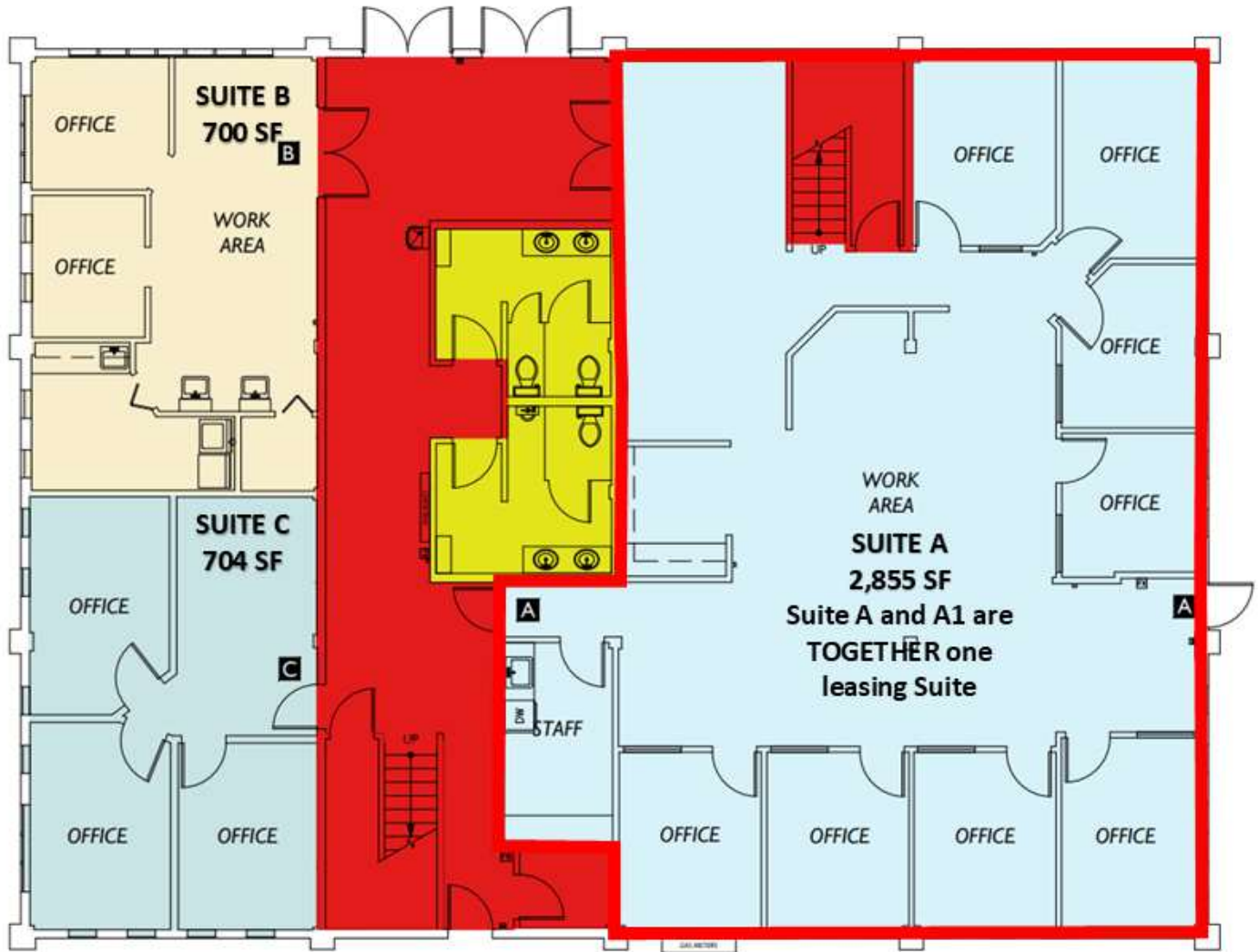

Jason Hearn

(360) 701-3490

jason.hearn@coldwellbankercommercialdanforth.com

Bob Fredrickson, CCIM

(206) 595-7232

bfredrickson@cbcworldwide.com



**COLDWELL BANKER
COMMERCIAL**
DANFORTH

3905 Martin Way E Olympia, WA 98506

Floor Plan Details:

- Suite F:** 1,126 SF (Green)
- Suite D2:** 350 SF (Orange)
- Suite D1:** 465 SF (Pink)
- Suite E:** 1,610 SF (Light Blue)
- Suite A1:** 1,240 SF (Light Blue)
- Suite A and A1:** are TOGETHER one leasing suite
- Other Areas:** OFFICE, STAFF, RESTROOMS, OPEN TO BELOW, NO ACCESS ASSUMED WALL THICKNESS (TYP.)

LEASE

MARTIN WAY PROFESSIONAL PLAZA

3905 Martin Way E Olympia, WA 98506

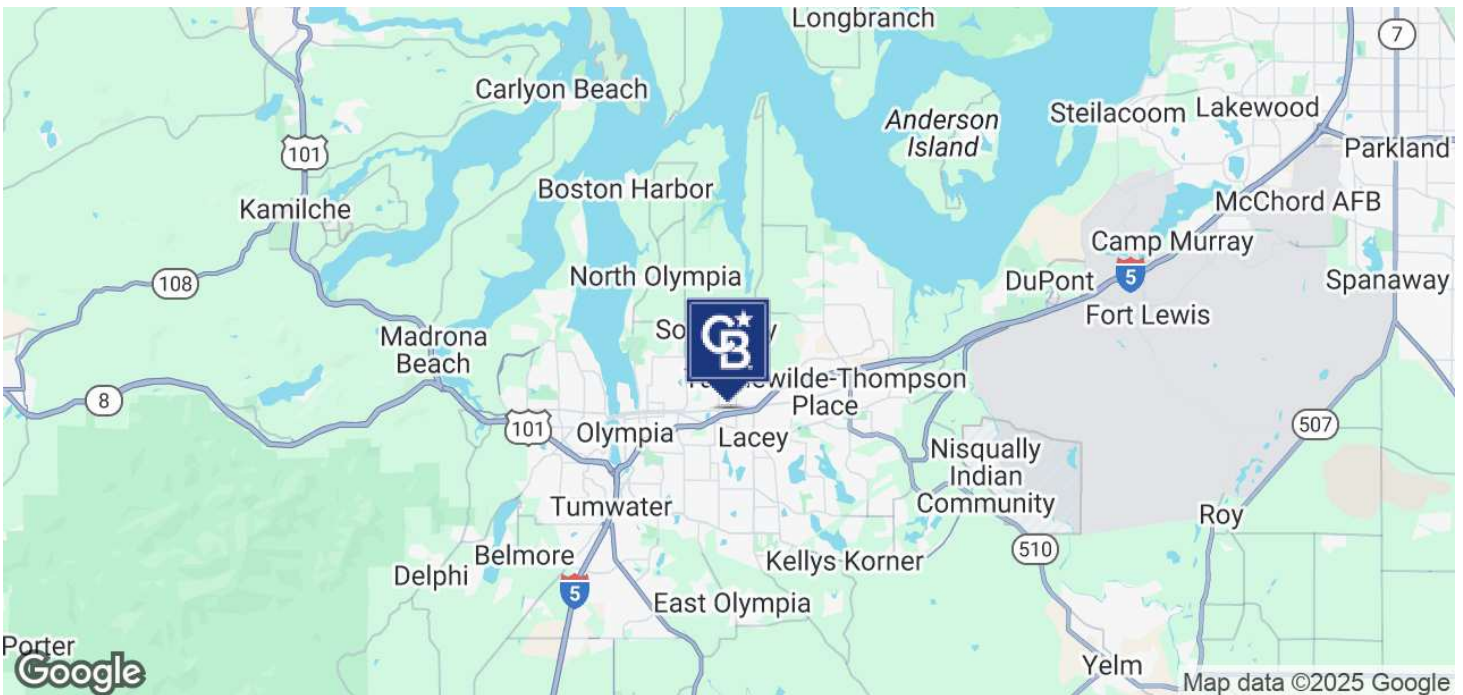

Jason Hearn

(360) 701-3490

jason.hearn@coldwellbankercommercialdanforth.com

Bob Fredrickson, CCIM

(206) 595-7232

bfredrickson@cbcworldwide.com



**COLDWELL BANKER
COMMERCIAL**
DANFORTH