

Temp Controlled Manufacturing- Heavy Power

852-866 South 500 West, Salt Lake City, Ut



Salt Lake Granary District

LEASE RATE \$.95 PSF, NNN

Property Details

Total Size: 34,622 SF

Office: 1,814 SF

Wet Lab: 1,564 SF

Warehouse: 31,244 SF

Doors: (1) 14'x15' Ground Level

(1) 14'x14' Ground Level

(1) 10'x10' Ground Level

Ceiling: 12'-29' Clear

Power: 1,000+ A, 480 V, 3 Phase

- HVAC throughout entire space
- Industrial grade dust collection system with silo
- Air lines ran throughout the space
- Warehouse drains throughout
- Partitioned warehouse space for printing, metalwork, textile, and washing
- Attractive office with reception, showroom, bullpen, breakroom and conference room
- Fire Sprinkled
- Space is divisible to 2,800 SF, 17,580 SF or 14,242 SF
- Great location with freeway access within less than one minute of the site



Bob Mills

385.988.6477

bob@adventut.com

Riley Mills

385.988.6478

riley@adventut.com

Advent Property Advisors: 5284 S. Commerce Drive, #C-274, Murray, Ut

Temp Controlled Manufacturing- Heavy Power

852-866 South 500 West, Salt Lake City, Ut



Bob Mills
385.988.6477
bob@adventut.com

Riley Mills
385.988.6478
riley@adventut.com

Advent Property Advisors: 5284 S. Commerce Drive, #C-274, Murray, Ut

Temp Controlled Manufacturing- Heavy Power

852-866 South 500 West, Salt Lake City, Ut

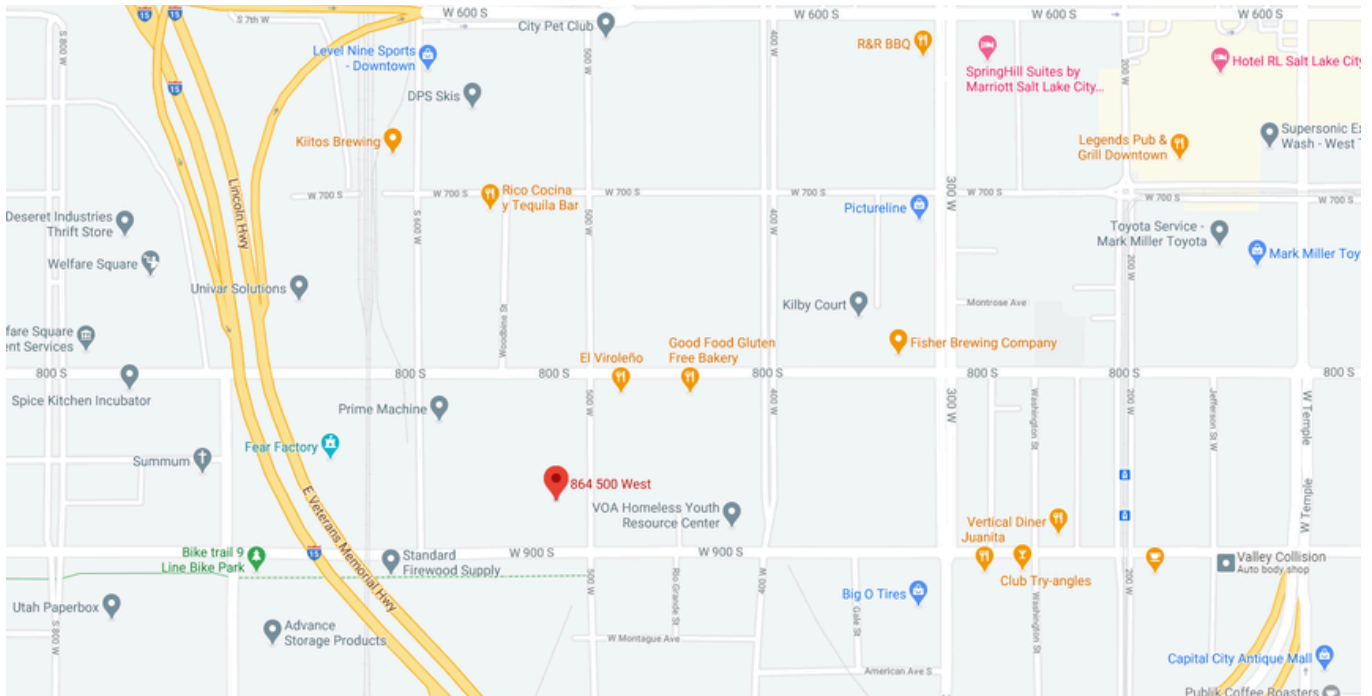
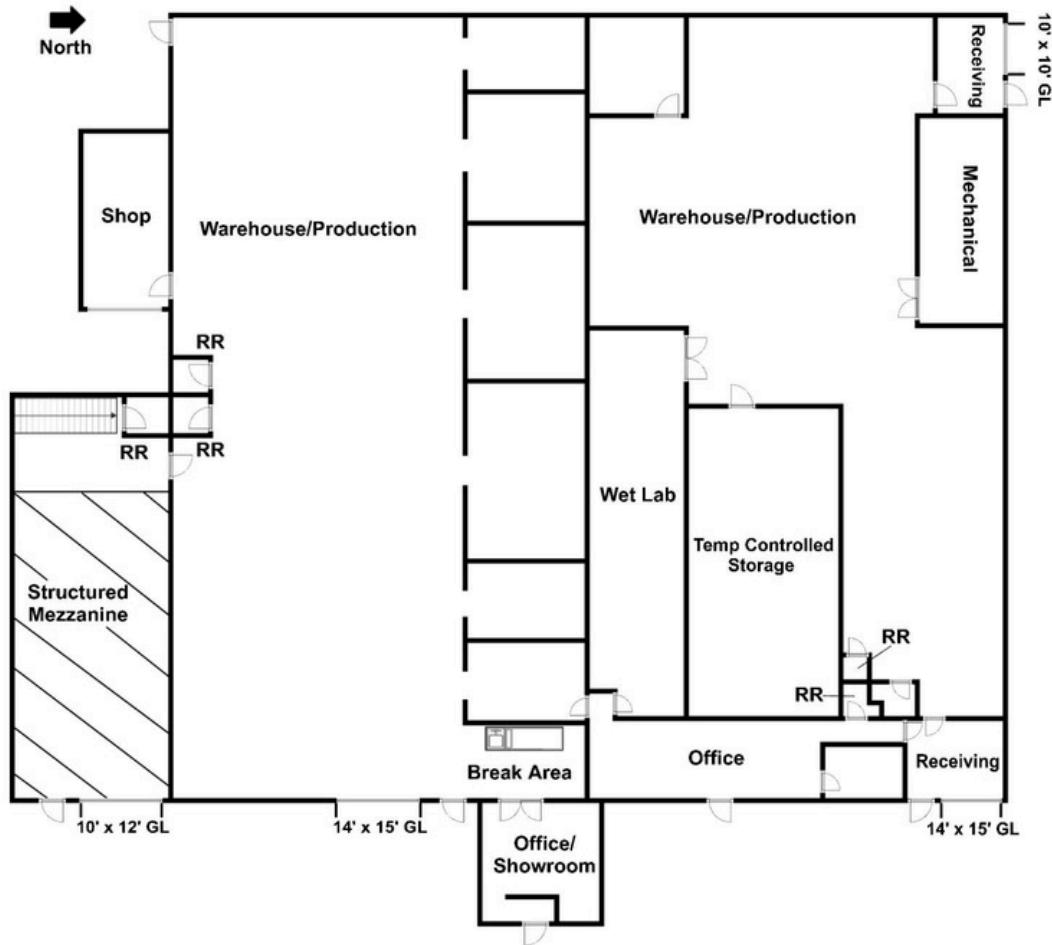

Bob Mills
385.988.6477
bob@adventut.com

Riley Mills
385.988.6478
riley@adventut.com

Advent Property Advisors: 5284 S. Commerce Drive, #C-274, Murray, Ut