

Public Asphalt Alley

136'-8 5/8"

45'-6 15/16"

28'-0"

50'-4"

17'-2 11/16"

23'-7"

CITY OF CHICAGO  
 DEPARTMENT OF HOUSING AND  
 ECONOMIC DEVELOPMENT  
 CONFORMS  
 TO ZONING ORDINANCE

AUG 27 2012

USE OF BLDG. *Auto Repair*  
 DESCRIPTION OF WORK *Auto Repair*  
 PLAN EXAMINER *D. J. ...*  
 ZONING ADMINISTRATOR *D. J. ...*

W. 95<sup>th</sup> Place

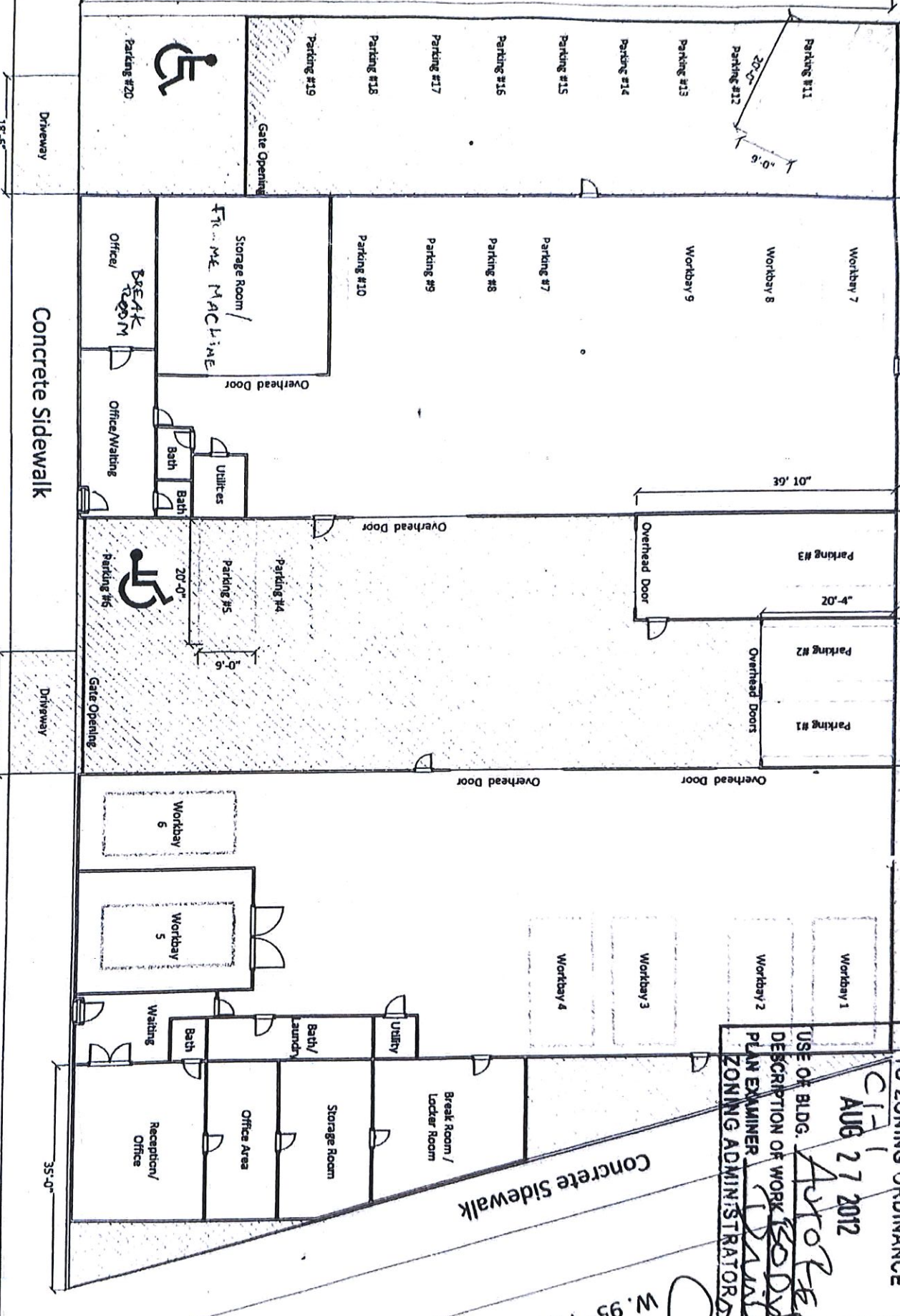

Concrete Sidewalk

Driveway

Driveway

35'-0"

18'-6"

19'-6"

W. 95<sup>th</sup> Place

K

K

90'

21