

FOR LEASE **24,000 SF ANCHOR SUITE AVAILABLE**

10001 Paramount Blvd, Downey, California 90240

PROPERTY HIGHLIGHTS

- Former Grocery Anchor Suite Available
- Strong Retail Intersection
- Excellent Building Top Signage
- Close to the Affluent Area of Downey
- Ample Surface Parking Available



DEMOGRAPHICS

2019 Est. Population	29,520	236,509	782,186
2019 Est. Average Household Income	\$95,760	\$79,157	\$72,121
2019 Est. Daytime Population	8,863	102,512	275,638

1 MILE

3 MILE

5 MILE

TRAFFIC COUNTS

Florence Avenue	approx 40,155 cars per day
Paramount Boulevard	approx 39,900 cars per day
Downey Avenue	approx 12,200 cars per day

FOR MORE INFORMATION

PETER SPRAGG
Senior Managing Director
213 298 3594
CA RE Lic 01485613
peter.spragg@ngkf.com

NEWMARK KNIGHT FRANK
700 S. Flower Street
Suite 2500
Los Angeles, CA 90017
Corporate Lic 01355491



FOR LEASE 24,000 SF ANCHOR SUITE AVAILABLE

10001 Paramount Blvd, Downey, California 90240



FOR LEASE **24,000 SF ANCHOR SUITE AVAILABLE**

10001 Paramount Blvd, Downey, California 90240

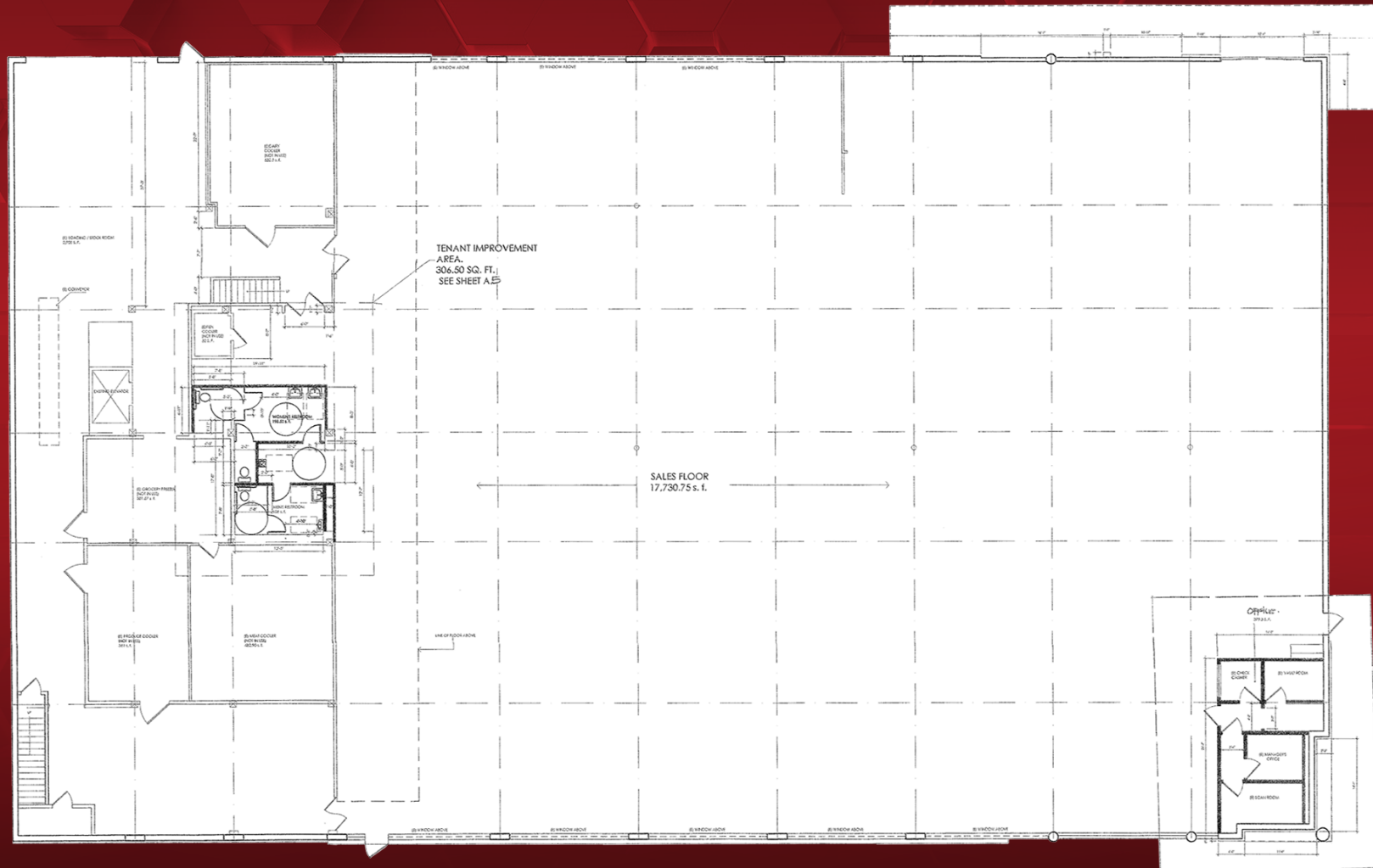

FOR MORE
INFORMATION

PETER SPRAGG
Senior Managing Director
213 298 3594
CA RE Lic 01485613
peter.spragg@ngkf.com

NEWMARK KNIGHT FRANK
700 S. Flower Street
Suite 2500
Los Angeles, CA 90017
Corporate Lic 01355491



FOR LEASE **24,000 SF ANCHOR SUITE AVAILABLE**

10001 Paramount Blvd, Downey, California 90240

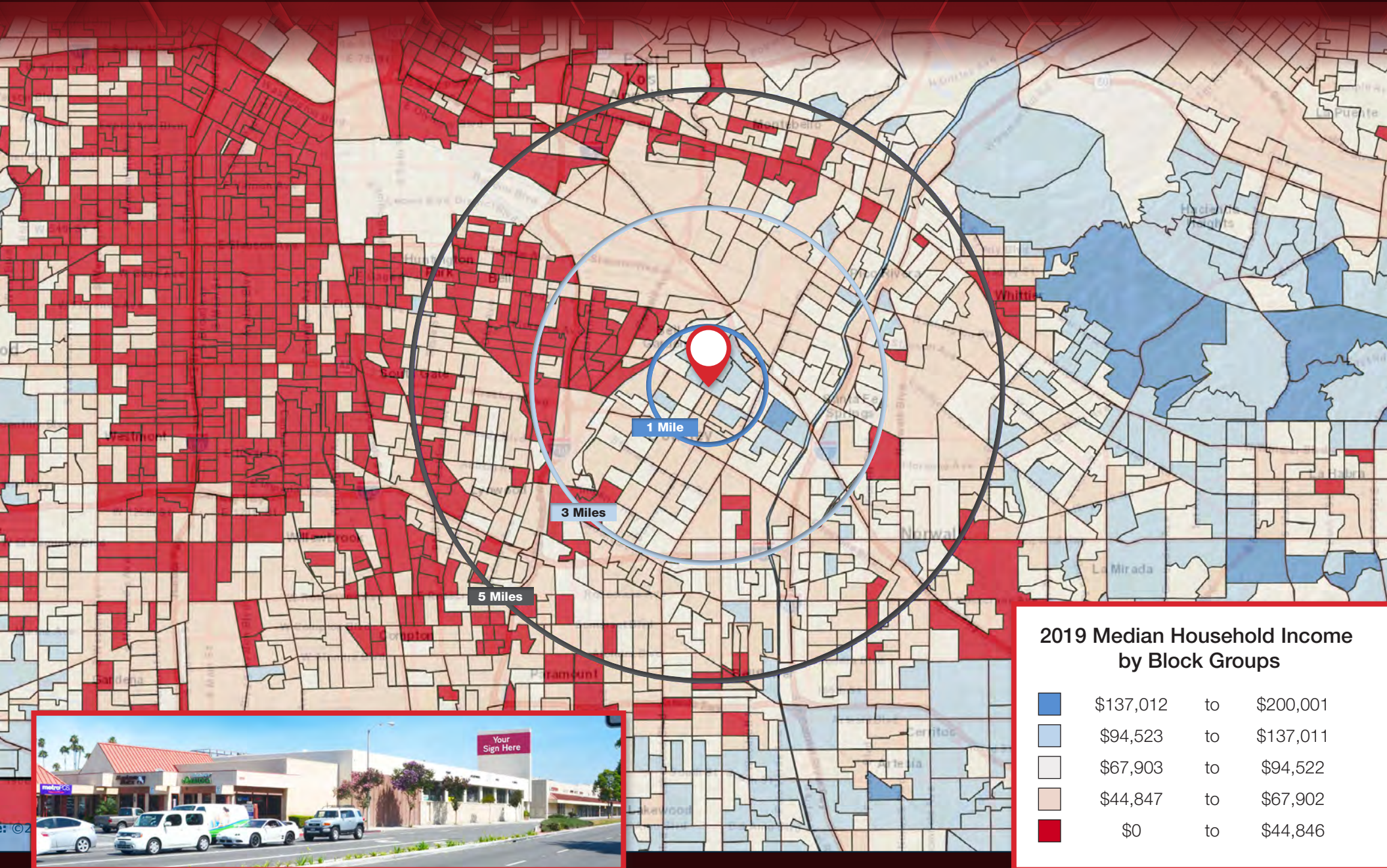

FOR LEASE **24,000 SF ANCHOR SUITE AVAILABLE**

10001 Paramount Blvd, Downey, California 90240



**FOR MORE
INFORMATION**

PETER SPRAGG
Senior Managing Director
213 298 3594
CA RE Lic 01485613
peter.spragg@ngkf.com

NEWMARK KNIGHT FRANK
700 S. Flower Street
Suite 2500
Los Angeles, CA 90017
Corporate Lic 01355491

