

1133 BROADWAY, NEW YORK, NY 10010

FOR SUBLEASE

3,200 SF BEAUTIFULLY BUILT-OUT OFFICE

Between West 25th Street & West 26th Street



SHLOMI BAGDADI
212.433.3355 x101
sb@tristatecr.com

TRI STATE COMMERCIAL®

PROPERTY SUMMARY

LOCATION

Located in the neighborhood NooMad of Manhattan.

SPACE DETAILS

- 2 Private Offices
- 18 Workstations
- 1 Conference Room
- 1 Kitchen & Lounge Area
- Open Floor Plan
- Mailroom
- Secure Entry
- Lots of Windows

TRANSPORTATION

N R Trains at 28th Street & 23rd Street

4 6 Trains at 28th Street & 23rd Street

BM3 M55 BM4 M3 Bus Lines

NEIGHBORS

Tiffany & Co. Corporate Office, Chick-fil-A, CAVA, Auntie Anne's, Michaels, Trader Joe's, Best Buy, Burlington, CVS, PetSmart, The LEGO® Store, The Home Depot, COTE Korean Steakhouse, HOKA Store, Carrot Express, Arc'teryx Flatiron, New Balance Flatiron, Harry Potter New York, Kleinfeld Bridal, TD Bank, The Container Store, Lovesac, and more!

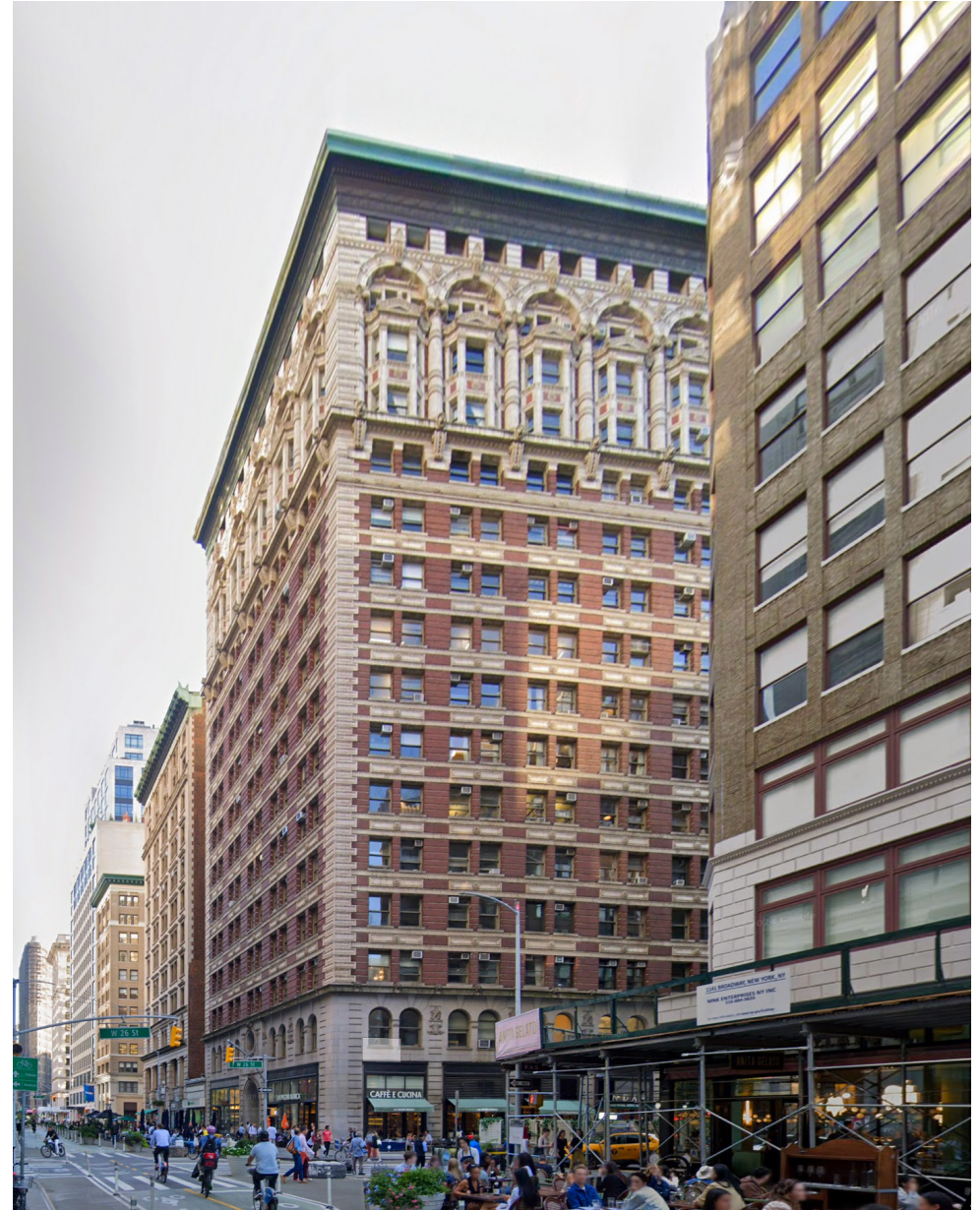

FLOOR PLANS

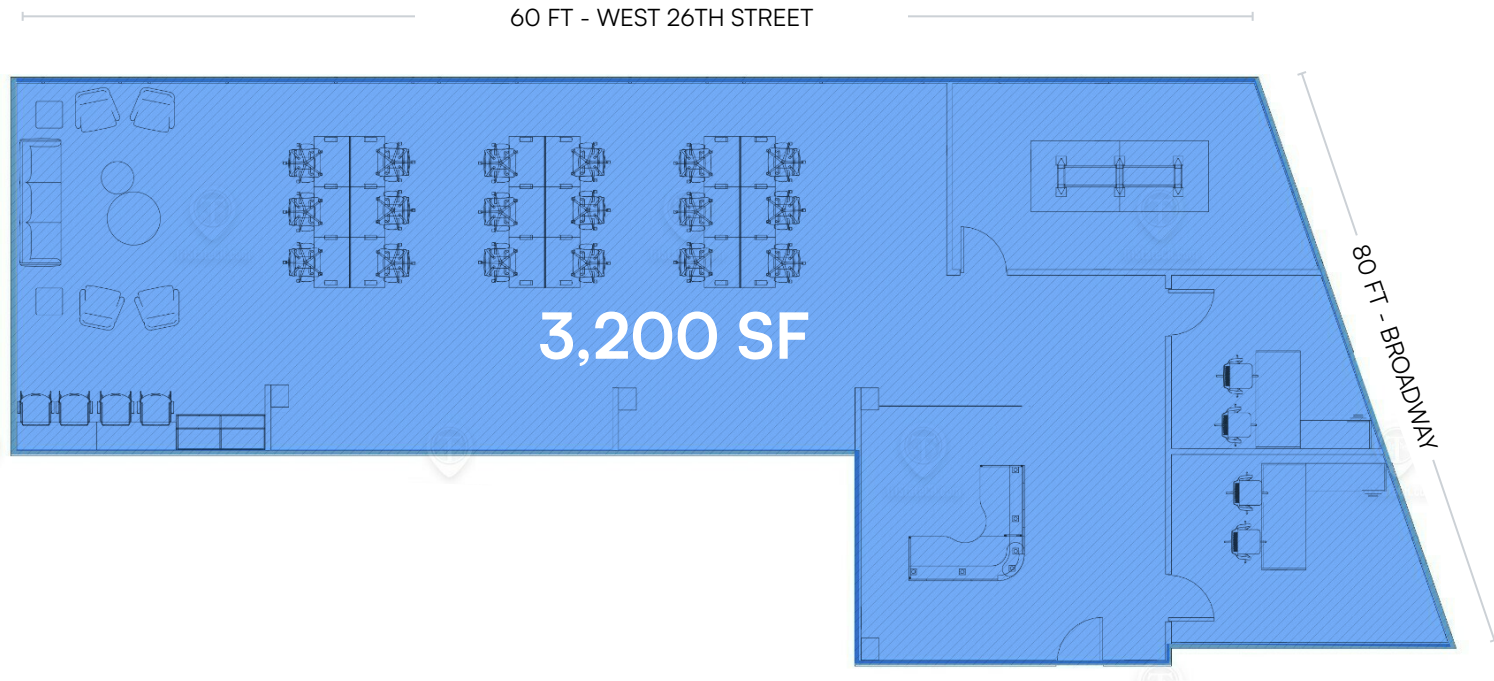

All square footages are approximate

PROPERTY PHOTOS



PROPERTY PHOTOS



RETAIL MAP

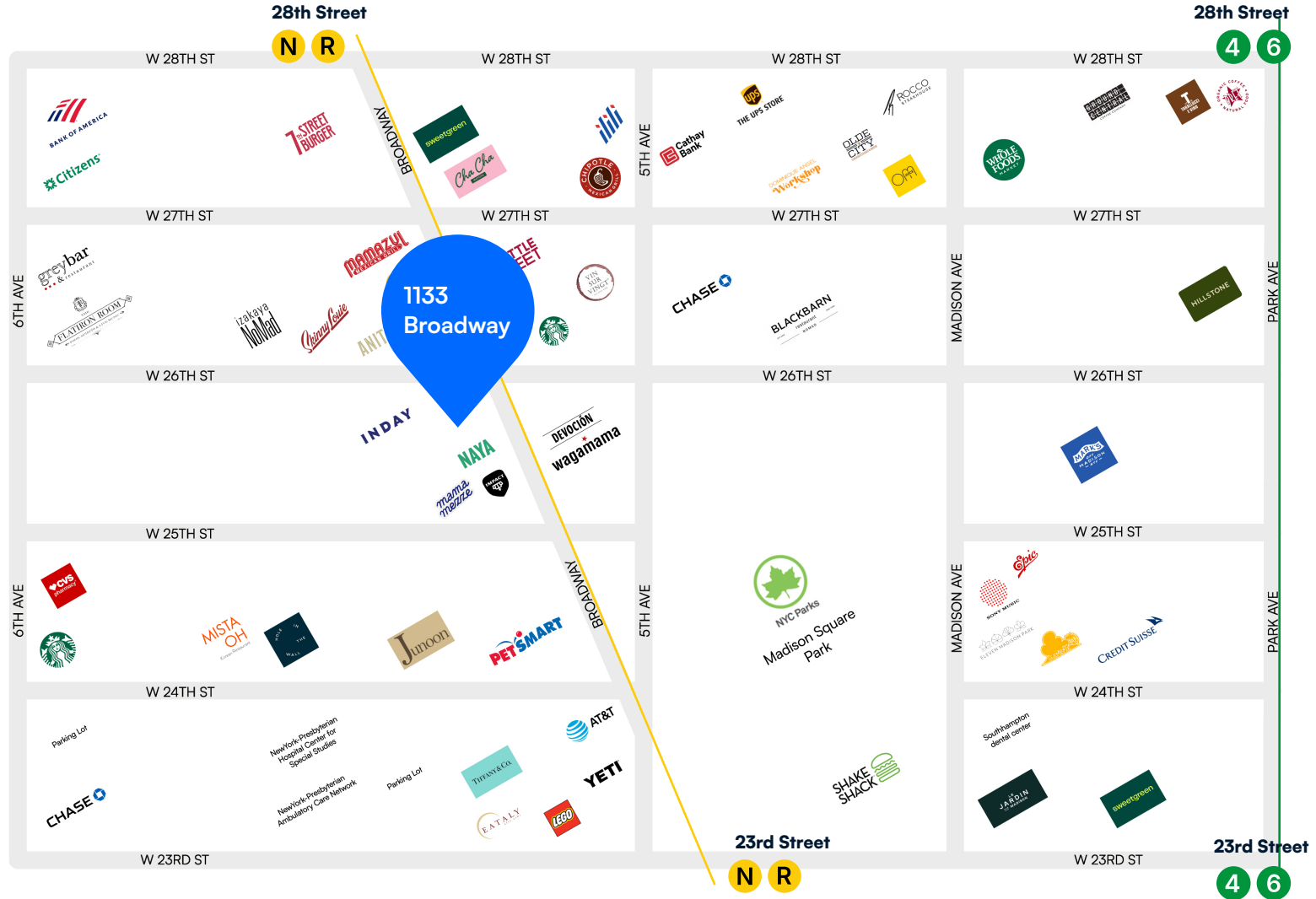

1133 BROADWAY, NEW YORK, NY 10010

3,200 SF BEAUTIFULLY BUILT-OUT OFFICE

Between West 25th Street & West 26th Street

For Pricing Call: **212.433.3355**

SHLOMI BAGDADI
212.433.3355 x101
sb@tristatecr.com

TSC.