



5961 NORTHLAND RD, UNIT 6 | FORT MYERS, FL 33905

NORTHLAND ROAD INDUSTRIAL FLEX UNIT

FOR LEASE

CONTACT

Justin Ankney, CCIM
239-933-5594
justin@mayhughcommercial.com

In Consultation With
Chase Mayhugh, SIOR, CCIM



13099 S. Cleveland Ave. Suite 410
Fort Myers, FL 33907

MAYHUGHCOMMERCIAL.COM

Prime Office/Warehouse Space

Position your business for maximum efficiency at Northland Road, ideally located just off Lockett Road and less than a quarter mile from I-75 at Exit 139—putting regional access literally seconds away. Unit 6, available now, offers a well-balanced 2,450 SF layout designed to support both administrative and operational needs. The space includes approximately 625 SF of office and 1,825 SF of warehouse, making it an ideal fit for service, distribution, or light industrial users seeking convenience and connectivity in a highly accessible location.

PROPERTY DETAILS

LEASE RATE	\$12.50 NNN + \$5.10 CAM/OPEX (Monthly: \$3,593.33)
AVAILABLE SF	2,450
YEAR BUILT	2009
BUILDING SIZE	14,700± SF
ZONING	IL
PARCEL SIZE	1.07 +/- AC
CLEAR HEIGHT	17'5" - 20'9"
OVERHEAD DOOR	(1) 12'w x 14'h
PARKING RATIO	2.45 / 1,000 SF (6 spots for this Unit)

FLOORPLAN

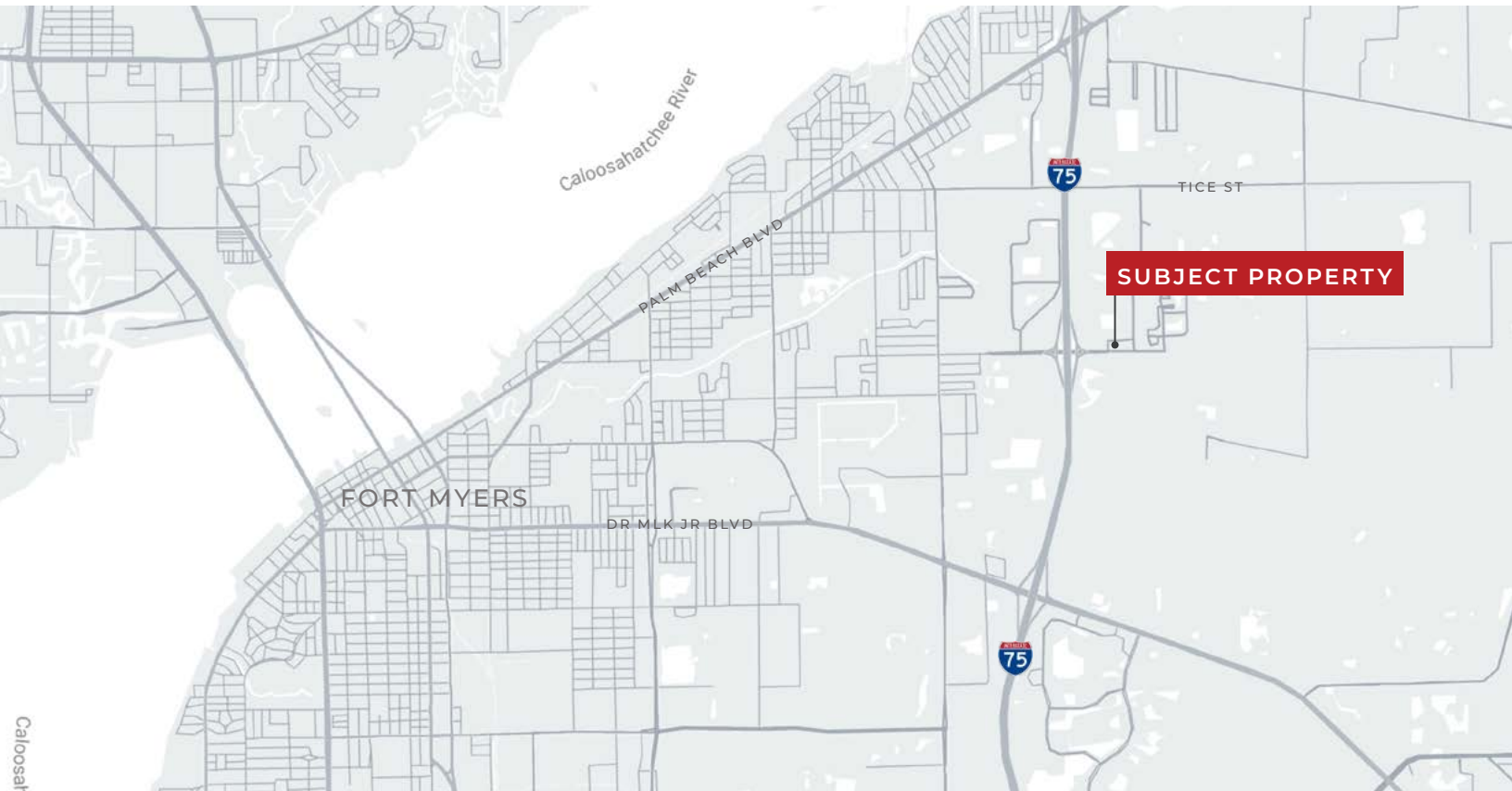
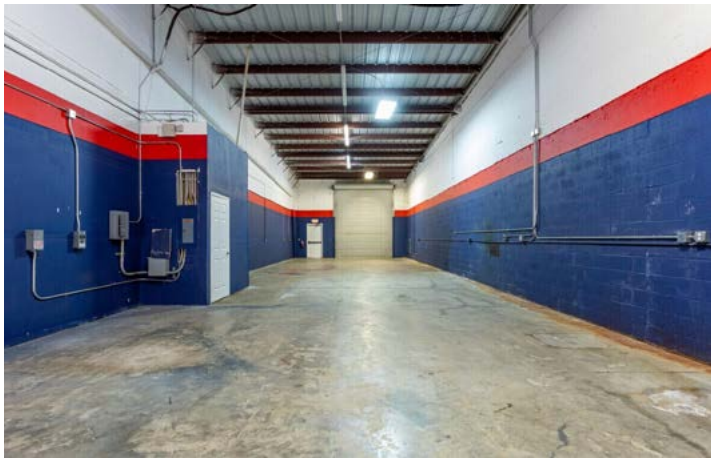
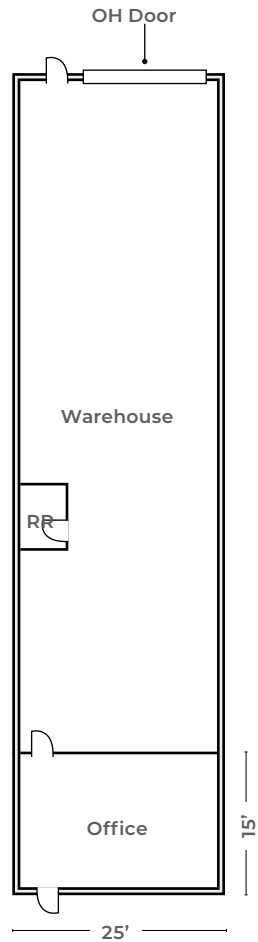

This marketing brochure serves as a reference for informational purposes only and does not constitute an offer for sale or lease, nor does it serve as a solicitation for an offer to purchase or lease. While the information contained herein is believed to be reliable, its accuracy, completeness, or reliability cannot be guaranteed. Prospective buyers or lessees are encouraged to conduct their own investigations and due diligence to verify the information provided. All descriptions, dimensions, conditions, permissions for use, and other details are offered in good faith but are subject to verification. No express or implied warranty or representation is made regarding the accuracy of the information herein. The content is subject to errors, omissions, price changes, withdrawal without notice, and any special listing conditions imposed by our principals.