



Sherman Oaks Medical Center | 4849 Van Nuys Blvd. | Sherman Oaks, CA Medical Office Suites For Sublease

Available Suites	Rentable SF	Rental Rates
Suite 202	8,260 RSF	\$3.50 FSG

Features

Fully Built Out Primary Care Clinic

Convenient to the 101 and 405 Freeways

Covered parking

Adjacent to Sherman Oaks Hospital and
near Encino Hospital Medical Center

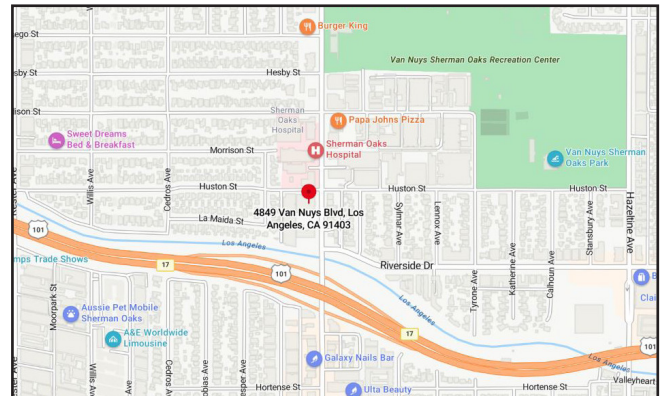

Contact

Mitch Yankowitz
(310) 517-4861
mitchy@medicalasset.com
DRE#: 01360137

Brock Burnett
(818) 990-5200 x102
brockb@medicalasset.com
DRE#: 01814211

www.medicalasset.com
(310) 530-6060

South Bay
201 Continental Blvd., Ste. 210
El Segundo, CA 90245

Downtown Los Angeles
1400 S. Grand Ave., Ste. 808
Los Angeles, CA 90015

San Fernando Valley
5411 Eriwanda Ave., Ste. 208
Tarzana, CA 91356

Long Beach
1040 Elm Ave., Ste. 308
Long Beach, CA 90813



Sherman Oaks Medical Center | 4849 Van Nuys Blvd. | Floor Plans

Suite 202 8,260 sq. ft.

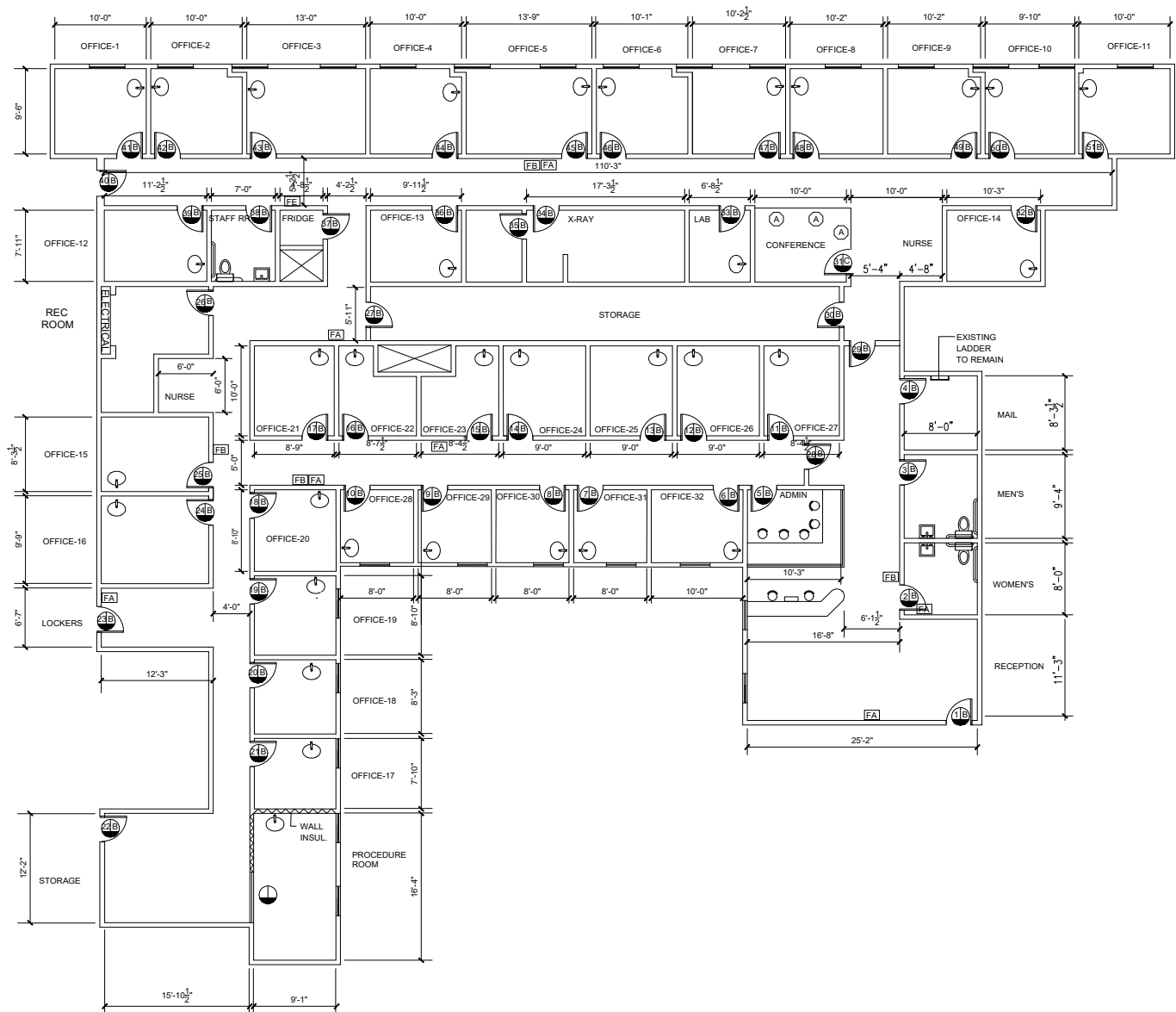



ANNIVERSARY
MEDICAL ASSET
MANAGEMENT
MEDICAL PROPERTY SPECIALISTS

