

Office Space & Build-to-Suit

1309 S Holly Avenue Yukon, OK 73099



Office Space Lease Price - \$19.50/RSF FSG
Basement Lease Price - \$6.00/RSF MG

Property Highlights

- + Located near Vandament Avenue in a mature area of Yukon
- + Building Size
 - ±18,392 SF
- + Available Space
 - Suite #3 - ±2,820 RSF
 - Suite #4 - ±2,495 RSF
 - Basement - ±2,532 RSF, with 8 ft X 8 ft overheard door
- + Build-to-Suit for Lease
 - ±5,000 RSF
 - Rental Rate to be determined
- + Zoned C-3 - Restricted Commercial District
- + 1 Story
- + 5.71/1,000 SF parking ratio
- + Great for medical tenant

Floor Plan

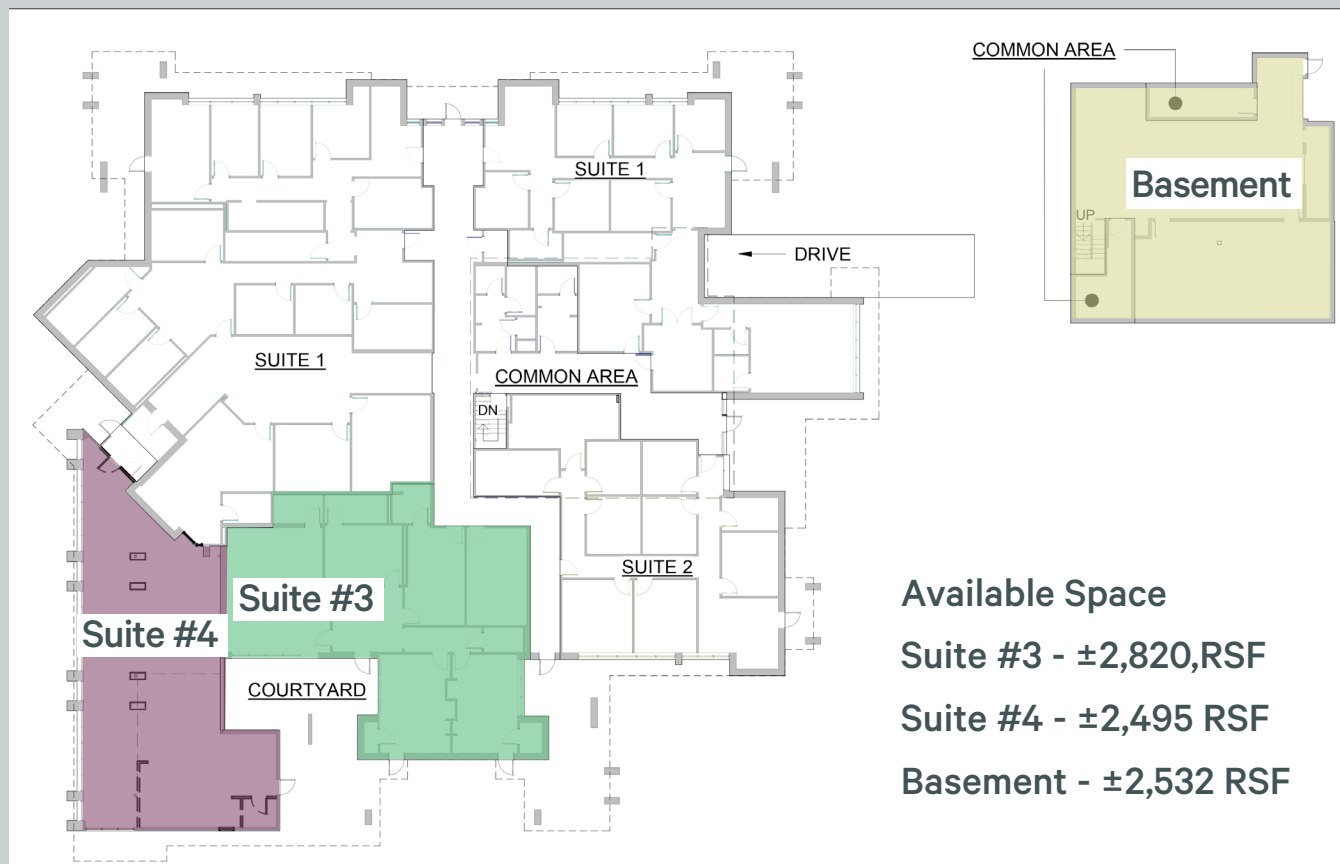

Tract 2
187,514 SQ. FT.
4.30 ACRES
ONE STORY STONE VENEER BUILDING

Tract 1
SPRINGS CREEK ADDITION
TO THE CITY OF YUKON,
CANADIAN COUNTY,
OKLAHOMA

Zone "C-3"
Restricted Commercial District

Zone "C-2"
Convenience Commercial District

Legend

- MONUMENT SET (1/2" IRON BAR UNLESS OTHERWISE NOTED)
- MONUMENT FOUND
- SUBJECT PROPERTY
- PROPERTY LINE
- EASEMENT LINE (U/E)
- SECTION LINE
- GUARDRAIL
- GAS LINE
- UNDERGROUND TELEPHONE LINE
- ASPHALT
- CONCRETE
- LANDSCAPING
- FLOODWAY
- FLOODWAY ZONE "AE"
- TITLE CALLS
- PARRING SPACES



Contact Us

Amy Dunn, CCIM
+1 405 607 6021
amy.dunn@cbre.com

© 2022 CBRE, Inc. All rights reserved. This information has been obtained from sources believed reliable, but has not been verified for accuracy or completeness. You should conduct a careful, independent investigation of the property and verify all information. Any reliance on this information is solely at your own risk. CBRE and the CBRE logo are service marks of CBRE, Inc. All other marks displayed on this document are the property of their respective owners, and the use of such logos does not imply any affiliation with or endorsement of CBRE. Photos herein are the property of their respective owners. Use of these images without the express written consent of the owner is prohibited.