



505 Eagleview

152,000 SF Class A Office Building
Up to ±31,000 SF Available

505 Eagleview Blvd
Exton, PA 19334



505 Eagleview

Located in Eagleview, a walkable, sustainability minded master planned community. 505 Eagleview is the region's premier office environment. Boasting LEED Gold and Energy Star certification, comfort, quality, and sustainability are paramount. From here you'll enjoy a plethora of trails and walking access to the restaurants, shops, fitness and daily services at Eagleview Town Center.



Certified Sustainability



Location

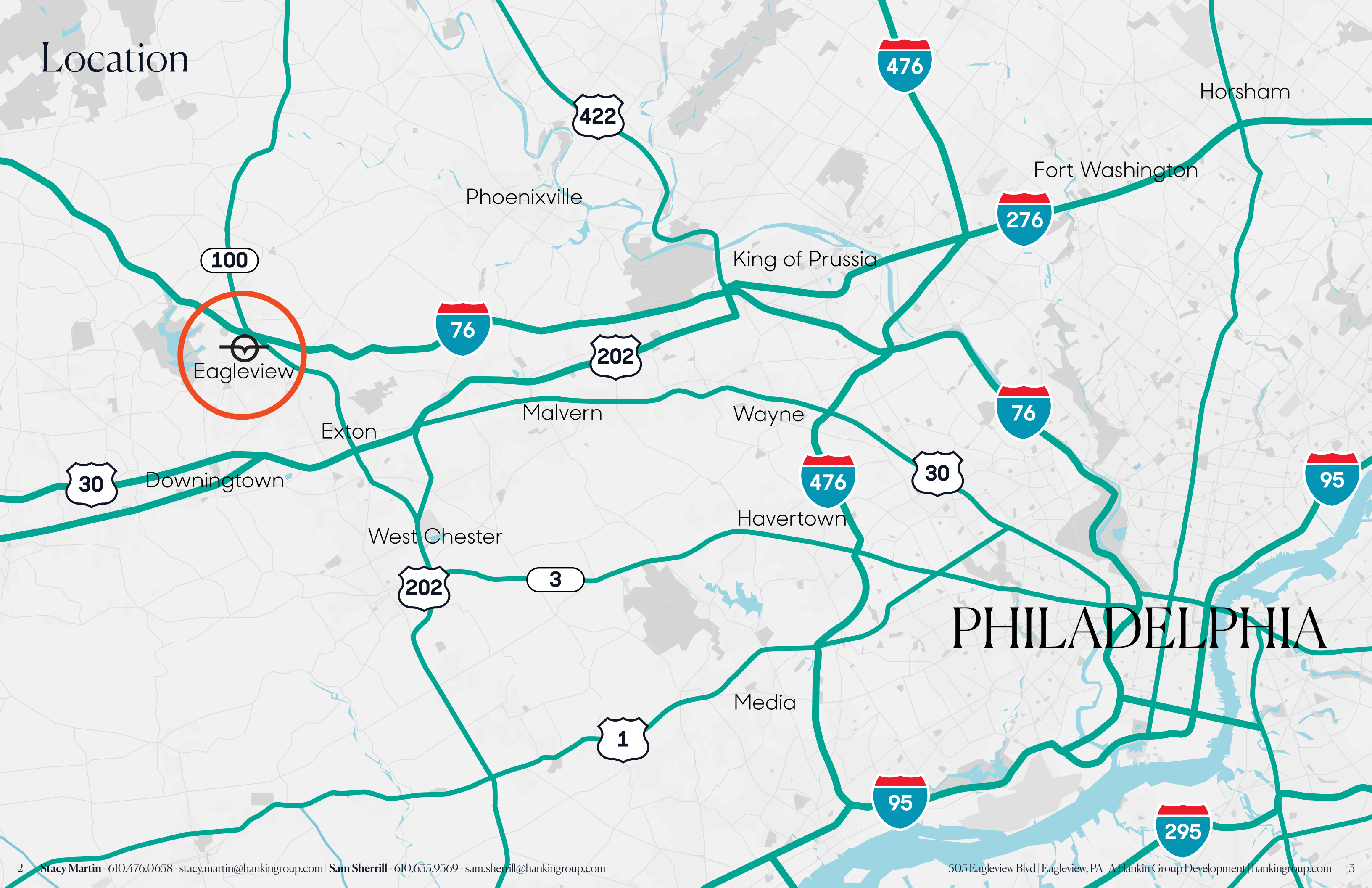



Welcome to Eagleview

Located just minutes from the PA Turnpike Exit 312, Eagleview is an award-winning mixed use planned development on over 800 acres in Uwchlan and Upper Uwchlan Townships in Exton, Pennsylvania. Eagleview is designed for a "walkable" lifestyle; it includes sidewalks, jogging paths and greenways that integrate home, market and workplace.

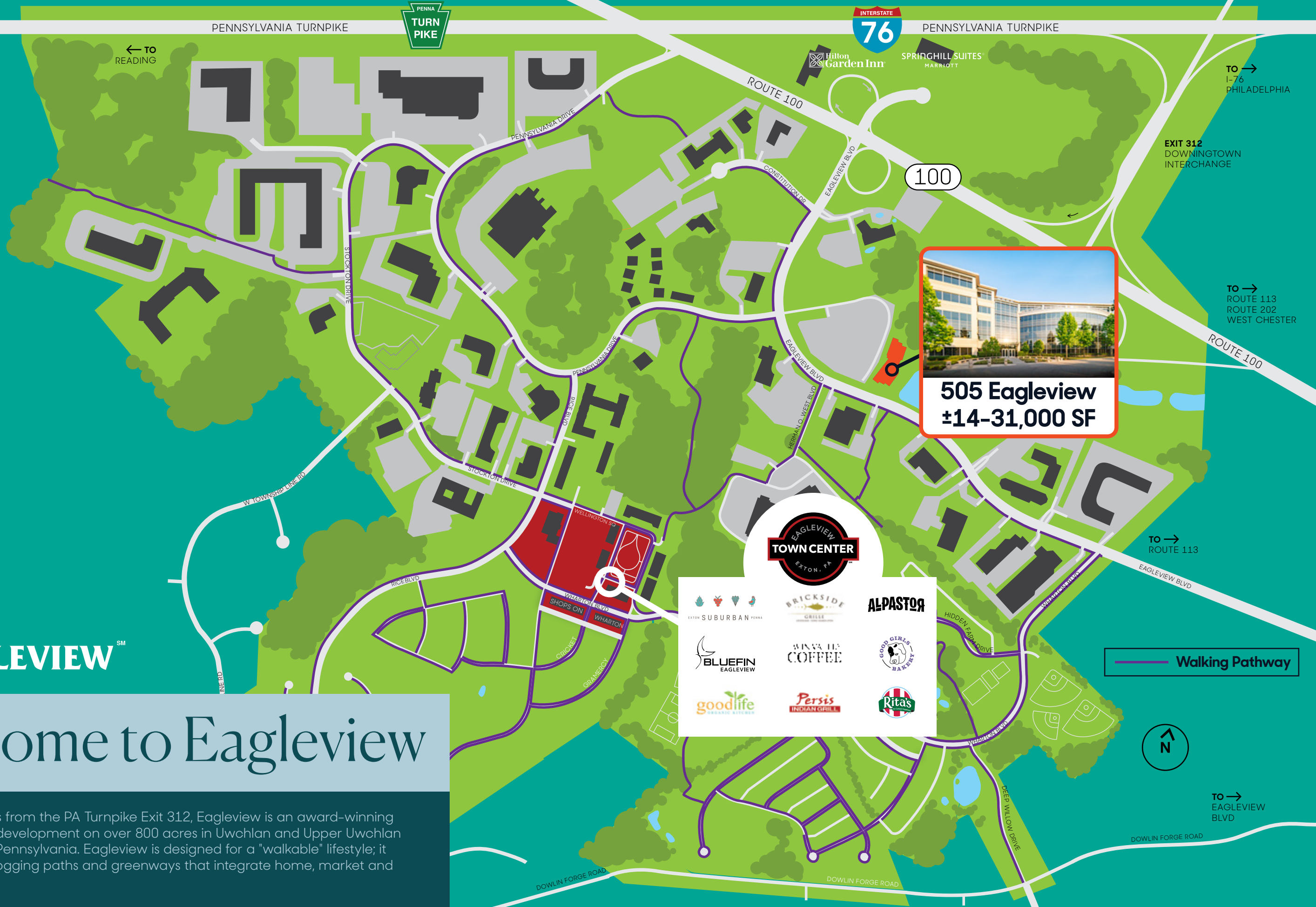

EAGLEVIEW TOWN CENTER
EXTON, PA

- EXTON SUBURBAN PENNA
- BRICKSIDE GRILLE
- ALPASTOR
- BLUEFIN EAGLEVIEW
- WINA HILL COFFEE
- GOOD GIRLS BAKERY
- goodlife ORGANIC STORES
- Persis INDIAN GRILL
- Rita's

Walking Pathway



A Highly Amenitized Environment

At Eagleview you have options. From the short walk to Town Center for lunch, the plethora of restaurants and shops within a 5-minute drive, and the two on-site hotels for visiting guests, there's no place quite like Eagleview.

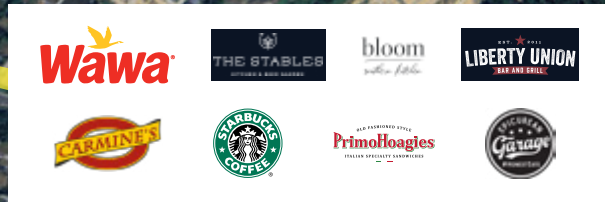



Property Overview

Address	505 Eagleview Boulevard, Exton, PA 19341
Building Size	152,345
Floors	5
LEED Status	Gold Certified
Access Control	Digitally controlled key card access
Property Management	Professionally managed 24/7 by award winning Hankin Property Management
Parking	598 Parking Spaces
Ceiling Height	12'
Data	Comcast Fiber and Verizon Fios
Elevators	2 passenger, 1 freight

The grand lobby with expansive green space views at 505 Eagleview Boulevard



5th Floor Available
±14-31K SF

The recently remodeled entrance to 505 Eagleview welcomes you with lush landscaping.

Available Space

Floor 5

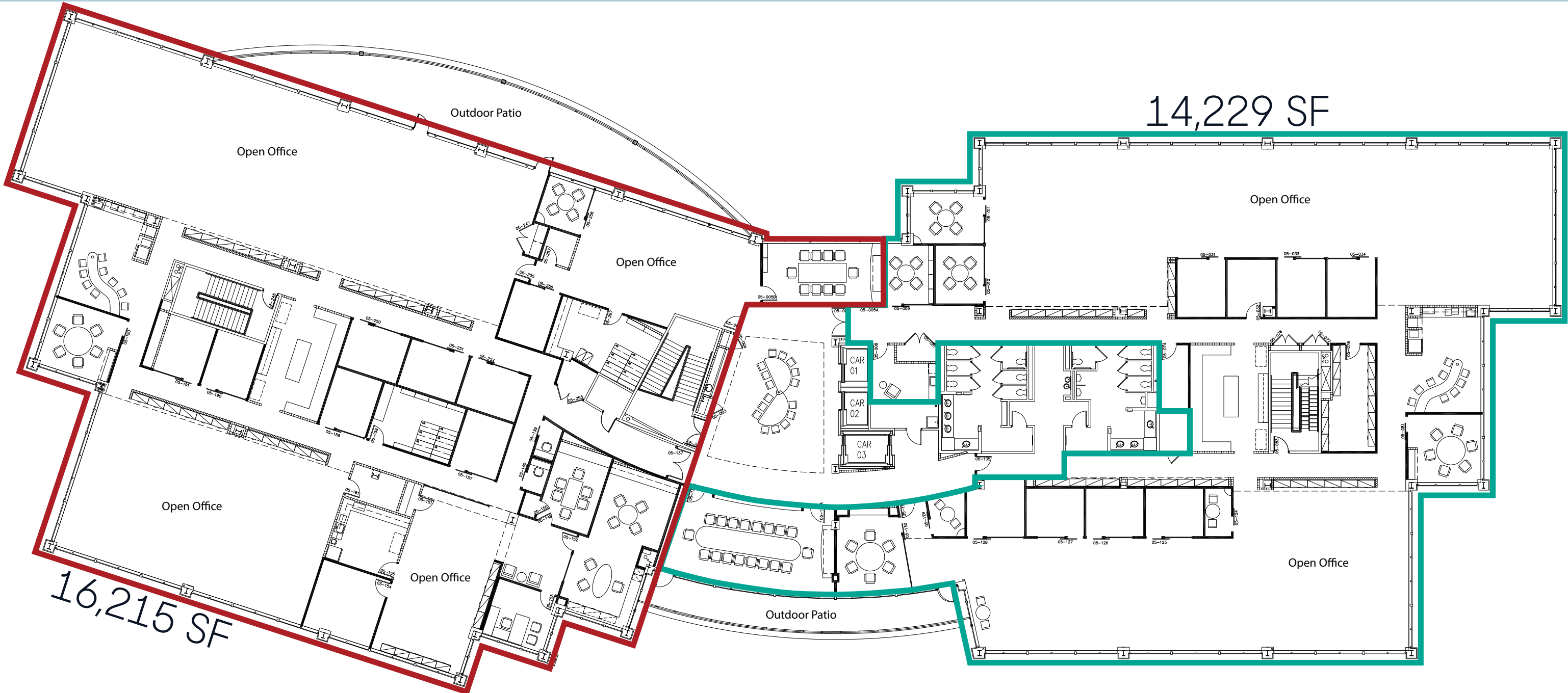

Red Suite Overview

Suite SF	16,125 SF
Existing Offices	10 private offices with 1 Executive Suite, 2 hoteling offices
Existing Meeting Rooms	4 meeting rooms

Green Suite Overview

Suite SF	14,229 SF
Existing Offices	9 private office, 2 hoteling offices
Existing Meeting Rooms	4 meeting rooms

Parking



Access



Shamona Creek

An Award Winning Development



Eagleview is an award-winning planned development nestled on over 800 acres in Uwchlan and Upper Uwchlan Townships in Exton, Pennsylvania. Here you'll find miles of trails for healthy and active lifestyles, quality housing options, a curated collection of dining experiences, an energetic town square, and a bustling corporate destination.

Eagleview Town Center Summer Concert Series

505 Eagleview Blvd | Eagleview, PA | A Hankin Group Development | hankingroup.com

About the Developer



**Hankin
Group**

Designing, developing, and managing environments with integrity that inspire people to lead richer, more fulfilled lives.

Quality

We don't compromise on quality. We build outstanding properties and provide unsurpassed resident and tenant services that deliver premium value to our communities.

Sustainability

We keep forever in mind, dedicated ourselves to holding our assets long-term and designing for a sustainable future.

Commitment

We stand ready to serve as a dedicated, capable, and reliable partner.

Community

We show appreciation for the people who occupy and enjoy our spaces.



