

For Lease or Sale: Industrial/Warehouse Building in Downtown Pueblo

📍 205 N Elizabeth Street | PUEBLO, CO 81003



PROPERTY FACTS

Available:	±16,000 - 94,000 RSF
Building Size:	±126,882 RSF
Market:	Downtown Pueblo
Zoning:	I2
Construction:	Concrete Tilt-Slab Walls
Clear Height:	±16'
Power:	800Amp 277/480 Throughout
Loading:	(6) 12' wide x 16' high
Sprinkled:	Yes
2023 OpEx:	±\$1.92 PSF
Year Built:	1952/1955
Remodeled:	2020

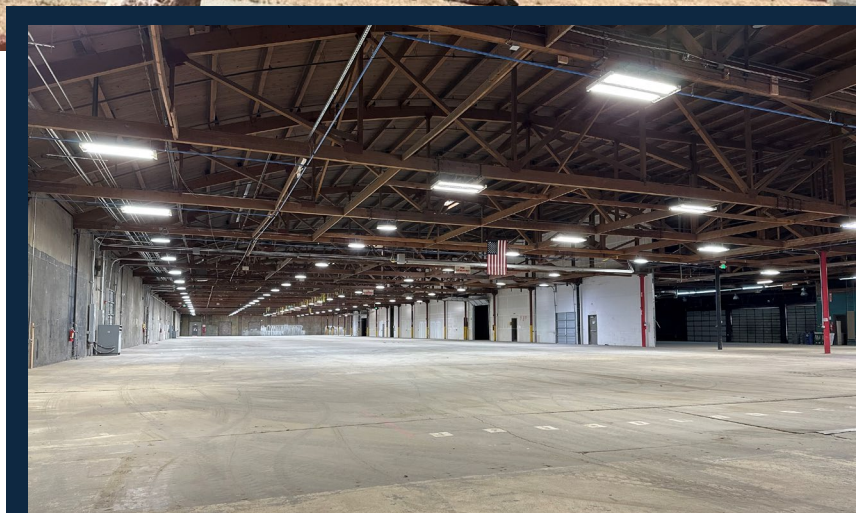

MILLENNIUM
COMMERCIAL REAL ESTATE

www.MCREUSA.com

\$6.00 NNN
LEASE RATE

Contact Broker
SALE PRICE

EXTERIOR & INTERIOR PHOTOS



AERIAL



FOR MORE INFORMATION

DREW DOWIS

drew.dowis@mcreusa.com
719.447.5948

ANDREW DOWIS

andrew.dowis@mcreusa.com
719.332.6314

MILLENNIUM
COMMERCIAL REAL ESTATE

www.MCREUSA.com

1755 Telstar Dr, Suite 300

Colorado Springs, CO 80920

ZOOMED AERIAL



FLOORPLAN

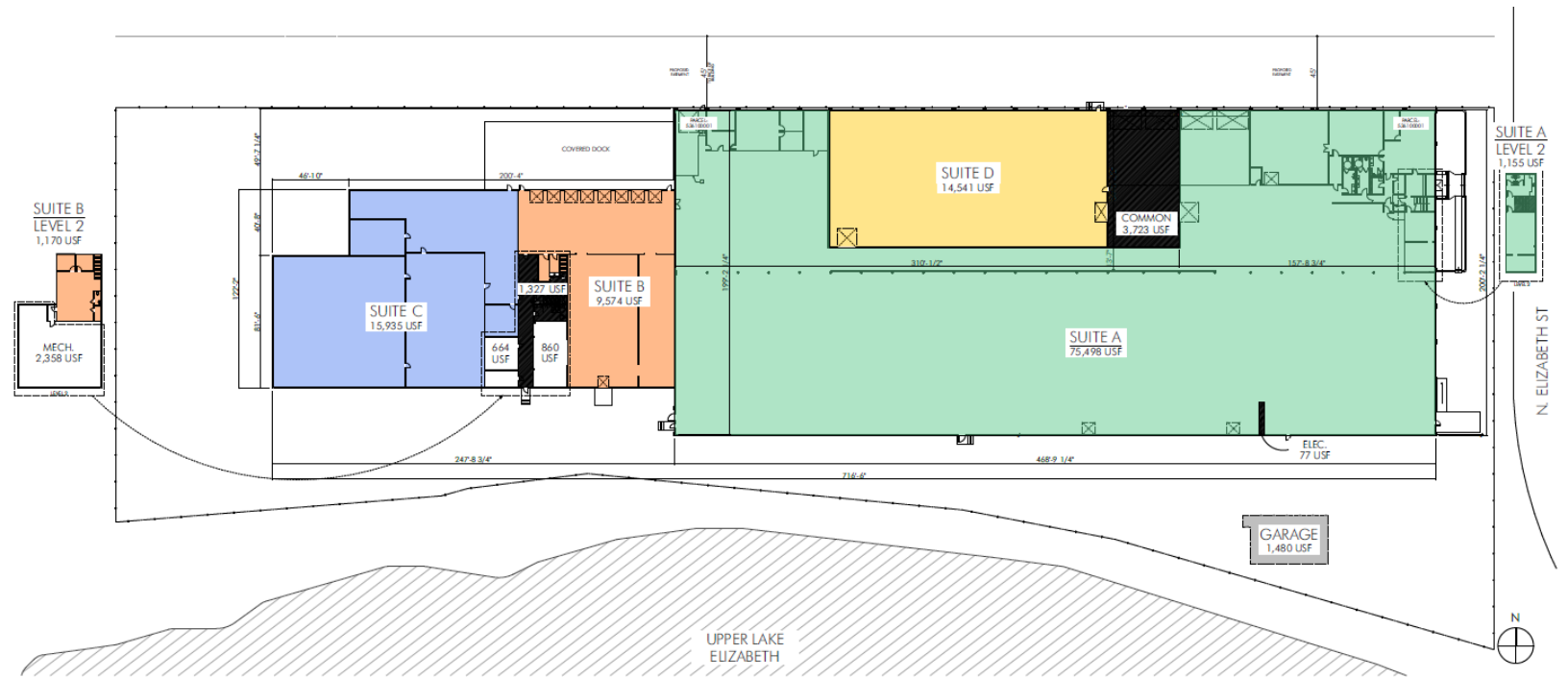

© 2021 Millennium Commercial Real Estate, LLC ("MCRE"). All rights reserved. The information and content contained herein has been obtained from third-party sources that are believed to be reliable and accurate, but MCRE cannot verify the accuracy or completeness of said information and cannot be held liable for inaccuracies from the third-party resources. Any reliance on this information by you is solely at your own risk and you should conduct a careful, independent investigation of the property and verify the accuracy of all information. The MCRE name and logo are service marks of MCRE. All other marks displayed on this document are the property of their respective owners, and the use of such logos does not imply any affiliation with or endorsement of MCRE. Photos herein are the property of their respective owners. Use of these images without the express written consent of the owner is prohibited.

