

## PREMIER SPACE: MOVE-IN READY

Building 9072 provides 115,632 SF of ready-to-use space designed for efficiency, flexibility and long-term operational success. With core systems already in place, tenants benefit from lower upfront costs and faster deployment of their teams. The layout can be modified for technical workflows and other technologically driven processes. This makes the building a strong fit for companies looking to streamline setup while maintaining room to expand.

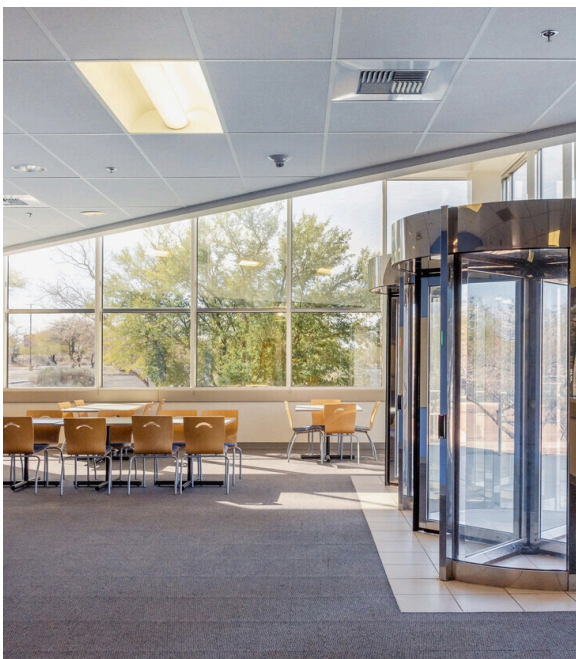

**Building Features:** This multi-use facility supports office, assembly, and warehouse operations, complete with back-office support, fully furnished spaces, and 100% backup power for electrical and chiller systems. Its flexible design allows companies to scale and adapt as their needs evolve.

**Move-In Ready Advantages:** Existing mechanical, electrical and communication systems minimize build out time and reduce upfront costs. Tenants can begin operations faster while retaining the ability to customize their environment as they grow.

**Talent Pipeline:** Leverage the University of Arizona's proximity for research collaboration, workforce recruitment and internship programs.

## FULL SERVICE CAMPUS

The UA Tech Park offers nearly 2 million square feet of developed space across a 1,267-acres. Tenants benefit from a well-connected campus experience featuring:

- On-site food service options (Starbucks, fresh meals and on-site catering)
- Corporate fitness center
- Walkable paths & shaded courtyards
- Event and corporate meeting spaces

