

±1.6 Acres / ±16,186 SF Industrial Building
AVAILABLE Regional Location

Property Highlights

- +/-16,186 SF Industrial Building
- 1.6 Acre land parcel with redevelopment potential
- Clear and full highway access to Interstate 95
- ±667' frontage and great sight lines on Jefferson Blvd
- Located near many amenities
- Many possible uses
- Zone LI (Light Industrial)

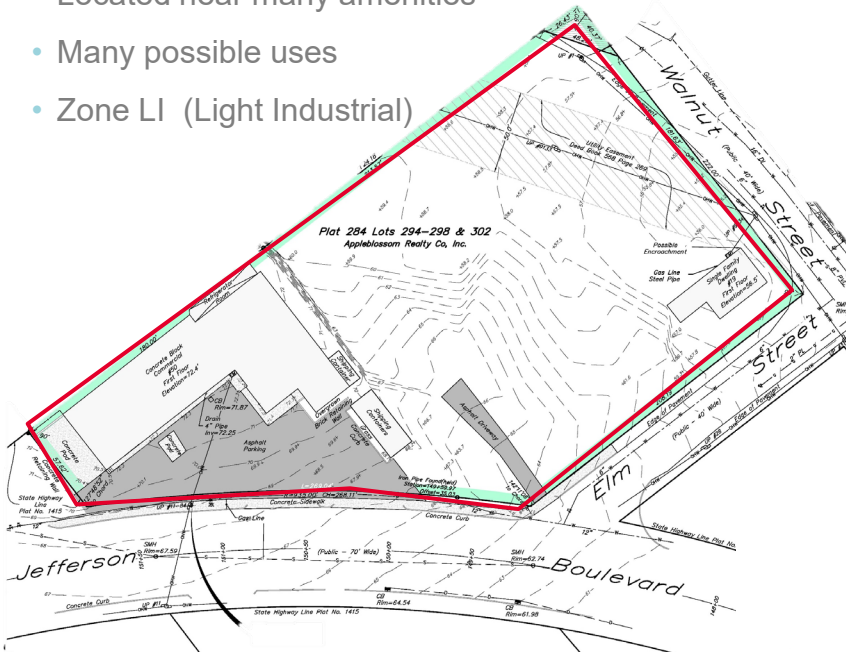

POTENTIAL REDEVELOPMENT 1.6 ACRES



For more information, please contact:

Bill Greene
 Partner
 401.273.7429
 bgreene@hayessherry.com

146 Westminister Street, 2nd floor
 Providence, RI 02903
 phone: 401 273 1980
 www.hayessherry.com

FOR LEASE

50 Jefferson Boulevard

Warwick, RI

